

CERTIFIED LAND CORNER RESTORATION

Index No. **013**

State of Wisconsin }
County of Forest } ss.

I, Glen Barker, do hereby
certify that on the 25th day
of May 19 83, I found
evidence of the N 1/16
corner of Sections 21-22
Township 34, North, Range
13 East, Fourth Principal Meridian,
as described hereon; and that from this evidence
I established a new monument and accessories
as described hereon to perpetuate the original
location of this corner.

Resident witnesses:

J. Claflin - R.L.

H. Wagoner

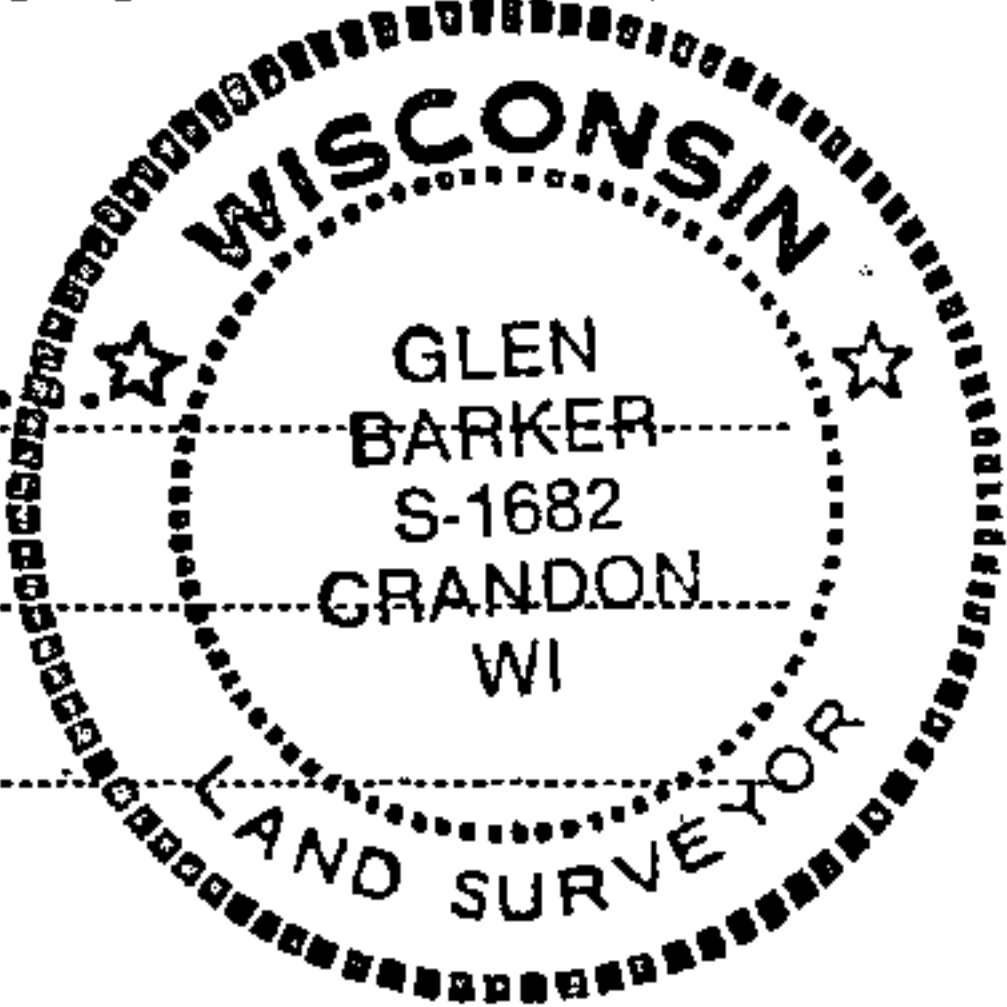

T34N

R13E

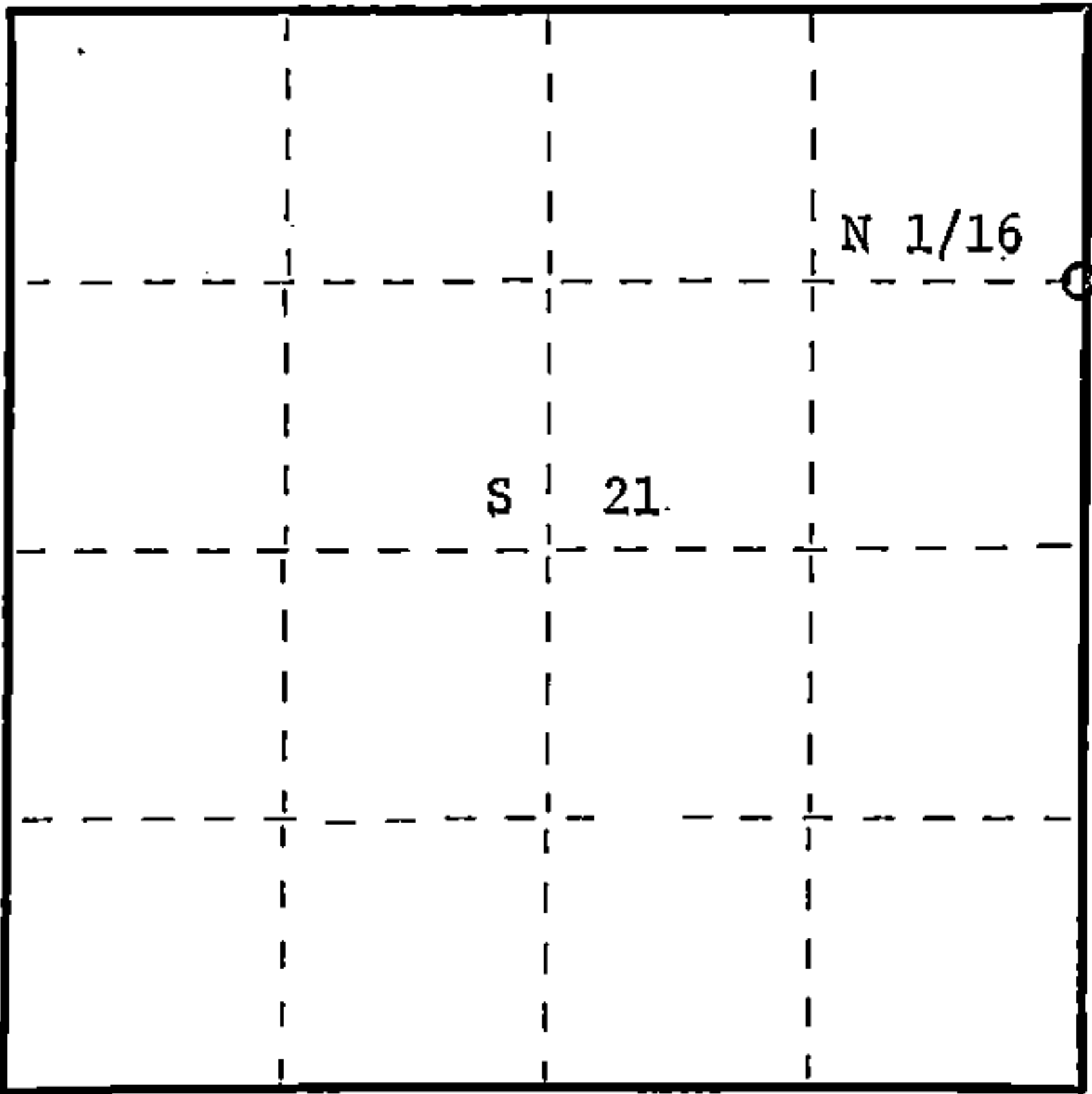

○ = Corner monument restored.

History of original corner establishment:

Neal Sperhake R.L.S. established corner in 1963

Description of corner evidence found:

Recovered a 1" iron pipe with 4" diameter alloy cap stamped:

O.B.T. Black Spruce 4" S58E 28.85 ft.

T34N
N 1/16 21-22
R13E
Sperhake R.L.S. 463
10/23/63

Description of monument and accessories I established to perpetuate the original location of this corner.

Left monument in place.

Marked NBTs:

Tamarack 3" S13E 15.85 ft.
Black spruce 3" N88E 43.20 ft.
Scribed 1/16 - B.T.

Dated at Rhineland, Wis., this 9th day of June, 19 83.

Signature Glen Barker Title Registered Land Surveyor Registration No. S1682
(County Surveyor, Registered Land Surveyor, or other duly authorized official)

Office of Register of Deeds, County of Forest, I hereby certify that the within
instrument was filed in this office for record on the 15th day of June, 19 83
at 2:00 o'clock P. M.

Eugene Stutzman
(Register of Deeds)

DOCUMENT NO. **123604**

By _____ Deputy

Stock No. 26272

McMillan Company
Surveyors, Inc.

FORM 985

43413213000

State of Wisconsin }
County of FOREST } ss. ESTABLISHMENT OF QUARTER - QUARTER SECTION CORNER BETWEEN
ORIGINAL GOVERNMENT SURVEY CORNERS.

I NEAL SPERHAKE, do hereby certify that on the TWENTY-THIRD day of OCTOBER,
19 63, I established the NORTH ONE SIXTEENTH CORNER BETWEEN SECTIONS 21 & 22, TOWNSHIP 34
NORTH, RANGE 13 EAST, Fourth Principal Meridian,
as described hereon.

History: There is no record of this corner having been ever previously established.

Description of monument and accessories I established to perpetuate the location of this corner:

At the point determined for the location of the corner I emplaced a:
GALVANIZED IRON PIPE, THREE FEET LONG, ONE INCH IN DIAMETER, WITH ALUMINUM CAP DENOTED AS,
"KIMBERLY CLARK CORP. T34N N 1/16 BTWN. 21 & 22 R13E SPERHAKE RLS 463 10/23/63."

The pipe is witnessed by:
Spruce 3 S 56°E 36½ links. (SCRIBED S22 BT).

Description as to how corner was located: The section corner ¼ mile north and the quarter corner
¼ mile south have been previously established with a distance of 40.44
chains between them. Thus, set the N 1/16 corner 20.22 chains from either
corner and on a straight line between them.

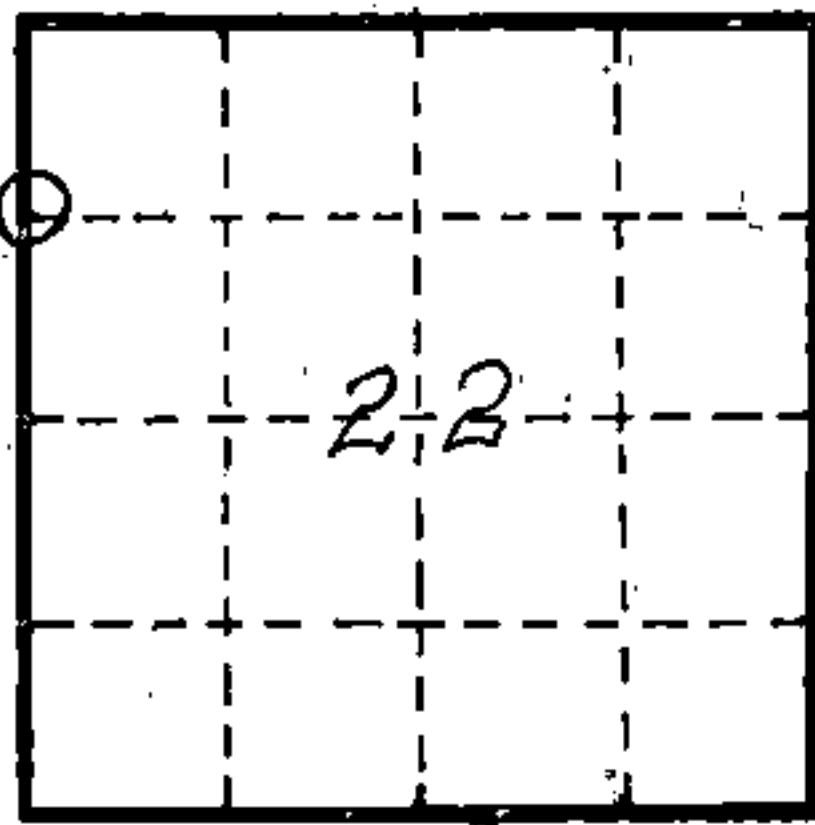

O = Corner monument
restored

Subscribed & sworn to before me this 25 day of Aug. 1964

Anna Peterson
~~XXXXXXXXXXXX~~,
NOTARY PUBLIC, FOREST CO., WIS
COM. EXPIRES 10/31/65

88991

Resident witnesses _____

Dated at Crandon, Wisconsin, this 25
day of Aug, 19 64.

Signature Neal Sperhake

Title Registered Land Surveyor Registration No. 463

Office of Reg. of Deeds County of Forest

I hereby certify that the within instrument was filed in this
office for record on the 25 day of Aug
19 64, and was filed in Book No. _____ Page No. _____
of County Records.

Surveyor's Seal

Signature Anna Peterson Title Reg. of Deeds

43413213000

Index No.

013