

# CERTIFIED LAND CORNER RESTORATION

Index No. J-7

State of Wisconsin } ss.  
County of Forest

I Philip T. Hansen, do hereby  
certify that on the 27th day  
of September, 1977, I ~~found~~  
established ~~existence of~~ the Quarter  
corner of Section 8 - 17  
Township 35, North, Range  
12 East, Fourth Principal Meridian,  
as described hereon; and that from this evidence  
I established a new monument and accessories  
as described hereon to perpetuate the original  
location of this corner.

Resident witnesses:

Glen Barker

Jim Claflin

Herb Wagoner

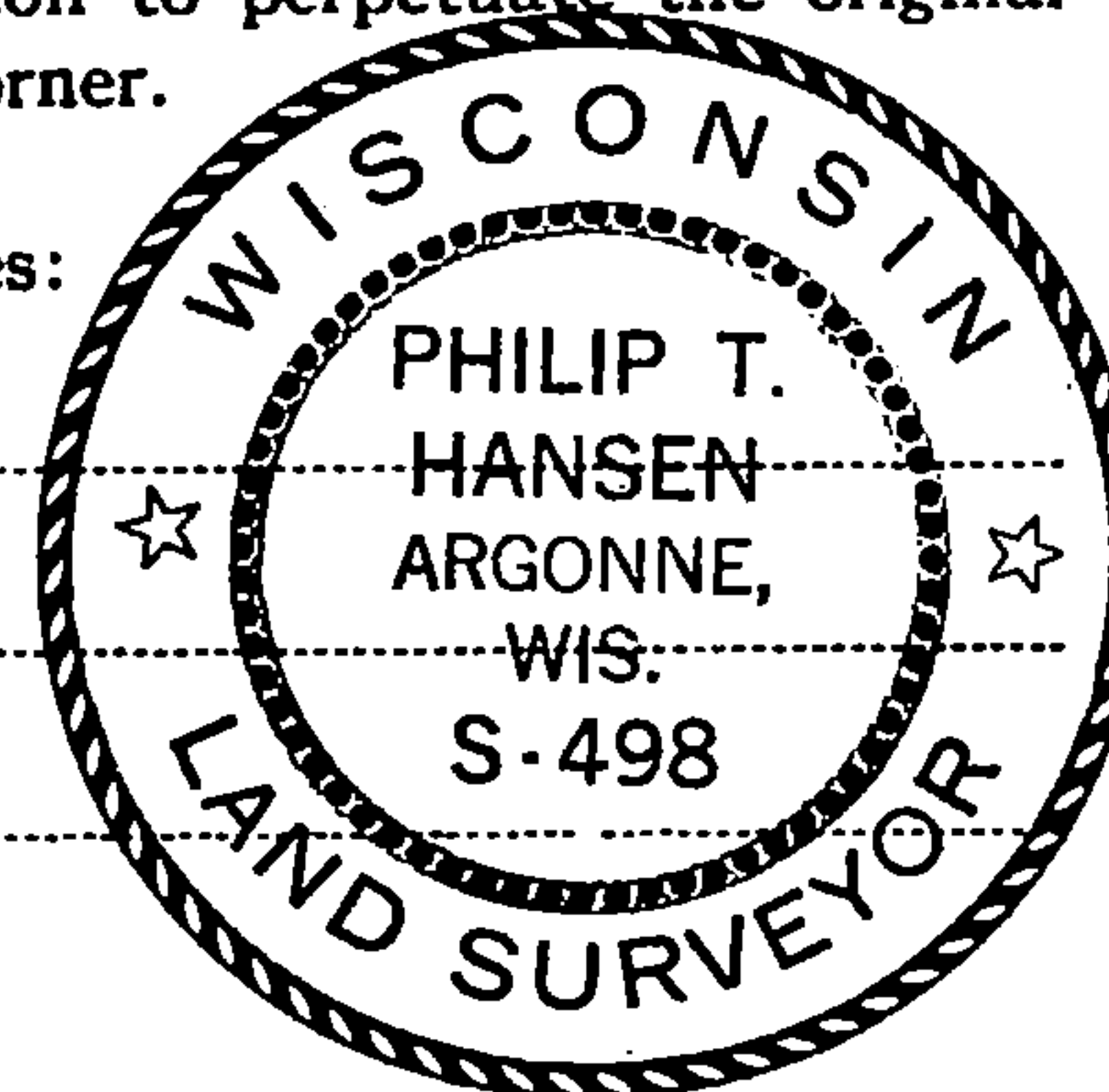

FORM 985 H. C. MILLER CO., MILWAUKEE

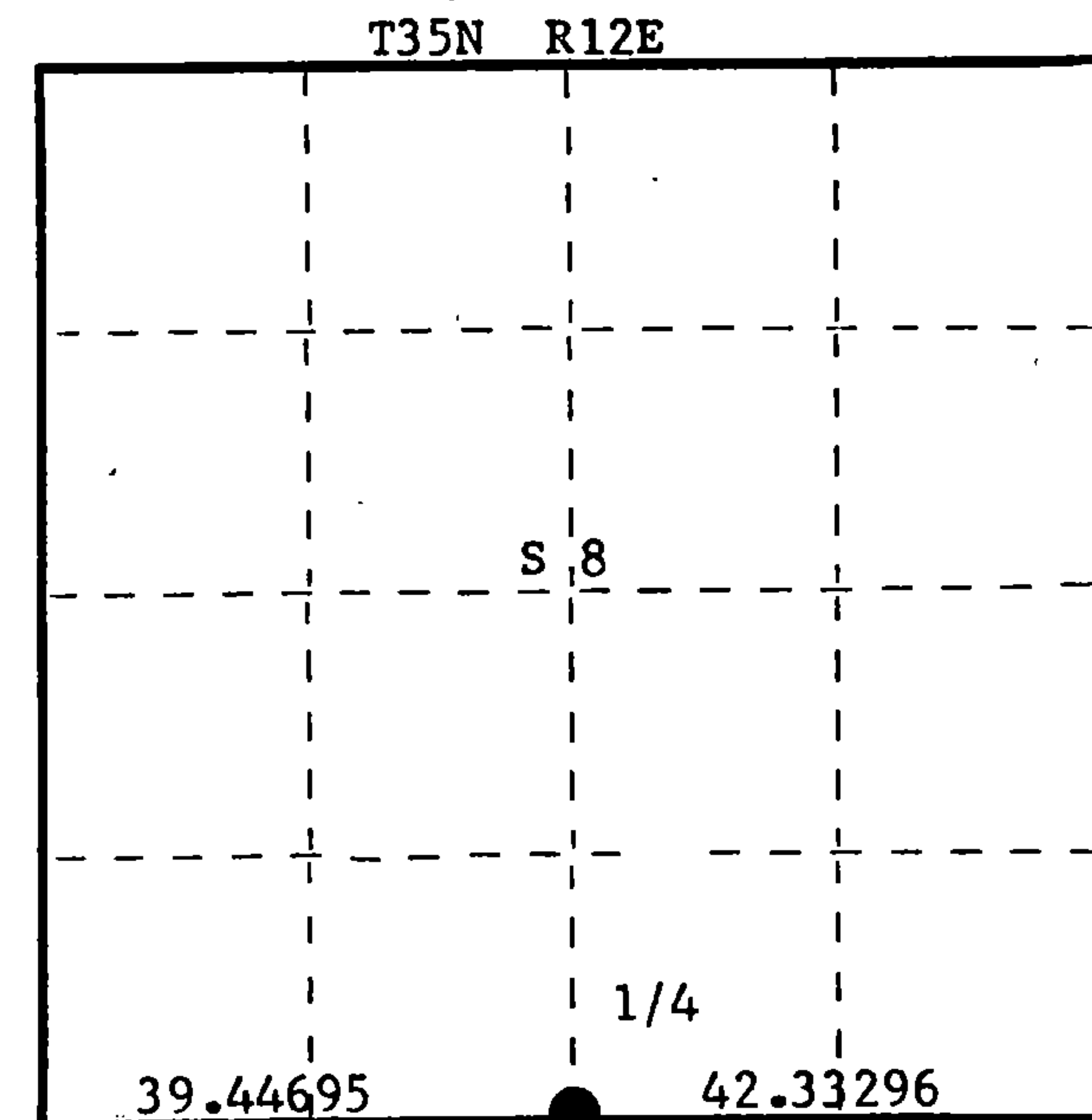

○ = Corner monument restored.

History of original corner establishment:

Original corner established by Hiram C. Fellows, Deputy Surveyor, in 1859, from which  
Sugar 15" bears S20°E, 20 links; Birch 12" bears N70°W, 75 links.  
No records of any subsequent survey.  
All evidence of original survey destroyed by road construction, County Trunk B.

Description of corner evidence found:

No evidence of corner recovered, old N-S fence line running north accepted as N-S 1/4 line.  
Accepted the intersection of the fence line with centerline of County Trunk B as the corner.  
Corner is S 87° 15' 44" E, 39.44695 chains from Section Corner 7, 8, 17 & 18 and S 89° 36' 46" W, 42.33926 chains from Section Corner 8, 9, 16 and 17.

Description of monument and accessories I established to perpetuate the original location of this corner.

Drove RR spike in blacktop road for true corner.

Set 2½" Berntsen A-1 Federal Monument for witness corner 60 links south.

Monument projects 1' above ground. Cap stamped:

Marked NBTs - Sugar 9" S41°E, 95.1 links

Sugar 7" S10°E, 116.3 links

Sugar 6" S46°W, 112.1 links, scribed 1/4 BT.

T35N R12E

1/4 S 8  
S 17 W.C.

S498 - 1977

N 60 lks. to Cor.

Dated at Rhineland, Wis., this 3rd day of October, 1977

Signature Philip T. Hansen Title Registered Land Surveyor Registration No. S-498  
(County Surveyor, Registered Land Surveyor, or other duly authorized official)

Office of Register of Deeds, County of Forest, I hereby certify that the within  
instrument was filed in this office for record on the 27th day of October, 1977  
at 2:45 o'clock P. M.

DOCUMENT NUMBER

**112524**

Eugene Staszny  
(Register of Deeds)

By \_\_\_\_\_ Deputy

43512080020