

CERTIFIED LAND CORNER RESTORATION

Index No. **V-18**

State of Wisconsin }
County of Forest } ss.

History of original corner establishment:
No evidence of any previous corner.

I Glen Barker, do hereby
certify that on the 28th day
of March, 19 83, I ~~found~~ found estab.
~~evidence of the~~ W 1/16
corner of Sections 26 & 35
Township 35, North, Range
13 East, Fourth Principal Meridian,
as described hereon; and that from this evidence
I established a new monument and accessories
as described hereon to perpetuate the original
location of this corner.

Resident witnesses:

J. Claflin

H. Wagoner

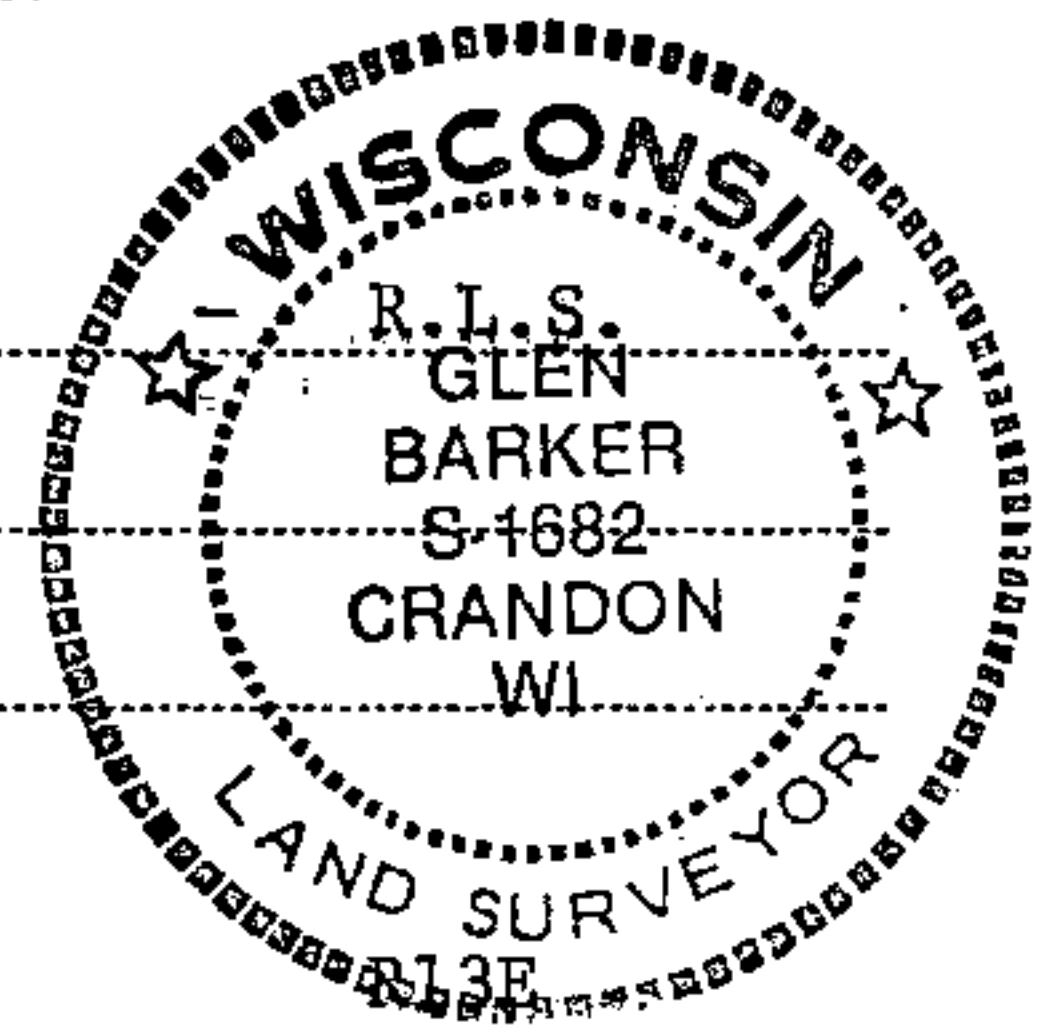

Description of corner evidence found:

Total distance from 1/4 corner between sections 26 & 35 to Section corner
26-27-34-35 is 2623.86 ft.
Set W 1/16 1311.93 intermediate.

Description of monument and accessories I established to perpetuate the original location of this corner.

Set a 1" iron pipe with 2" diameter alloy cap stamped:

Monument projects 18" above ground.

Marked NBTs

Sugar 6" S45E 10.80 ft.
Sugar 5" S52W 29.58 ft.
Scribed 1/16 - B.T.

S1682

T35N R13E

S 26

S 35

CPI - 1983

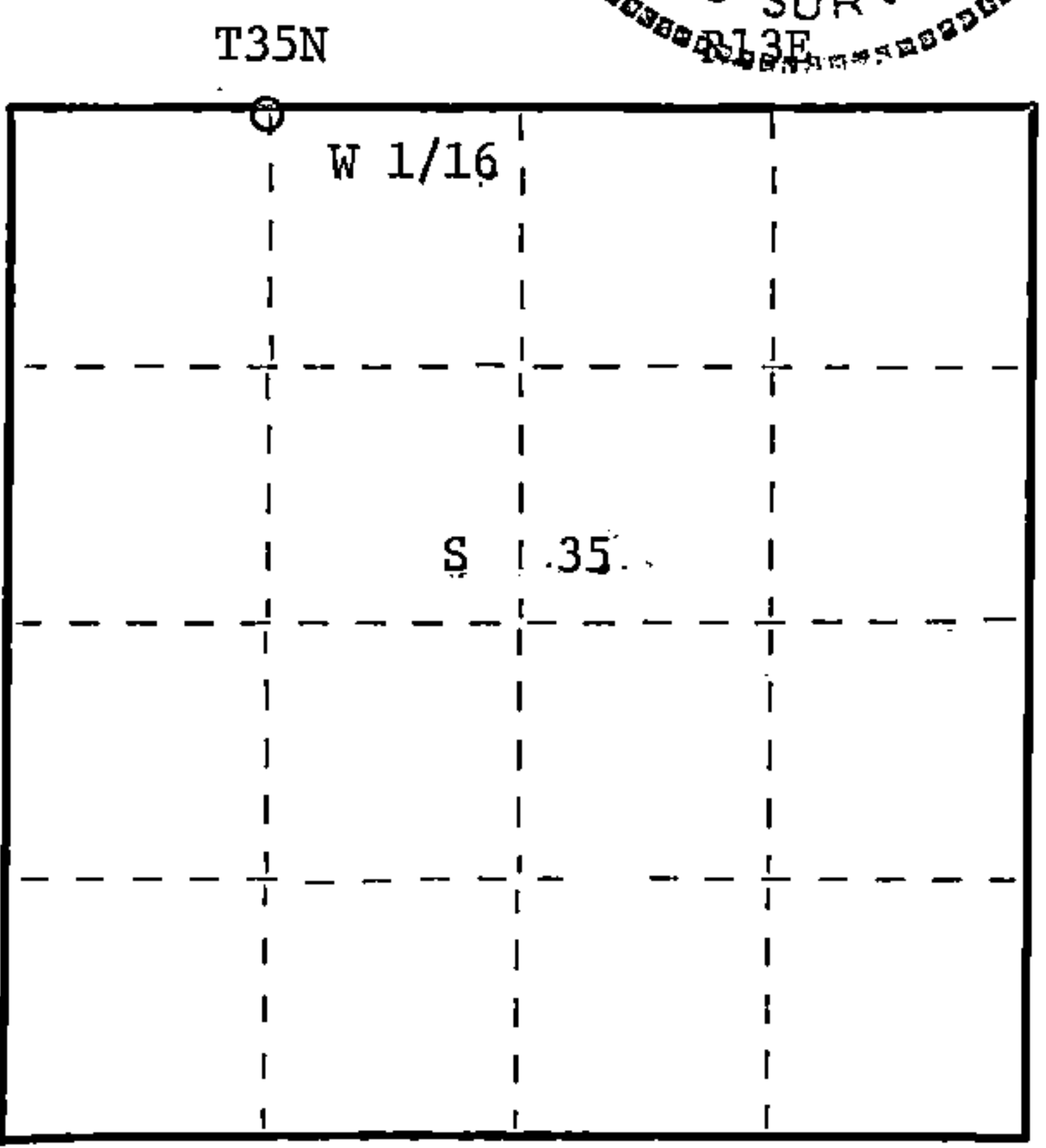

○ = Corner monument restored.

Dated at Rhineland, Wis., this 6th day of May, 19 83.

Signature Glen Barker Title Registered Land Surveyor Registration No. S1682
(County Surveyor, Registered Land Surveyor, or other duly authorized official)

Office of Register of Deeds, County of Forest, I hereby certify that the within
instrument was filed in this office for record on the 19th day of May, 1983
at 3:00 o'clock P. M.

Eugene Stetson
(Register of Deeds)
By _____ Deputy

DOCUMENT NO.
123412

Stock No. 26272
FORM 985
H.C. Miller Company
Register of Deeds

43513 260030