

FORM 985 H.C. Miller Company Stock No. 26272

State of Wisconsin }
County of Forest } ss.

I Glen Barker, do hereby
certify that on the 18th day
of November, 1982, I ~~found~~
evidence of the C 1/4
corner of Section 28
Township 35, North, Range
13 East, Fourth Principal Meridian,
as described hereon; and that from this evidence
I established a new monument and accessories
as described hereon to perpetuate the original
location of this corner.

Resident witnesses:

J. Claflin, Reg. ~~Land~~ Surveyor

H. Wagoner

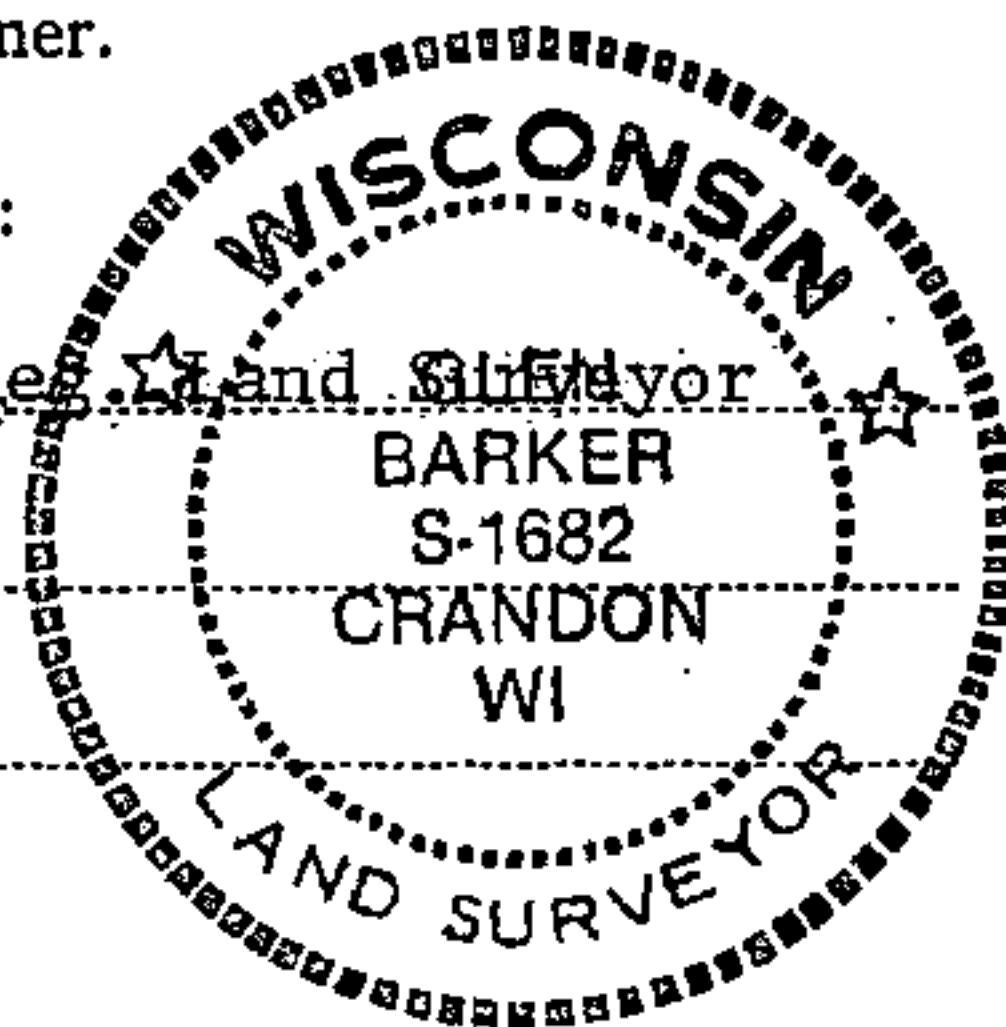

T35N R13E

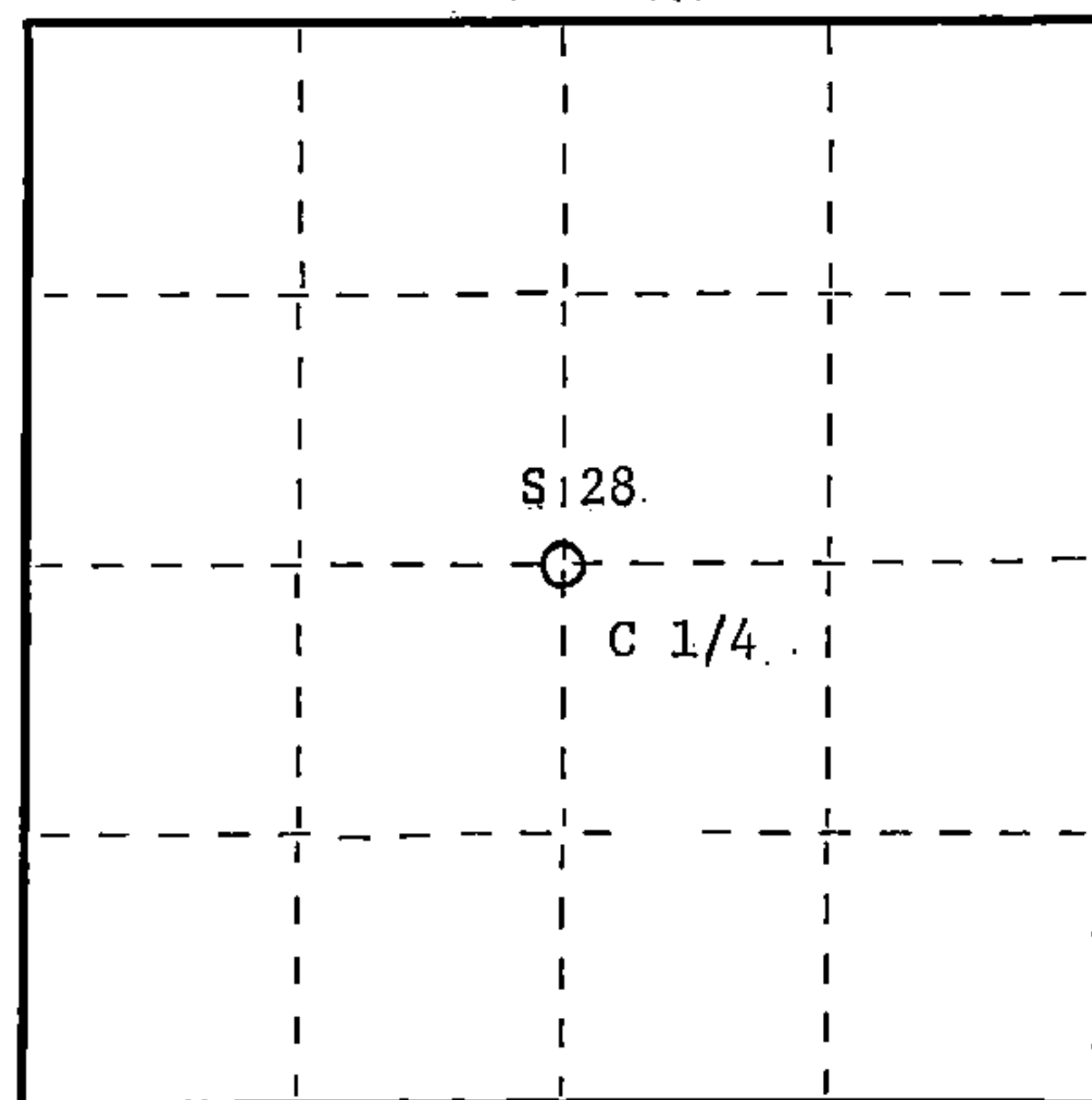

○ = Corner monument restored.

CERTIFIED LAND CORNER RESTORATION

Index No. T-11

TIT

History of original corner establishment:

No record of any previous corner.
Someone's approximate C 1/4 hardwood stake bears N 10E 52.0 feet from our position.

Description of corner evidence found:

Corner established by subdivision of section 28.
Corner sets S 0-02-41 W 2709.02 feet of N 1/4 corner,
N 88-21-52 W 2605.59 feet of E 1/4 corner,
N 0-02-41 E 2640.74 feet of S 1/4 corner,
and S 88-21-52 E 2750.34 feet of W 1/4 corner.

Description of monument and accessories I established to perpetuate the original location of this corner.

Set a 2-1/2" aluminum A-1 Federal Monument with cap - stamped:
Monument projects 18" above ground.

Marked NBT's:

Sugar 5" S54E 13.62 feet)
Sugar 5" N23E 25.20 feet) C 1/4-B.T.
Sugar 4" N23W 40.25 feet B.T.

T35N R13E
C 1/4 S 1/28
S1682-1982

Dated at Rhinelander, Wis., this 21st day of March, 19 83.

Signature *Glen Barker* Title Registered Land Surveyor Registration No. S-1682
(County Surveyor, Registered Land Surveyor, or other duly authorized official)

Office of Register of Deeds, County of Forest, I hereby certify that the within
instrument was filed in this office for record on the 7th day of April, 19 83.
at 9:30 o'clock A. M.

Eugene Stegny
(Register of Deeds)

By Deputy

DOCUMENT NO. 123149

43513282020