

86983

ESTABLISHMENT OF QUARTER - QUARTER SECTION CORNER BETWEEN ORIGINAL GOVERNMENT SURVEY CORNERS

Index No.

124

220

STATE OF WISCONSIN

County of FOREST

I NEAL SPERHAKE, do hereby
 certify that on the TWELFTH day
 of DECEMBER, 1962, I established
 the EAST ONE SIXTEEN CORNER
BETWEEN SECTIONS 2, TOWNSHIP 34
NORTH, RANGE 13 EAST, AND, 35,
TOWNSHIP 35 NORTH, RANGE 13 EAST,
 Fourth Principal Meridian, as
 described hereon.

Resident Witnesses:

Richard Piontek - Waubeno.

R13E

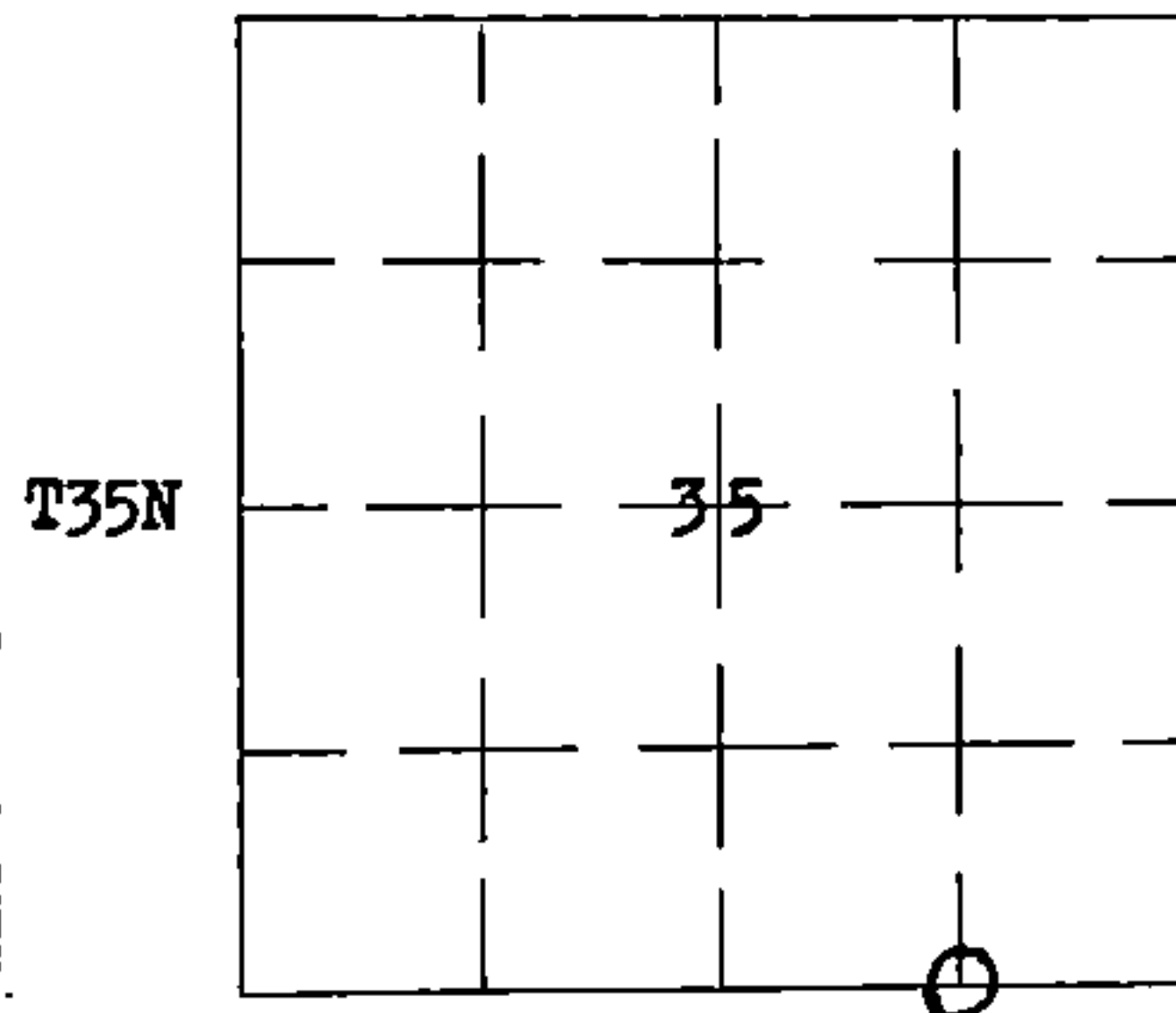

O = Corner monument established

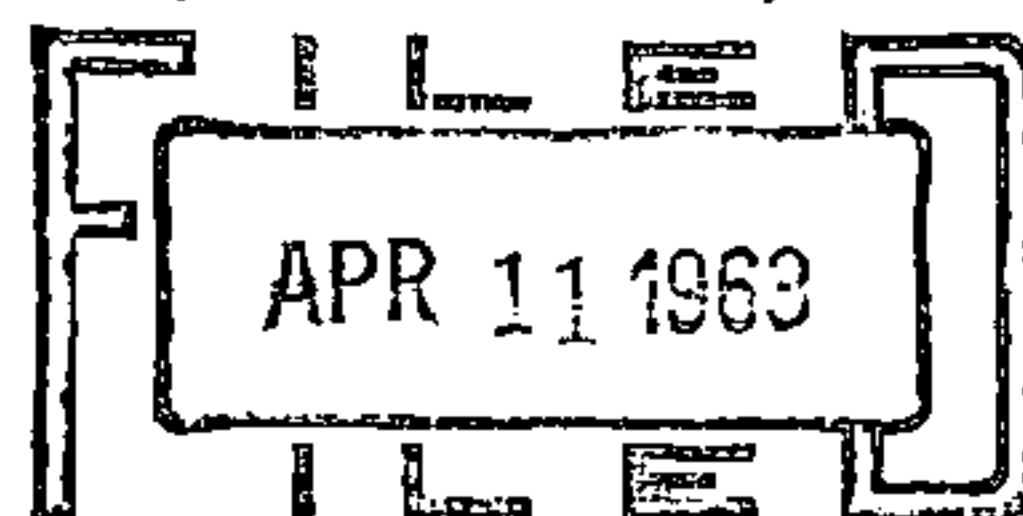
REGISTER'S OFFICE
FOREST COUNTY, WIS.

At 2 o'clock P.
Karl A. Anger Register of Deeds
sp.

This corner can also be described as either the "EAST 1/8 TH, OR, THE EAST QUARTER - QUARTER
 SECTION CORNER BETWEEN SECTIONS 2, T34N-R13E,
 AND, 35, T35N-R13E, 4TH P.M.

History:

There is no record of this corner having ever been previously established.

Description of monument and accessories I established to perpetuate the location of this corner:

At the point determined for the location of the corner I emplaced a:

"GALVANIZED IRON PIPE, THREE FEET LONG, ONE INCH IN DIAMETER, WITH AN ALUMINUM CAP DENOTED AS,
 'KIMBERLY-CLARK CORP T34-35N E 1/16 BTWN 2 & 35 R13E SPERHAKE RLS 463 12-12-62".

The pipe is witnessed by:

W. Birch 7 N12°E 9½ links. (Scribed S35 BT).
 W. Birch 6 S12°E 34 links. (Scribed S 2 BT).

Description as to how corner was located:

Since both the quarter section corner one quarter mile west, and the section corner one
 quarter mile east have been previously established, with a distance between them of
 40.01½ chains, the 1/16th corner was set 20.00 ¾ chains from either corner, on a
 straight line between them.

Dated at Crandon Wis., this 11th day of April, 19 63Signature Neal Sperhake Title Registered Land Surveyor Registration No. S-463

~~Office of Register of Deeds~~, County of Forest I hereby certify that the within
 signed and sworn to
 instrument was ~~filed in this office for record~~ on the 11th day of April, 19 63

at 2 o'clock P.

Adeline DeNoble
 Notary ~~(Register of Deeds)~~ Public
 Forest County, Wisconsin
 By My commission expires February 6, 1966 ~~Deputy~~

My Commission Expires
 February 6, 1966

Surveyor's Seal

43513350010

CERTIFIED LAND CORNER RESTORATION

Index No. **7-20**

State of Wisconsin }
County of Forest } ss.

I, Glen Barker, do hereby
certify that on the 28th day
of April, 1983, I ~~found~~
~~relocated~~ established E 1/16
corner of Sections 2 & 35
Township 34 & 35, North, Range
13 East, Fourth Principal Meridian,
as described hereon; and that from this evidence
I established a new monument and accessories
as described hereon to perpetuate the original
location of this corner.

Resident witnesses:

Jim Clafflin

H. Wagoner

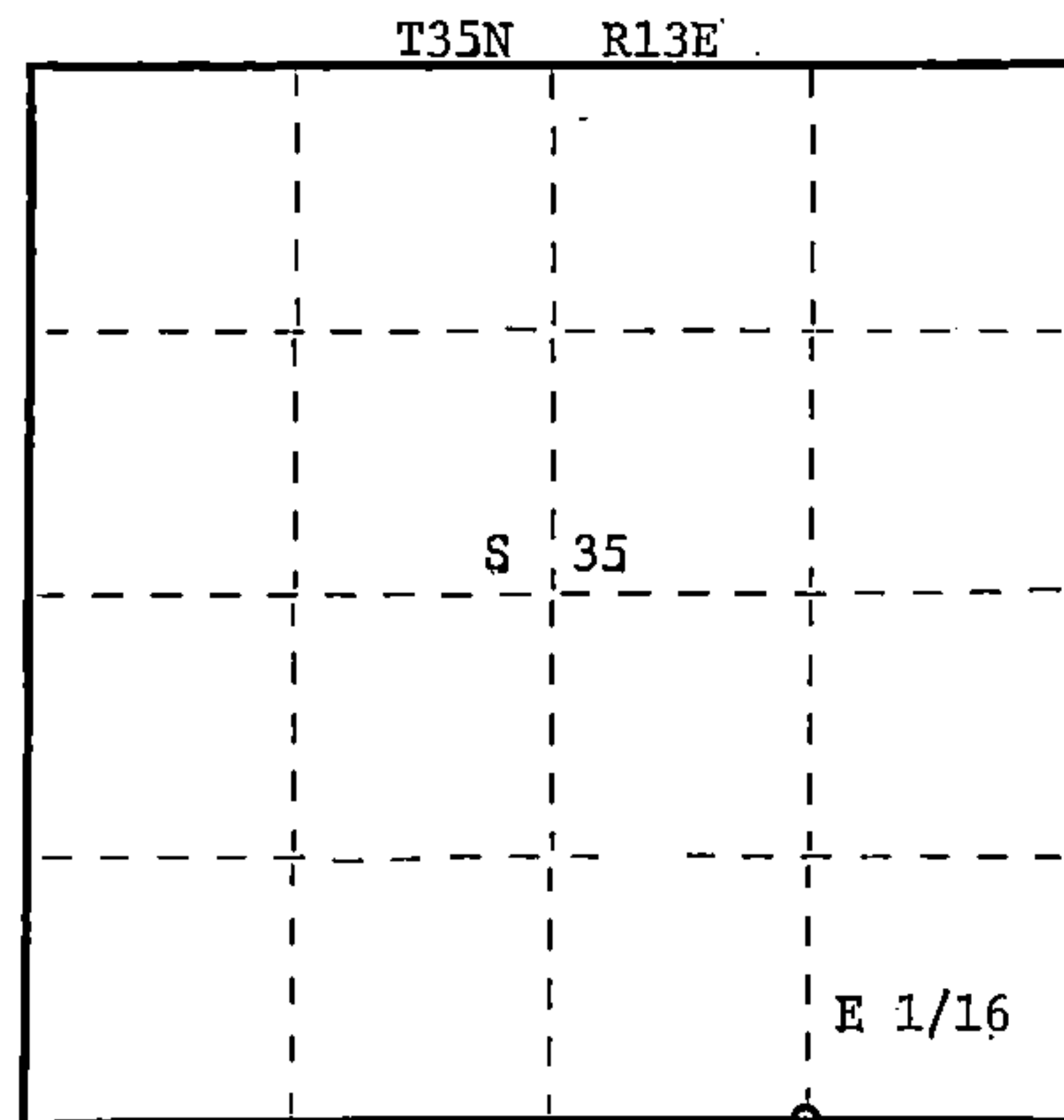
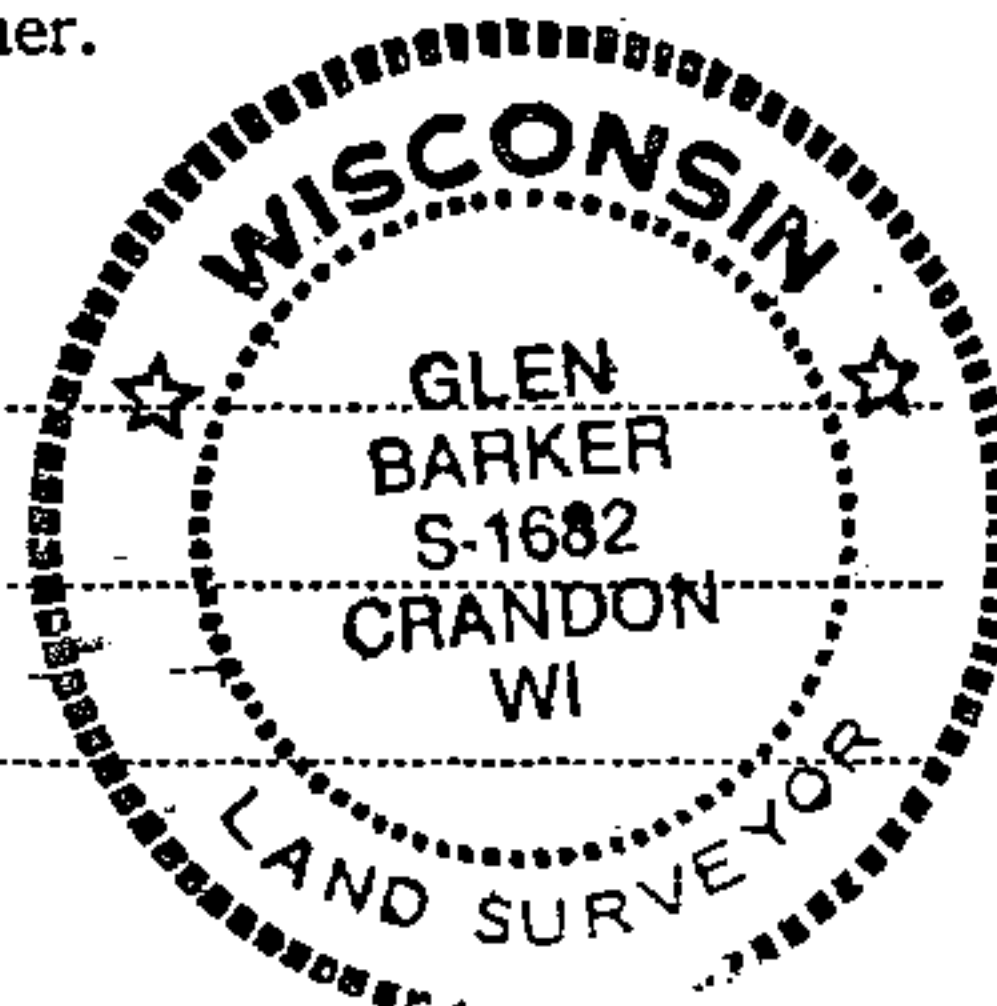

○ = Corner monument restored.

History of original corner establishment:

Neal Sperhake established corner in 1964.

Description of corner evidence found:

Total distance from section corner 1-2-35-36 T34&35N R13E to 1/4 corner between
sections 2 and 35 is 2632.00 feet.
Set E 1/16 1316.00 feet intermediate.
Sperhake's monument bears N75°E 3.02 feet of our position.

Description of monument and accessories I established to perpetuate the original location of this corner.

Set a 1" iron pipe with 2" diameter alloy cap, stamped:
Monument projects 18" above ground.
Marked NBT's:

Sugar 6" S46E 25.28 feet
Maple 5" N8E 18.85 feet
scribed 1/16 B.T.

S1682
T35N R13E
E 1/16 S 35
S 2
T34N R13E
CPI - 1983

Dated at Rhineland, Wis., this 30th day of June, 1983.

Signature Glen Barker Title Registered Land Surveyor Registration No. S-1682
(County Surveyor, Registered Land Surveyor, or other duly authorized official)

Office of Register of Deeds, County of Forest, I hereby certify that the within
instrument was filed in this office for record on the 26th day of July, 1983
at 11:55 o'clock A. M.

Eugene Stutzman
(Register of Deeds)
By _____ Deputy

DOCUMENT NO. **123863**

Stock No. 26272

FORM 985

43513350010