

CERTIFIED LAND CORNER RESTORATION

State of Wisconsin

County of Forest

ss.

I Jean F. Resvick, do hereby certify that on the 22nd day of July, 1969, I found evidence of the East quarter corner of Section 1 Township 35 North, Range 16 East, Fourth Principal Meridian, as described hereon; and that from this evidence I established a new ~~monument~~ and accessories as described hereon to perpetuate the ~~original~~ location of this corner:

Description of original monument and accessories and subsequent restorations:

Surveyed in 1857 by Artemas Curtis.

Set wood post.

Sugar 18, bears N79W, 48 lks.

Elm 12, bears S42E, 36 lks.

Survey for Marinette County by J.J. Jenkins, Menominee County Surveyor, in Dec. 1934 and Jan. 1935 and recorded in Marinette County.

Set 4 inch iron post for the quarter corner between sections 1 and 6.

Description of corner evidence found:

Found 4 inch diameter iron post with brass cap marked:

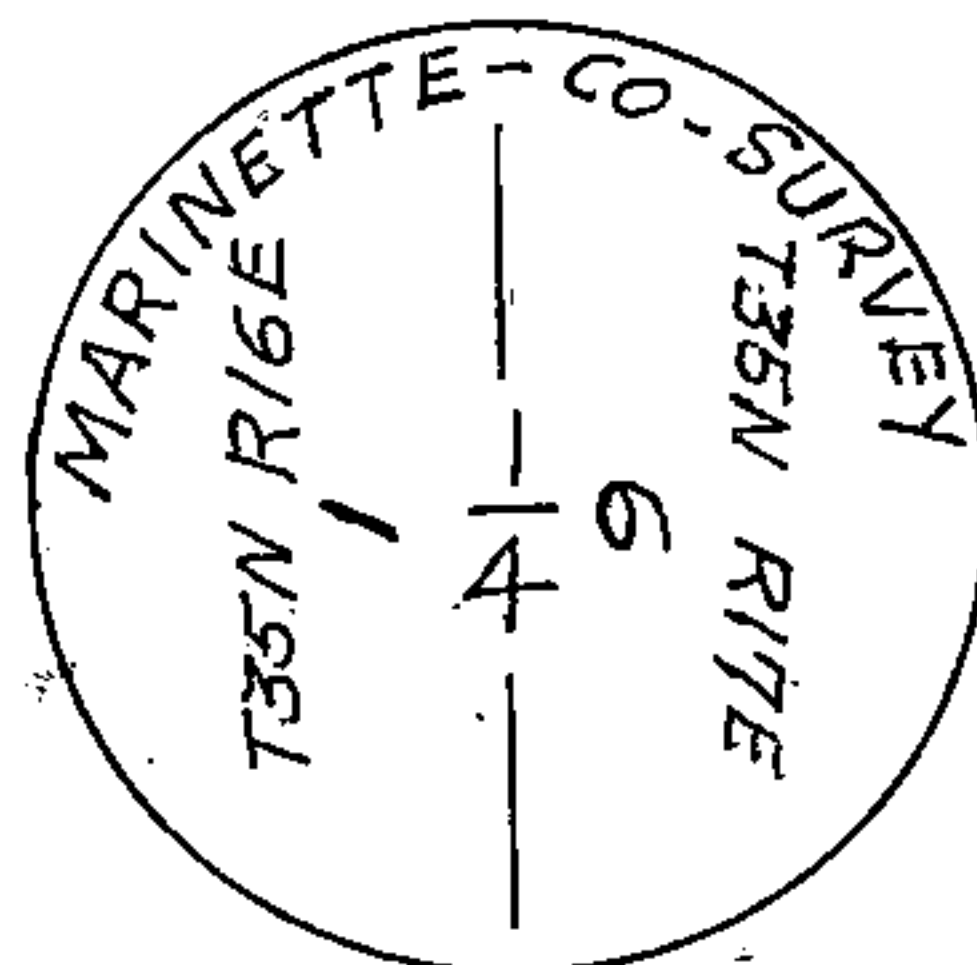
Description of ~~monument~~ accessories I established to perpetuate the ~~original~~ location of this corner:

Blazed and scribed the following new bearing trees.

Maple 7, bears S56E, 21.12 ft. or 32.000 lks.

Maple 10, bears S32W, 10.83 ft. or 16.409 lks.

Maple 15, bears N49W, 35.32 ft. or 53.515 lks.

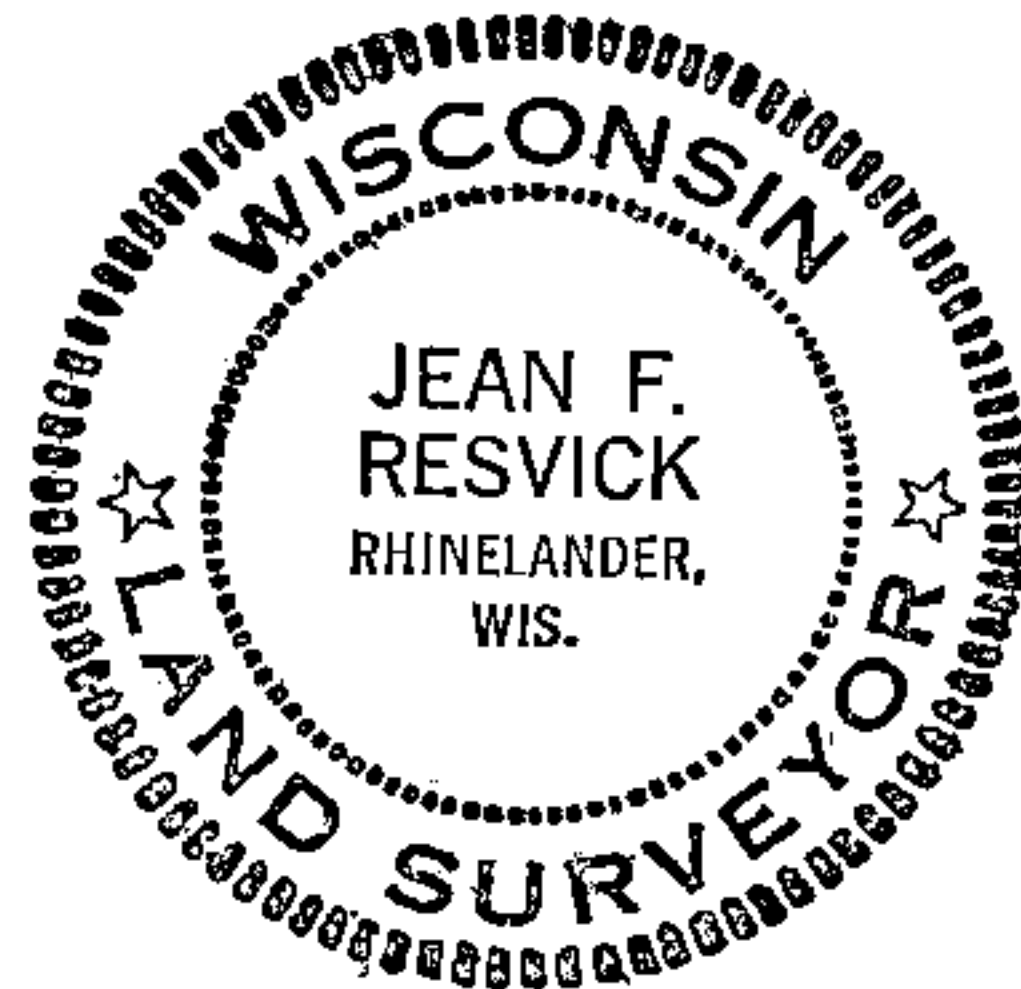

43516012000

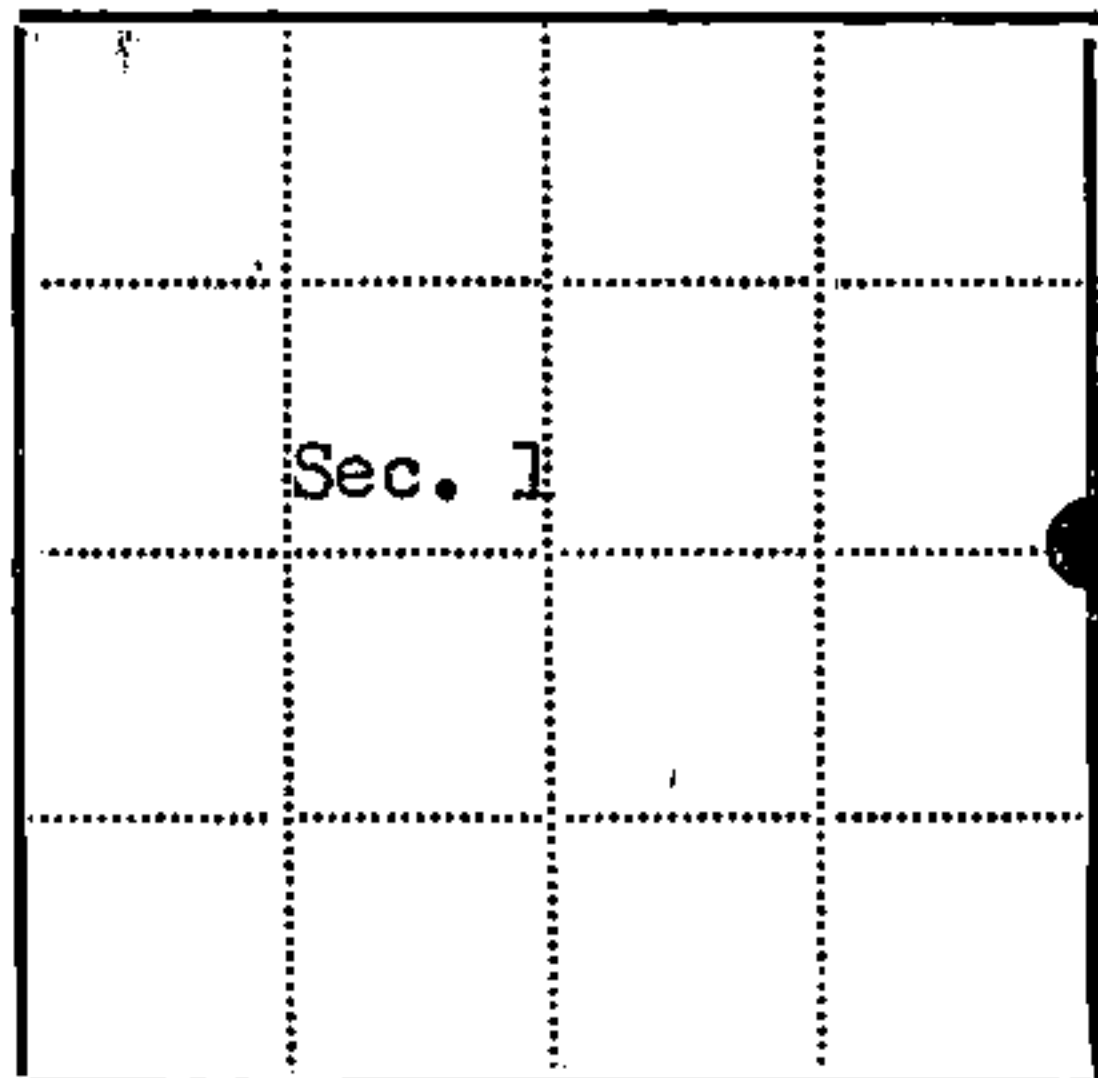

● = Corner monument restored

□ =

Resident witnesses.....

Dated at Rhinelanders Wisconsin, this 30th day of July 1969.

Signature *Jean F. Resvick* Title Cadastral surveyor
(County Surveyor, Registered Land Surveyor, or other duly authorized official)

Surveyors Registration No. S-802 DOCUMENT NO. 98044

Office of Register of Deeds County of Forest

I hereby certify that the within instrument was filed in this office for record on the 22nd day of May 1970, and was filed in Book No. Page No. C-25 of County Records.

Signature *Eugene Stutzman* Title Register of Deeds

Township 35 North, Range 16 East, Section 1, Index No. C-25, Page No.

C 25

U. S. PUBLIC LAND SURVEY MONUMENT RECORD

INSTRUCTIONS:

This record shall show the location of the corner and shall include all of the following nine elements (a through i).

- (a) Identify the corner by reference to the U.S. public land survey system.

⊙ = Corner monument restored.

Quarter Corner to Sections 1-6, T.35N., R.16-17E., Forest-Marquette Counties, Wisconsin.

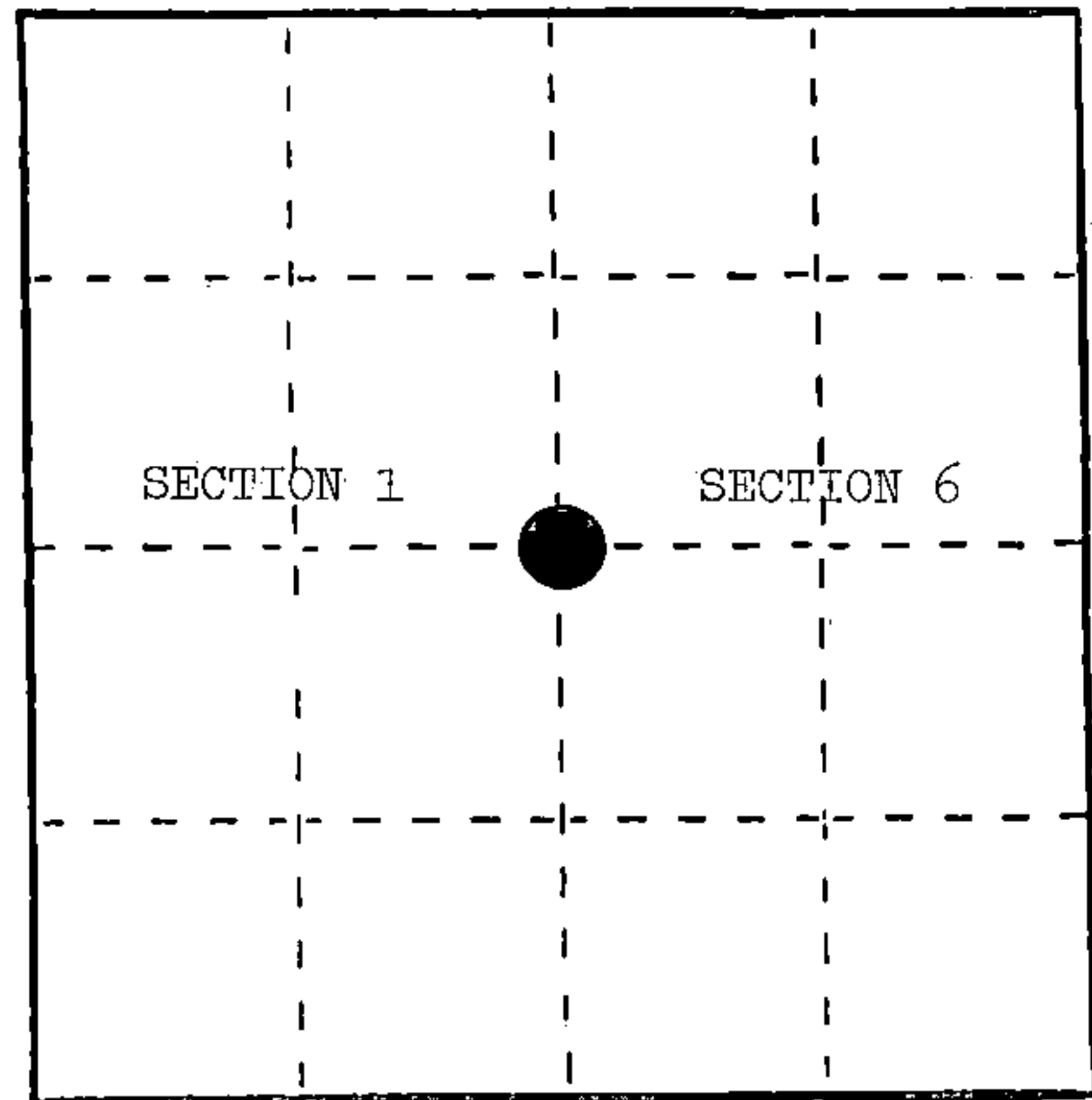

- (b) Describe any record evidence, monument evidence, occupational evidence, testimonial evidence or any other material evidence you considered, and whether the monument was found or placed.

In 1857, Artemas Curtis set a wood post with the following BTs: Sugar, 18", N.79°W., 48 links; Elm, 12", S.42°E., 36 links.

In 1927, Goodman Lumber Company found an Elm post believed set by Wells Company surveyors. They set a 3" Maple post and a 2" flue pipe 20" high.

In 1934-35, J. J. Jenkins, Menominee County Surveyor, while surveying the east boundary of T.35N., R.16E., set a 4" iron pipe with brass cap stamped to identify the corner.

In 1969, J. Resvick (RLS) found Jenkins' County monument. He mounded rock around monument and added the following BTs: Maple, 7", S.56°E., 21.12 feet; Maple, 10", S.32°W., 10.83 feet; Maple, 15", N.49°W., 35.32 feet.

In 1987, A. Harrison (RLS) found monument and accessories as per Resvick. He repainted the BTs and added a steel sign post which bears south, 1.33 feet from corner.

- (c) In the plan view drawing below, provide reference ties to at least 4 witness monuments, or, if the location is within a municipality, to at least 2 witness monuments. (Witness monuments shall be made of concrete, natural stone, iron or other equally durable material.) Describe witness monuments.

- (d) Show a plan view drawing depicting the relevant monuments and reference ties which is sufficient in detail to enable accurate relocation of the corner monument if the corner monument is disturbed. Indicate north.

1. Marinette County monument stamped to identify the corner.
2. Maple, 7", S.56°E., 21.12 feet
3. Maple, 10", S.32°W., 10.83 feet
4. Maple, 15", N.49°W., 35.32 feet
5. Steel Sign Post, South, 1.33 feet

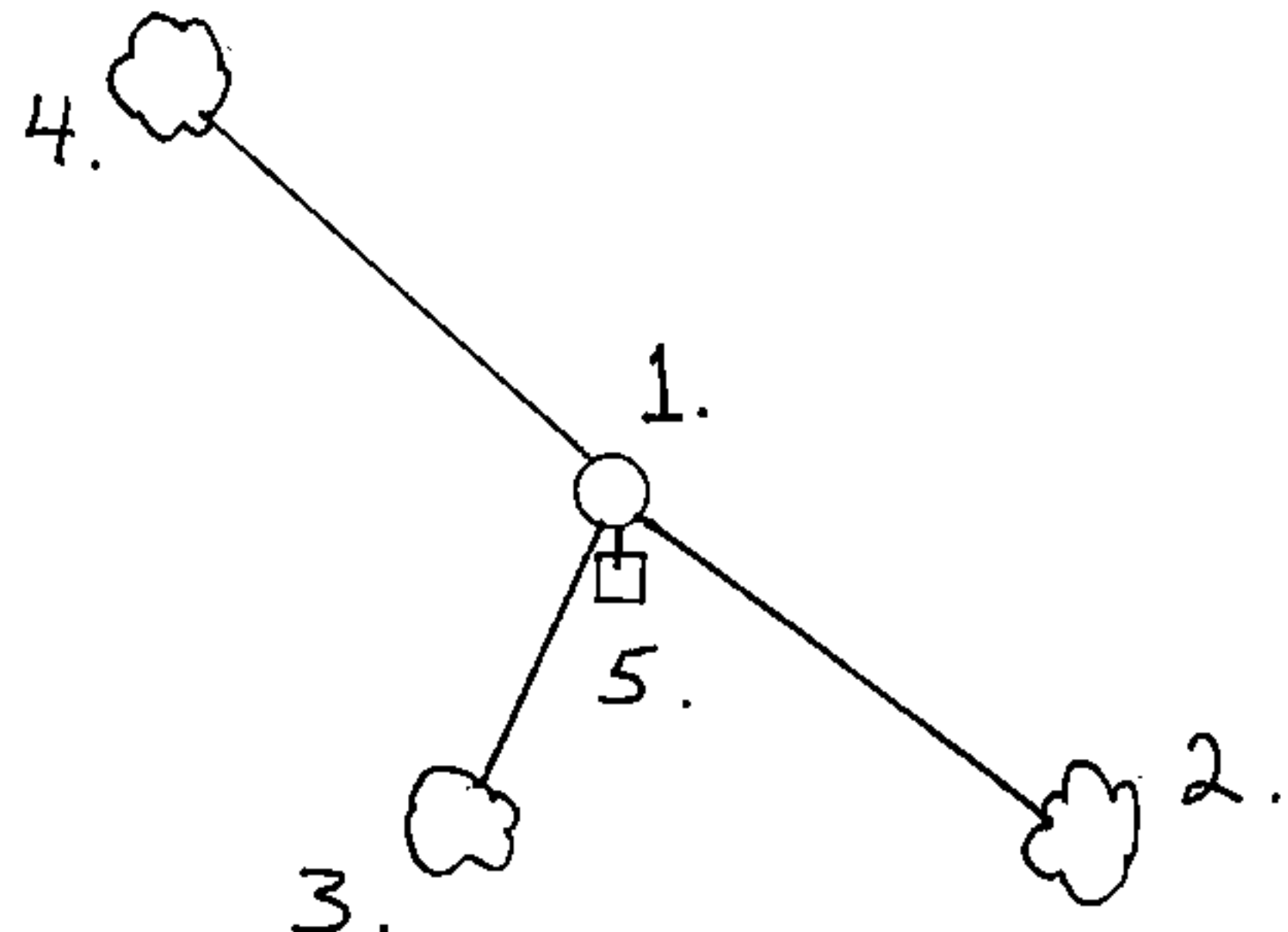

(e) Describe any material discrepancy between the location of the corner as restored or reestablished and the location of that corner as previously restored or reestablished by distance and direction. Show the discrepancy on the plan view drawing under (d), above. Show the distances between the corner as previously restored or reestablished and (1) the corner as restored or reestablished, and (2) to at least 2 of the witness monuments shown on the drawing in (d), above.

None.

(f) Was the corner restored through acceptance of (1) an obliterated evidence location, or, (2) a found perpetuated location?

(2) a found perpetuated location.

(g&h) Was the corner reestablished through lost corner proportionate methods? If so, show the method, including the directions and distances to other public land survey corners used as evidence or used for proportioning in determining the corner location?

No.

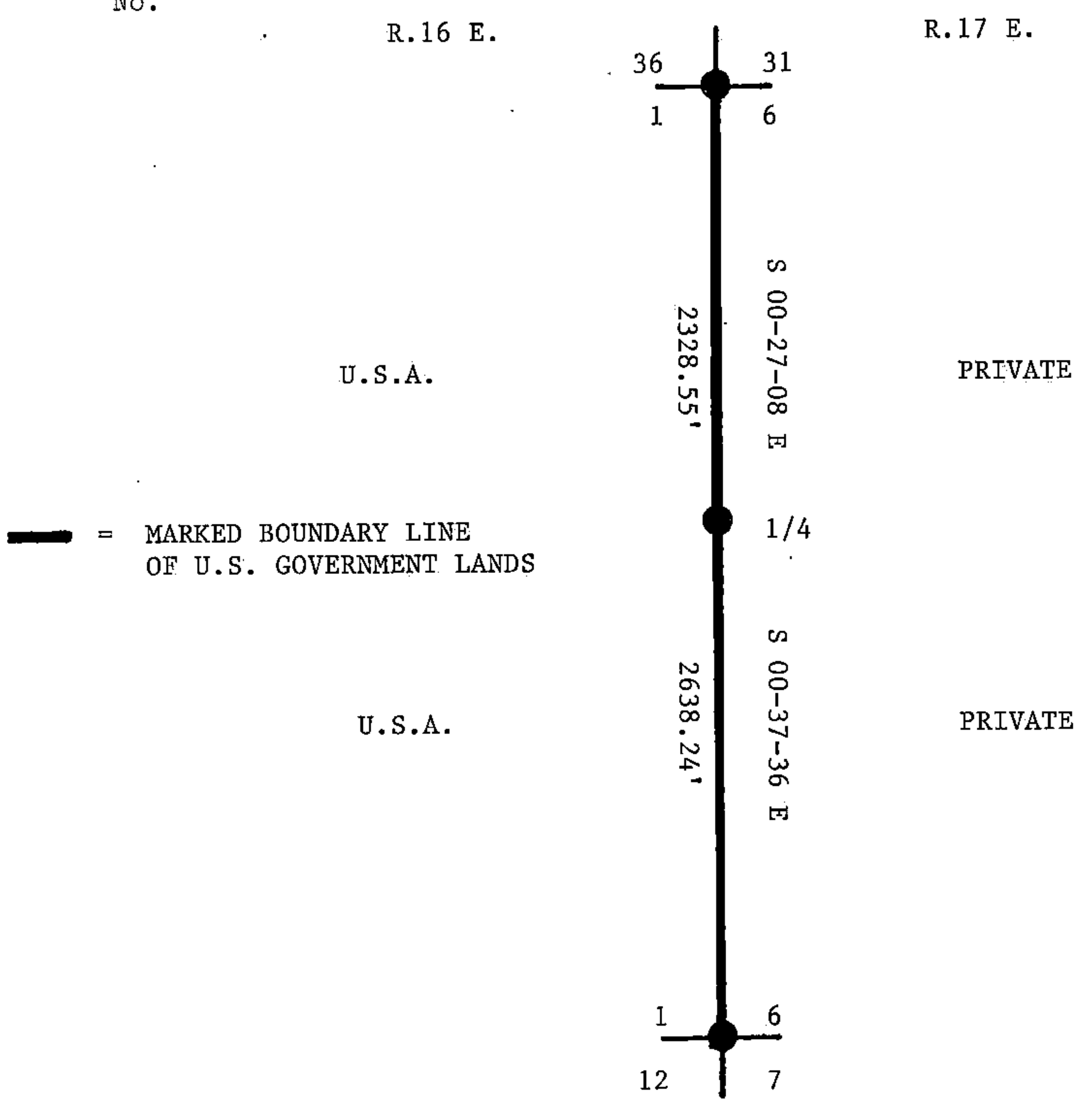

(i) I, Alan D. Harrison
(type or print name) certify that the corner location shown on this record was determined by me or under my direction and control and that this U.S. Public Land Survey Monument Record is correct and complete to the best of my knowledge and belief.

Alan D. Harrison 2/20/90
Signature Date

Certificate ready for filing: Dale S. Stagg
District Ranger

