

U. S. PUBLIC LAND SURVEY MONUMENT RECORD

INDEX NO. J-3

1/4 Corner to Section 18 7 T35N, R16E
(Section/Quarter)

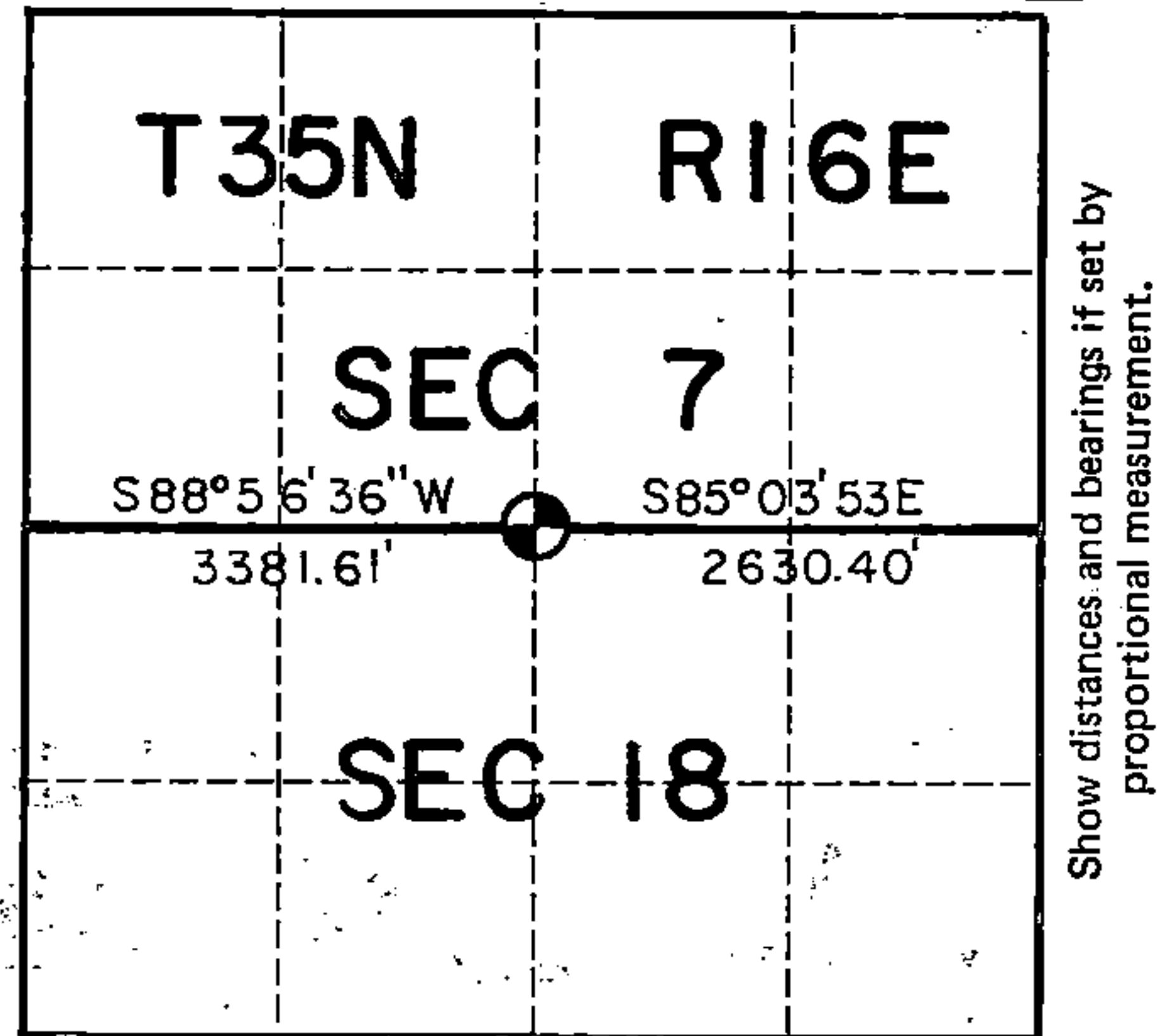

Show distances and bearings if set by proportional measurement.

○ = Corner monument restored.



Set a PK nail at the corner position with a 2"x 36" aluminum post stamped Reference Monument North 25.00 ft.
Ties are to
aluminum nails
driven into tree
centers which
trees were blazed
and scribed.

- | | | |
|-------|-------|--------|
| 1-2 = | North | 25.00' |
| 1-3 = | S12°E | 78.14' |
| 1-4 = | S52°W | 92.80' |
| 1-5 = | N18°W | 53.92' |
| 1-6 = | North | 25.70' |

⊙ = Set 2"x36" Aluminum reference monument

△ = Set P.K. nail

Certificate Ready For Filing:

Ralph H. Bell
District Ranger

History of original corner establishment, record evidence, monument evidence, occupational evidence, testimonial evidence or any other material evidence, and what you found and how the monument was set.

In 1858 James McBride set this corner at 40 chains west of his southeast corner of section 7 and marked the following bearing trees:

Spruce	10"	S15E	17
Cedar	10"	N14W	38

Located a road centerline and PI at this corner location. All other evidence of this corner location had been destroyed with road construction. John Hammes filed a CCC tag noting this corner to fall 2,941 ft east of Connors railroad. Using the present road centerline as control, I set this corner at proportionate distance between the two section corners already recovered. This position fit the distance recorded by Hammes, the swamp call to the west, and the road PI the best within a half of a chain. Using any one of these bits of record ties to the corner would have placed the other record over a chain out of place.

In the plan view drawing below, provide reference ties to at least 4 witness monuments, or, if the location is within a municipality, to at least 2 witness monuments. (Witness monuments shall be made of concrete, natural stone, iron or other equally durable material, except wood other than bearing trees.) Also, show any material discrepancies between the corner restored or re-established and the location of any other previous corner location or occupation.

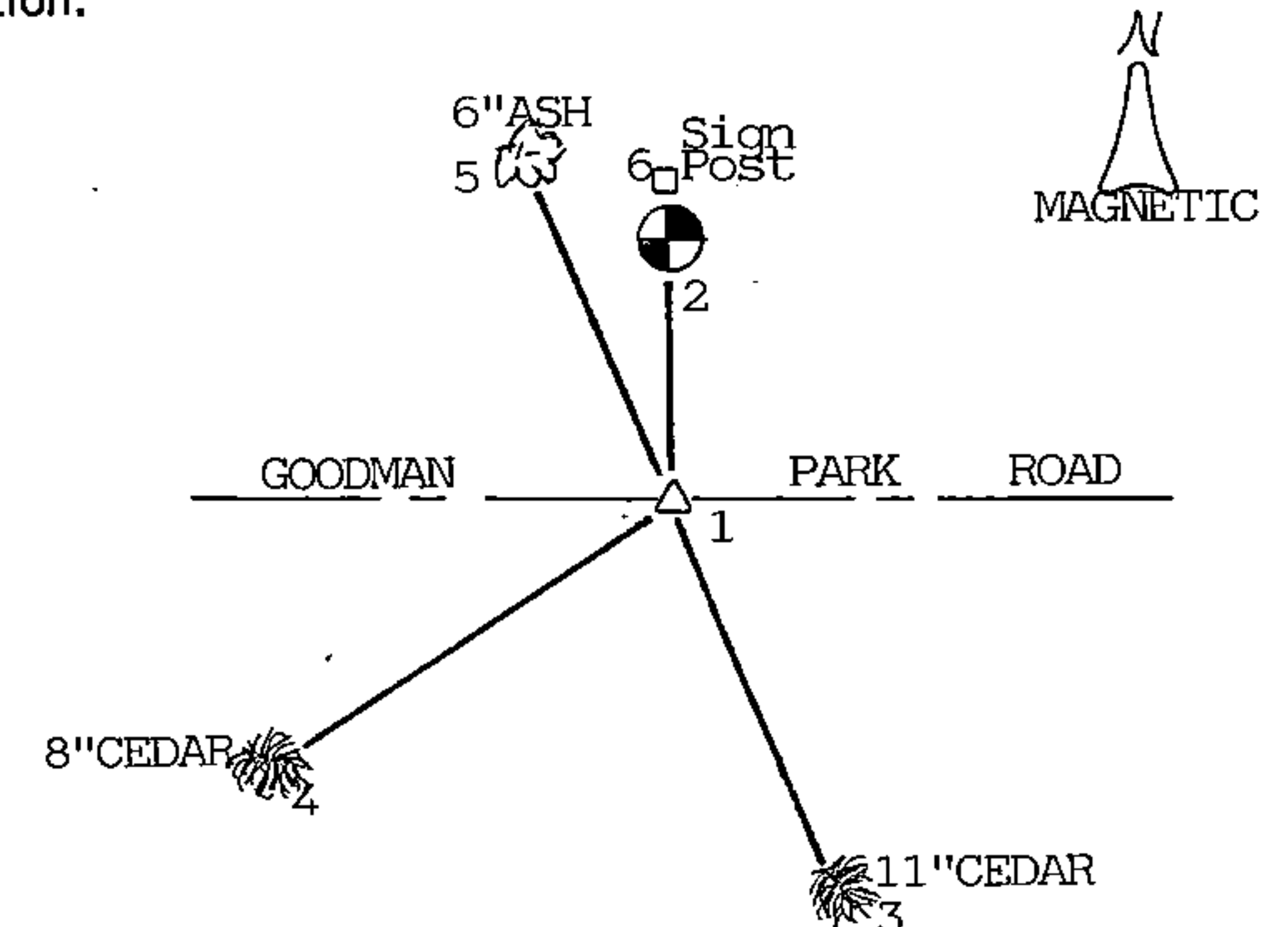

I, Kim H Pritzlaff, RLS No. 1259
(Type or print name) certify that the corner location shown on this record was determined by me or under my direction and control and that this U.S. Public Land Survey Monument Record is correct and complete to the best of my knowledge and belief.

Kim Pritzlaff
Signature
1993
Date

149052

43516070020

INDEX NO. _____

MAINTENANCE RECORD

Condition of Monument _____

Condition of Ties _____

New Ties, if any:

Date

Signature

Condition of Monument _____

Condition of Ties _____

New Ties, if any:

Date

Signature

Condition of Monument _____

Condition of Ties _____

New Ties, if any:

Date

Signature

REGISTER'S OFFICE
FOREST COUNTY, WIS.

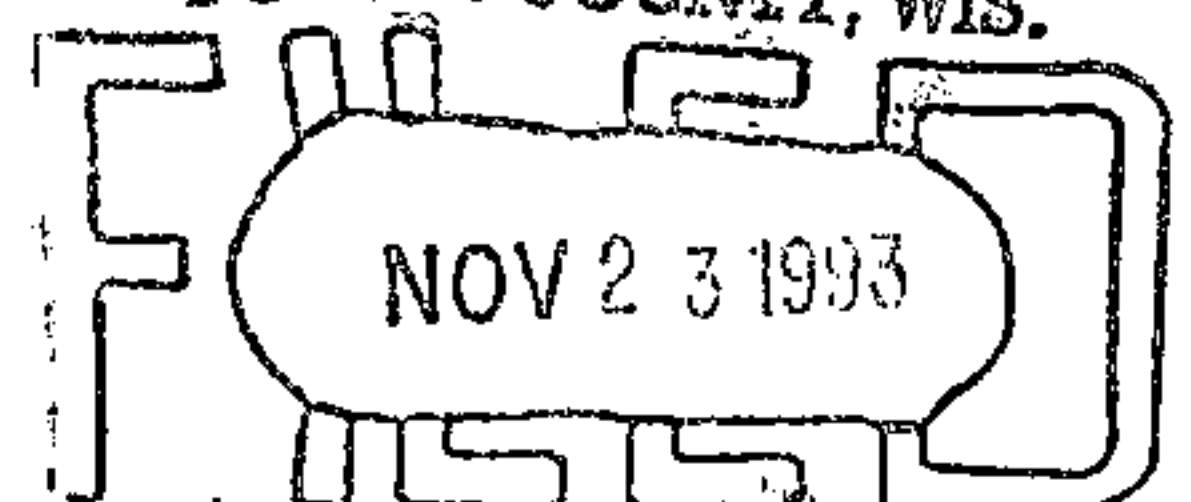

At 9 o'clock  M.
Paul A. [Signature]
Register of Deeds