

CERTIFIED LAND CORNER RESTORATION

Index No. Y-1

State of Wisconsin }
County of Forest } ss.

I Philip T. Hansen, do hereby
certify that on the 23rd day
of August, 19 76, I found
evidence of the S 1/16
corner of Section 31 & 36
Township 36, North, Range
11 & 12, Fourth Principal Meridian,
as described hereon; and that from this evidence
I established a new monument and accessories
as described hereon to perpetuate the original
location of this corner.

Resident witnesses:

Glen Barker

Jim Claflin

Herb Wagoner

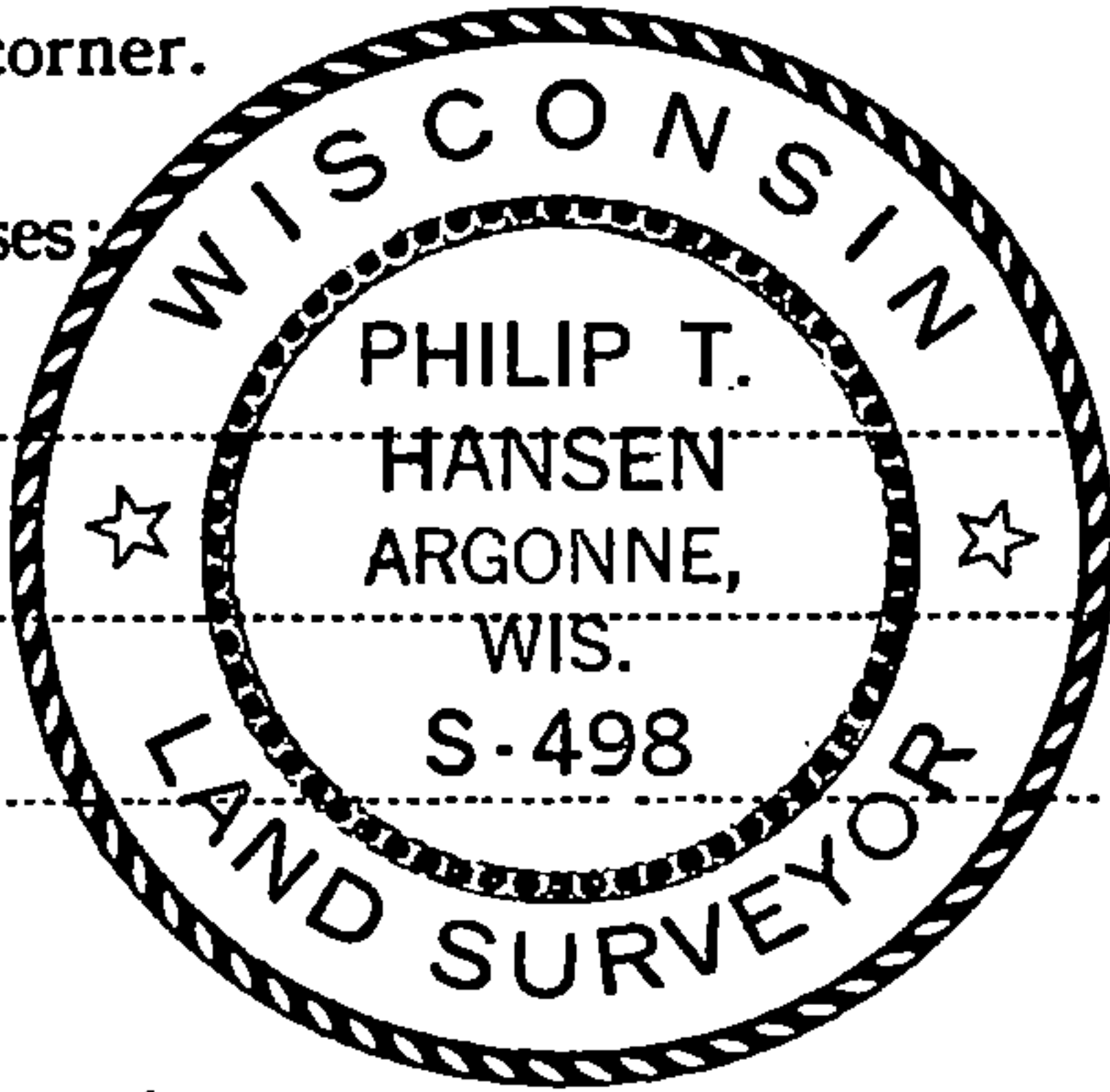

T36N R12E

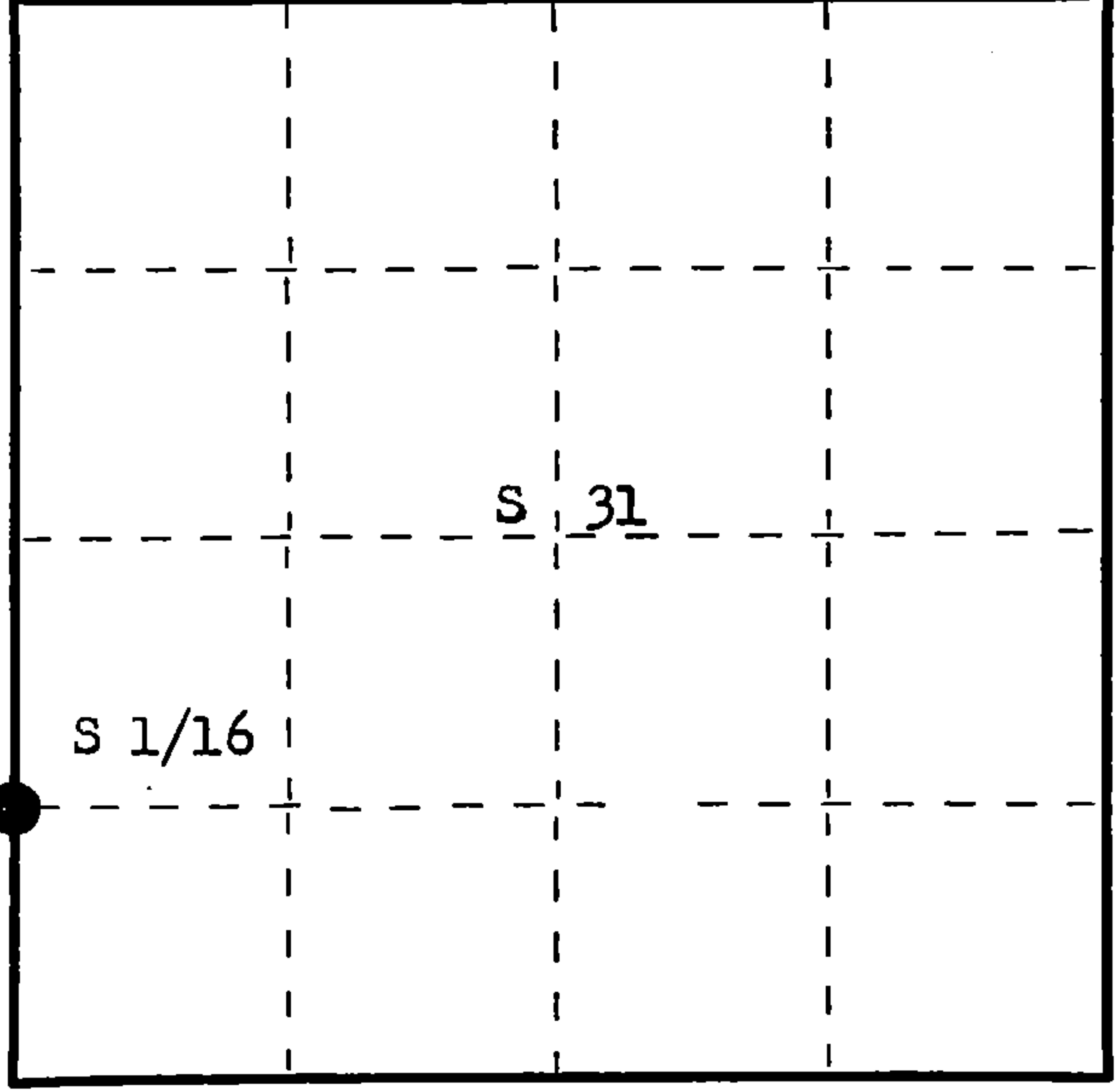

○ = Corner monument restored.

History of original corner establishment:

Corner established by Charles Walker, County Surveyor.

No records of survey or BT's established.

Description of corner evidence found:

Recovered pieces of old post and the old point well preserved in muck and moss.
This was a squared cedar post.
Unable to recover any evidence of any BT's.

Description of monument and accessories I established to perpetuate the original location of this corner.

Replaced point of old cedar post with 1 1/2" iron pipe with 2" brass cap, stamped.

Monument projects 24" above ground.

NBT's - Tamarack 6" North 11.6 links, scribed 1/16 BT.

Tamarack 8" S 54° E 62.2 links, scribed 1/16 BT.

Monument and BT's painted blue.

S498
T36N
R 11 36 | 31 R 12
E E
CPI-1976

Dated at Rhineland, Wis., this 31st day of August, 19 76.

Signature Philip T. Hansen Title Registered Land Surveyor Registration No. S-498
(County Surveyor, Registered Land Surveyor, or other duly authorized official)

Office of Register of Deeds, County of Forest, I hereby certify that the within
instrument was filed in this office for record on the 8th day of September, 19 76
at 10 o'clock A. M.

Eugene Stetson
(Register of Deeds)
By _____ Deputy

DOCUMENT NUMBER
110112

FORM 985 H. C. MILLER CO., MILWAUKEE

43611361000