

Document Number

176964

REGISTER'S OFFICE
Forest County, Wis.
Received for record this 9th day
of October A.D., 2002 at
9:00 o'clock A.M. and recorded
in Vol. Corner Restoration
page J 13

Kay Swanson, Deputy
Register of Deeds

U.S. PUBLIC LAND SURVEY MONUMENT RECORD

NOTE: This form is intended and designed to fulfill all requirements of Wisconsin Administrative Code, Chapter A-E 7.08 U.S. Public Land Survey Monument Record (3)(a)(b)(c)(d)(e)(f)(g)(h)(i). An additional sheet may be added if necessary to conform with said requirements.

(a) Corner location: Township 36 North

Range 12 West

Town of CRANDON

FOREST County, Wisconsin

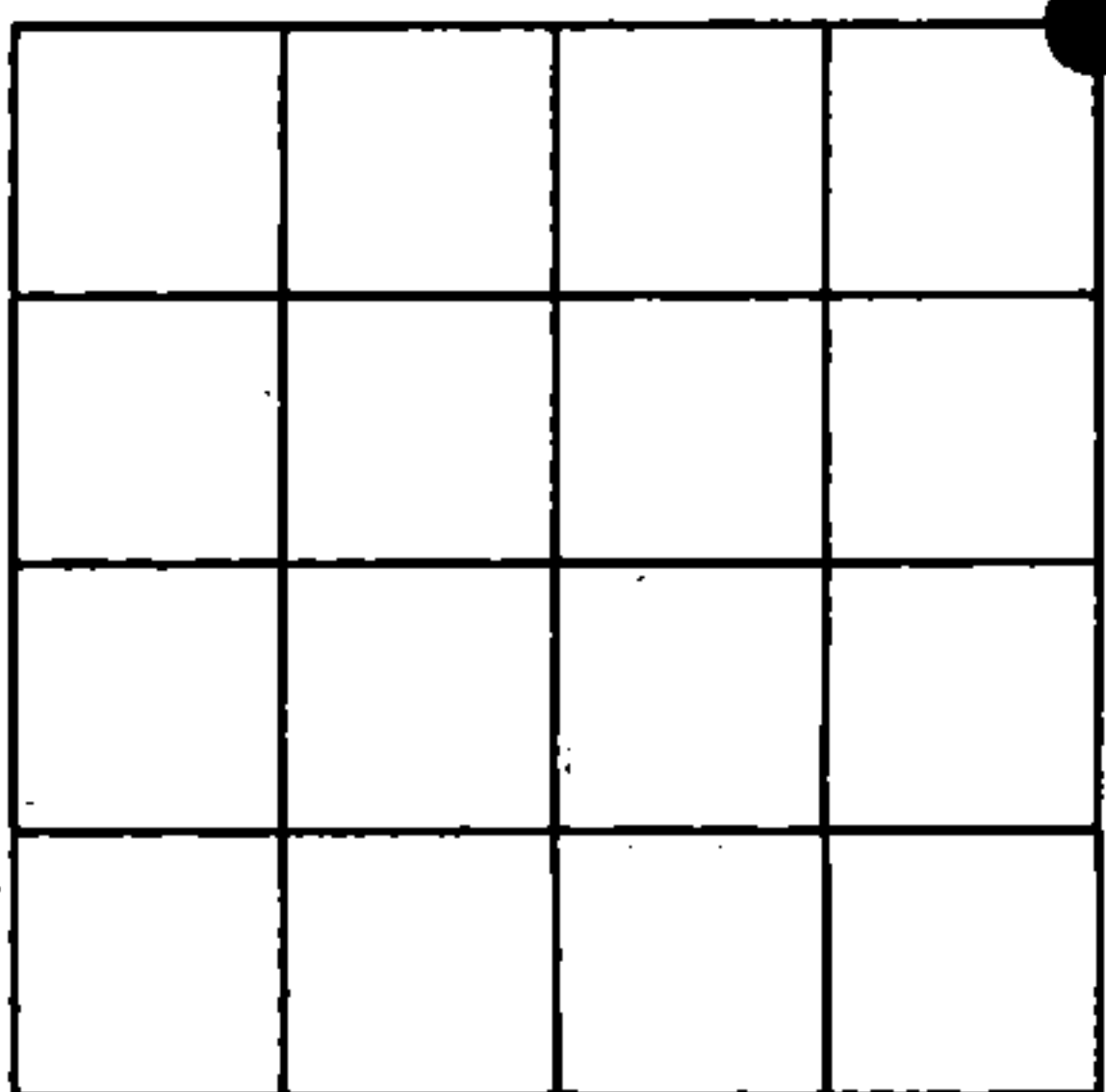

Section 16

(b)(f)(g)(h) Description of monument found at this corner and if it was accepted, state all evidence (material, testimonial, occupational, plats, records, other monuments) used as a basis for accepting. If not accepted or if nothing was found, state evidence used as basis for establishing location. If reestablished through lost corner proportionate methods, indicate all monuments, distances and directions used to establish. Indicate type of monument found or set and sign post.

Researched records, Original corner established by Wm. E. Daugherty in August, 1859. Area had been logged and original bearing trees are gone. At site did find 4" square tag in tree with hole at Northeast corner of section. On back of tag was names A. Nelson & E. Davidson of the Conservation Department. I checked with Conservation Department in Crandon but they had no other information on how tag was set. Could find no other information on corner. Neighboring owners, the Cottrell's, had pointed out a 1 1/4" dia. iron pipe found which was 7 feet East of the N. 1/4 1/4 corner of the NW. 1/4 of Section 15 and also a 1 1/4" dia. iron pipe at the North 1/4 corner of Section 15. The pipe was 7 feet East of the N. 1/4 1/4 because the actual corner falls in logging road. I traversed area and accepted iron pipes found. To establish this corner I extended a line from the North 1/4 of Section 15, West through the pipe at the N. 1/4 1/4 of NW. 1/4 of Section 15 and doubled distance using addition 7 feet as referenced by Cottrell's. This position came within 36 feet of tree with tag found.

(c)(d)(e) Plan view of corner with ties to at least 4 witness monuments. If in disagreement with previously established corner, show the distances between the two corners and also indicate the ties to the

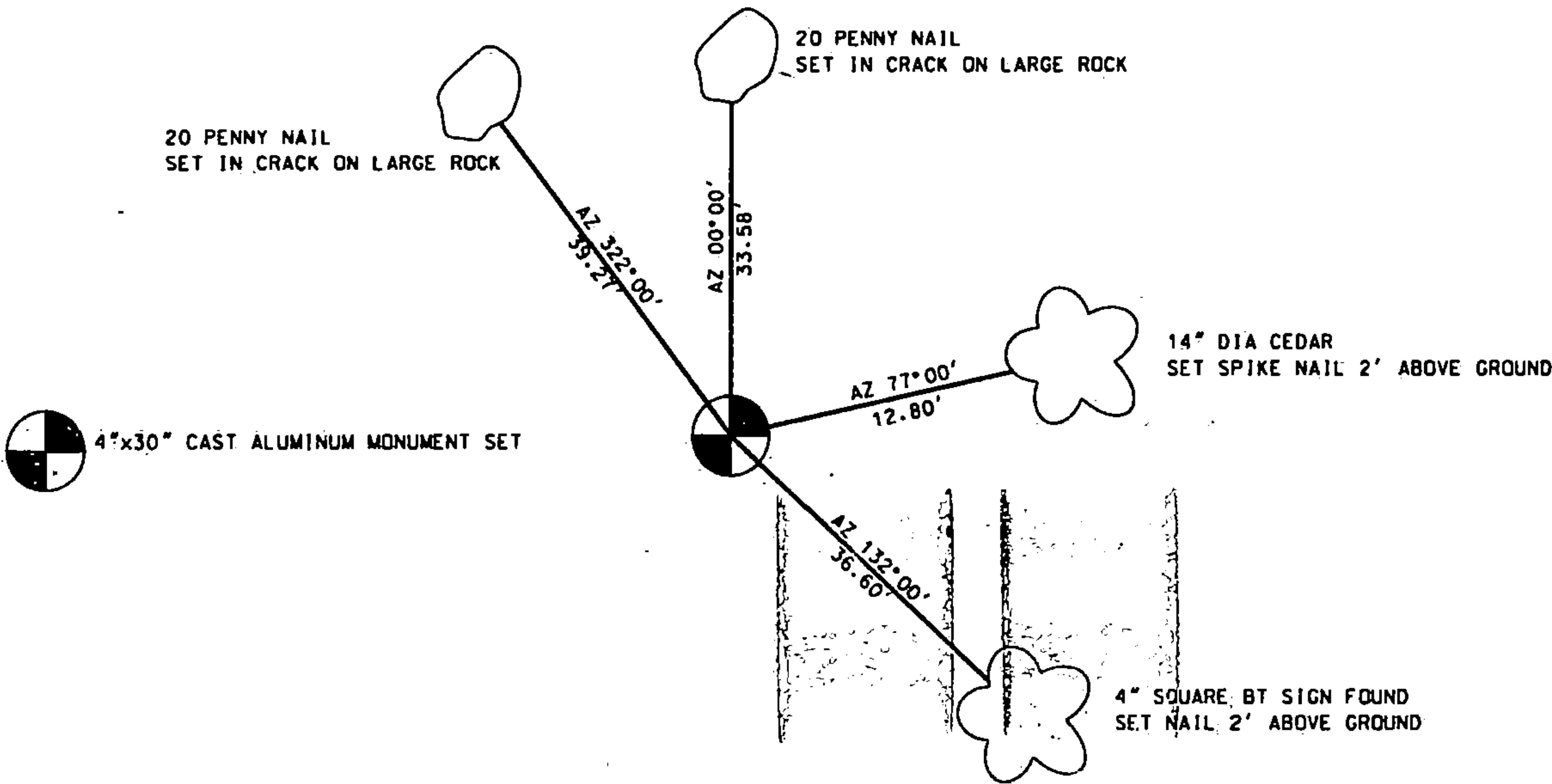

(i) I, EUGENE C. UTTECH, Registered Land Surveyor *S-1451, hereby certify that the corner location on this record was determined by me or under my direction and control and that this U.S. Public Land Survey Monument Record is correct and complete to the best of my knowledge and belief.

Eugene C. Uttech
Signature

SEPT. 27, 2002
Date

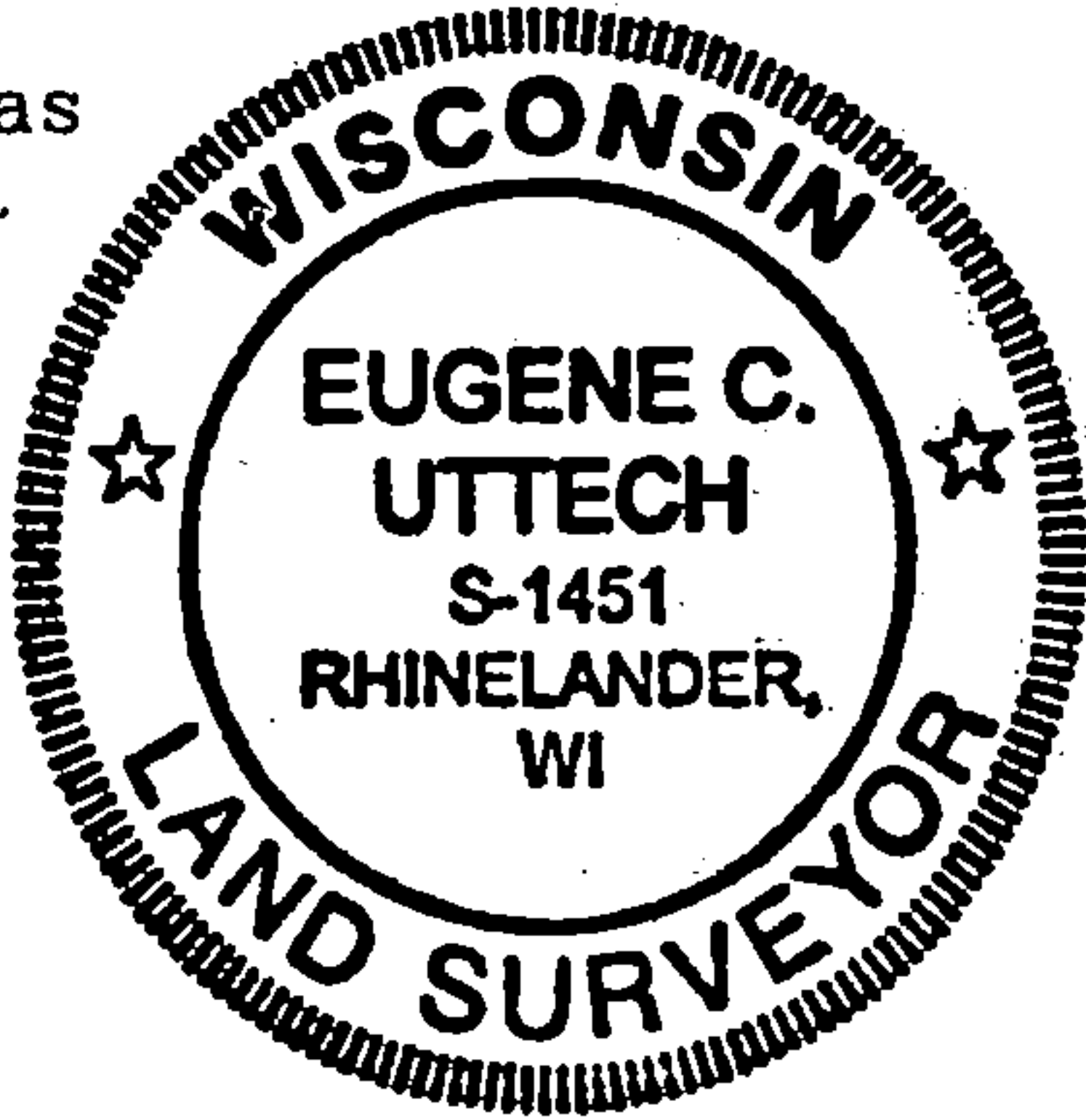

Index No. J 13

43612090000