

CERTIFIED LAND CORNER RESTORATION

Index No. R-13

State of Wisconsin }
County of Forest } ss.

I Philip T. Hansen, do hereby
certify that on the 7th day
of June, 1979, I found
evidence of the Section
corner of Section 21, 22, 27 and 28
Township 36, North, Range
12 East, Fourth Principal Meridian,
as described hereon; and that from this evidence
I established a new monument and accessories
as described hereon to perpetuate the original
location of this corner.

Resident witnesses:

Glen Barker

Jim Claflin

Herb Wagoner

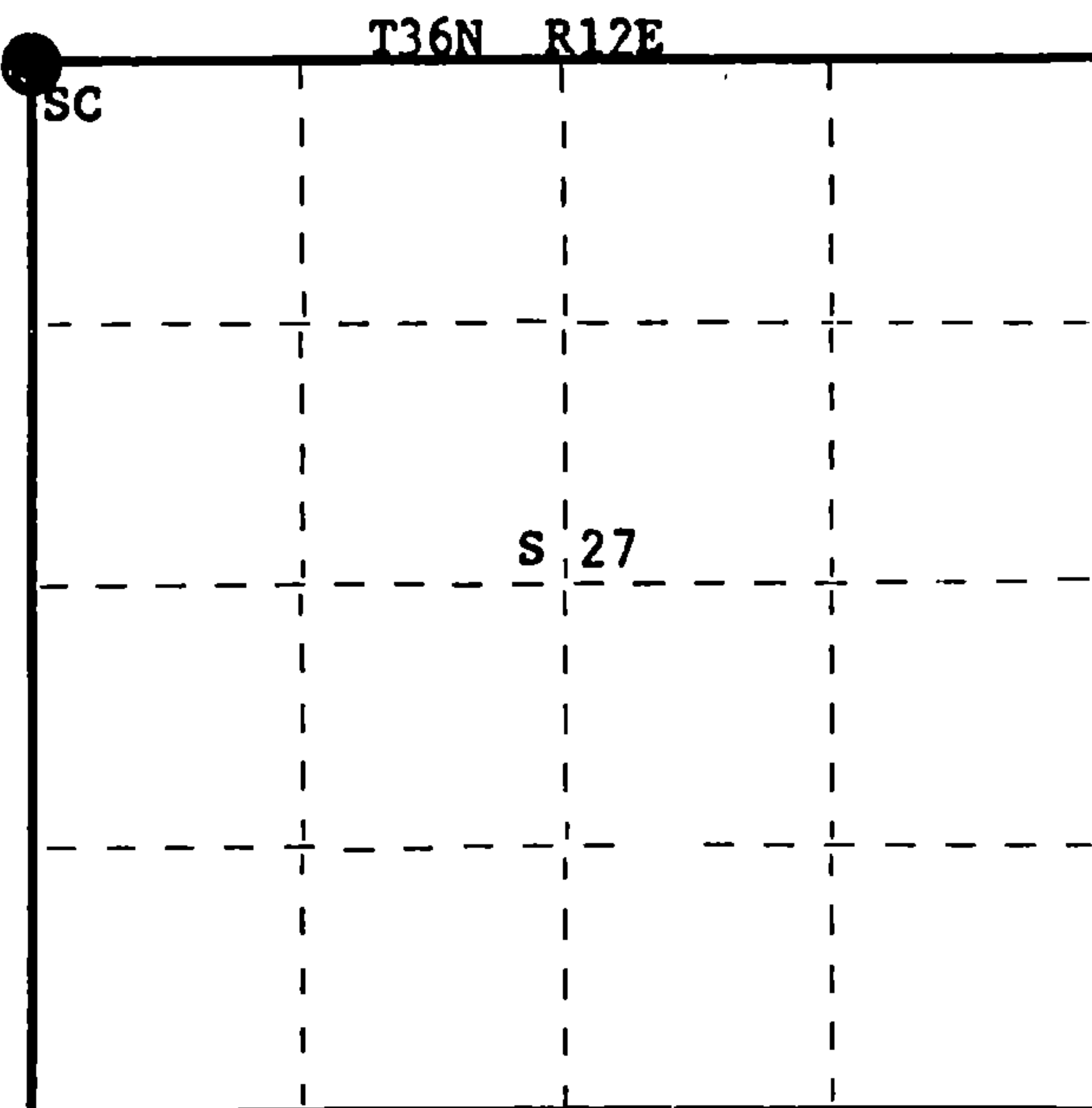
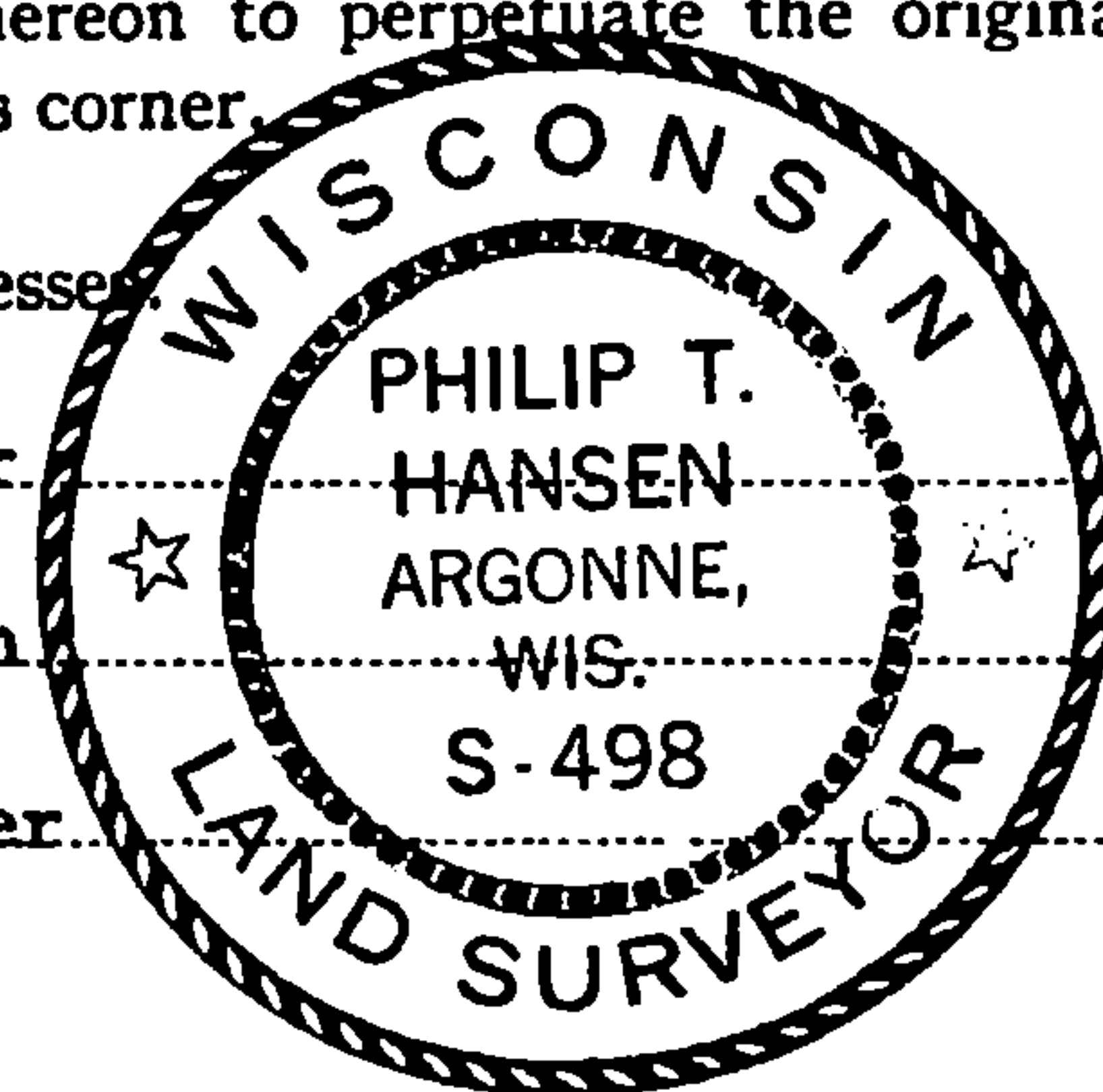

○ = Corner monument restored.

History of original corner establishment:

Original corner established by Wm. E. Dougherty, Deputy Surveyor, in 1859. No record of any subsequent survey.

Description of corner evidence found:

Recovered an old 4" squared cedar post, scribed S21, 22, 27 & 28, standing in fair condition. Also recovered an old squared cedar stake lying under the leaves beside the old post. Recovered OBT Yellow Birch 12" S59°W 17.00 feet, scribed T36N R12E S28 BT.; Yellow Birch 12" N50°E 8.00 feet, scribed T36N R12E S22 BT.

Description of monument and accessories I established to perpetuate the original location of this corner.

Replaced cedar post with a 2-1/2" Berntsen A-1 Federal Monument (F.C.) projecting 18" above ground. Cap stamped:

Marked NBT's -

Maple 6" S52°E 23.75'
Cedar 10" N77°W 27.10'
both scribed 1/4 BT.

T36N R12E
S.C. 21+22
28+27
S498 - 1979

Dated at Rhineland, Wis., this 12th day of June, 19 79

Signature Philip T. Hansen Title Registered Land Surveyor Registration No. S-498
(County Surveyor, Registered Land Surveyor, or other duly authorized official)

Office of Register of Deeds, County of Forest, I hereby certify that the within
instrument was filed in this office for record on the 13th day of November, 19 79
at 8:30 o'clock A. M.

Eugene Staszewski
(Register of Deeds)

By _____ Deputy

DOCUMENT NO. **117077**