

CERTIFIED LAND CORNER RESTORATION

Index No. W-13

State of Wisconsin }  
County of Forest } ss.

I Philip T. Hansen, do hereby  
certify that on the 28th day  
of January, 1977, I ~~restored~~  
~~re-established~~ established the N 1/16  
corner of Section 33 & 34  
Township 36, North, Range  
12 East, Fourth Principal Meridian,  
as described hereon; and that from this evidence  
I established a new monument and accessories  
as described hereon to perpetuate the original  
location of this corner.

Resident witnesses:

Glen Barker

Jim Claflin

Herb Wagoner

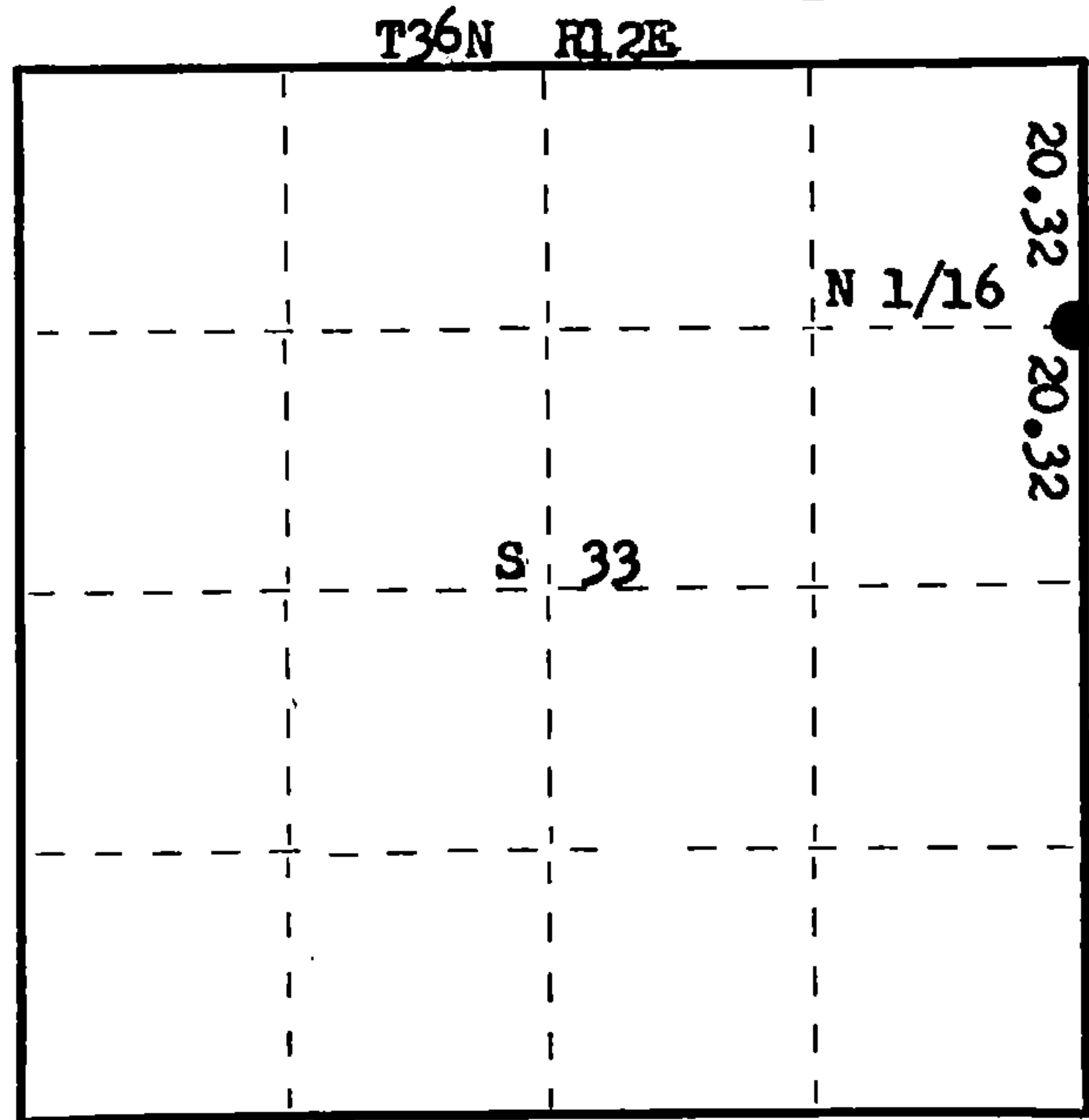
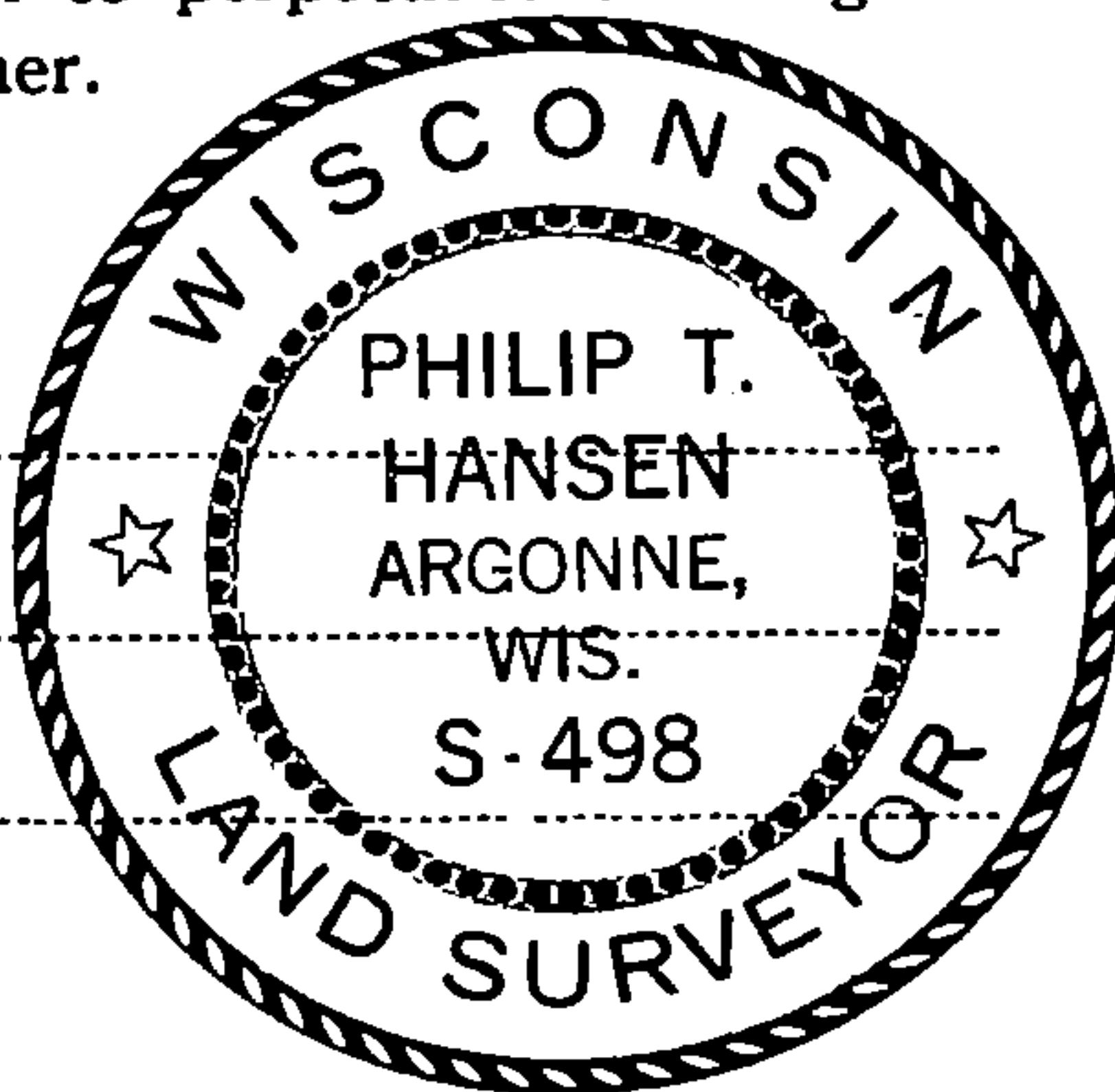

○ = Corner monument restored.

History of original corner establishment:

No evidence of record of this corner having been previously established.

Description of corner evidence found:

Established corner by proportionate measurement. Ran traverse from Section Corner 27, 28, 33 & 34 to previously established 1/4 corner between Section 33 & 34. Computed distance 40.64 chains, bearing S 0° 15' 24" W. Established N 1/16 corner at 20.32 chains intermediate.

Description of monument and accessories I established to perpetuate the original location of this corner.

Set 1 1/2" iron pipe with 2" brass cap, projecting 18" above ground, cap stamped:

Marked NBTs - Hemlock 12" S 76° E, 58.2 links.  
Cedar 6" N 68° W, 47.4 links, scribed 1/16 BT.

S498  
T36N R12E  
N 1/16 33 | 34  
CPI-1977

Dated at Rhineland, Wis., this 5th day of April, 1977.

Signature Philip T. Hansen Title Registered Land Surveyor Registration No. S-498  
(County Surveyor, Registered Land Surveyor, or other duly authorized official)

Office of Register of Deeds, County of Forest, I hereby certify that the within  
instrument was filed in this office for record on the 5th day of May, 1977  
at 4:00 o'clock P. M.

Eugene Stetson  
(Register of Deeds)  
By \_\_\_\_\_ Deputy

DOCUMENT NUMBER  
**111376**