

CERTIFIED LAND CORNER RESTORATION

Index No. L-9

State of Wisconsin }  
County of Forest } ss.

I Thomas R. Arnott, do hereby  
certify that on the 31st day  
of December, 19 75, I found  
evidence of the 1/4  
corner of sections 16 & 17  
Township 36, North, Range  
13 E, Fourth Principal Meridian,  
as described hereon; and that from this evidence  
I established a new monument and accessories  
as described hereon to perpetuate the original  
location of this corner.

Resident witnesses:  
Herbert Wagoner  
\_\_\_\_\_  
\_\_\_\_\_  
\_\_\_\_\_

FORM 985 H. C. MILLER CO., MILWAUKEE

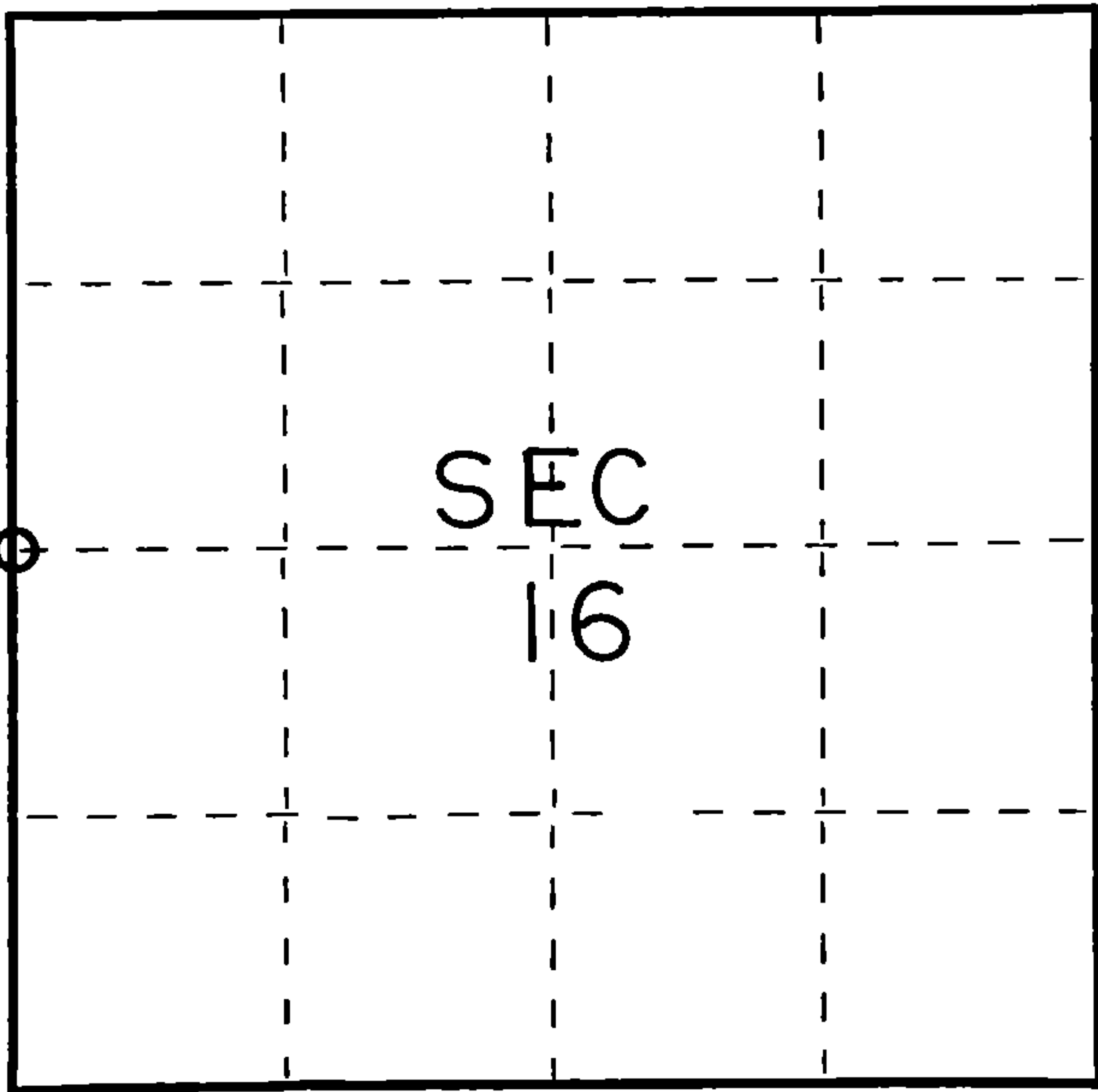

○ = Corner monument restored.

History of original corner establishment:

Original subdivision by James Nowlin June 2 - June 12, 1865

Spruce	10	N64E	20 Lks.
Spruce	8	S64W	18 Lks.

Description of corner evidence found:

1 1/2" iron pipe found  
Wood post found  
BT found on Spruce 12 N8W 5.95 feet



43613172000

Description of monument and accessories I established to perpetuate the original location of this corner.

Replaced iron pipe and wood post with a new Forest County aluminum monument

Ties:

Spruce	12	N8W	5.95 feet (BT found)
Spruce	10	N2E	4.73 feet
Spruce	12	East	27.73 feet
Spruce	6	S6W	33.56 feet

Dated at Crandon, Wis., this 9th day of January, 19 76.

Signature Thomas Arnott Title Surveyor Registration No. S-887  
(County Surveyor, Registered Land Surveyor, or other duly authorized official)

Office of Register of Deeds, County of Forest, I hereby certify that the within  
instrument was filed in this office for record on the 9th day of January, 19 76  
at 11 o'clock A. M.

Eugene Stagny Document Number 108535  
(Register of Deeds)

By \_\_\_\_\_ Deputy

CERTIFIED LAND CORNER RESTORATION

Index No. L-9

State of Wisconsin }  
County of Forest } ss.

I Thomas Fogarty, do hereby  
certify that on the 13<sup>th</sup> day  
of July, 2005, I found  
evidence of the 1/4  
corner of sections 16 & 17  
Township 36, North, Range  
13 E, Fourth Principle Meridian,  
as described hereon; and that from this evidence  
I established a new monument and accessories  
as described hereon to perpetuate the original  
location of this corner.

Resident witnesses:

Kory Rentmeester, Brad Nelson

Forest County Coordinates:

N: 581844.574 (feet)  
E: 841340.184 (feet)

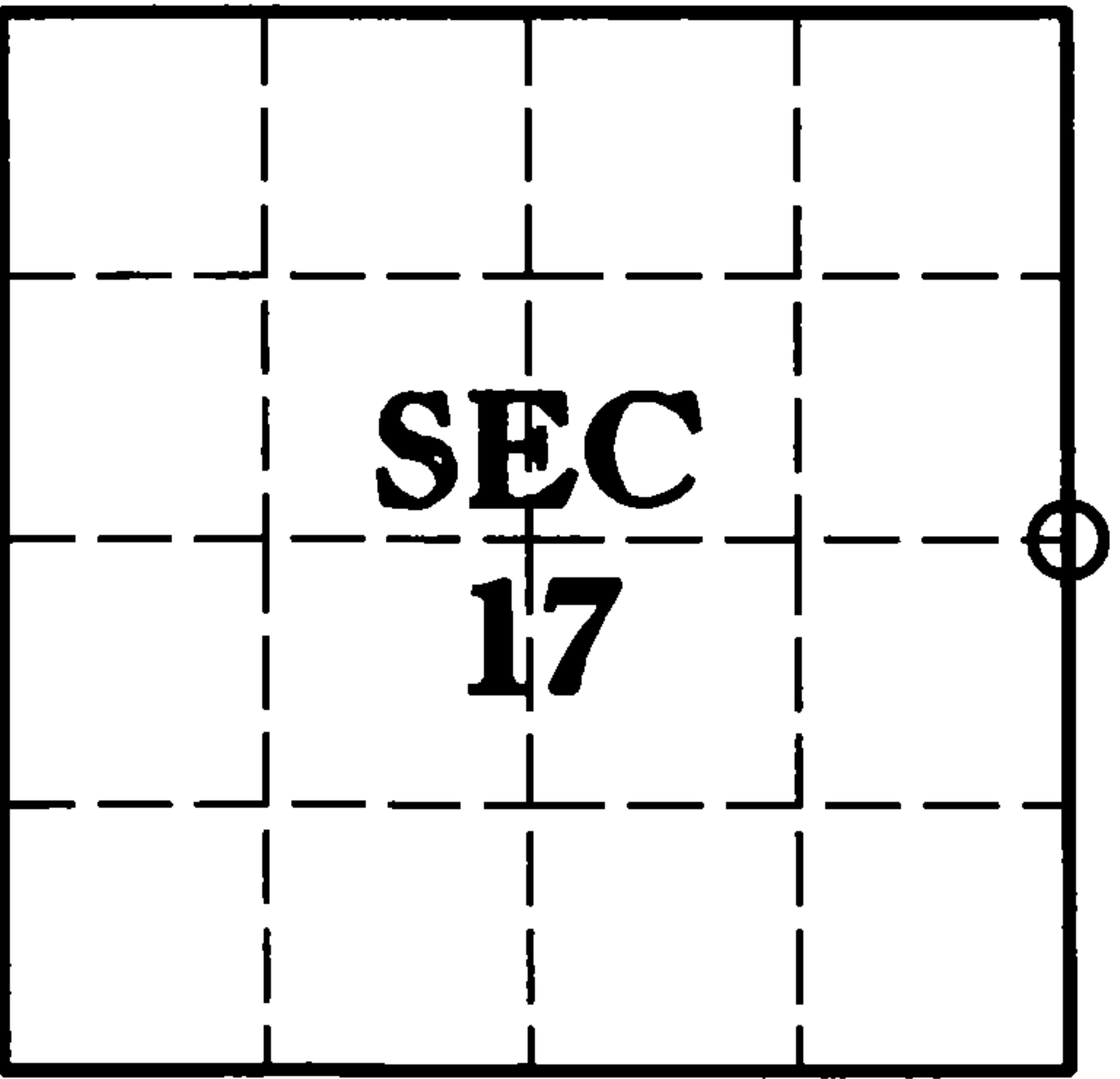

○ = Corner monument restored.

History of original corner establishment:

1865 - James L. Nowlin set original corner post and made the following B.T.'s:  
Spruce 10 N64E 20 Lks.  
Spruce 8 S64W 18 Lks.

1976 - Thomas R. Amott found 1.5" iron pipe and wood post. He replaced these with a new Forest County  
aluminum monument and set the following ties:  
Spruce 12 N8W 5.95 feet (BT found)  
Spruce 10 N2E 4.73 feet  
Spruce 12 East 27.73 feet  
Spruce 6 S6W 33.56 feet

2005 - I found a Forest County aluminum monument and all of Amott's B.T. stumps.  
Set the following ties:  
Rebar 5/8" S31°09'08"W 63.97 feet  
Rebar 5/8" S31°05'45"E 53.05 feet  
Rebar 5/8" N30°27'00"E 49.35 feet  
Rebar 5/8" N37°51'19"W 56.35 feet

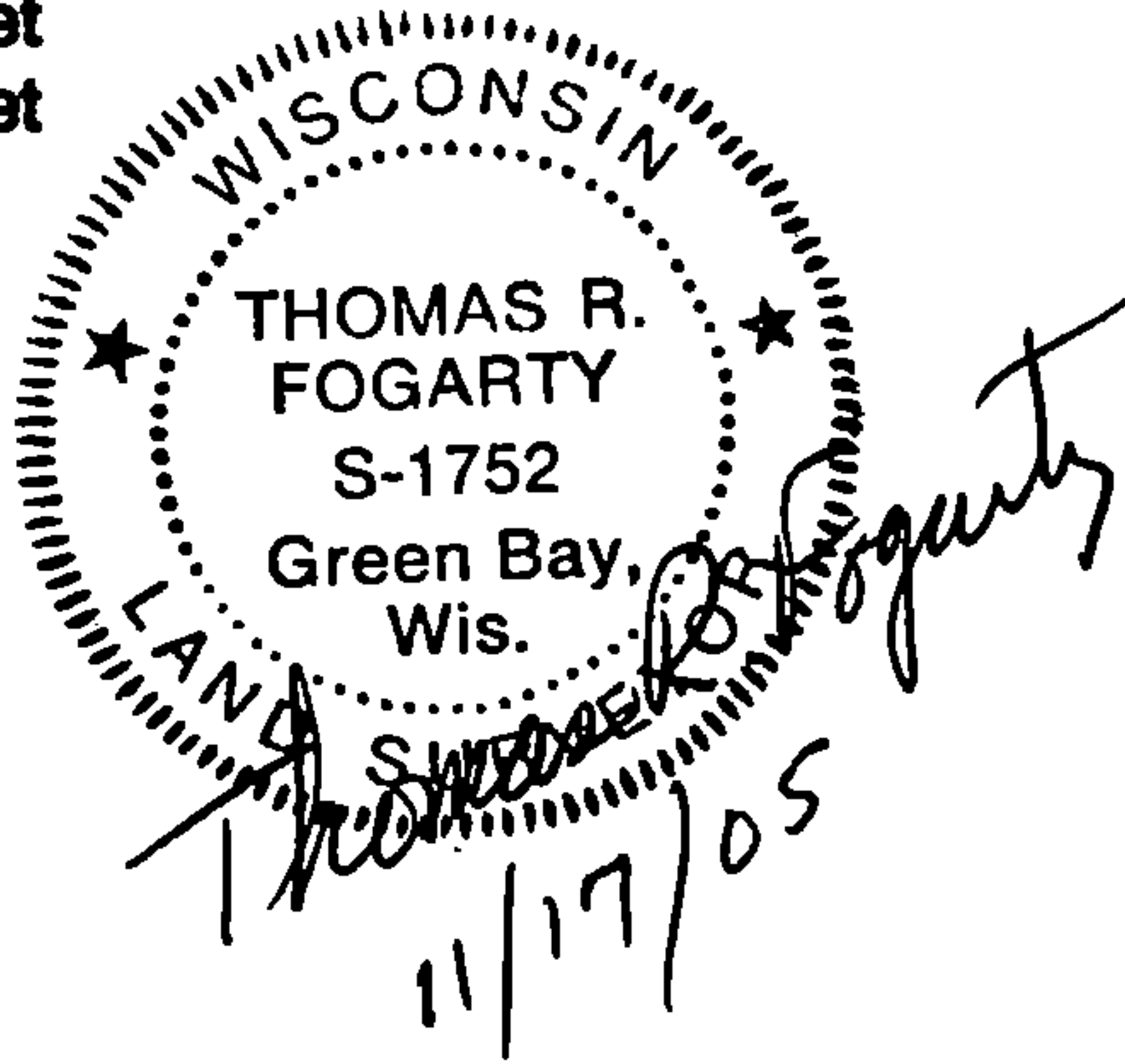
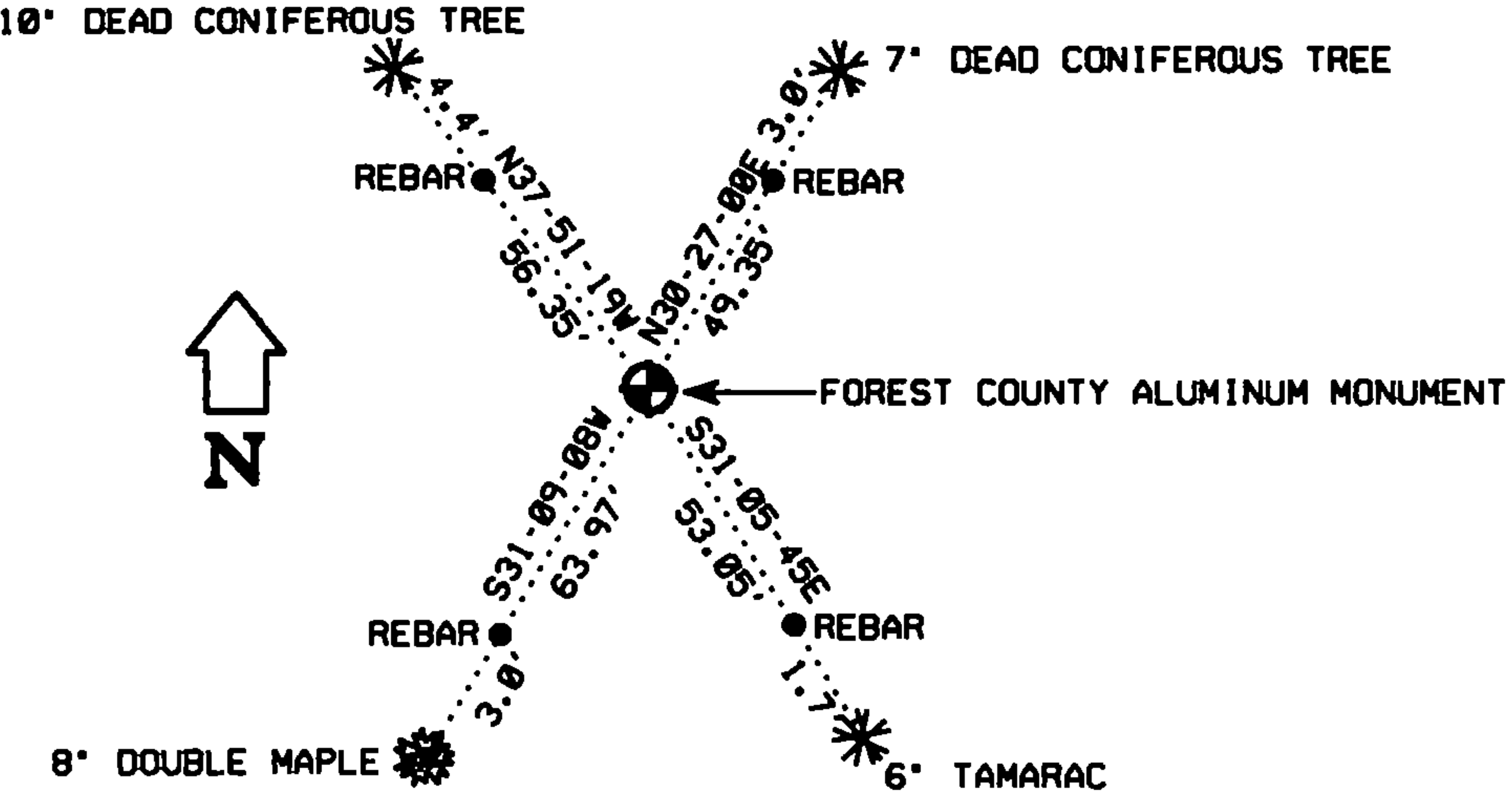

Dated at Crandon, Wis., this 17<sup>th</sup> day of November, 2005.  
Signature Thomas R. Fogarty Title Registered Land Surveyor Registration No. S-1752  
(County Surveyor, Registered Land Surveyor, or other duly authorized official)

Office of Register of Deeds, County of Forest, I hereby certify that the within  
instrument was filed in this office for record on the 18<sup>th</sup> day of November, 2005  
at 2:40 o'clock P. M.

Kay Swanson, Deputy  
(Register of Deeds)

REGISTER'S OFFICE {  
Forest County, Wis.  
Received for record this 18<sup>th</sup> day  
of November A.D., 2005, at  
2:40 o'clock P. M. and recorded  
in Vol. Corner Restoration  
page L-9  
Kay Swanson, Deputy  
Register of Deeds

Document Number  
189291

43613172000