

# CERTIFIED LAND CORNER RESTORATION

State of Wisconsin

County of Forest

ss.

I Jean F. Resvick, do hereby certify that on the 4th day of November, 1976, I found evidence of the established the west one sixteenth corner on the north line of Section 1 Township 35 North Range 14 East, Fourth Principal Meridian, as described hereon; and that from this evidence I established a monument and accessories as described hereon to perpetuate the original location of this corner:

Description of original monument and accessories and subsequent restorations:

None of record.

Description of corner evidence found:

Established West one sixteenth on a straight line and midway between the Northwest section corner and North quarter corner of Section 1.

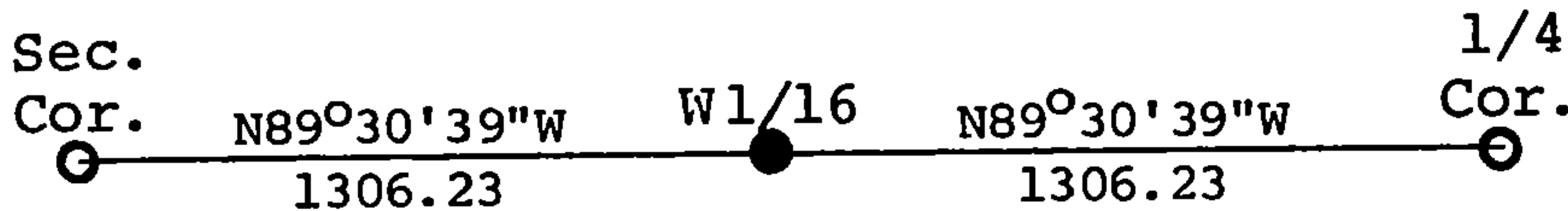

Description of monument and accessories I established to perpetuate the location of this corner:

At the corner position established set a 2 inch inside diameter, galvanized iron pipe, 3 feet long, filled with concrete, 1 foot below the surface of the road, with brass cap stamped, T36N, R14E, W 1/16, S36, S1, T35N, 1976, S-802

From which the following blazed and scribed bearing trees bear:  
Hemlock 7, S35E, 44.40 feet  
Maple 8, S33W, 54.63 feet

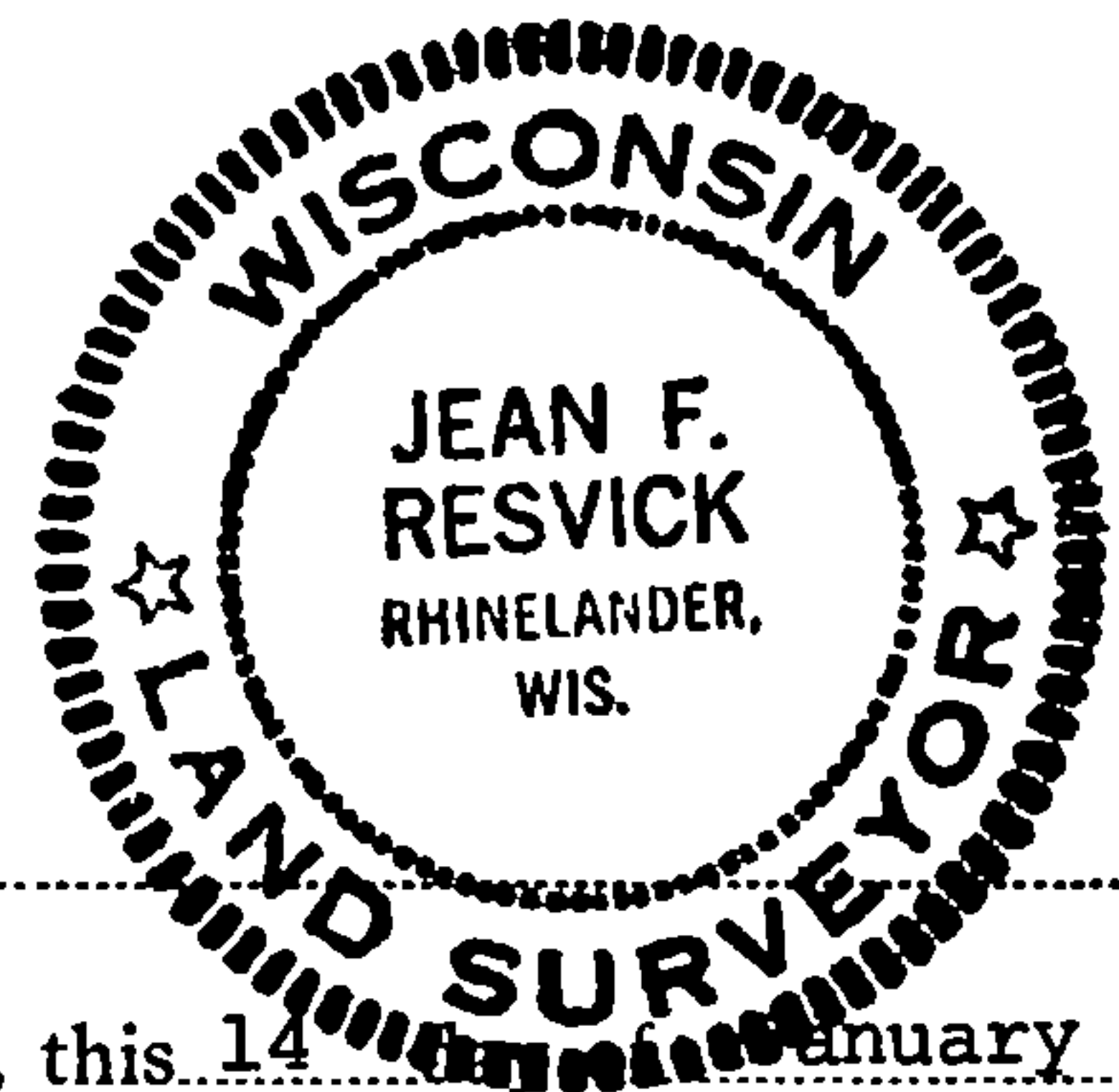
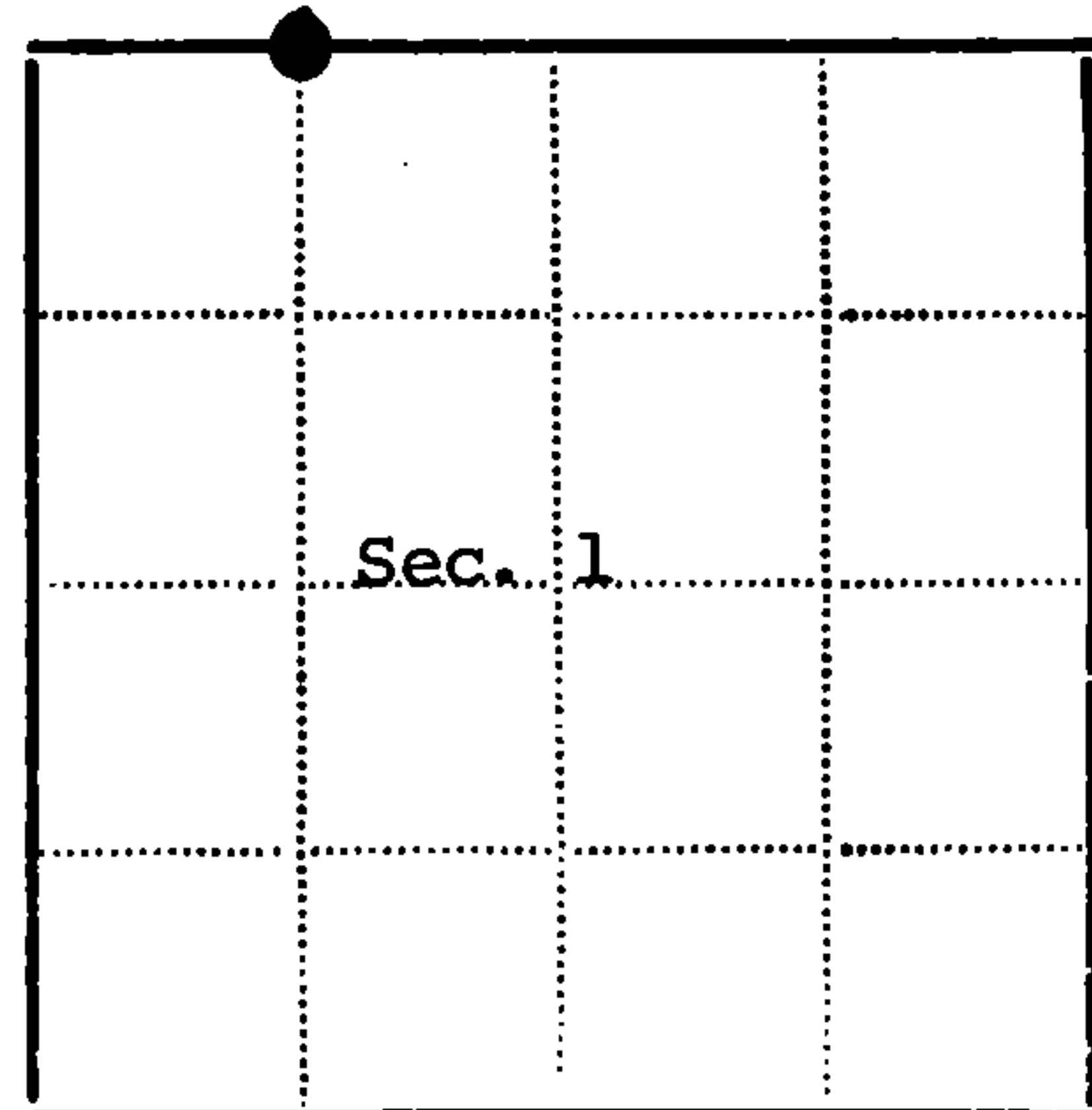

Resident witnesses

Dated at Rhinelanders Wisconsin, this 14th day of January 1977.

Signature Jean F. Resvick Title Land Surveyor  
(County Surveyor, Registered Land Surveyor, or other duly authorized official)

Surveyors Registration No. S-802

DOCUMENT NUMBER 111429

Office of Register of Deeds County of Forest

I hereby certify that the within instrument was filed in this office for record on the 13th day of May 1977, and was filed in Book No. Page No. of County Records.

Signature Eugene Stutzman Title Register of Deeds

Township 35 North Range 14 East Section 1 Index No. A-22, Page No.

43614360030

22