

CERTIFIED LAND CORNER RESTORATION

State of Wisconsin }  
County of Forest } ss.

I Milo E. Stefan, do hereby certify that on the 23rd day of July, 1981, I found evidence of the West  $\frac{1}{4}$  corner of Section 11 Township 36 North Range 15 East, Fourth Principal Meridian, as described hereon; and that from this evidence I established a new monument and accessories as described hereon to perpetuate the original location of this corner:

Description of original monument and accessories and subsequent restorations:

Surveyed in 1859 by James McBride  
40.00 chains north between Section 10  
and Section 11, set wood post  
Tamarac, 10", S46E, 82 lks., 54.12 feet  
Tamarac, 10", S5W, 217 lks., 143.22 feet  
231, 3.50 chains south leave Alder swamp  
bears E & W  
174.9, 2.65 north stream 20 lks. runs SW,  
19.50 north leave swamp bears E & W

Surveyed in 1968 by Cochrane and Resvick  
Found 2" iron pipe alongside of 4" squared  
Cedar post, which is very old. Post is  
scribed. 190 feet north from post to stream.  
195 feet south to edge of swamp from post.

Description of corner evidence found:

Found post and pipe.  
N62E, 13" Cedar blazed, scribed and location poster attached 37.8 feet, 60-80 years ago.  
Down and badly decayed Tamarack. Tree 10" - 14" D.B.H., S5W, 143 feet. 6" Cedar now  
growing out of stump. Swamp and creek calls are reasonable. I accept this position as  
the original corner and monument same.

Description of monument and accessories I established to perpetuate the location of this corner:

Placed a 2" x 60" aluminum pipe alongside of post and iron pipe stamped as follows:  
T36N, R15E, S10,  $\frac{1}{4}$ , S11, 1981, RLS-1558  
From which the following bear:  
B. Ash, 6", N52E, 40.88 feet  
Silver Maple, 16", N70W, 99.03 feet  
Set steel sign post, south, 1.3 feet  
Creek 15 feet west of Silver Maple, runs NNE & WSW  
Corner lies in Tag Alder swamp

DOCUMENT NO.  
**124203**

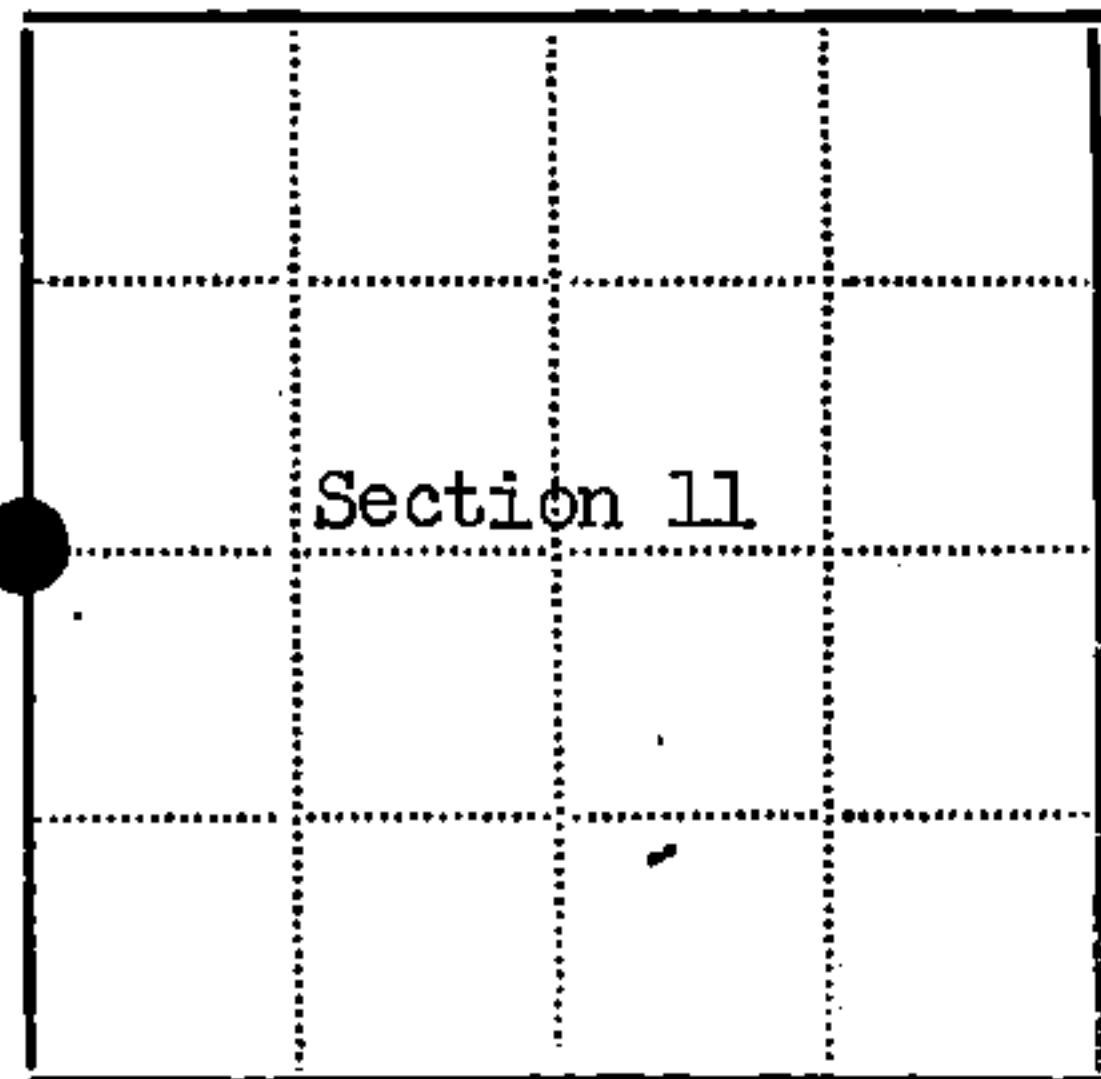

● - Corner monument restored  
□ -

Resident witnesses.....

Dated at Rhineland Wisconsin, this.....day of.....  
1982.....

Signature Milo E. Stefan Title Land Surveyor  
(County Surveyor, Registered Land Surveyor, or other duly authorized official)

Surveyors Registration No. RLS-1558

Office of Register of Deeds County of Forest

I hereby certify that the within instrument was filed in this office for record  
on the 13th day of September 1983, and was filed in Book  
No.....Page No.....of County Records.

Signature Eugene J. Stutzman Title Register of Deeds

Township 36 North, Range 15 East, Section 11, Index No. G-17, Page No. 31

# U.S. PUBLIC LAND SURVEY MONUMENT RECORD

Index No. G-17

State of Wisconsin }  
County of Forest } ss.

I, Gary L. Pisoni, do hereby certify that on the 13th day of May, 1994, I found evidence of the East quarter corner of Section 10 Township 36, North, Range 15 East, Fourth Principal Meridian, as described hereon; and that from this evidence I established a new monument and accessories as described hereon to perpetuate the original location of this corner.

Resident witnesses:

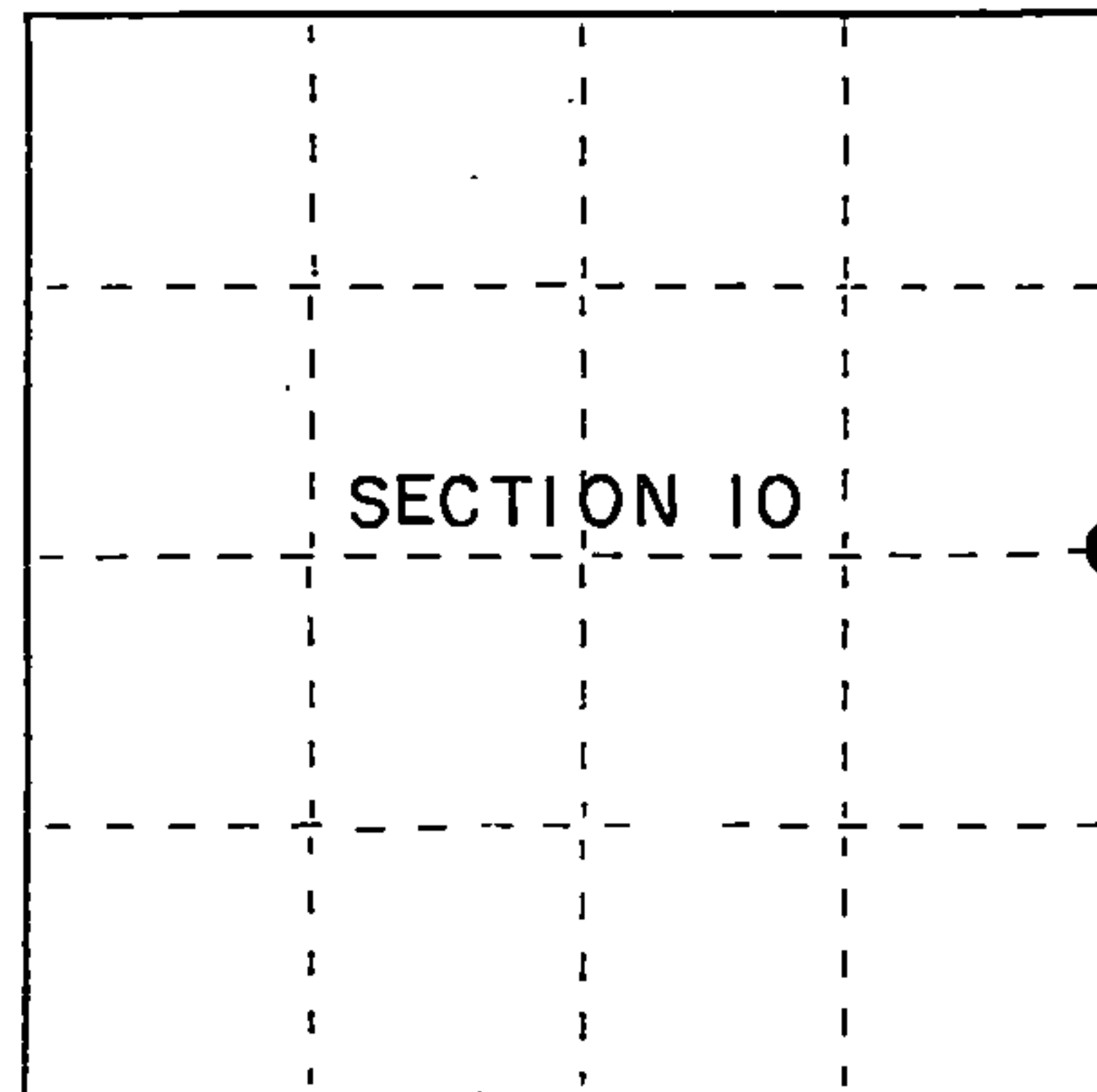

● = Corner monument restored.

## History of original corner establishment:

Original Government Survey in 1859 by James McBride, deputy surveyor. North between Sections 10 and 11 at 40.00 chains, set Quarter Section post from which the following bear:  
Tamarack 10" S 46° E 82 lks; Tamarack 10" S 05° W 217 lks

In 1968, Resvick and Bill Cochrane RLS U.S.F.S. found a 2" iron pipe along side a 4" scribed squared cedar post which was very old. On 7/23/81, Milo Stefan RLS recovered the post and pipe as described above and replaced pipe with a 2"x60" aluminum capped pipe monument from which the following bear:

Black Ash	6"	N 52° E	40.88 feet
Silver Maple	16"	N 70° W	99.03 feet
Steel sign post		South	1.3 feet
Cedar	13"	N 62° E	37.8 feet

Description of corner evidence found:

Found the monument and bearing trees as described above:

Cedar	15"	N 62° E	37.8 feet
Black Ash	8"	N 52° E	40.88 feet
Silver Maple	16"	N 70° W	99.08 feet
Steel sign post		South	1.3 feet

Description of monument and accessories I established to perpetuate the original location of this corner.

Blazed and scribed the following new bearing tree: (Measurement taken to a nail in side of tree)

Cedar	9"	S 74° E	62.05 feet
-------	----	---------	------------

Dated at Iron River, MI, Wis., this 13th day of May, 1995

Signature Gary L. Pisoni Title Land Surveyor Registration No. S-1634  
(County Surveyor, Registered Land Surveyor, or other duly authorized official)

Office of Register of Deeds, County of Forest, I hereby certify that the within instrument was filed in this office for record on the 20th day of March, 1997 at 1:30 o'clock P. M.

(Register of Deeds)

By [Signature] Deputy

- e) Describe any material discrepancy between the location of the corner as restored or reestablished and the location of that corner as previously restored or reestablished by distance and direction. Show the discrepancy on the plan view drawing under (d), above. Show the distances between the corner as previously restored or reestablished and (1) the corner as restored or reestablished, and (2) to at least 2 of the witness monuments shown on the drawing in (d), above.

None

- (f) Was the corner restored through acceptance of (1) an obliterated evidence location, or, (2) a found perpetuated location?

Restored through acceptance of a found perpetuated location.

- (g&h) Was the corner reestablished through lost corner proportionate methods? If so, show the method, including the directions and distances to other public land survey corners used as evidence or used for proportioning in determining the corner location?

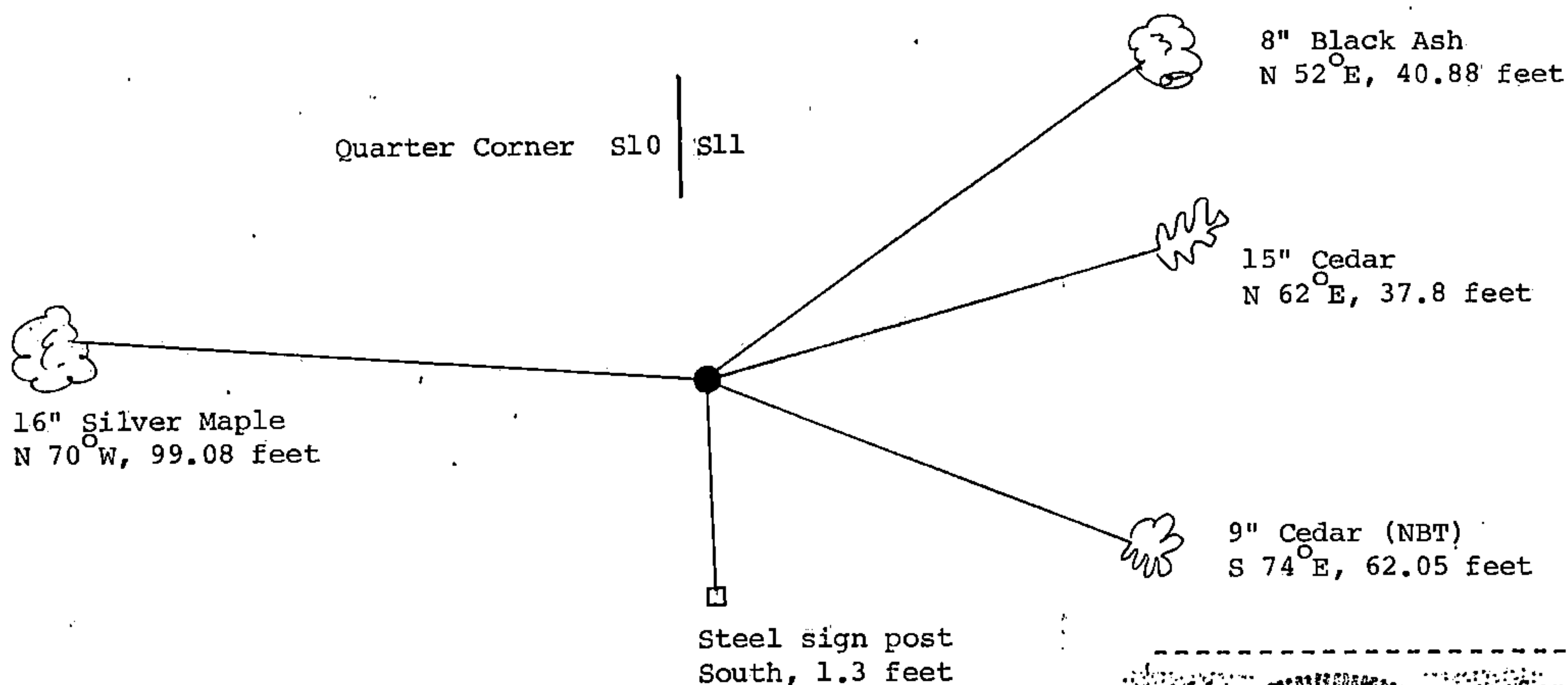

Gary L. Pisoni

- (i) I, Gary L. Pisoni (type or print name) certify that the corner location shown on this record was determined by me or under my direction and control and that this U.S. Public Land Survey Monument Record is correct and complete to the best of my knowledge and belief.

Signature

Date

*Gary L. Pisoni*

5-24-96

