

U. S. PUBLIC LAND SURVEY MONUMENT RECORD

INDEX NO. J-23

Quarter Corner to Section 12 13 T 36 N, R 15 E
(Section/Quarter)

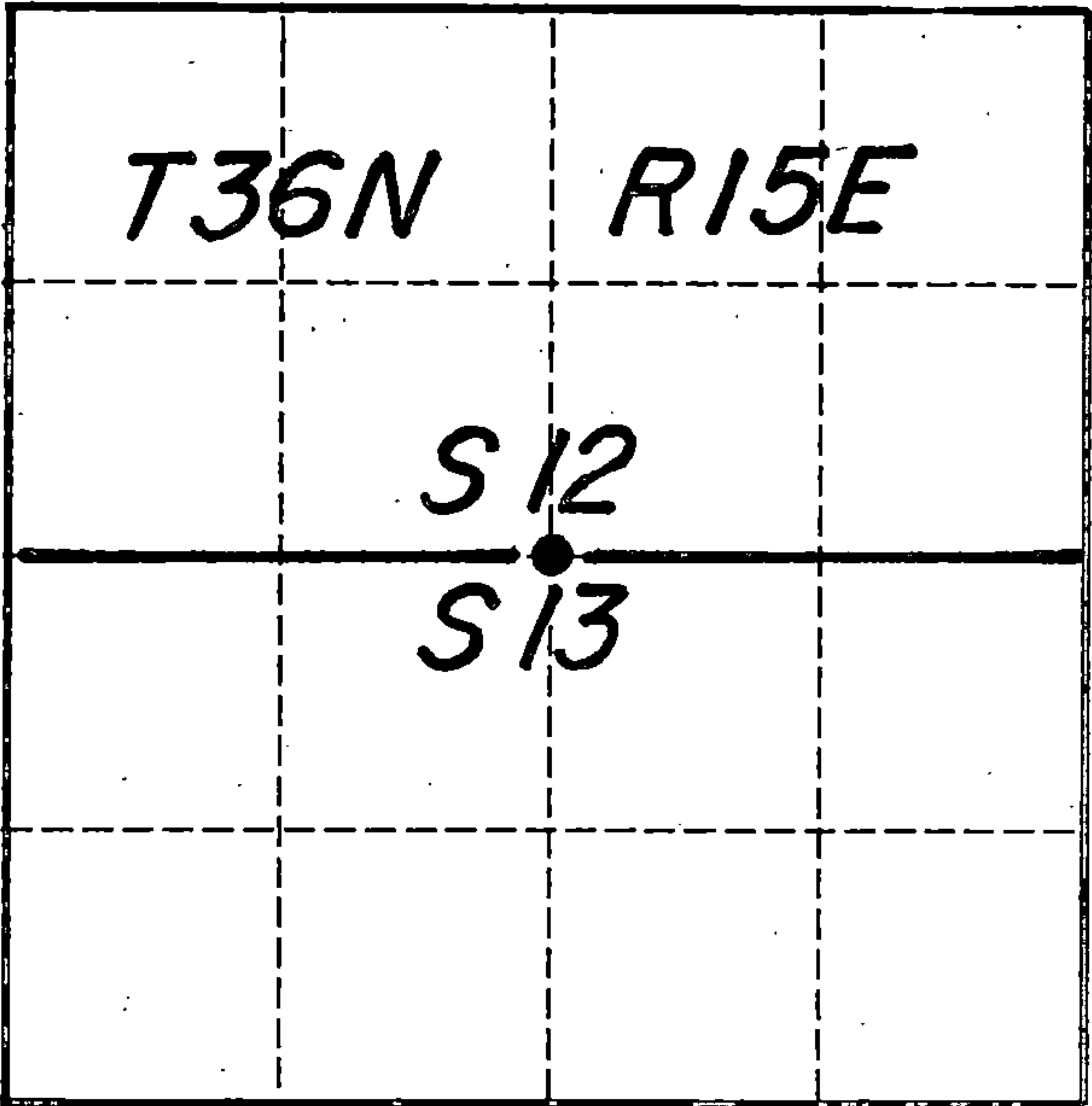

Show distances and bearings if set by proportional measurement.

History of original corner establishment, record evidence, monument evidence, occupational evidence, testimonial evidence or any other material evidence, and what you found and how the monument was set.

In 1859 James McBride set a wood post at this corner location and scribed the following trees:
Tamarack 8" S 10°E 7 links
Tamarack 6" N 47°E 20 links

In 1928 timber cruisers Carr and Martin found a wood post at this corner position and marked two Balsam Fir trees facing the corner but recorded no distances or bearings.

During a traverse of Sections 12 and 13 I recovered a 1" iron pipe at the East sixteenth corner location. I set up a search area for the quarter corner at both the single proportionate position and doubling the sixteenth corner pipe to the west. The two positions were close in distance but fell north and south of one another. Right between these two positions and under 18" of swamp grass matt a cedar post point was located which was found with the help of recovering a felled and dead Balsam tree with a "beaver" blaze facing the post point. Tamarack roots were found at the bearing of S 10°E 7 links but no solid stump evidence was recovered. The post point fit the stream call of McBride to the west within a half chain. The post was accepted and monumented.

In the plan view drawing below, provide reference ties to at least 4 witness monuments, or, if the location is within a municipality, to at least 2 witness monuments. (Witness monuments shall be made of concrete, natural stone, iron or other equally durable material, except wood other than bearing trees.) Also, show any material discrepancies between the corner restored or re-established and the location of any other previous corner location or occupation.

○ = Corner monument restored.



The corner consists of a 2½" x 60" aluminum post with cap stamped for the corner. Distances are to nails driven into the tree centers which were also blazed and scribed "BT" on the edge of the swamp lands. Bearings are magnetic.



REGISTER'S OFFICE
Forest County, Wis.

Received for record this 30 day of JANUARY A.D., 1992 at 9:30 o'clock A.M. and recorded in Vol. CORNER RESTORATIONS page J-23

Paul Hochstetler
Register of Deeds

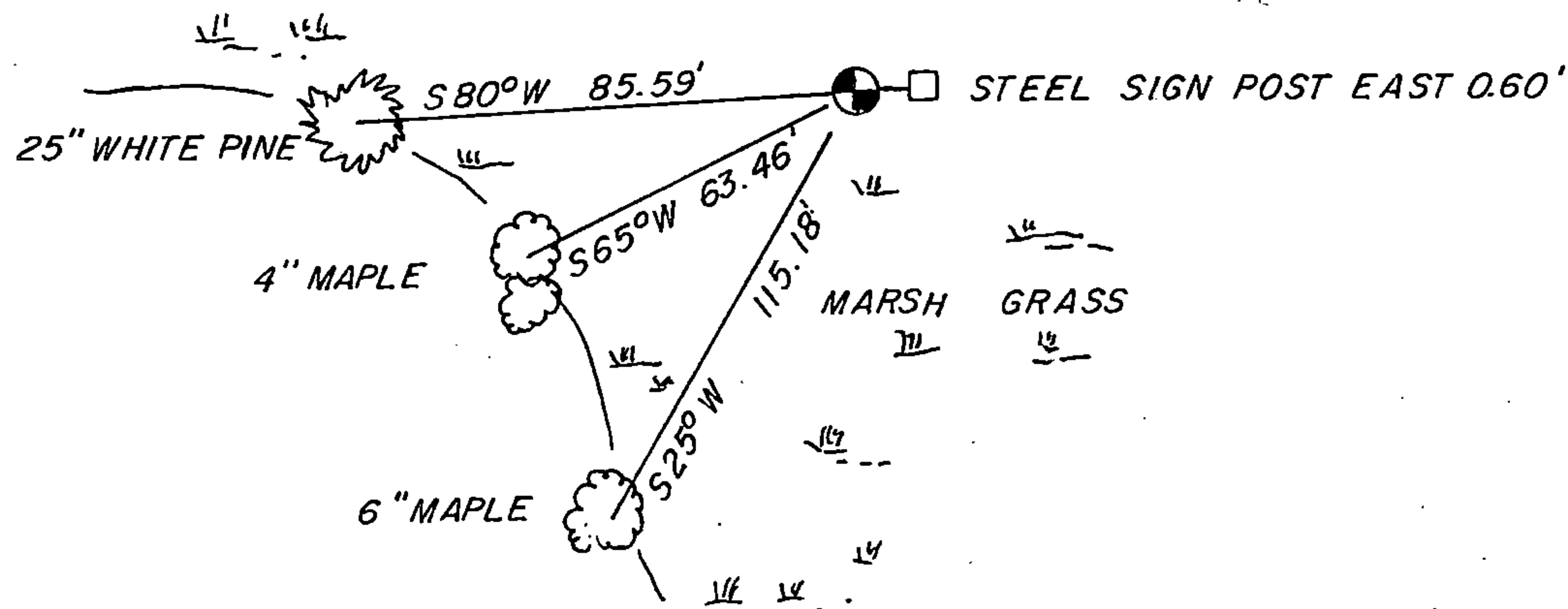

DOCUMENT NUMBER
143537

I, Kim H Pritzlaff, Contractor with USFS
(Type or print name) certify that the corner location shown on this record was determined by me or under my direction and control and that this U.S. Public Land Survey Monument Record is correct and complete to the best of my knowledge and belief.

Kim H. Pritzlaff

Signature

11/30/91

Date

43615120020