

CERTIFIED LAND CORNER RESTORATION

State of Wisconsin }
County of Forest } ss.

I William B. Cochrane, do hereby certify that on the 12th day of May, 1980, I found evidence of the Northeast Section corner of Section 22 Township 36 North, Range 15 East, Fourth Principal Meridian, as described hereon; and that from this evidence I established a new monument and accessories as described hereon to perpetuate the original location of this corner:

Description of original monument and accessories and subsequent restorations:

Surveyed in 1859 by James McBride.
North between Sections 22 and 23, 80.00 chains set post corner to sections 14, 15, 22 and 23.
Hemlock, 18 inches, N26W, 44 links
Elm, 10 inches, N66E, 47 links
Hemlock, 24 inches, S64E, 16 links
Hemlock, 18 inches, S17W, 27 links.

Description of corner evidence found:

2 inch iron pipe, 2 feet above ground in a mound of stone.
Very old and quite decayed wood post alongside pipe.
N26W, 44 links, Hemlock stump hole
N66E, 49 links, Elm stump, partially decayed, faceblaze lying alongside stump
S64E, 16 links, large Hemlock stump hole
S17W, 27 links, Hemlock stump hole

Description of monument and accessories I established to perpetuate the location of this corner:

I replaced the iron pipe with a 2½ inch diameter aluminum pipe, 3 feet long, with an aluminum cap stamped:
T36N, R15E, S14, S15, S22, S23, 1980, S-1107
Hemlock, 9 inches, N53E, 30.60 feet
Hemlock, 13 inches, S10E, 10.13 feet
Hemlock, 9 inches, S76W, 48.64 feet
Basswood, 8 inches, N60W, 28.50 feet
Placed mound of stone around monument.

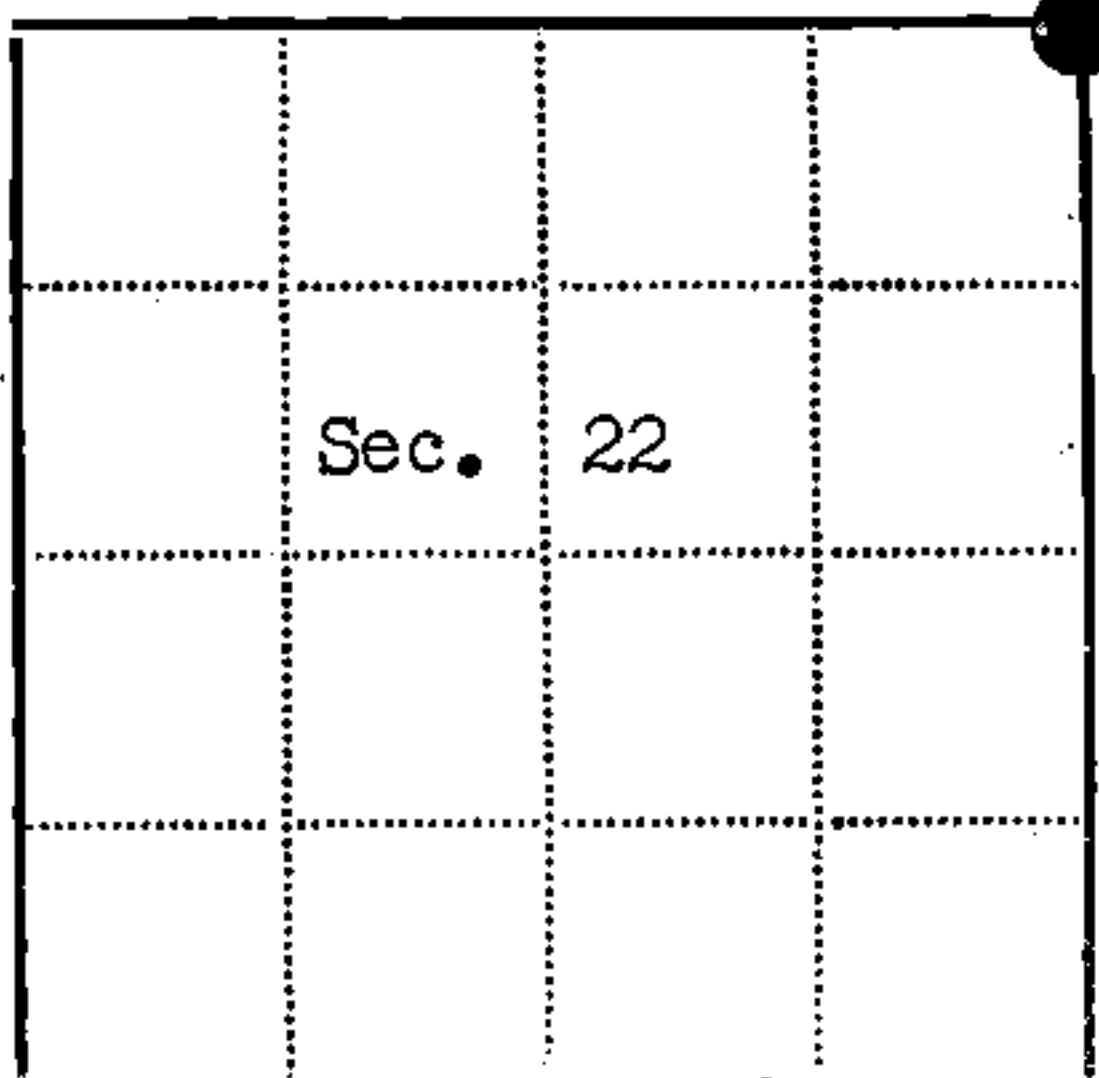
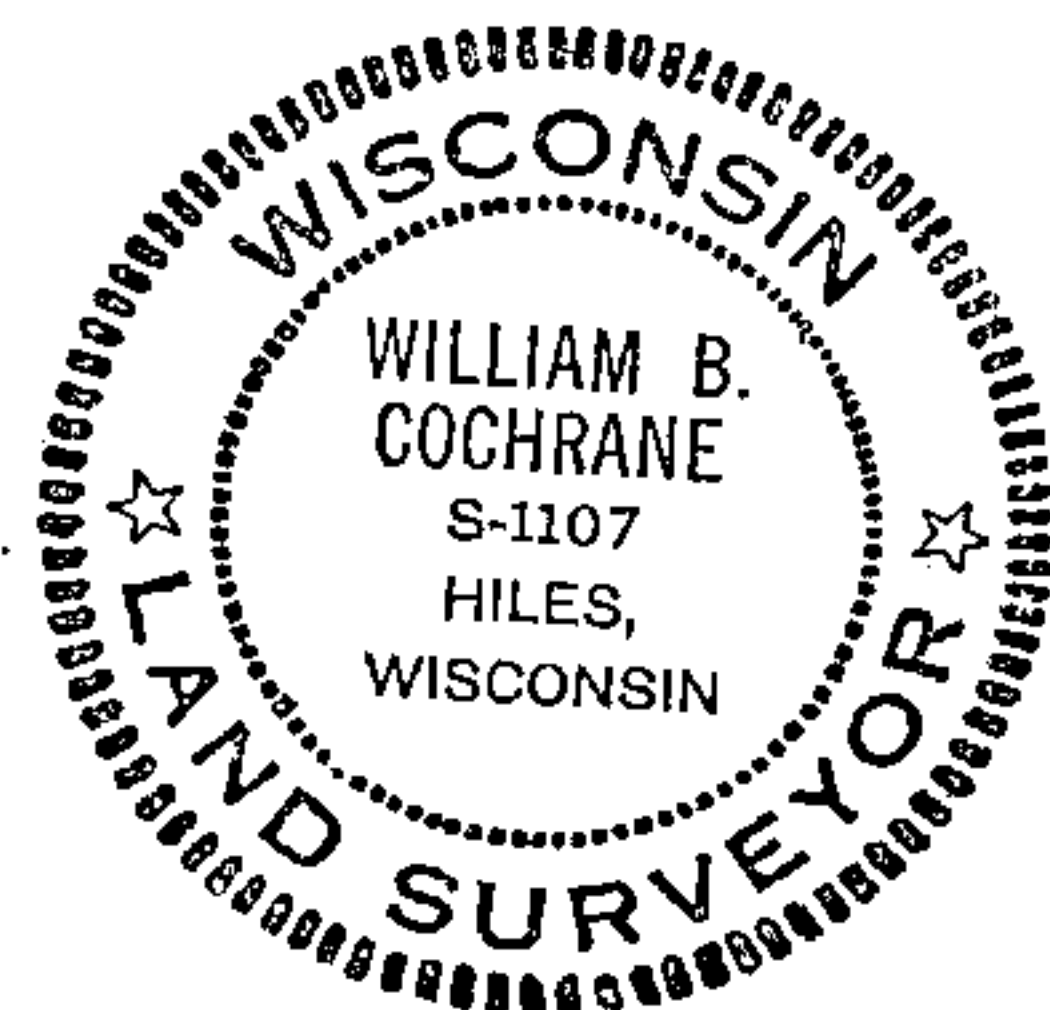

● - Corner monument restored
□ -

Resident witnesses.....

Dated at Laona Wisconsin, this 28th day of May 1980.

Signature William B. Cochrane Title Land Surveyor
(County Surveyor, Registered Land Surveyor, or other duly authorized official)

Surveyors Registration No. S-1107 DOCUMENT NO. 118075

Office of Register of Deeds County of Forest

I hereby certify that the within instrument was filed in this office for record on the 9th day of June 1980, and was filed in Book No. Page No. of County Records.

Signature Sharon Mueller Title Deputy

Township 36 North, Range 15 East, Section 22, Index No. N-17, Page No.

431615150000

N 17