

CERTIFIED LAND CORNER RESTORATION

State of Wisconsin }
County of Forest } ss.

I William B. Cochrane, do hereby certify that on the 14th day of May, 1980, I found evidence of the North quarter corner of Section 22 Township 36 North, Range 15 East, Fourth Principal Meridian, as described hereon; and that from this evidence I established a new monument and accessories as described hereon to perpetuate the original location of this corner:

Description of original monument and accessories and subsequent restorations:

Surveyed in 1859 by James McBride.
West corrected between Sections 15 and 22, 40.20 chains set $\frac{1}{4}$ section post.
Sugar, 12 inches, N21E, 3 links
Hemlock, 12 inches, S71W, 3 links.

Description of corner evidence found:

1 inch iron rod in a mound of rock. Old decayed wood post lying next to the iron rod.
Sugar maple stump, N21E, 3 links.
Hemlock stump, S71W, 3 links.

Description of monument and accessories I established to perpetuate the location of this corner:

I replaced the iron rod with a $2\frac{1}{2}$ inch diameter, aluminum pipe, 3 feet long, with an aluminum cap stamped:
T36N, R15E, $\frac{1}{4}$, S15, S22, 1980, S-1107.

Blazed and scribed the following new bearing trees:
Hemlock, 18 inches, N19W, 16.54 feet
Sugar Maple, 6 inches, N53E, 17.62 feet

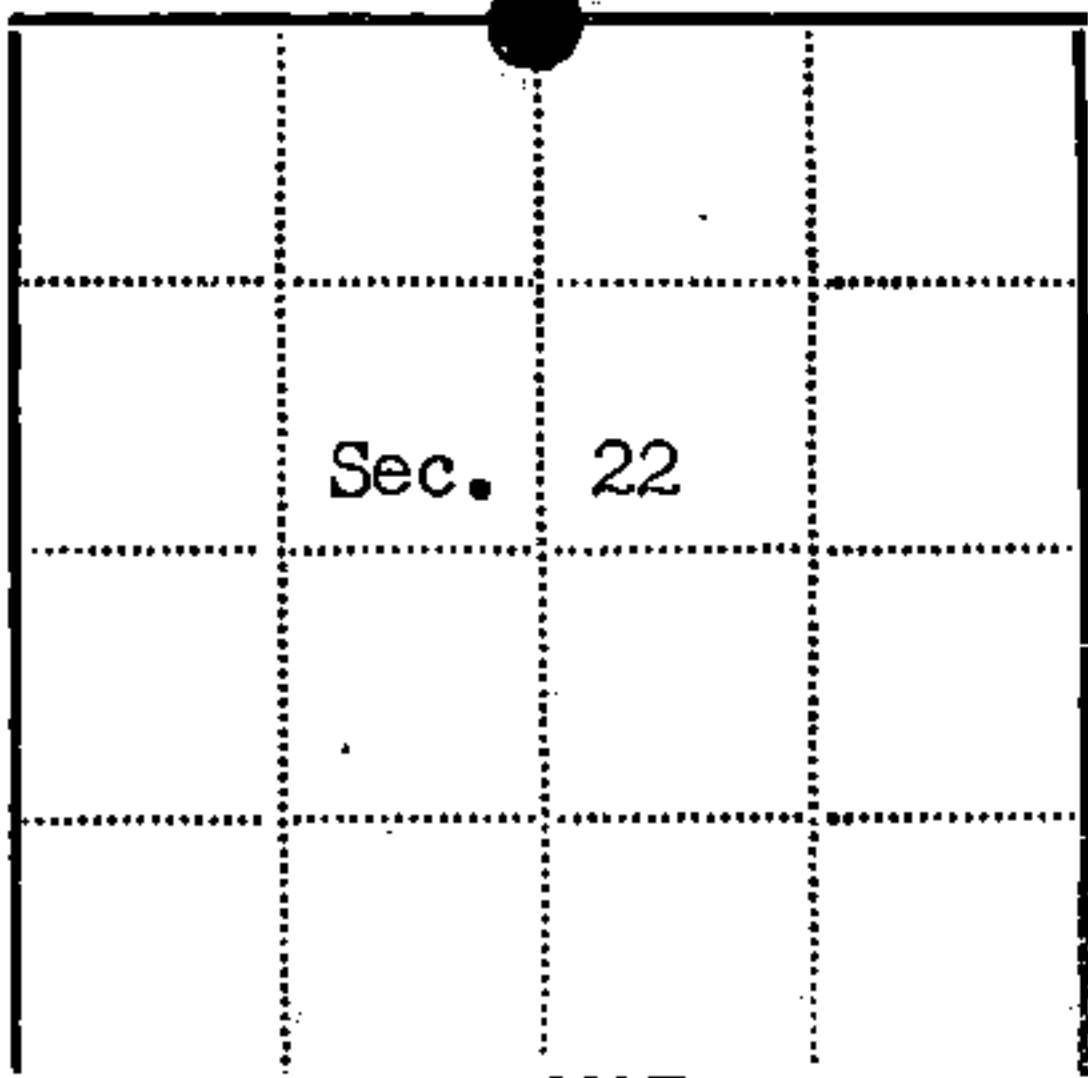
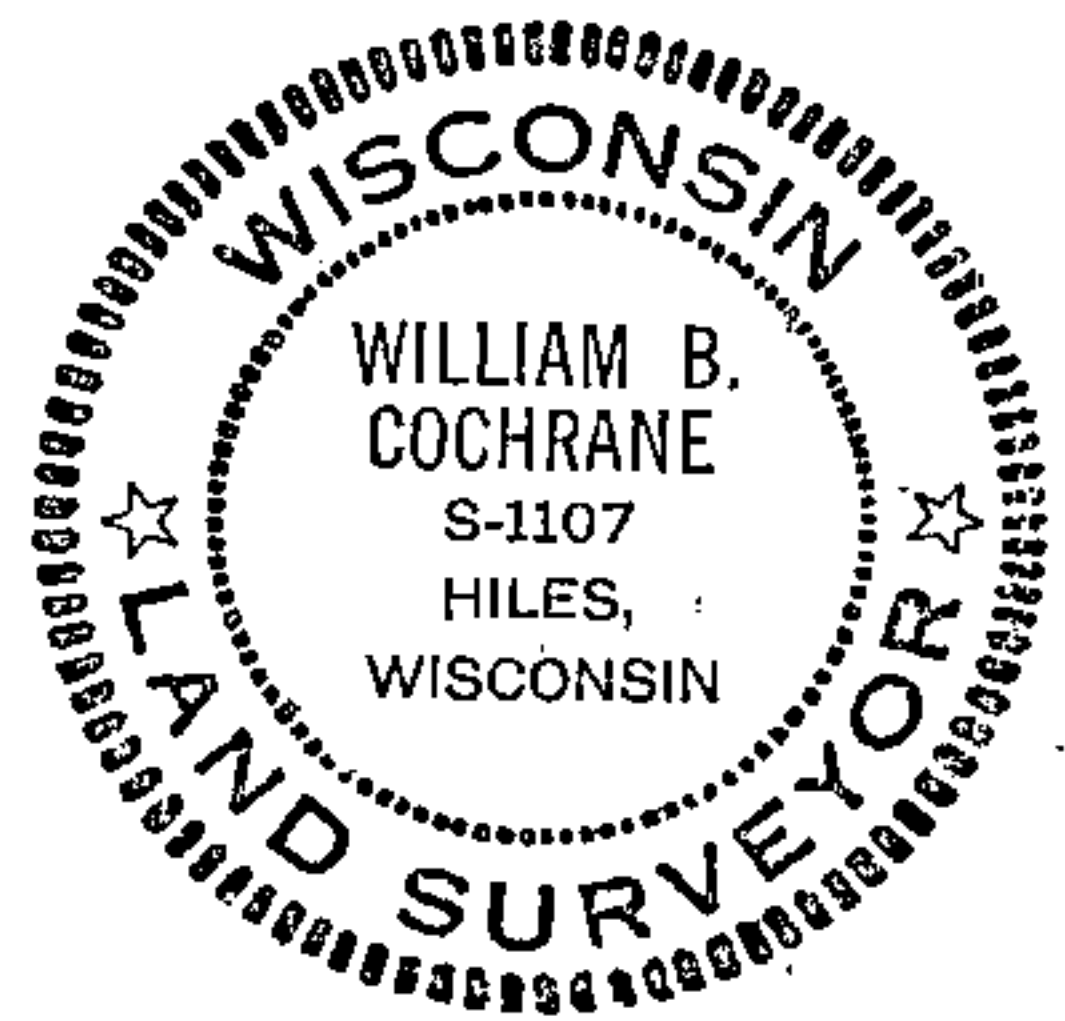

● - Corner monument restored
□ -

Resident witnesses.....

Dated at Laona Wisconsin, this 27th day of May 1980.

Signature William B. Cochrane Title Land Surveyor
(County Surveyor, Registered Land Surveyor, or other duly authorized official)

Surveyors Registration No. S-1107 DOCUMENT NO. 118074

Office of Register of Deeds County of Forest

I hereby certify that the within instrument was filed in this office for record on the 9th day of June 1980, and was filed in Book No. Page No. of County Records.

Signature Sharon Mueller Title Deputy

Township 36 North, Range 15 East, Section 22, Index No. N-15, Page No.

43615150020

N15

N-15

U. S. PUBLIC LAND SURVEY MONUMENT RECORD

INDEX NO. N-15

Quarter Corner to Section 15 22 T 36 N, R 15 E
(Section/Quarter)

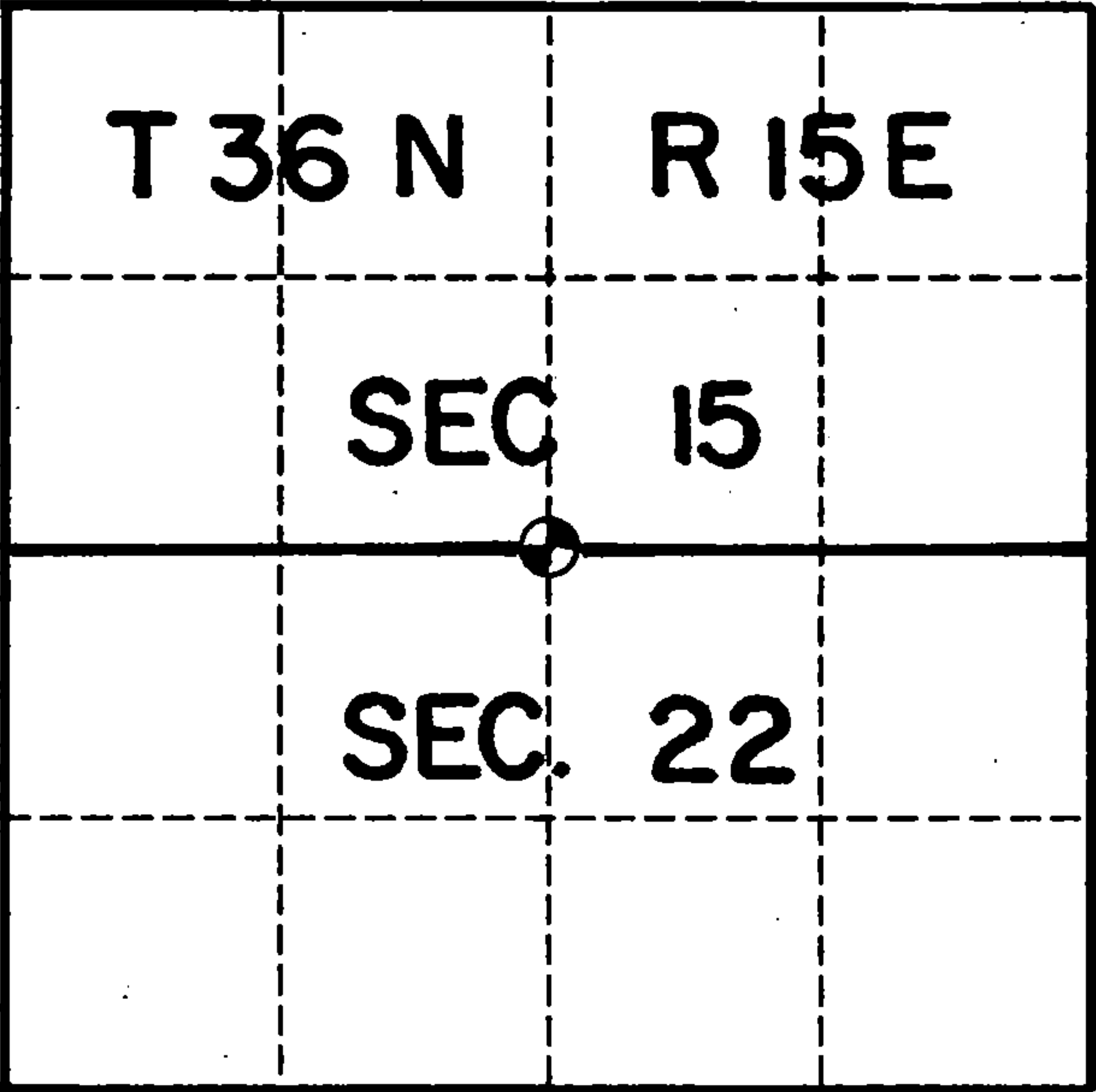

Show distances and bearings if set by proportional measurement.

History of original corner establishment, record evidence, monument evidence, occupational evidence, testimonial evidence or any other material evidence, and what you found and how the monument was set.

In 1859 James McBride set a wood post at this corner location with the following scribed bearing trees:
Sugar 12" N21°E 3 links
Hemlock 12" S 71°W 3 links

In 1980 Bill Cochran found a 1" iron rod and decayed wood post and stumps of the original bearing trees. He set a 2½" aluminum post at this corner location and marked two bearing trees, a Hemlock and Sugar.

I found Cochran's monument in good shape along with his two bearing trees, now a 20" Hemlock and a 10" Sugar. I blazed and scribed two more trees and set a steel sign post as noted below.

In the plan view drawing below, provide reference ties to at least 4 witness monuments, or, if the location is within a municipality, to at least 2 witness monuments. (Witness monuments shall be made of concrete, natural stone, iron or other equally durable material, except wood other than bearing trees.) Also, show any material discrepancies between the corner restored or re-established and the location of any other previous corner location or occupation.

○ = Corner monument restored.



Corner consists of a 2½" aluminum post with cap stamped for corner. Distances are to nails in the trees which are scribed "BT" and blazed. Bearings are magnetic.

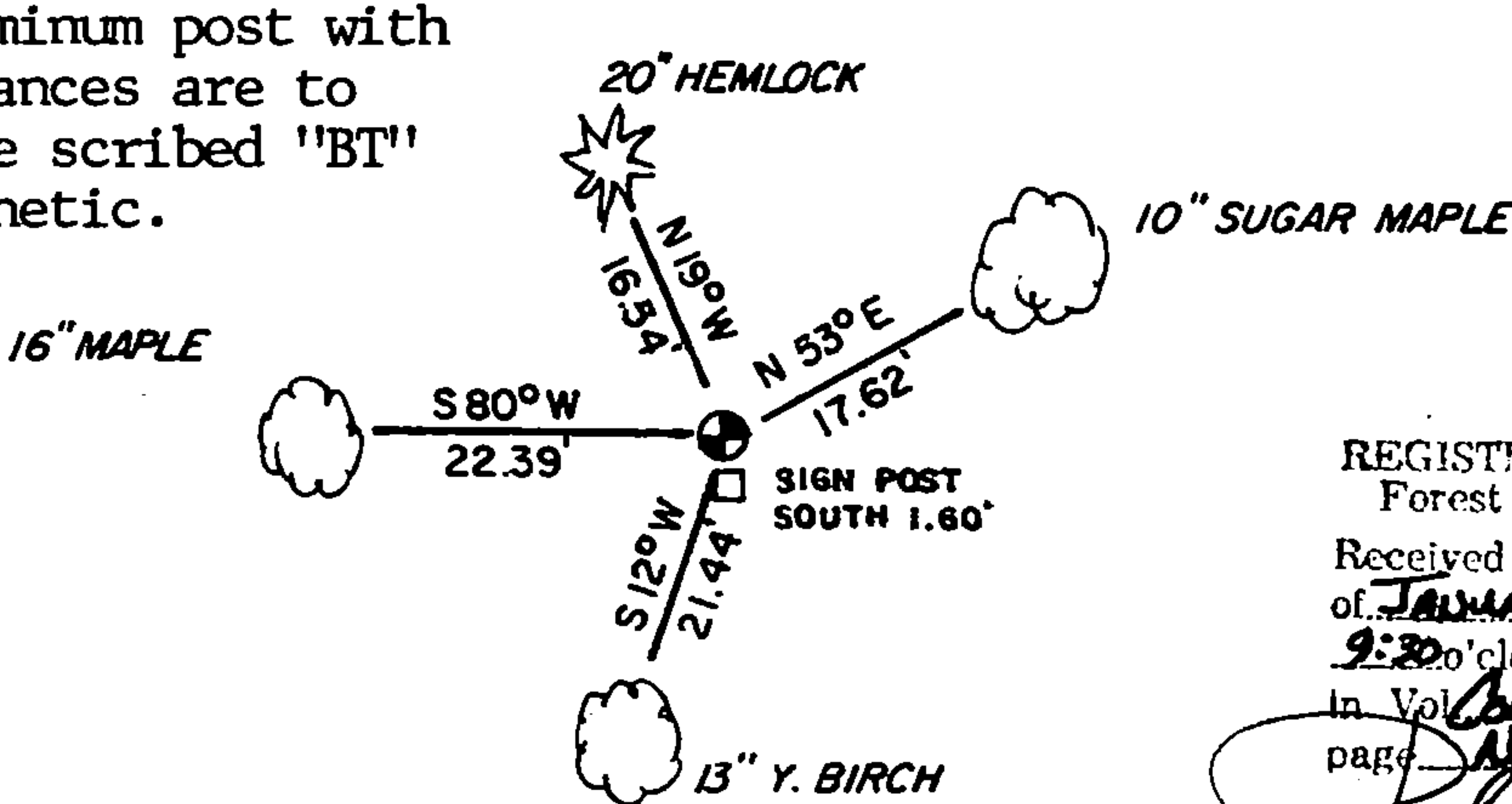

I, Kim H Pritzlaff, Contractor for the USFS
(Type or print name) certify that the corner location shown on this record was determined by me or under my direction and control and that this U.S. Public Land Survey Monument Record is correct and complete to the best of my knowledge and belief.

Kim H. Pritzlaff

Signature

11/30/91

Date

REGISTER'S OFFICE
Forest County, Wis.
Received for record this 300 day
of January A.D. 1992 at
9:20 o'clock A.M. and recorded
in Vol. Deer Restoration
page N-15

Paul Heisterunner
Register of Deeds

DOCUMENT NUMBER

143541

43615150020