

U. S. PUBLIC LAND SURVEY MONUMENT RECORD

INSTRUCTIONS: This record shall show the location of the corner and shall include all of the following nine elements (a through i).

- (a) Identify the corner by reference to the U.S. public land survey system.

○ = Corner monument restored.

Section corner to Sections 19, 24, 25, and 30, T.37N., R.11-12E., Forest County and Oneida County, Wisconsin.

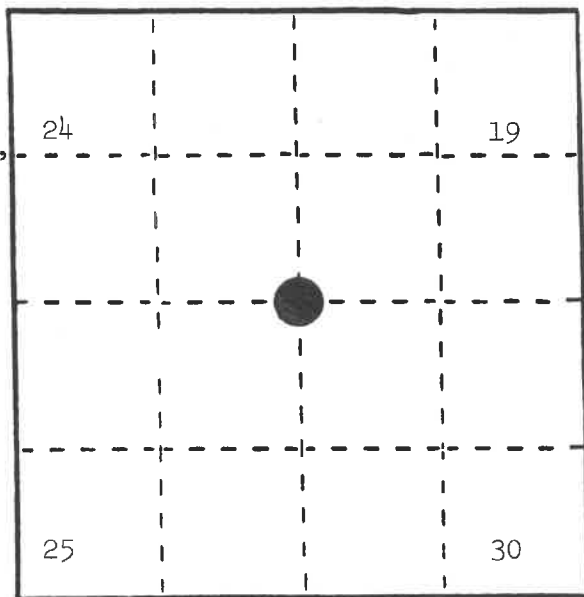

REGISTER'S OFFICE
Forest County, Wis.

Received for record this 14th day
of March A.D., 1986 at
10:25 o'clock A.M. and recorded
in Vol. CORNER RESTORATION
page R-1
Paul Aschenbrenner
Register of Deeds

- (b) Describe any record evidence, monument evidence, occupational evidence, testimonial evidence or any other material evidence you considered, and whether the monument was found or placed.

See corner certificate on file dated February 13, 1968.

In 1984, Milo Stefan found corner as called for on filed certificate, made new references.

- (c) In the plan view drawing below, provide reference ties to at least 4 witness monuments, or, if the location is within a municipality, to at least 2 witness monuments. (Witness monuments shall be made of concrete, natural stone, iron or other equally durable material.)
Describe witness monuments.

- (d) Show a plan view drawing depicting the relevant monuments and reference ties which is sufficient in detail to enable accurate relocation of the corner monument if the corner monument is disturbed. Indicate north.

1. Black Spruce, 3", S.31°E., 26.73 feet
2. Spruce, 3", N.56°E., 37.21 feet
3. Tamarack, 2", S.49°E., 75.60 feet
4. Spruce, 4", S.82°W., 87.64 feet
5. Wood post with monument sign, East, 1.35 feet
6. 2" inside diameter iron pipe with a brass cap stamped to identify the corner.

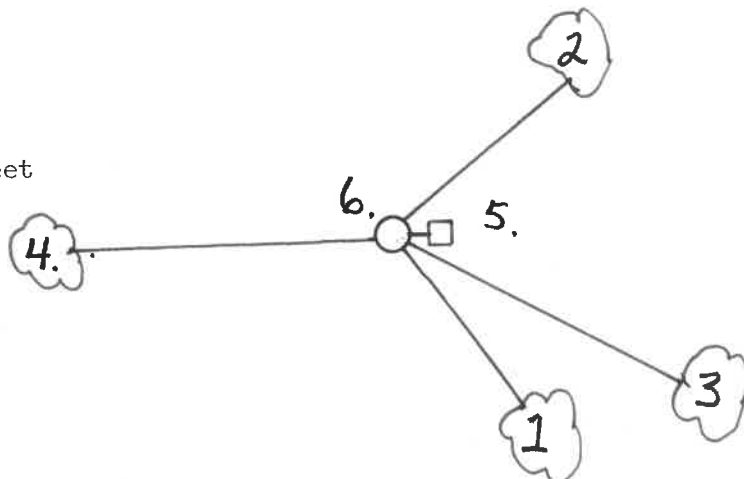

- (e) Describe any material discrepancy between the location of the corner as restored or reestablished and the location of that corner as previously restored or reestablished by distance and direction. Show the discrepancy on the plan view drawing under (d), above. Show the distances between the corner as previously restored or reestablished and (1) the corner as restored or reestablished, and (2) to at least 2 of the witness monuments shown on the drawing in (d), above.

See certificate on file.

- (f) Was the corner restored through acceptance of (1) an obliterated evidence location, or, (2) a found perpetuated location?

See certificate on file.

- (g&h) Was the corner reestablished through lost corner proportionate methods? If so, show the method, including the directions and distances to other public land survey corners used as evidence or used for proportioning in determining the corner location?

See certificate on file.



(1) I, Milo E. Stefan

(Type or print name) certify that the corner location shown on this record was determined by me or under my direction and control and that this U.S. Public Land Survey Monument Record is correct and complete to the best of my knowledge and belief.

Milo E. Stefan
Signature

5/28/85
Date

CERTIFIED LAND CORNER RESTORATION

State of Wisconsin

County of Forest

ss.

I Jean F. Resvick, do hereby certify that on the 12th day of February, 1968, I found evidence of the Northwest section corner of 30 Township 37 North, Range 12 East, Fourth Principal Meridian, as described hereon; and that from this evidence I established a new monument and accessories as described hereon to perpetuate the original location of this corner:

Description of original monument and accessories and subsequent restorations:

Surveyed in 1858 by Alfred Millard.

80.00 ch. North between Sections 25 and 30

Set wood post.

Tamarack 6, N40W 50 links

Spruce 5, N69E 40 links

Tamarack 5, S30E 13 links

Tamarack 5, S70W 20 links

Description of corner evidence found:

3x3 squared cedar post, 5 ft. high.

Tamarack stump S30°E, 8.6 ft. with picket scribed OBT. evidence of healed over blaze on stump.

Tamarack snag 3", S46°W, 31.7 ft. scribed S25 NBT

Tamarack snag 3", N35°W, 30.1 ft., with F.S. location poster, scribed S24NBT

Tamarack snag 2", N31°E, 37.9 ft. scribed S19NBT

Description of monument and accessories I established to perpetuate the original location of this corner:

Replace cedar post with 2 inch inside diameter, galvanized wrought iron pipe, 5 feet long, filled with concrete with brass cap marked:

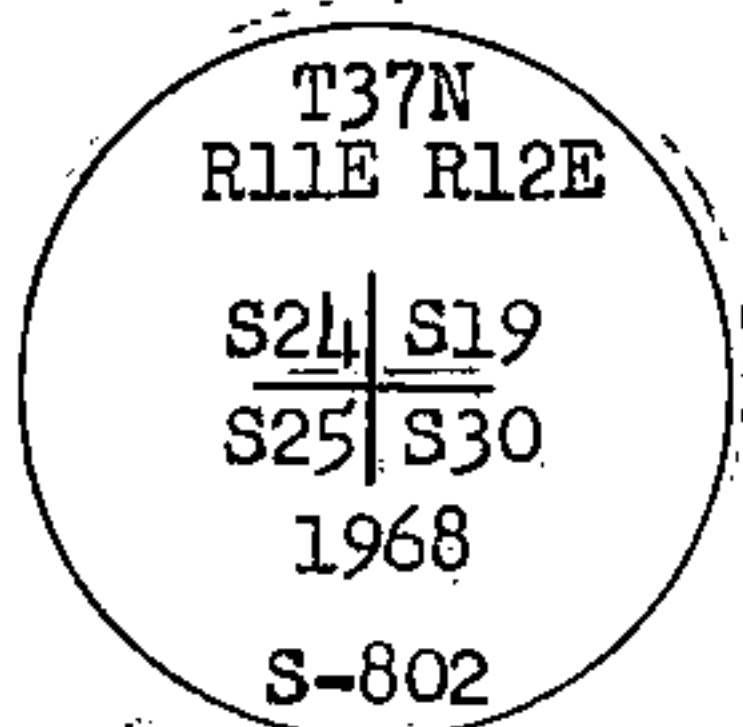

from which the following blazed and scribed new bearing trees bear:

Spruce 3", N56°E, 37.21 ft. or 56.38 lks.

Tamarack 2", S49°E, 75.60 ft. or 114.55 lks.

Spruce 4", S82°W, 87.64 ft. or 132.79 lks.

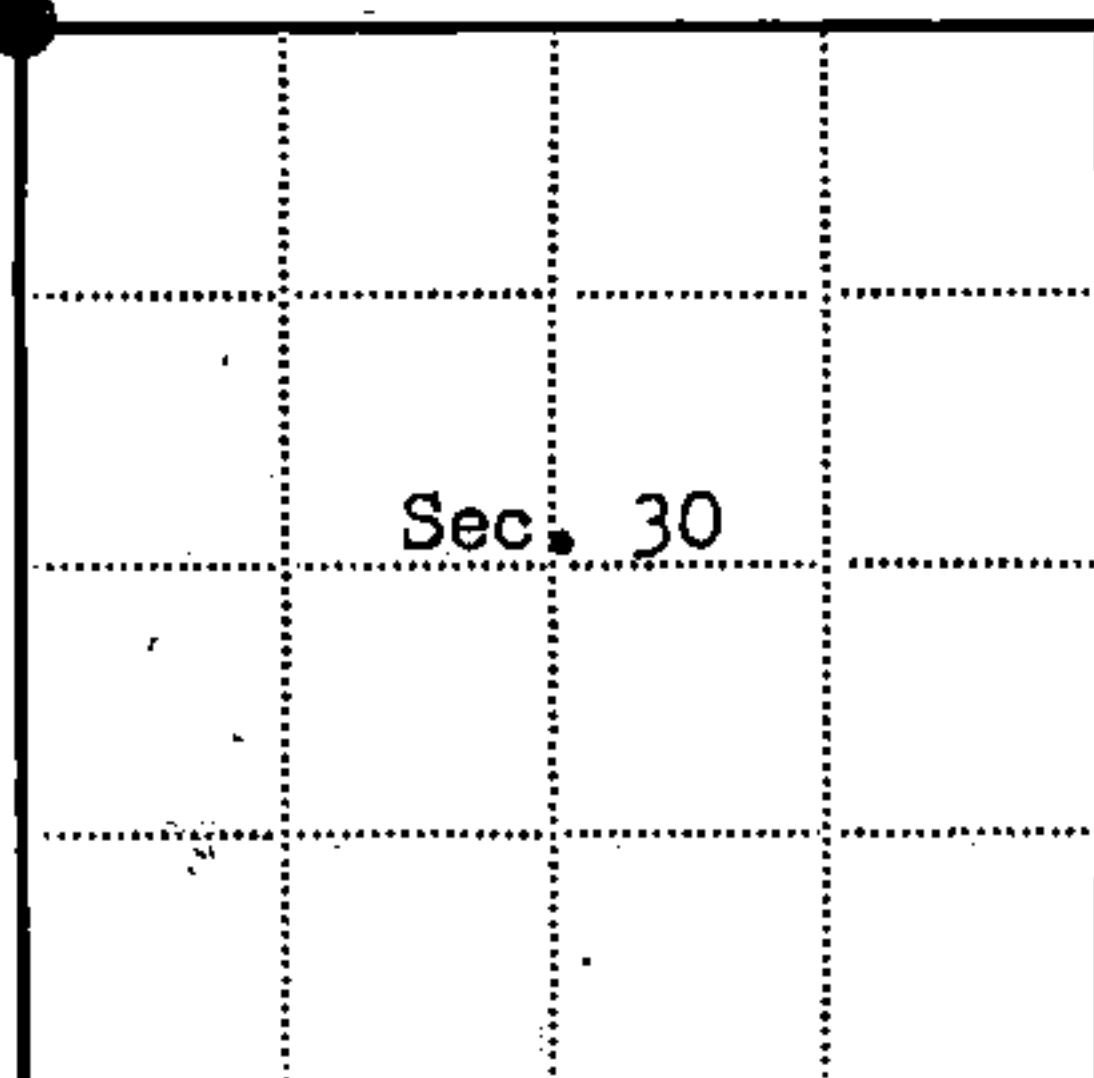

● = Corner monument restored

□ =

Resident witnesses

Dated at Rhineland Wisconsin, this 12th day of February, 1968.Signature Jean F. Resvick Title Cadastral Surveyor
(County Surveyor, Registered Land Surveyor, or other duly authorized official)Surveyors Registration No. S-802DOC. NO. 94221Office of Register of Deeds County of Forest

I hereby certify that the within instrument was filed in this office for record on the 27th day of February, 1968, and was filed in Book No. I Page No. of County Records.

Signature Eugene Staszny Title Register of DeedsTownship 37 North, Range 12 East, Section 30, Index No. R-1, Page No.

43711240000

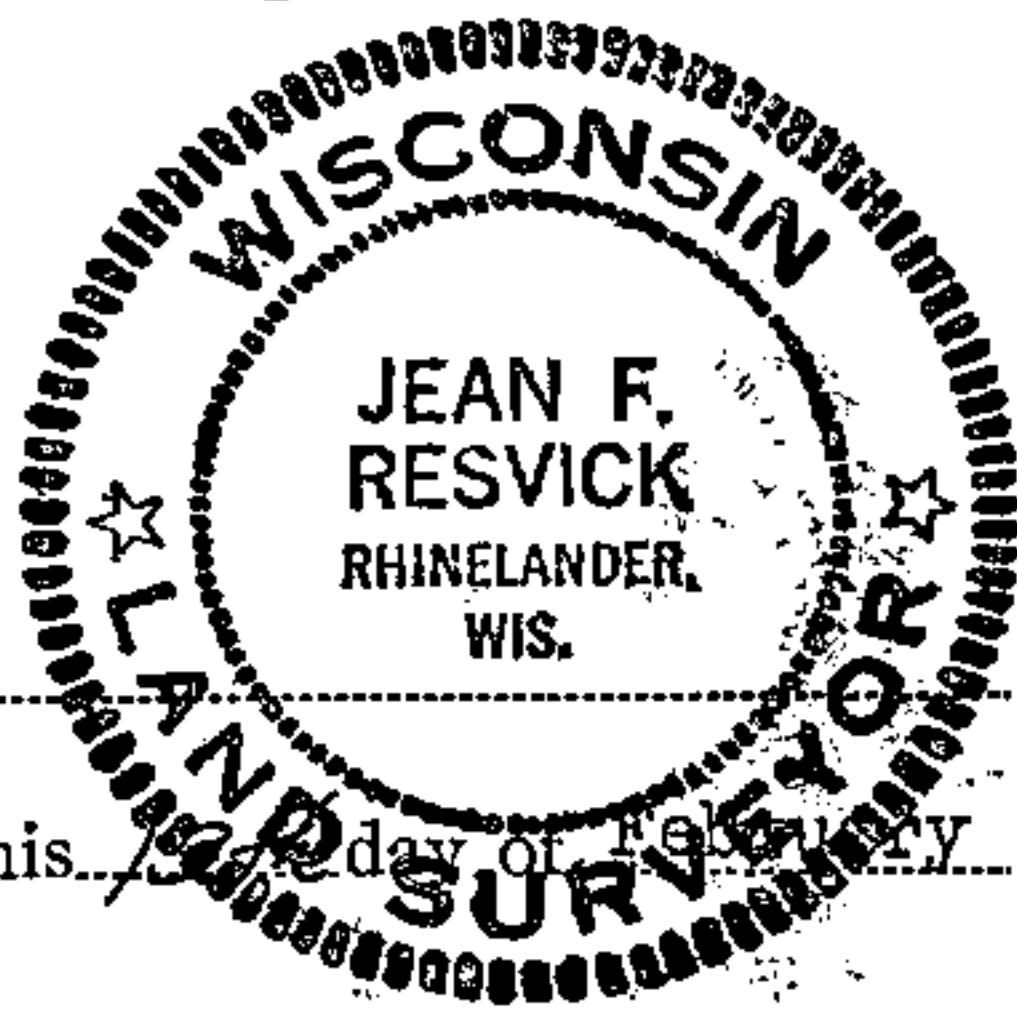

U. S. PUBLIC LAND SURVEY MONUMENT RECORD

INSTRUCTIONS:

This record shall show the location of the corner and shall include all of the following nine elements (a through i).

- (a) Identify the corner by reference to the U.S. public land survey system.
 O = Corner monument restored.

Section Corner to Sections 19 & 30,
 T.37N., R.12E., & Sections 24 & 25,
 T.37N., R.11E., 4th P.M.

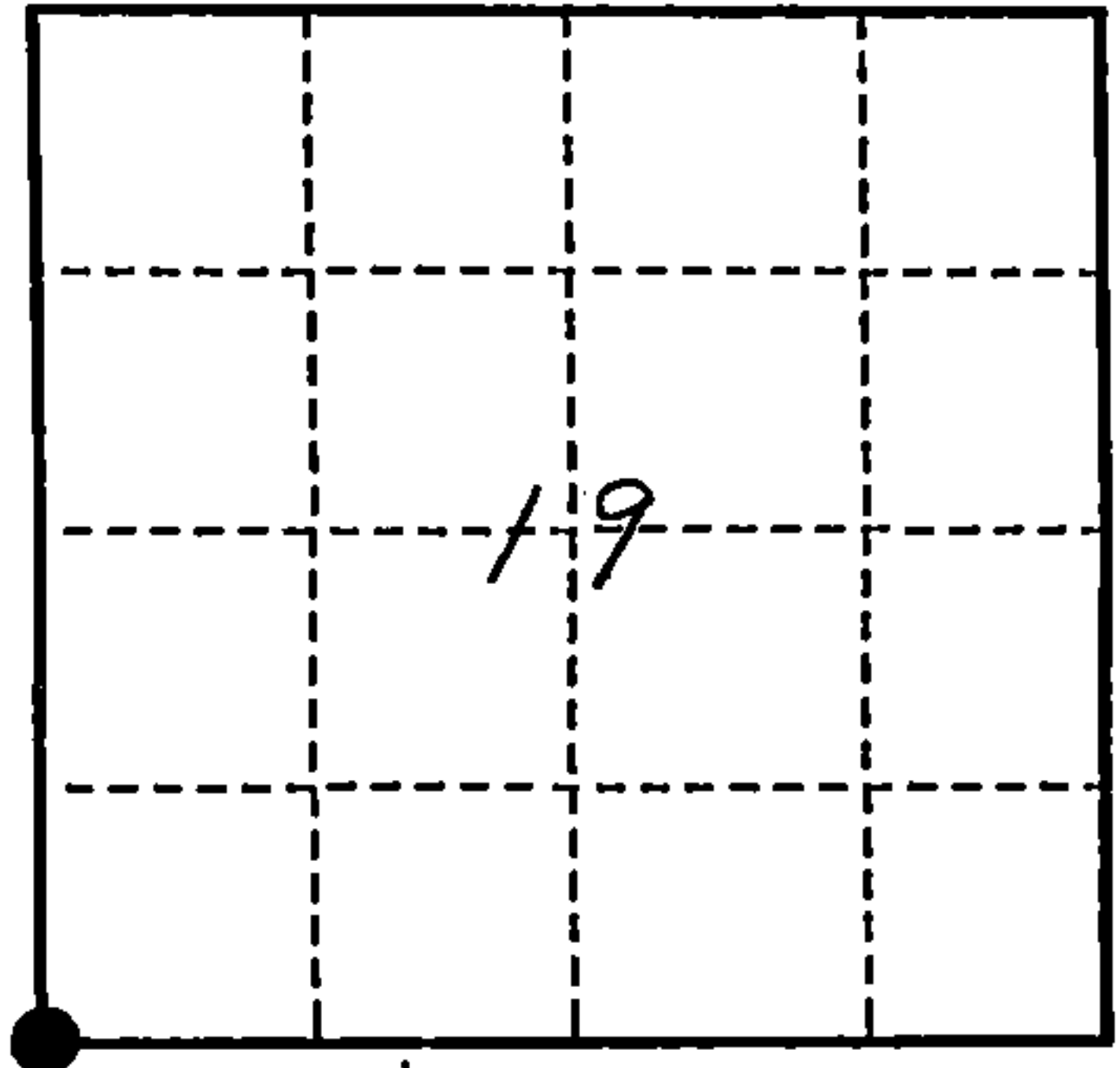

- (b) Describe any record evidence, monument evidence, occupational evidence, testimonial evidence or any other material evidence you considered, and whether the monument was found or placed.

Found 2" x 60" Forest Service monument set by Resvick in 1968. Only one BT, the 4" Spruce, S.82°W., 87.64' is still alive. We made three new BTs:

Spruce, 3", N.47°E., 22.71'
 Spruce, 3", S.40°W., 59.01'
 Tamarack, 8", N.72°W., 134.37'

- (c) In the plan view drawing below, provide reference ties to at least 4 witness monuments, or, if the location is within a municipality, to at least 2 witness monuments. (witness monuments shall be made of concrete, natural stone, iron or other equally durable material.)

- (d) Show a plan view drawing depicting the relevant monuments and reference ties which is sufficient in detail to enable accurate relocation of the corner monument if the corner monument is disturbed. Indicate north.

1. 2" x 60" Steel pipe with Brass Cap.
2. Spruce, 3", N.47°E., 22.71'
3. Spruce, 3", S.40°W., 59.01'
4. Spruce, 4", S.82°W., 87.64'
5. Tamarack, 8", N.72°W., 134.37'
6. 6" x 6" wood post, East, 1.35'
7. Steel sign post, South, .5'

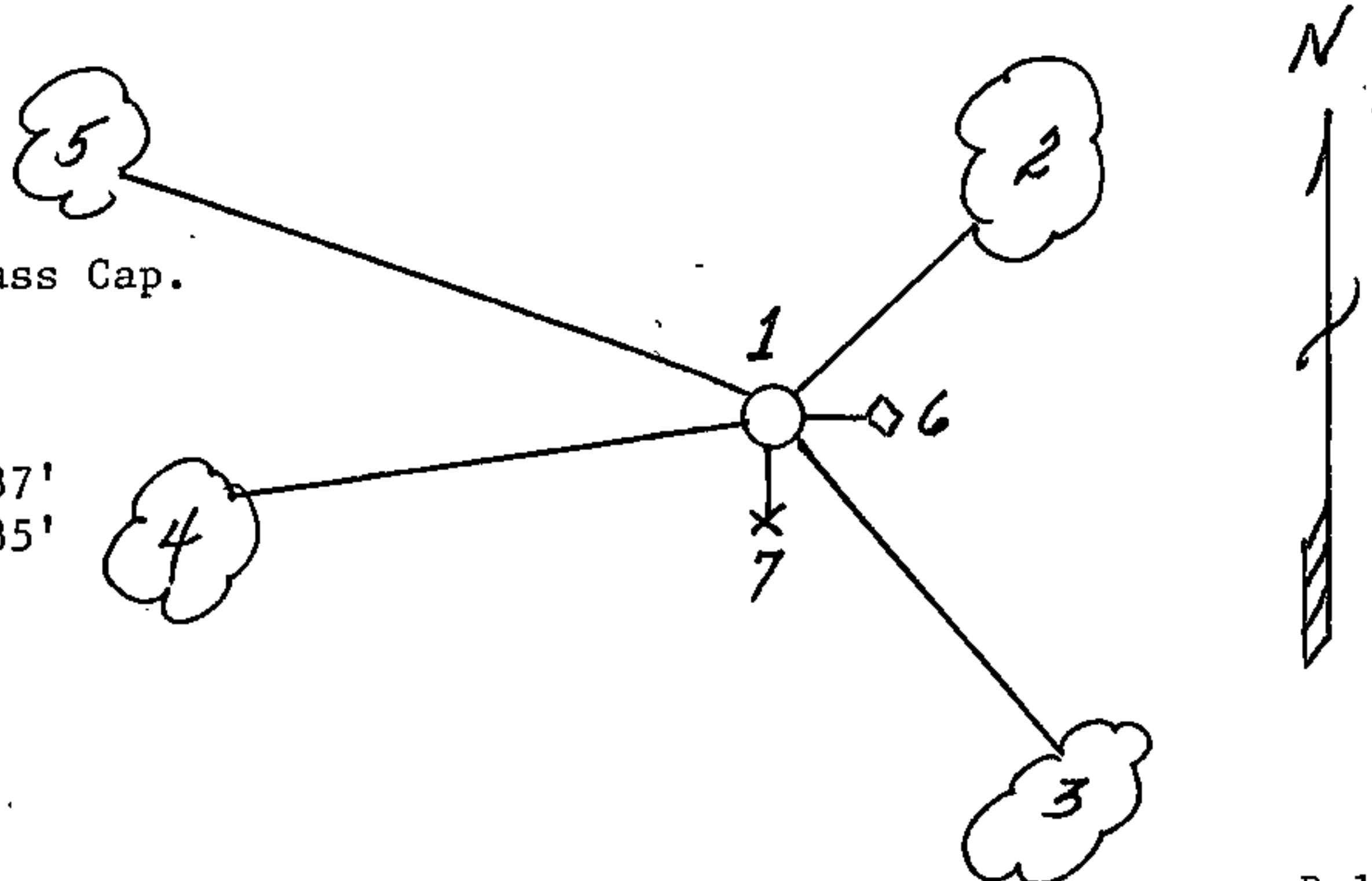

REGISTER'S OFFICE
 Forest County, Wis.

Received for record this 24 day
 of March A.D., 1993 at
2:15 o'clock PM and recorded
 in Vol 37-11-12 Corner Restorations
 page R-1

Paul C. H. Deputy
 Register of Deeds

R-1

R-1

4371124 0000

(e) Describe any material discrepancy between the location of the corner as restored or reestablished and the location of that corner as previously restored or reestablished by distance and direction. Show the discrepancy on the plan view drawing under (d). above. Show the distances between the corner as previously restored or reestablished and (1) the corner as restored or reestablished, and (2) to at least 2 of the witness monuments shown on the drawing in (d), above.

N/A

(f) Was the corner restored through acceptance of (1) an obliterated evidence location, or, (2) a found perpetuated location?

(2)

(g & h) Was the corner reestablished through lost corner proportionate methods? If so, show the method, including the directions and distances to other public land survey corners used as evidence or used for proportioning in determining the corner location?

N/A

(1) I, Milo E. Stefan

(type or print name) certify that the corner location shown on this record was determined by me or under my direction and control and that this U.S. Public Land Survey Monument Record is correct and complete to the best of my knowledge and belief.

Milo E. Stefan
Signature

November 25, 1992

Date

CERTIFICATE READY FOR FILING:

Dale R. Covey
Acting District Ranger

