

CERTIFIED LAND CORNER RESTORATION

Index No. **J-13**

State of Wisconsin }
County of Forest } ss.

I Thomas R. Arnott, do hereby
certify that on the 15th day
of December, 1975, I found
evidence of the section
corner of sections 9, 10, 15, & 16
Township 37, North, Range
12 E, Fourth Principal Meridian,
as described hereon; and that from this evidence
I established a new monument and accessories
as described hereon to perpetuate the original
location of this corner.

Resident witnesses:

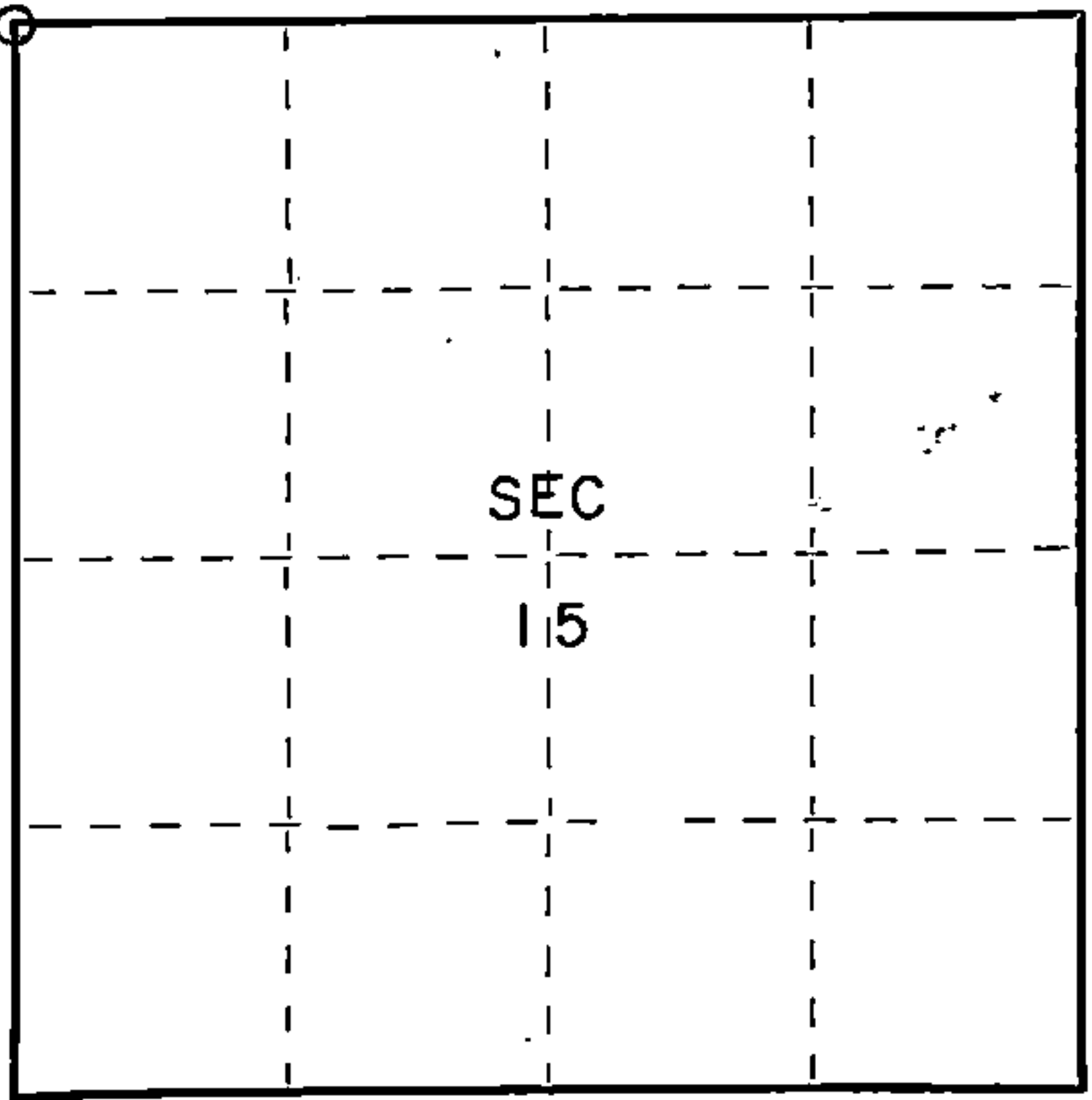

○ = Corner monument restored.

History of original corner establishment:

Original subdivision by William Daugherty Aug. 17 - Aug. 23, 1859

Cedar	10	S15E	14 Lks.
Cedar	10	S82W	21 Lks.

Description of corner evidence found:

Wood post found
iron pipe found
iron pipe found with brass cap 2" below ground surface



Description of monument and accessories I established to perpetuate the original location of this corner

Left iron pipe with brass cap

Ties:

Power pole (3712-10L17)	N12W	90.95 feet
NW corner of house	S44E	94.16 feet
1 1/2" iron pipe along side and to East of corner		

Dated at Crandon, Wis., this 16th day of December, 1975.

Signature Thomas R. Arnott Title Land Surveyor Registration No. S-887
(County Surveyor, Registered Land Surveyor, or other duly authorized official)

Office of Register of Deeds, County of Forest, I hereby certify that the within
instrument was filed in this office for record on the 16th day of December, 1975
at 11 o'clock A. M.

Eugene Stating Document Number
(Register of Deeds)

By _____ Deputy

108399

43712090000

U.S. PUBLIC LAND SURVEY MONUMENT RECORD

Index No. J-13

State of Wisconsin

County of FOREST ss.

I, John C. Schulke, do hereby certify that on the 13th day of June, 1986, I found evidence of the Northeast corner of Section 16 Township 37 North, Range 12 East, Fourth Principal Meridian, as described hereon; and that from this evidence I established a new monument and accessories as described hereon to perpetuate the original location of this corner.

Resident witnesses:

History of original corner establishment:

Original Government Survey in 1859 by William Daugherty.

Corner restored on December 1975 by Thomas R. Arnott (S887), a Registered Land Surveyor.

See Certified Land Corner Restoration Certificate filed in the Register of Deeds Office, Document #108399, in the Forest County Courthouse.

Description of corner evidence found:

Recovered 1 1/2" dia, iron pipe, in place, with brass cap marked for identification of the corner. Wooden post along side the monument.

Recovered the following 1975 corner references:

Power Pole	3712-10L17	N16°E	90.9 feet
House	NW Corner	S44°E	94.1 feet
iron pipe	1 1/2"	East	along side the monument

Description of monument and accessories I established to perpetuate the original location of this corner.

Blazed, painted and scribed the following new corner references.

Scotch	9"	N75°W	10.63 feet
White Pine	12"	S36°W	42.75 feet
Black Ash	4"	N65°E	38.92 feet
Steel sign post		Southeast	0.4 feet

Dated at Ludington, Michigan, Wis., this fifth day of January, 1987.

Signature John C. Schulke Title Land Surveyor Registration No. S-1665
(County Surveyor, Registered Land Surveyor, or other duly authorized official)

Office of Register of Deeds, County of Forest, I hereby certify that the within instrument was filed in this office for record on the 24th day of February, 1987 at 2:00 o'clock P. M.

Paul Aschenbrenner
(Register of Deeds)

By Deputy

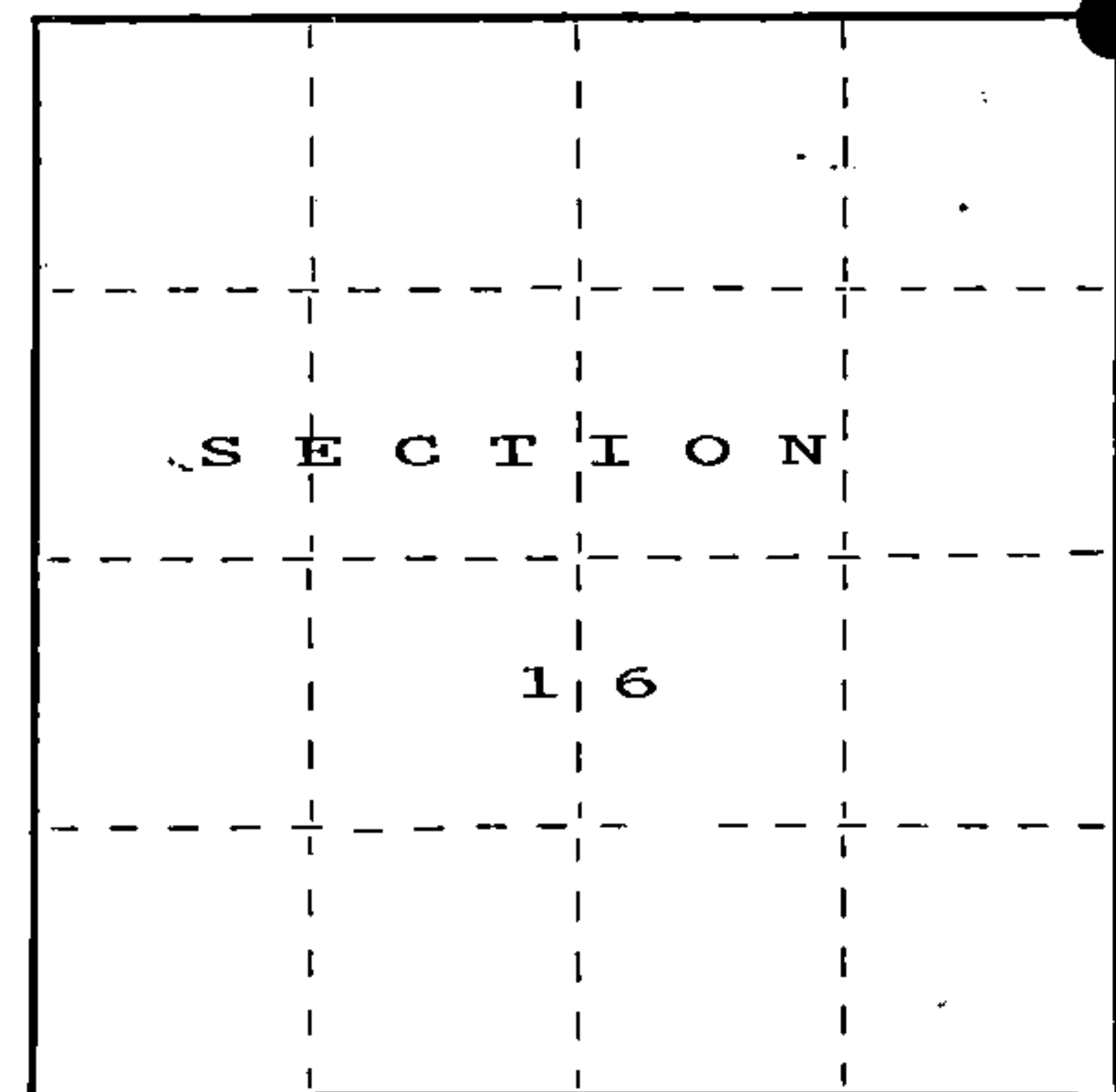

○ = Corner monument restored.

REGISTER'S OFFICE
Forest County, Wis.
Received for record this 24th day
of February, 1987 at
2:00 o'clock P.M. and recorded
in Vol. CORNER RESTORATIONS
page J-13
Paul Aschenbrenner
Register of Deeds

FORM NO. 985-A

H.C. Miller Company
ST. LOUIS, MISSOURI

Stock No. 26273

DOCUMENT NUMBER
132175

43712090000

(e) Describe any material discrepancy between the location of the corner as restored or reestablished and the location of that corner as previously restored or reestablished by distance and direction. Show the discrepancy on the plan view drawing under (d), above. Show the distances between the corner as previously restored or reestablished and (1) the corner as restored or reestablished, and (2) to at least 2 of the witness monuments shown on the drawing in (d), above.

No discrepancy, excepted existing corner.

(f) Was the corner restored through acceptance of (1) an obliterated evidence location, or, (2) a found perpetuated location?

Corner was restored through a found perpetuated location.

(g&h) Was the corner reestablished through lost corner proportionate methods? If so, show the method, including the directions and distances to other public land survey corners used as evidence or used for proportioning in determining the corner location?

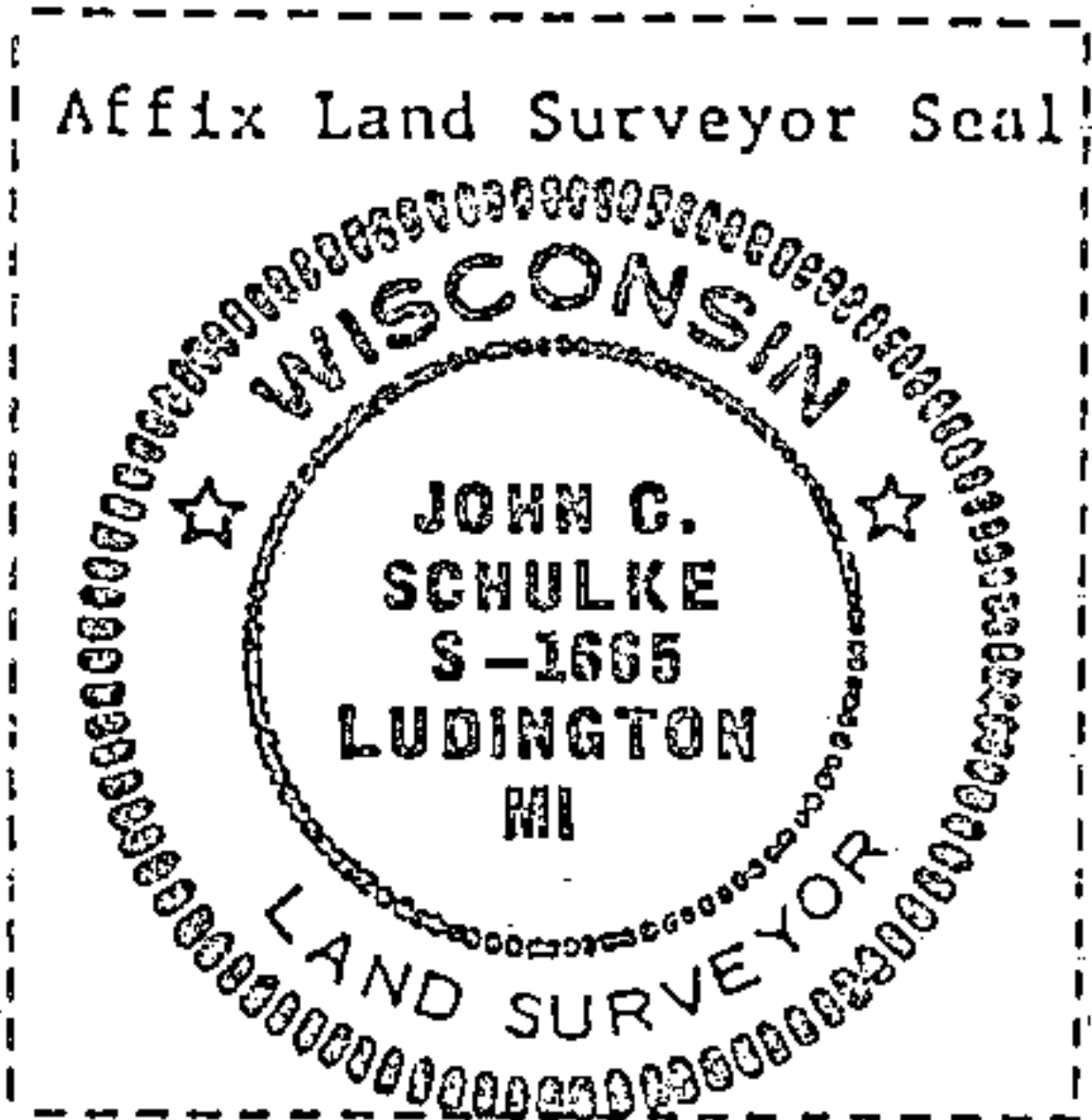
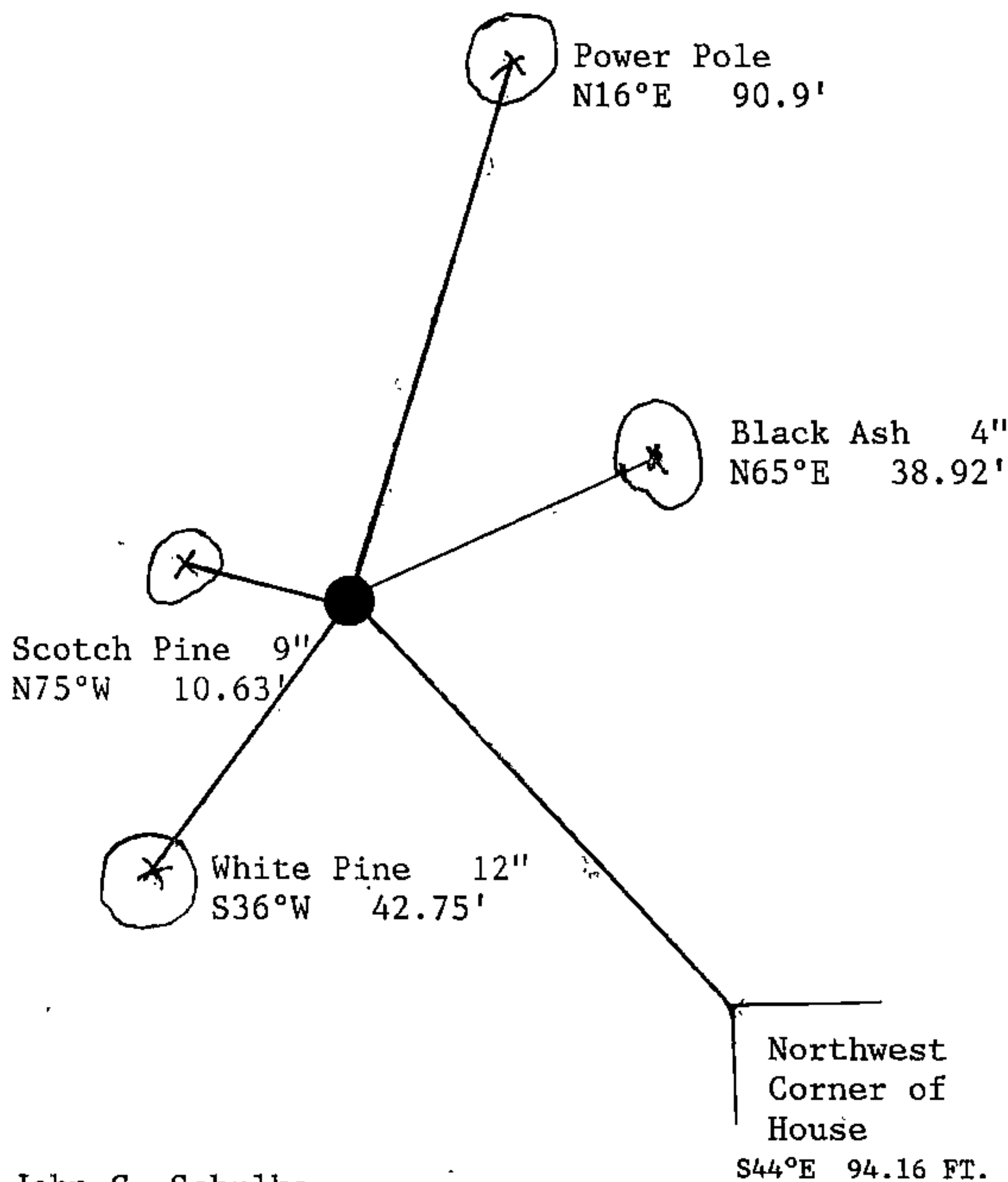

(i) I, John C. Schulke
(type or print name) certify that the corner location shown
on this record was determined by me or under my direction and
control and that this U.S. Public Land Survey Monument Record is
correct and complete to the best of my knowledge and belief.

John C. Schulke January 5th, 1987
Signature Date

Certificate Ready for Filing: Dale B. Stage 2/24/87
District Ranger Date