

U.S. PUBLIC LAND SURVEY MONUMENT RECORD

Index No. T-13

State of Wisconsin }
County of FOREST } ss.

I, John C. Schulke, do hereby certify that on the third day of September, 1986, I found evidence of the West Quarter corner of Section 27, Township thirty-seven, North, Range twelve East, Fourth Principal Meridian, as described hereon; and that from this evidence I established a new monument and accessories as described hereon to perpetuate the original location of this corner.

Resident witnesses:

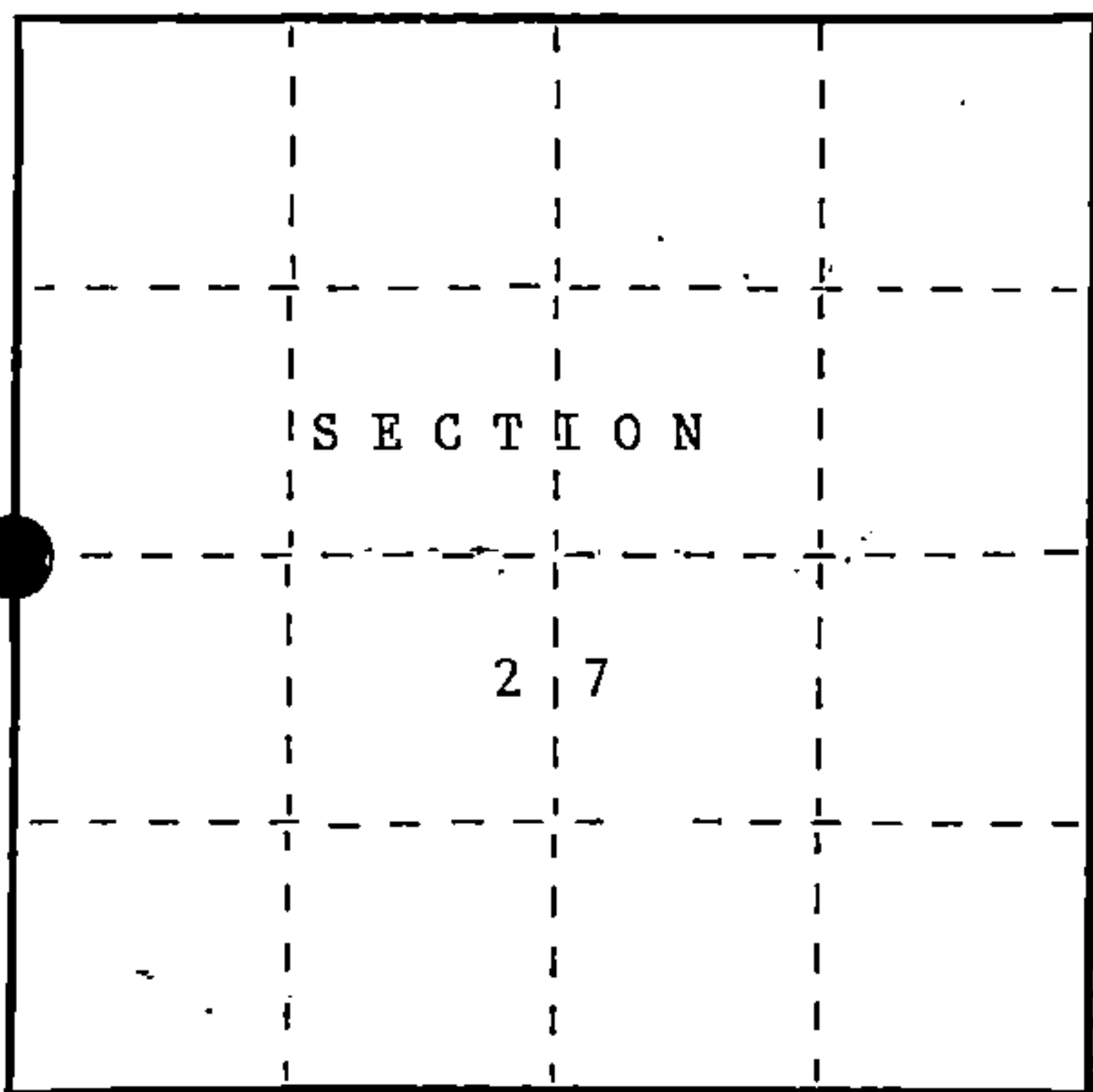

○ = Corner monument restored.

History of original corner establishment:

Original corner established in 1859 by William Daugherty, U.S. Deputy Surveyor. Set a wooden post with the following bearing trees:

Sugar Maple	8"	N34°W	20 lks.
Hemlock	6"	N78°E	8 lks.

North between Sections 27 and 28

11.00 ch	Enter swamp - bears east and west	40.00 ch	Set quarter corner
31.00 ch	Leave swamp - bears east and west	48.58 ch	Pine Lake, Set Meander Corner

Description of corner evidence found:

Found what appeared to be the location of the original post point for the quarter corner, with the following bearing trees for evidence:

Red Oak	37"	N34°W	13.2 feet
Hemlock Roots		N78°E	5.3 feet

The oak had scarring on the southeast side. The measured rate of growth indicated the tree was 5"-8" diameter at the time of the original survey. Note: the bark of a young oak is very similar to a young sugar maple. Also a search of Daugherty survey notes in several townships didn't show an oak used as a bearing tree.

Description of monument and accessories I established to perpetuate the original location of this corner.

Set a 2 1/2" diameter aluminum pipe monument, 36 inches long, 30 inches in the ground with an aluminum cap stamped; T37N, R12E, 1/4, S27, S28, 1986, S-1665. Established the following new bearing trees which are blazed, scribed, painted and tagged.

Twin Red Maple	4"	S11°E	15.12 feet
Red Maple	7"	N06°E	35.52 feet
Hemlock	20"	N72°E	9.96 feet
Steel sign post		West	0.7 feet

Dated at Hiles, Wis., this Eleventh day of November, 1987

Signature John C. Schulke Title Land Surveyor Registration No. S-1665
(County Surveyor, Registered Land Surveyor, or other duly authorized official)

Office of Register of Deeds, County of Forest, I hereby certify that the within instrument was filed in this office for record on the 2nd day of February, 1988 at 9:40 o'clock a. M.

Paul Aschenbrenner
(Register of Deeds)

By Deputy

FORM NO. 985-A

H.C. Miller Company

Stock No. 26273

DOCUMENT NUMBER 134574

37-12

43712282000

- (e) Describe any material discrepancy between the location of the corner as restored or reestablished and the location of that corner as previously restored or reestablished by distance and direction. Show the discrepancy on the plan view drawing under (d), above. Show the distances between the corner as previously restored or reestablished and (1) the corner as restored or reestablished, and (2) to at least 2 of the witness monuments shown on the drawing in (d), above.

Found concrete monument S49°42'W a distance of 409.67 feet. This monument has been used by at least two surveyors as the quarter corner in certified surveys. Numerous surveyors though have looked at this corner and didn't restore and certify that it was the correct place for the quarter corner. For additional information also see the corner certificate for the Meander Corner of Sections 27 and 28.

- (f) Was the corner restored through acceptance of (1) an obliterated evidence location, or, (2) a found perpetuated location?
An obliterated evidence location.

- (g&h) Was the corner reestablished through lost corner proportionate methods? If so, show the method, including the directions and distances to other public land survey corners used as evidence or used for proportioning in determining the corner location?

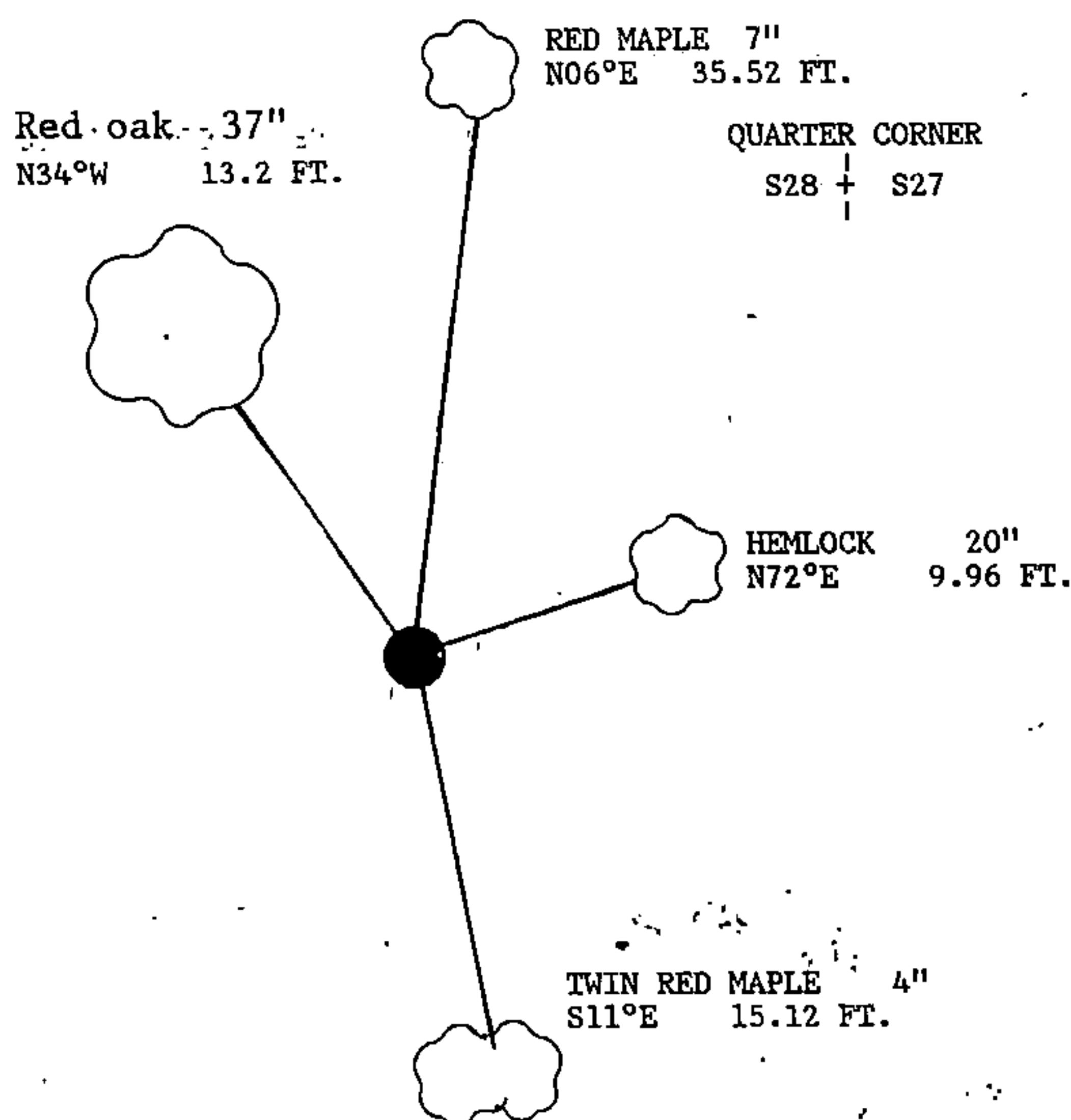

Affix Land Surveyor Seal

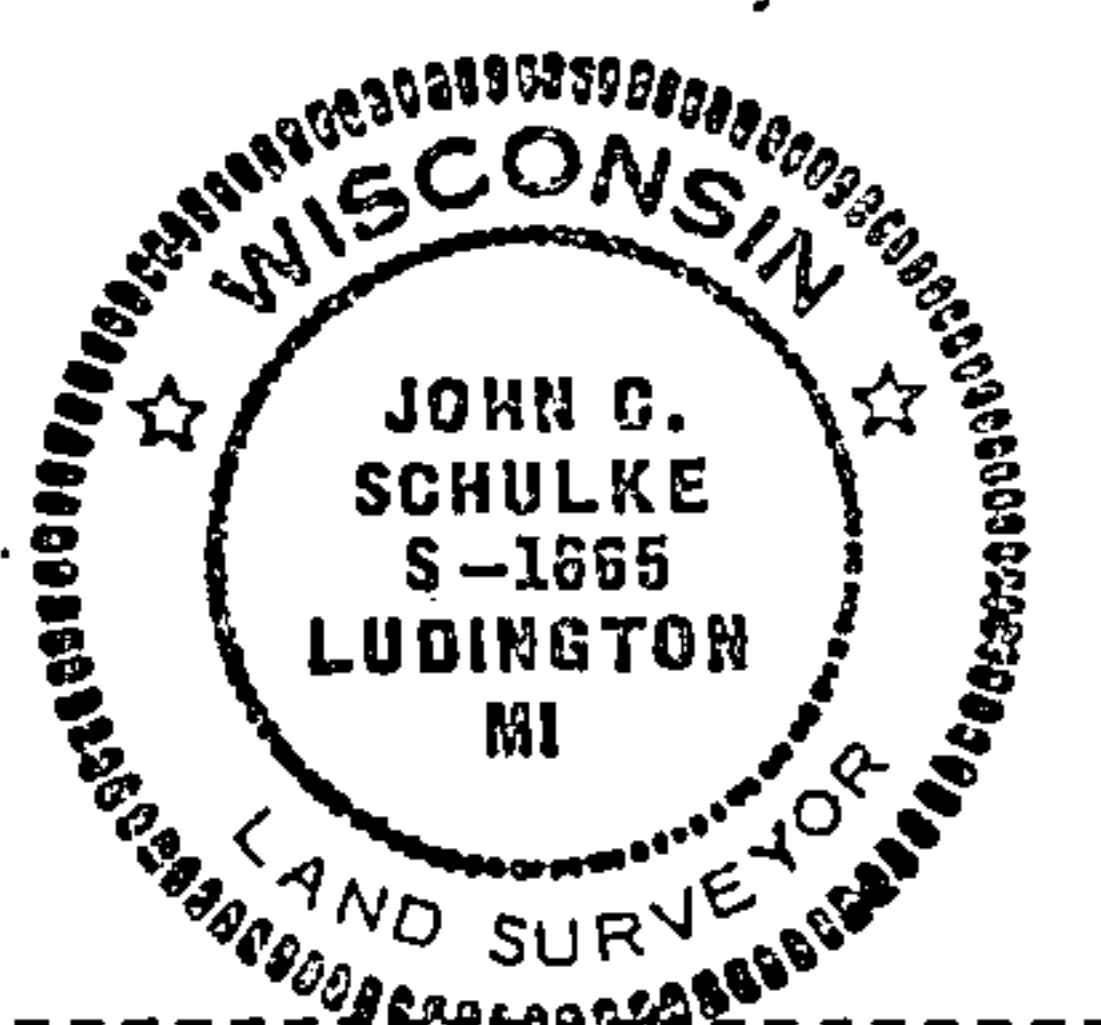

- (i) I, John C. Schulke
(type or print name) certify that the corner location shown on this record was determined by me or under my direction and control and that this U.S. Public Land Survey Monument Record is correct and complete to the best of my knowledge and belief.

John C. Schulke Nov 11, 1987
Signature Date

Survey requested by: Dale S. Staege 2/1/88
District Ranger Date