

U. S. PUBLIC LAND SURVEY MONUMENT RECORD

INSTRUCTIONS: This record shall show the location of the corner and shall include all of the following nine elements (a through i).

- (a) Identify the corner by reference to the U.S. public land survey system.
○ = Corner monument restored.

Quarter corner to Sections 2-11, T37N, R13E, Forest County, Wisconsin

REGISTER'S OFFICE }
Forest County, Wis. }
Received for record this 7th day
of August A.D., 1985 at
3:00 o'clock P.M. and recorded
in Vol. CORNER RESTORATIONS
page E-19
Paul Aschendrenner
Register of Deeds

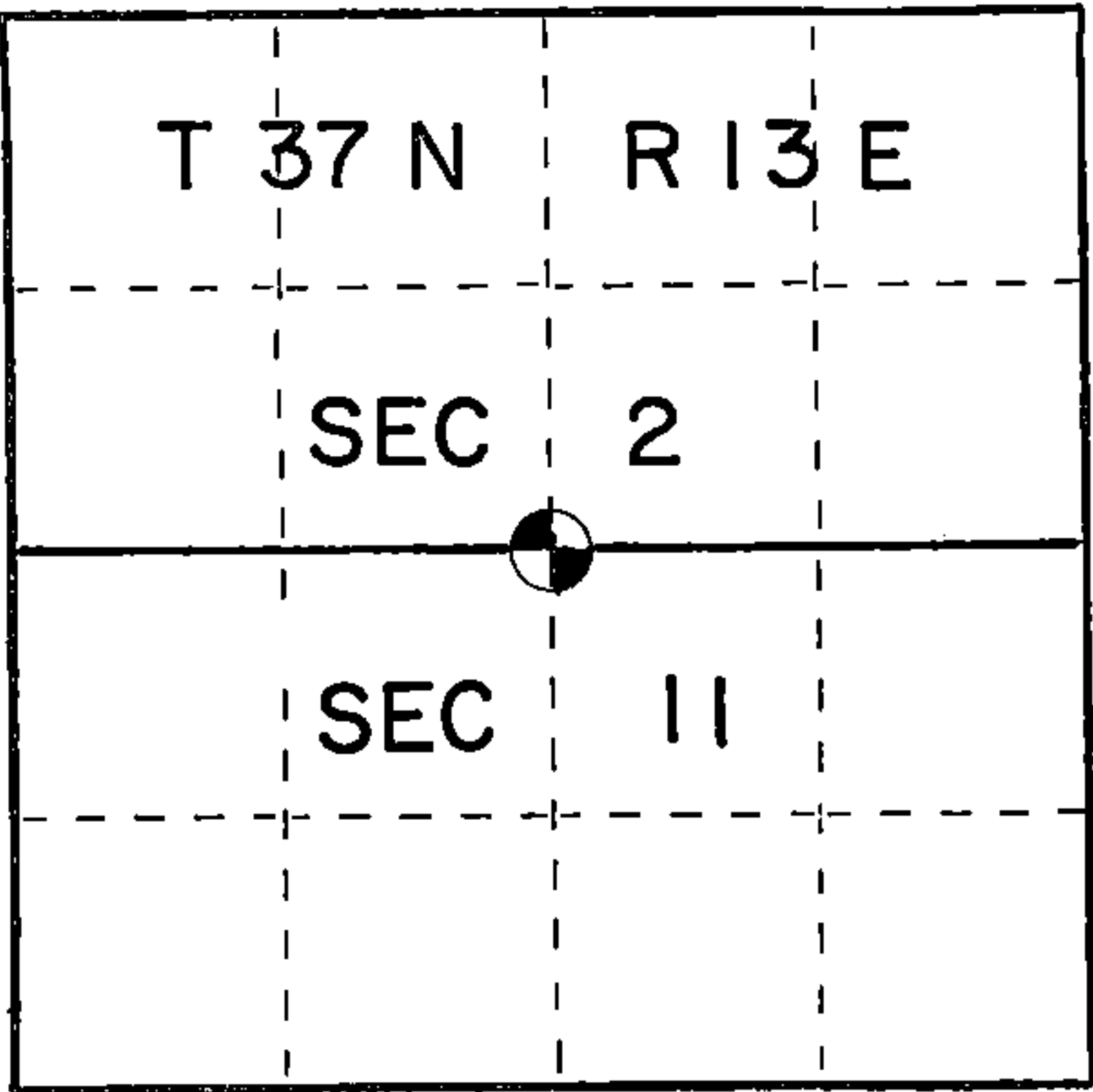

- (b) Describe any record evidence, monument evidence, occupational evidence, testimonial evidence or any other material evidence you considered, and whether the monument was found or placed.

In 1865 Nowlin set a wood post with:

Cedar 10" N77W 13.20'
Spruce 12" S45E 11.88'

Found a cedar tree with metal location tag by N Lorenz in 1937 saying corner was N 09 W 10 links. Found a 3" pickett at this location but no original bearing tree evidence. This position was too far west(by 109.70 ft) to fit for the quarter corner position. I did not accept Lorenz's post and set this corner by single proportionate measure. Lorenz stated on tag he measured 41.41 chains east from the southwest corner of Section 2 to come up with his position.

- (c) In the plan view drawing below, provide reference ties to at least 4 witness monuments, or, if the location is within a municipality, to at least 2 witness monuments. (Witness monuments shall be made of concrete, natural stone, iron or other equally durable material.)
Describe witness monuments.

- (d) Show a plan view drawing depicting the relevant monuments and reference ties which is sufficient in detail to enable accurate relocation of the corner monument if the corner monument is disturbed. Indicate north.

Set a 2"x 60" Aluminum monument with cap stamped for corner and accessories set to USFS standards. Lorenz's point bears N70W, 109.70 ft from this monument.

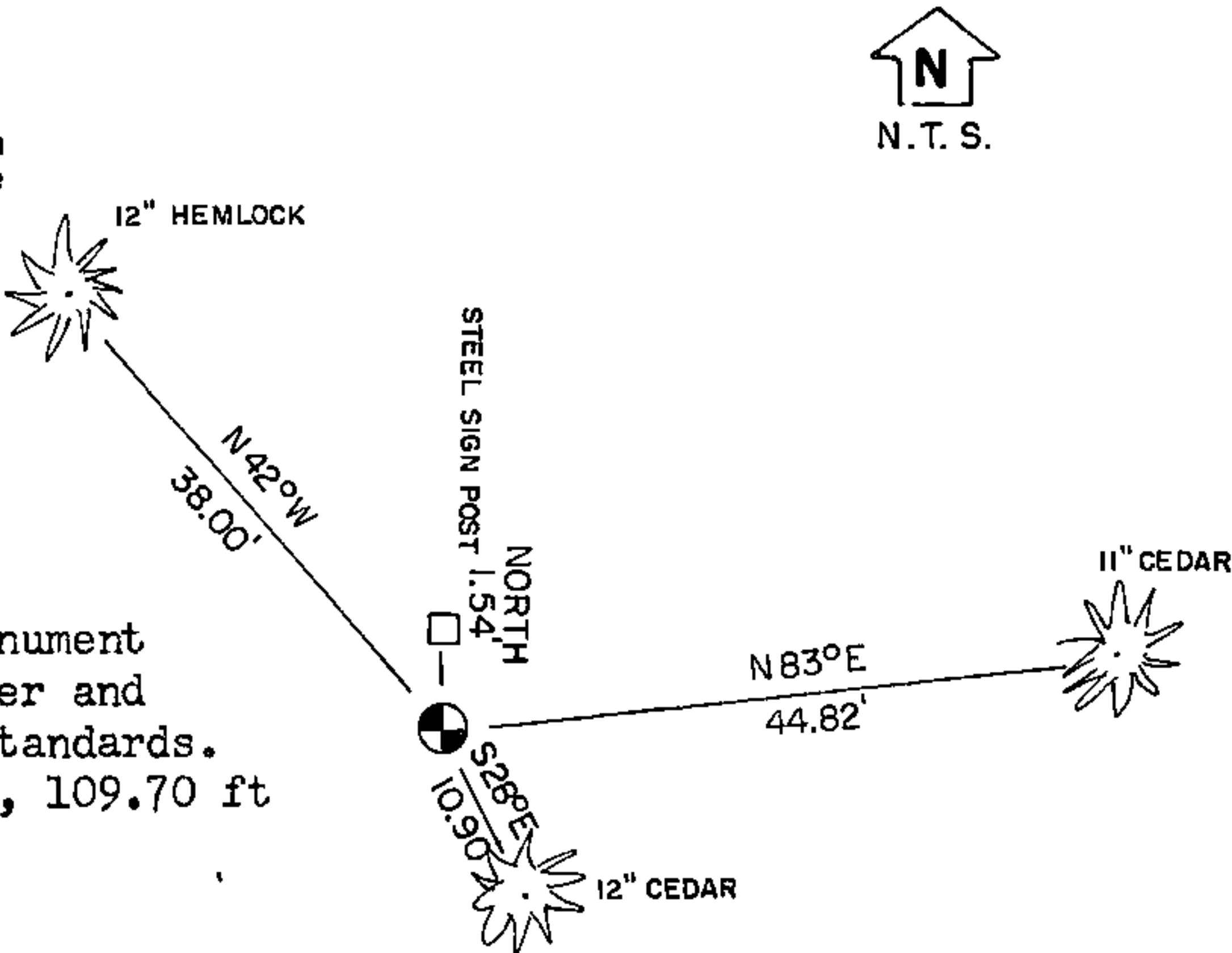

43713820020

- (e) Describe any material discrepancy between the location of the corner as restored or reestablished and the location of that corner as previously restored or reestablished by distance and direction. Show the discrepancy on the plan view drawing under (d), above. Show the distances between the corner as previously restored or reestablished and (1) the corner as restored or reestablished, and (2) to at least 2 of the witness monuments shown on the drawing in (d), above.

No discrepancy

- (f) Was the corner restored through acceptance of (1) an obliterated evidence location, or, (2) a found perpetuated location?

Obliterated evidence location

- (g&h) Was the corner reestablished through lost corner proportionate methods? If so, show the method, including the directions and distances to other public land survey corners used as evidence or used for proportioning in determining the corner location?

Lost methods of single proportionate measure between the southeast and southwest corners of Section 2.

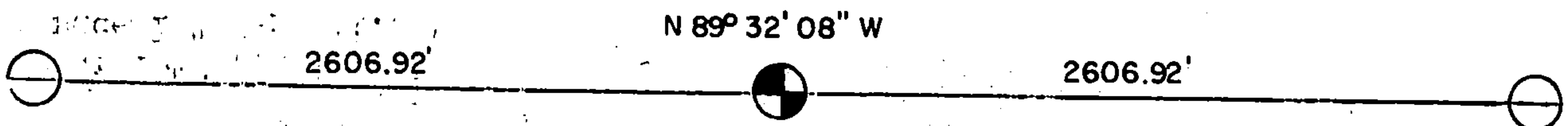

SEC. 11

Affix Land Surveyor Seal



- (i) I, Kim H. Pritzlaff
(type or print name) certify that the corner location shown on this record was determined by me or under my direction and control and that this U.S. Public Land Survey Monument Record is correct and complete to the best of my knowledge and belief.

Signature

Date

5-6-85