

# CERTIFIED LAND CORNER RESTORATION

Index No. **25**

State of Wisconsin } ss.  
County of Forest

I, Philip T. Hansen, do hereby certify that on the 9th day of December, 1975, I found evidence of the Section corner of Sec. 31, 32, 5-6 Township 37-36, North, Range 14 East, Fourth Principal Meridian, as described hereon; and that from this evidence I established a new monument and accessories as described hereon to perpetuate the original location of this corner.

Resident witnesses:

Glen Barker

Jim Claflin

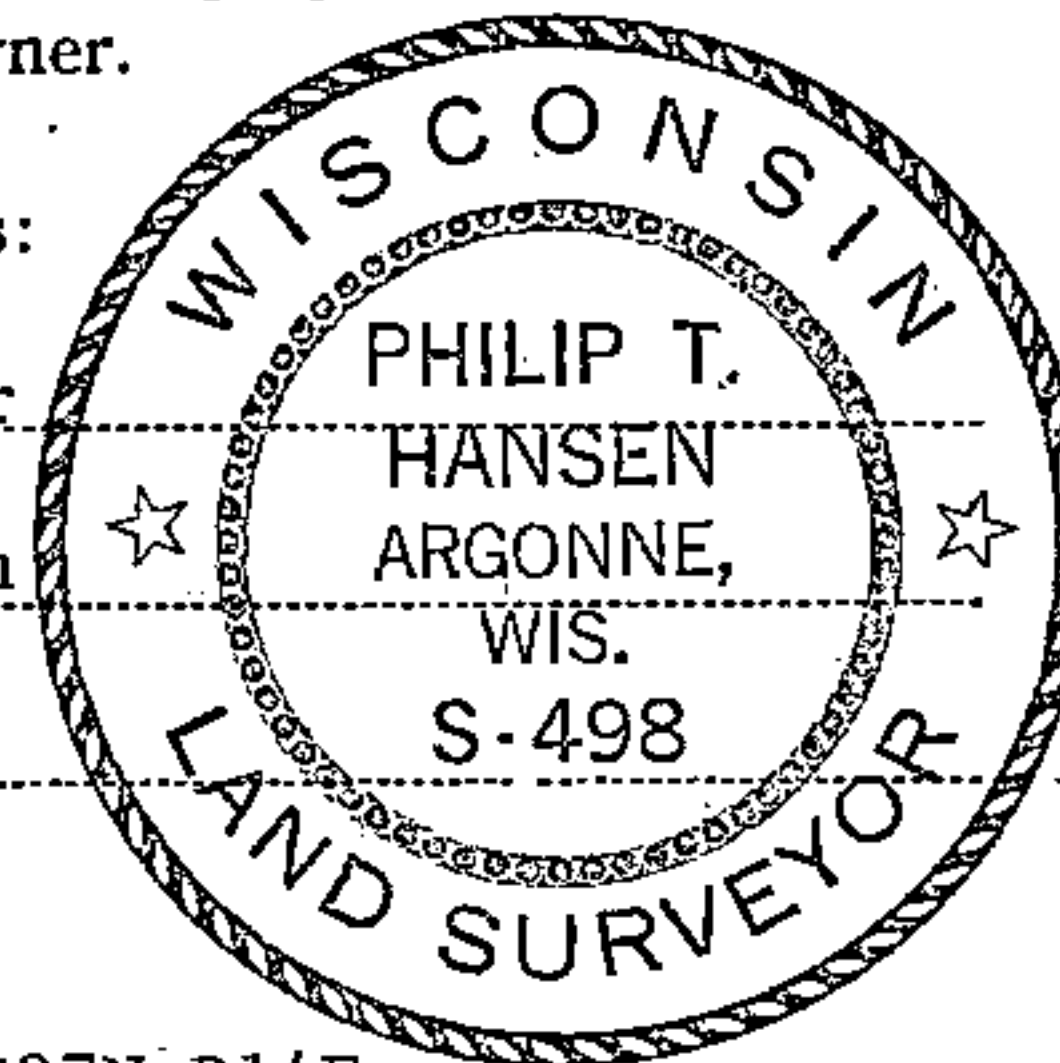

T37N R14E

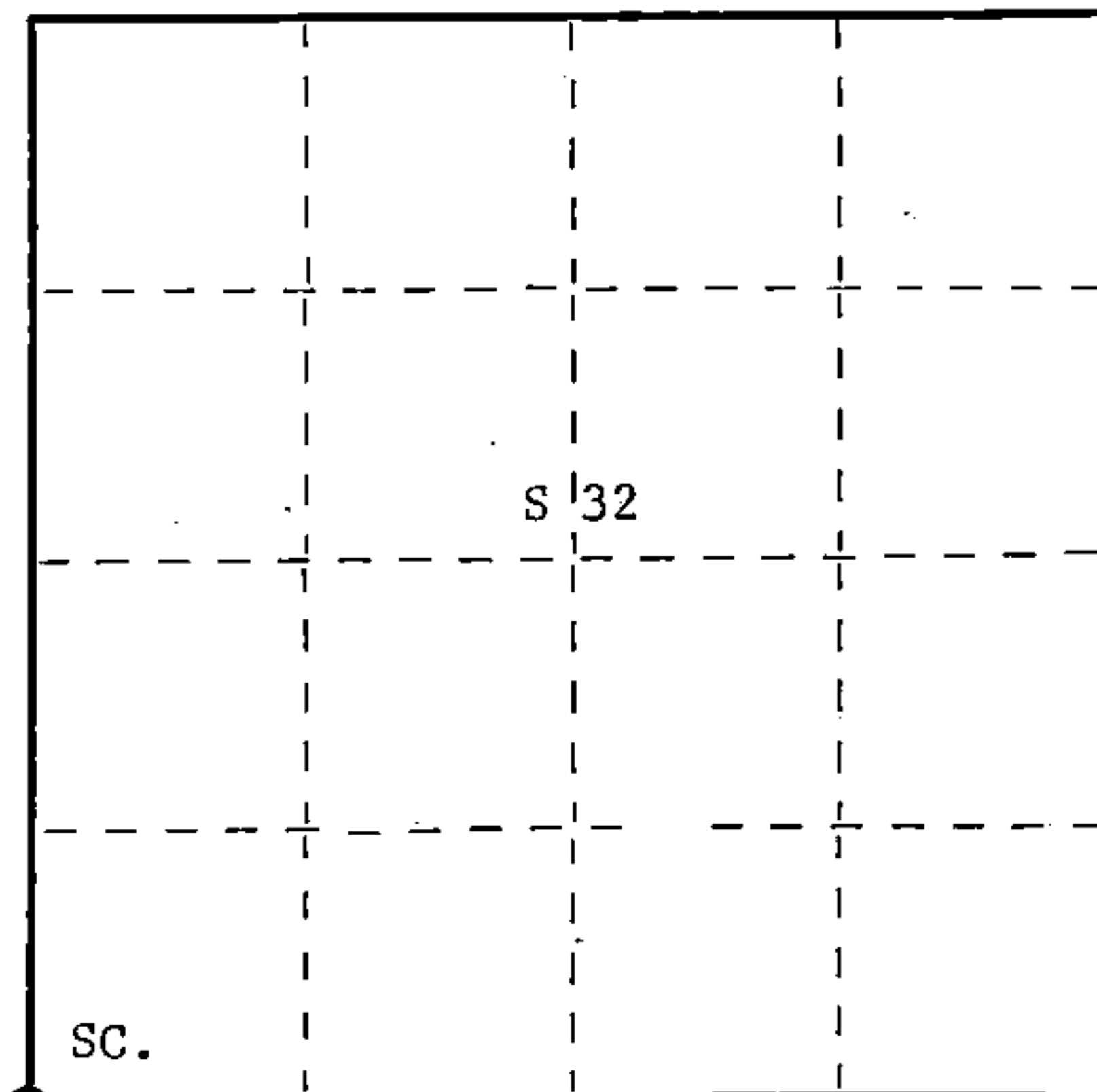

○ = Corner monument restored.

History of original corner establishment: Original corner established by Alfred Millard, Deputy Surveyor, in 1858, from which lind 16" bears N80°W 26 lks., sugar 18" bears N55°E 31 lks., yellow birch 12" bears S25°E 21 lks., and lind 10" bears S60°W 27 lks.

No record of any subsequent survey.

Corner recovered and restored by Ray Leigh, Consolidated Forester in 1942, who has maintained it for many years.

Description of corner evidence found: Recovered 4" squared cedar post in fair condition. A rock cairn had been placed around its base.

No trace of any OBT's was recovered.

Description of monument and accessories I established to perpetuate the original location of this corner. Replaced 4" squared post with 2-1/2" Berntsen, A-1 Federal Monument, aluminum with magnet installed in cap and base. Pipe projects 18" above ground.

Cap stamped -

Set wood post next to new pipe.

NBT's - Elm 12" S20°W 85.8 lks. scribed SC BT.  
Elm 16" S28°E 31.4 lks. scribed SC BT.  
Sugar 6" S71°W 104.5 lks. scribed SC BT.

S498  
T37N R14E  
Sec. 

S31	32
6	5

  
T36N R14E  
1975

Pipe, post and NBT's painted blue.

Dated at Argonne, Wis., this 15th day of December, 1975.

Signature *Philip T. Hansen* Title Reg. Land Surveyor Registration No. S-498  
(County Surveyor, Registered Land Surveyor, or other duly authorized official)

Office of Register of Deeds, County of Forest, I hereby certify that the within instrument was filed in this office for record on the 23rd day of December, 1975 at 2:30 o'clock P. M.

DOCUMENT NUMBER 108438

*Eugene Stutzman*  
(Register of Deeds)  
By Deputy

## U. S. PUBLIC LAND SURVEY MONUMENT RECORD

## INSTRUCTIONS:

This record shall show the location of the corner and shall include all of the following nine elements (a through i).

- (a) Identify the corner by reference to the U.S. public land survey system.  
 ○ = Corner monument restored.

Section corner common to Sections 31, 32,  
 5 & 6, T37-36N, R14E, 4th P.M., Forest  
 County, WI.

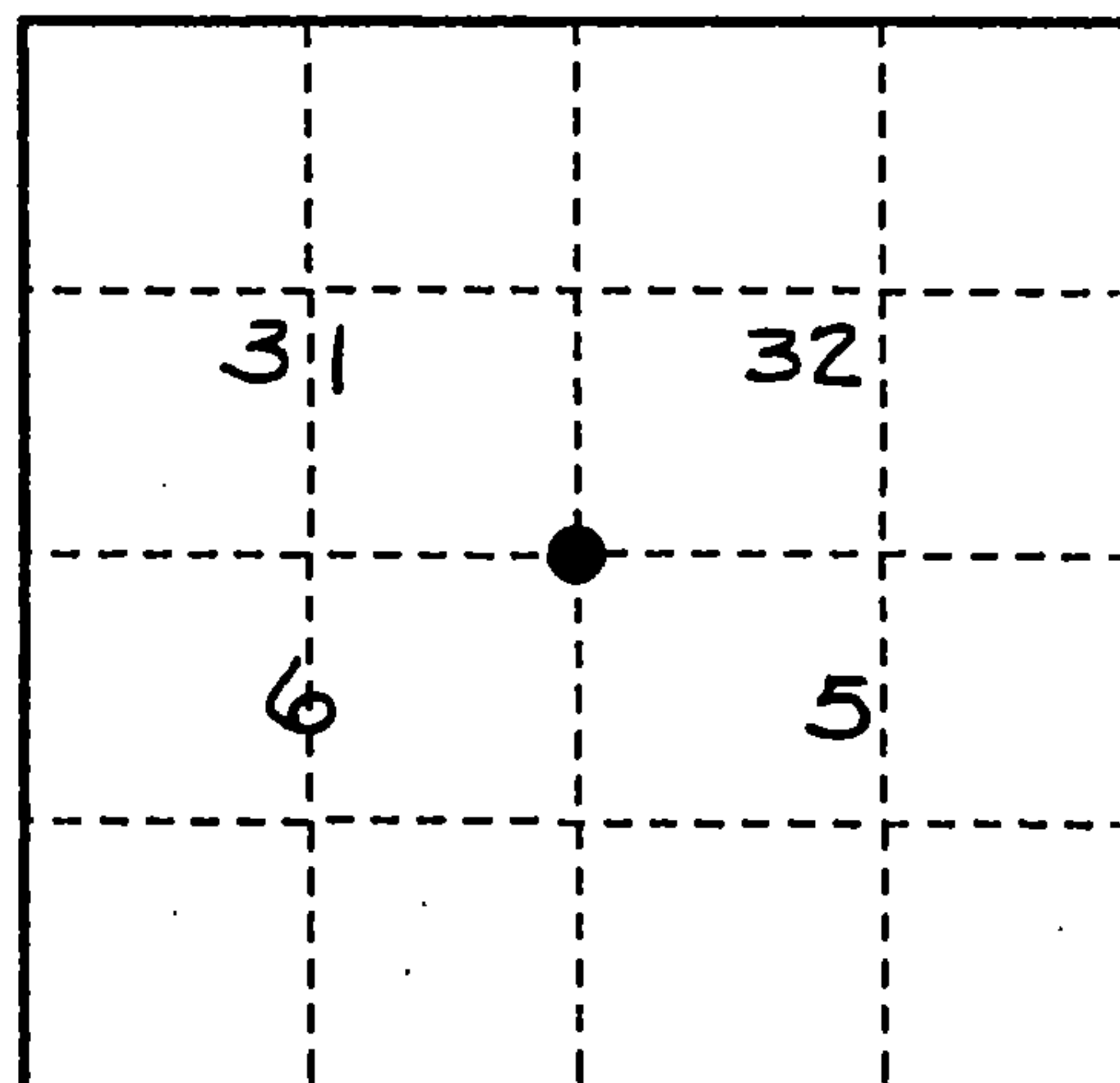

- (b) Describe any record evidence, monument evidence, occupational evidence, testimonial evidence or any other material evidence you considered, and whether the monument was found or placed.

Original survey by Alfred Millard, Deputy Surveyor, in 1858.

## Original Bearing Trees:

Lind 16", N80°W - 26 links  
 Y. Birch 12", S25°E - 21 links

Sugar 18", N55°E - 31 links  
 Lind 10", S60°W - 27 links

1942- Corner recovered by Ray Leigh, a Consolidated Forester.

1975- The corner was monumented and recorded by Philip Hansen S-498, on document No. 108438 on December 23, 1975. He recovered a 4" squared cedar post.

1993- I found his\* monument, a 2 1/2" Bernstein aluminum monument with a stamped cap, to be in good condition. I upgraded the accessories as noted below.

- (c) In the plan view drawing below, provide reference ties to at least 4 witness monuments, or, if the location is within a municipality, to at least 2 witness monuments. (witness monuments shall be made of concrete, natural stone, iron or other equally durable material.)

- (d) Show a plan view drawing depicting the relevant monuments and reference ties which is sufficient in detail to enable accurate relocation of the corner monument if the corner monument is disturbed. Indicate north.

Found a 2 1/2" Bernstein A-1 Federal Monument, aluminum with a stamped cap to read: S498, T37N, R14E, S31, S32, S6, S5, T36N, R14E, 1975.

- 1- 9" Sugar-N14°W-41.34 feet  
 2- 12" Sugar-N48°E-51.67 feet  
 3- 9" Sugar-S49°E-24.74 feet  
 4- 11" Sugar-(existing BT)  
 S72°W-69.00 feet  
 5- Steel sign post-Southwest-3.05 feet

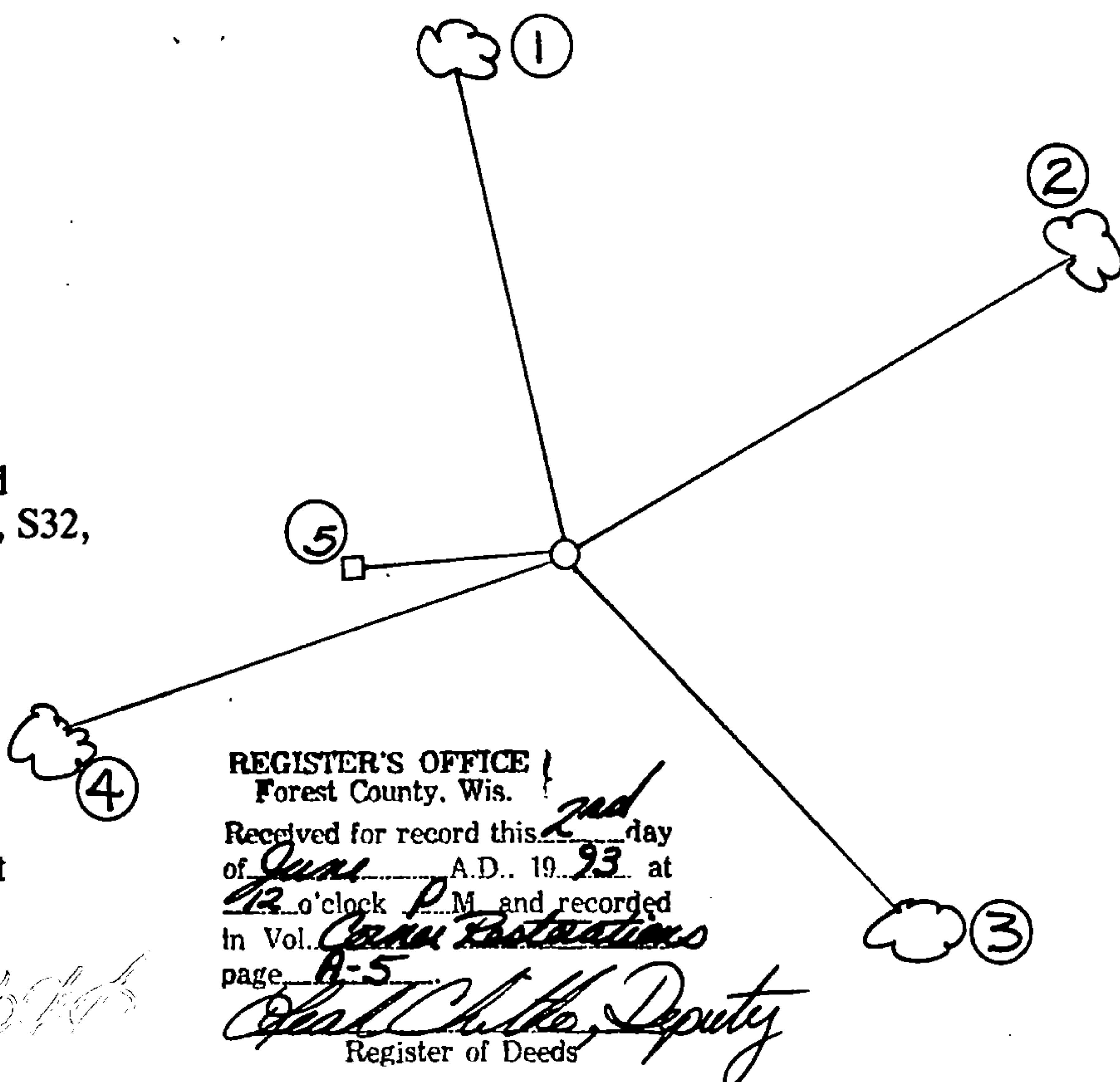

REGISTER'S OFFICE  
 Forest County, Wis.

Received for record this 2nd day  
 of June A.D. 1993 at  
12 o'clock P.M. and recorded  
 in Vol. Green Registrations  
 page A-5

*Paul Chitko, Deputy*  
 Register of Deeds

43714310000

(e) Describe any material discrepancy between the location of the corner as restored or reestablished and the location of that corner as previously restored or reestablished by distance and direction. Show the discrepancy on the plan view drawing under (d), above. Show the distances between the corner as previously restored or reestablished and (1) the corner as restored or reestablished, and (2) to at least 2 of the witness monuments shown on the drawing in (d), above.

None

(f) Was the corner restored through acceptance of (1) an obliterated evidence location, or, (2) a found perpetuated location?

(2) Found perpetuated corner location.

(g & h) Was the corner reestablished through lost corner proportionate methods? If so, show the method, including the directions and distances to other public land survey corners used as evidence or used for proportioning in determining the corner location?

No

(1) I, John R. Garske, S-1685

(type or print name) certify that the corner location shown on this record was determined by me or under my direction and control and that this U.S. Public Land Survey Monument Record is correct and complete to the best of my knowledge and belief.

Signature

CERTIFICATE READY FOR FILING:

3-19-93

Date

Sue Vap  
District Ranger

