

CERTIFIED LAND CORNER RESTORATION

Index No. R-5

State of Wisconsin }
County of Forest } ss.

I Norman A. Harrison, do hereby
certify that on the 8th day
of August, 1986, I found
evidence of the northeast corner
corner of Section 30
Township 37, North, Range
16, Fourth Principal Meridian,
as described hereon; and that from this evidence
I established a new monument and accessories
as described hereon to perpetuate the original
location of this corner.

Resident witnesses:

History of original corner establishment: Subdivision of Township 37 North, Range 16 East,
4th Principal meridian by James McBride, Deputy Surveyor.
Commenced July 11, 1859 - Finished July 16, 1859

80.00 Set post ~~corner~~ to Sections 19, 20, 29 and 30
Elm 10 N 56 W 57
Fir 10 N 41 E 70
Elm 12 S 60 E 18
Fir 8 S 15 W 29

Description of corner evidence found: No evidence of original corner found.
Found 2 old 4 way fence corner at edge of swamp, fence corners at the sixteenth corners
on North line of Section and road intersection at north quarter corner of Section.
Accepted old fence corner as best evidence of perpetuation of original corner location.
Sketch on back side of this sheet.

Description of monument and accessories I established to perpetuate the original location of this corner
Set Forest County Aluminum monument at corner.
New bearing trees

soft maple	9"	N 55° 56' W	28.6 feet
hard maple	7"	N 66° 32' E	70.0 feet
soft maple	8"	S 87° 34' W	41.0 feet

bearings referenced to Magnetic North

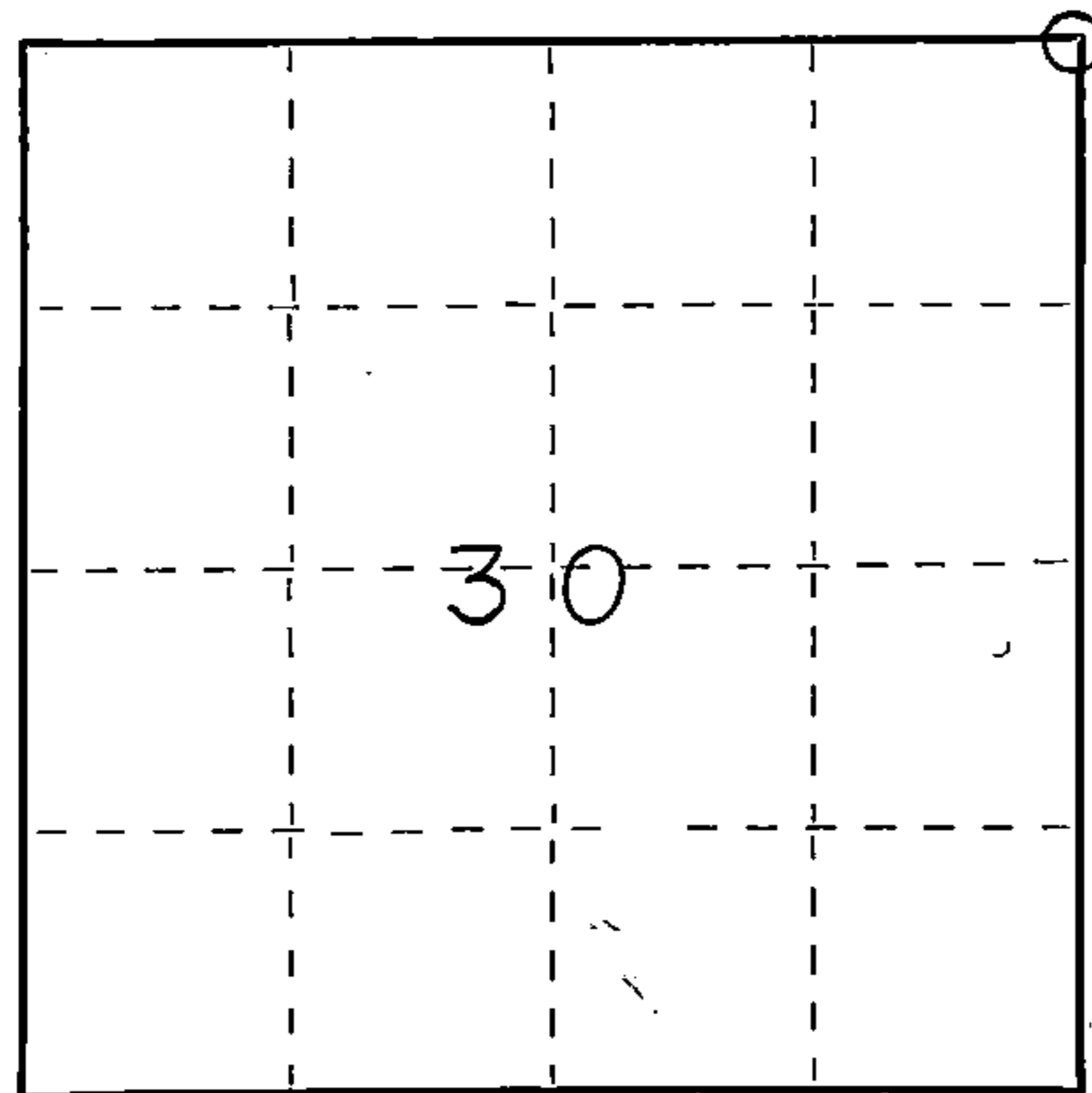
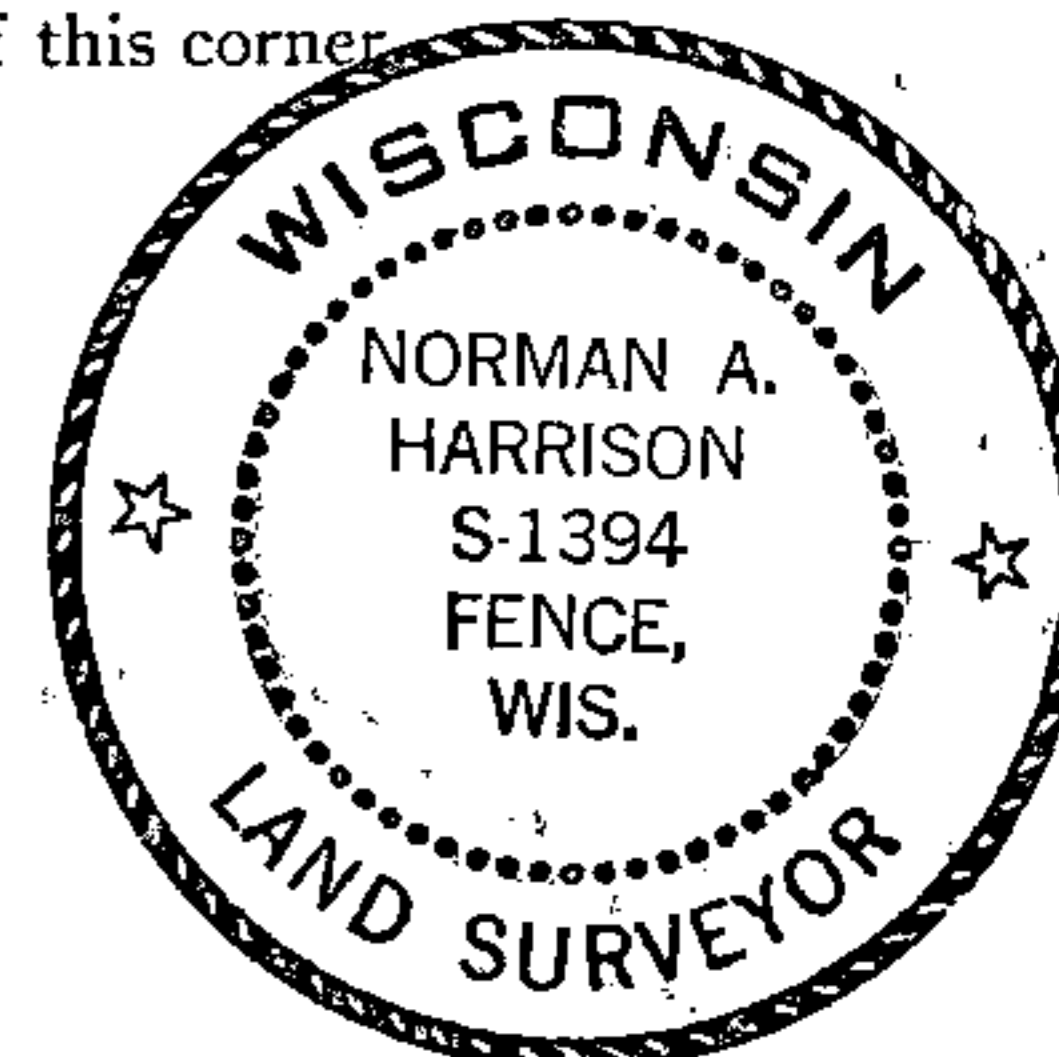

○ = Corner monument restored.

Dated at Fence, Wis., this 18th day of December, 1986

Signature Norman A. Harrison Title Surveyor Registration No. 1394
(County Surveyor, Registered Land Surveyor, or other duly authorized official)

Office of Register of Deeds, County of Forest, I hereby certify that the within
instrument was filed in this office for record on the 18th day of December, 1986
at 11:00 o'clock A. M.

Paul Aschenbrenner
(Register of Deeds)

By _____ Deputy

DOCUMENT NUMBER
131742

FORM 985 H. C. MILLER CO., MILWAUKEE

437161900000

