

U.S. PUBLIC LAND SURVEY MONUMENT RECORD

Index No. **E-25**

State of Wisconsin }
County of Forest } ss.

I William B. Cochrane, do hereby certify that on the 12th day of February, 1985, I found evidence of the Southeast Section corner of Section 1 Township 38, North, Range 14 East, Fourth Principal Meridian, as described hereon; and that from this evidence I established a new monument and accessories as described hereon to perpetuate the original location of this corner.

Resident witnesses:

David Brownell

Tony Tillman

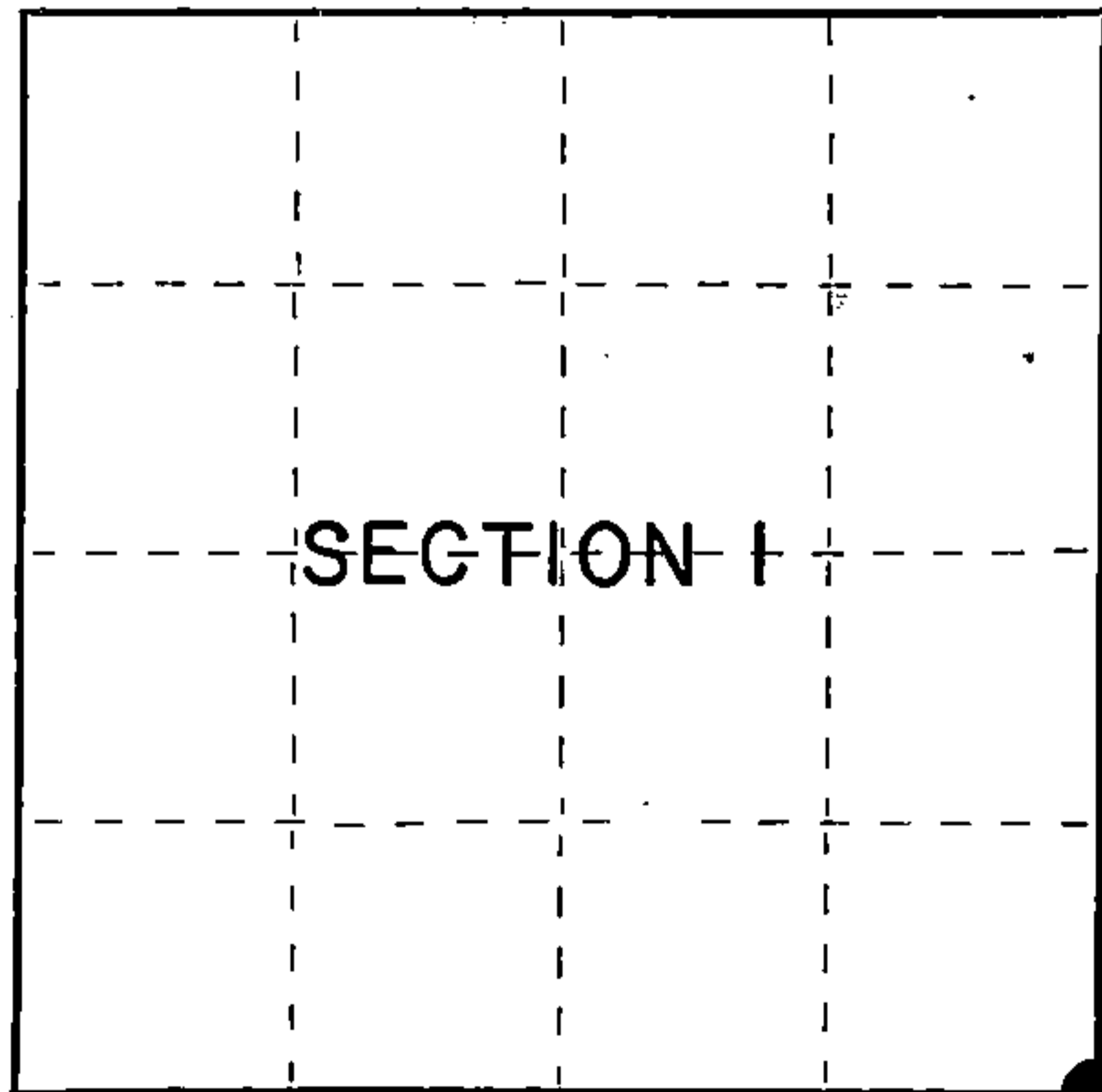

○ = Corner monument restored.

History of original corner establishment:

Original Government Survey in 1857 by Artemas Curtis. In 1964 Jean Resvick, a Land Surveyor with the U.S. Forest Service, found a 2" squared top cedar post in concurrence with original B.T. evidence. In place of post, set a 2" diameter galvanized iron pipe 5 feet long, with a brass cap stamped: T38N, R14E, R15E, S1, S6, S7, S12, 1964, S802.

From which the following bear:

Aspen	5"	N12°E	58.28 feet
Aspen	4"	S35°E	33.15 feet
Aspen	5"	N43°W	41.59 feet

Description of corner evidence found:

Found monument as described and in place from which the following bear:

Aspen	8"	N12°E	58.28 feet
Aspen	10"	N43°W	41.59 feet
Aspen	4"	S35°E	33.15 feet- cut down for Photo Project
4"x4" Cedar post		SE	1.60 feet

Description of monument and accessories I established to perpetuate the original location of this corner.

Blazed and scribed a new bearing tree:

Spruce	10"	S16°W	69.95 feet
--------	-----	-------	------------

Dated at Hiles, Wis., this 8th day of March, 1985

Signature William B. Cochrane Title Land Surveyor Registration No S-1107
(County Surveyor, Registered Land Surveyor, or other duly authorized official)

Office of Register of Deeds, County of Forest, I hereby certify that the within instrument was filed in this office for record on the 24th day of April, 1985 at 1:00 o'clock P. M.

Paul Aschenbrenner
(Register of Deeds)

By _____ Deputy

FORM NO. 985-A

H.C. Miller Company
Burlington, Wisconsin

Stock No. 26273

Document Number 127891

43814010000

(e) Describe any material discrepancy between the location of the corner as restored or reestablished and the location of that corner as previously restored or reestablished by distance and direction. Show the discrepancy on the plan view drawing under (d), above. Show the distances between the corner as previously restored or reestablished and (1) the corner as restored or reestablished, and (2) to at least 2 of the witness monuments shown on the drawing in (d), above.

See drawing below.

(f) Was the corner restored through acceptance of (1) an obliterated evidence location, or, (2) a found perpetuated location?

Restored through acceptance of a found perpetuated location.

(g&h) Was the corner reestablished through lost corner proportionate methods? If so, show the method, including the directions and distances to other public land survey corners used as evidence or used for proportioning in determining the corner location?

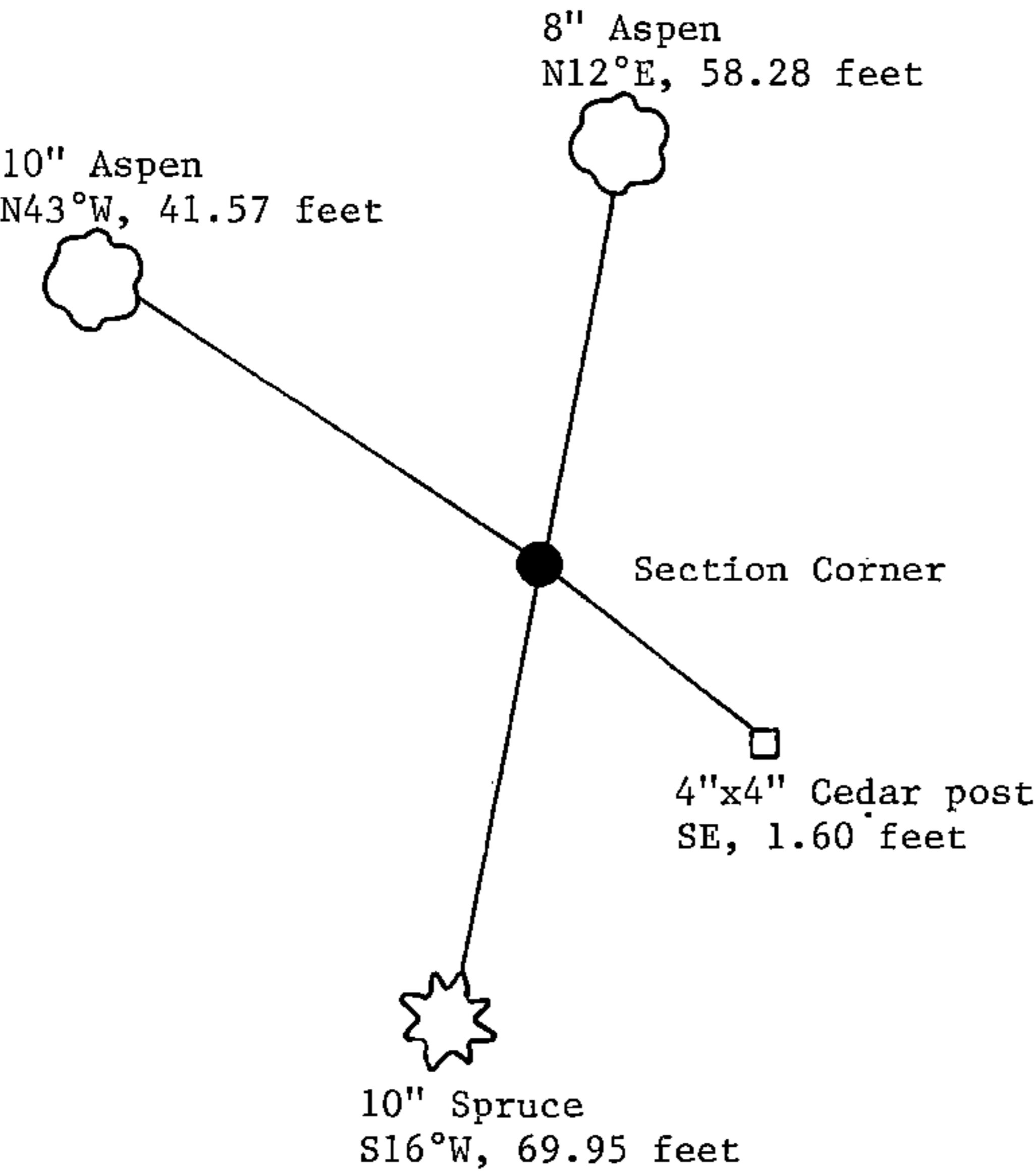

R14E	R15E
S1	S6
S12	S7

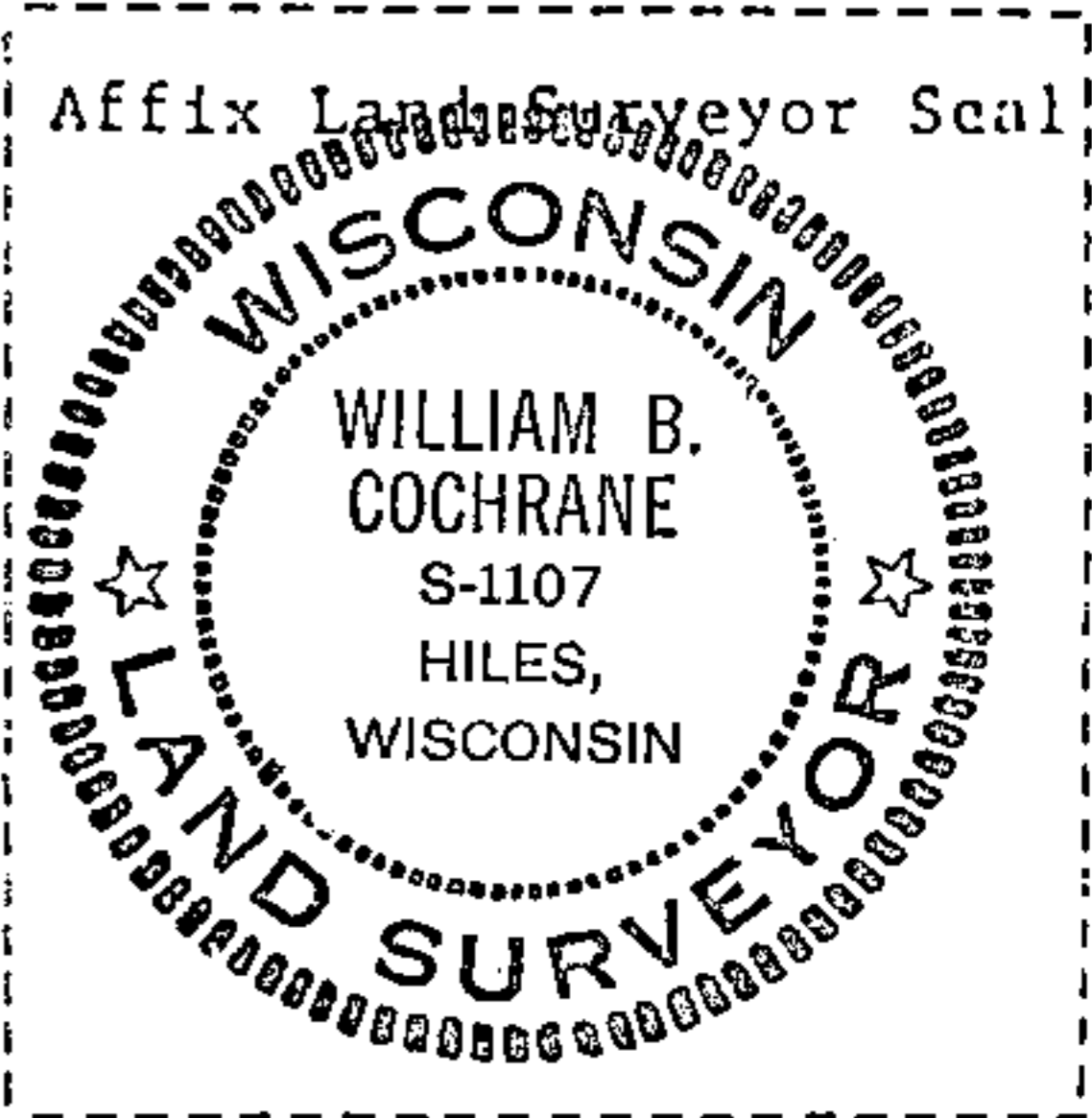

(i) I, William B. Cochrane
(type or print name) certify that the corner location shown on this record was determined by me or under my direction and control and that this U.S. Public Land Survey Monument Record is correct and complete to the best of my knowledge and belief.

William B. Cochrane
Signature

March 8, 1985
Date