

CERTIFIED LAND CORNER RESTORATION

State of Wisconsin }
County of Forest } ss.

I Jean F. Resvick, do hereby certify that on the 9th day of May, 19 67,
I found evidence of the Northeast corner of Section 33
Township 38 North, Range 14 East, Fourth Principal Meridian, as described
hereon; and that from this evidence I established a new monument and accessories as described hereon to per-
petuate the original location of this corner:

Description of original monument and accessories and subsequent restorations:

Original survey in 1865 by James L. Nowlin.
North 80 chains between Sections 33 & 34.
Set post for corner of Sections 27, 28, 33 & 34.
Cedar 15 inches, bears N25W, 23 links.
Birch 12 inches, bears N18E, 32 links.
8.0 chains south to stream 10 links wide runs NE.

Description of corner evidence found:

Found 3 inch squared cedar post from which the following bear:
1. Birch stump and snag with open blaze, tree 12 inches
when blazed bears N18°E, 22 feet.
2. Cedar stump hole and blow down bears N25°W, 15 feet.
3. South 10 chains to river channel as now located from post.

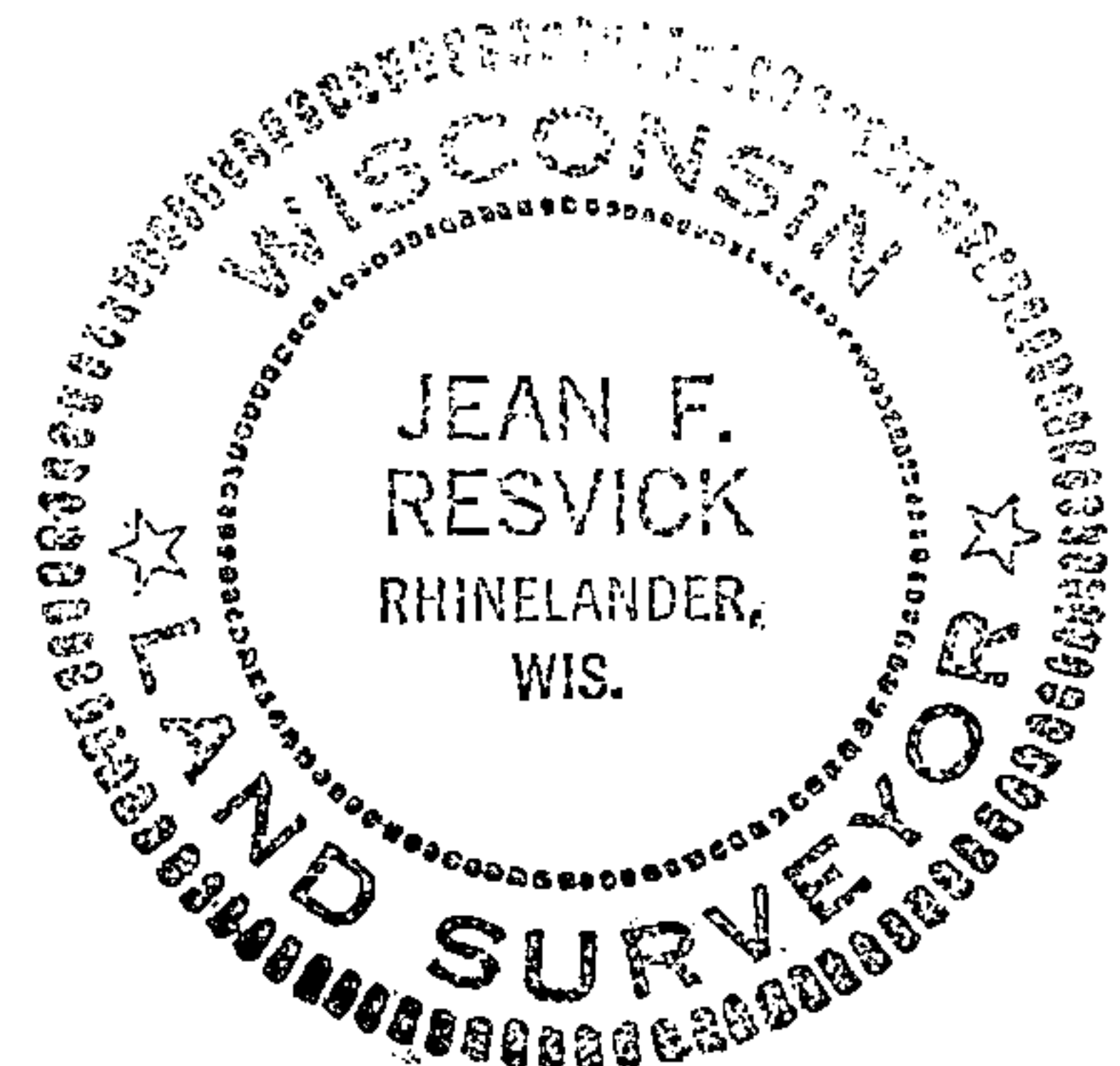

Description of monument and accessories I established to perpetuate the original location of this corner:

Replaced 3 x 3 cedar post with a 2-inch diameter, galvanized, wrought iron pipe,
5 feet long, flanged at bottom, filled with concrete, with brass cap marked:

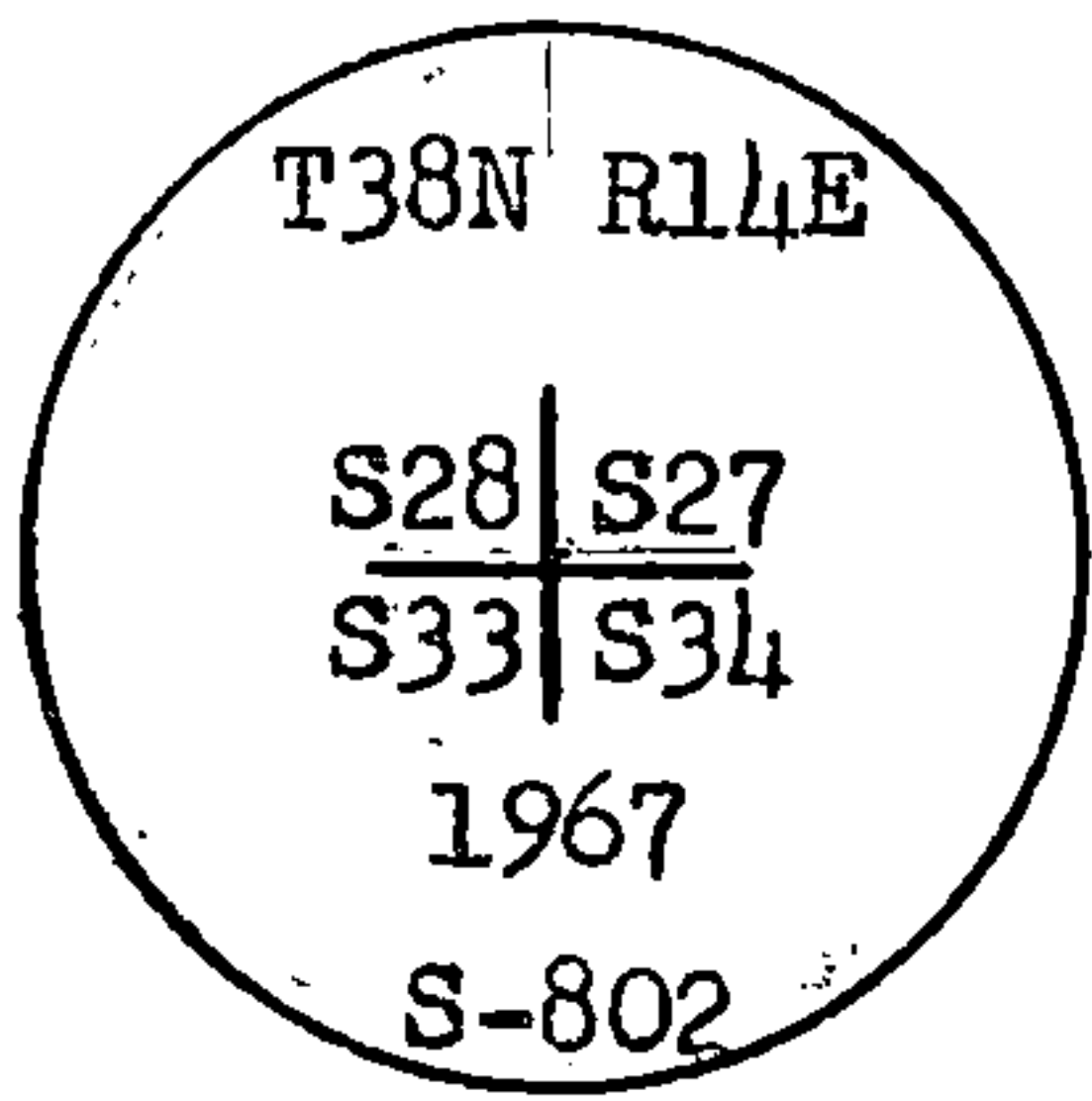

from which the following new blazed and scribed bearing trees bear:

Sugar 16 inch, N11°W, 34.05 ft. or 51.59 lks.
White Birch 16 inch, S74°E, 6.51 ft. or 9.86 lks.
Hemlock 13 inch, S42°W, 52.24 ft. or 79.15 lks.
Hemlock 15 inch, N48°W, 32.77 ft. or 49.65 lks.

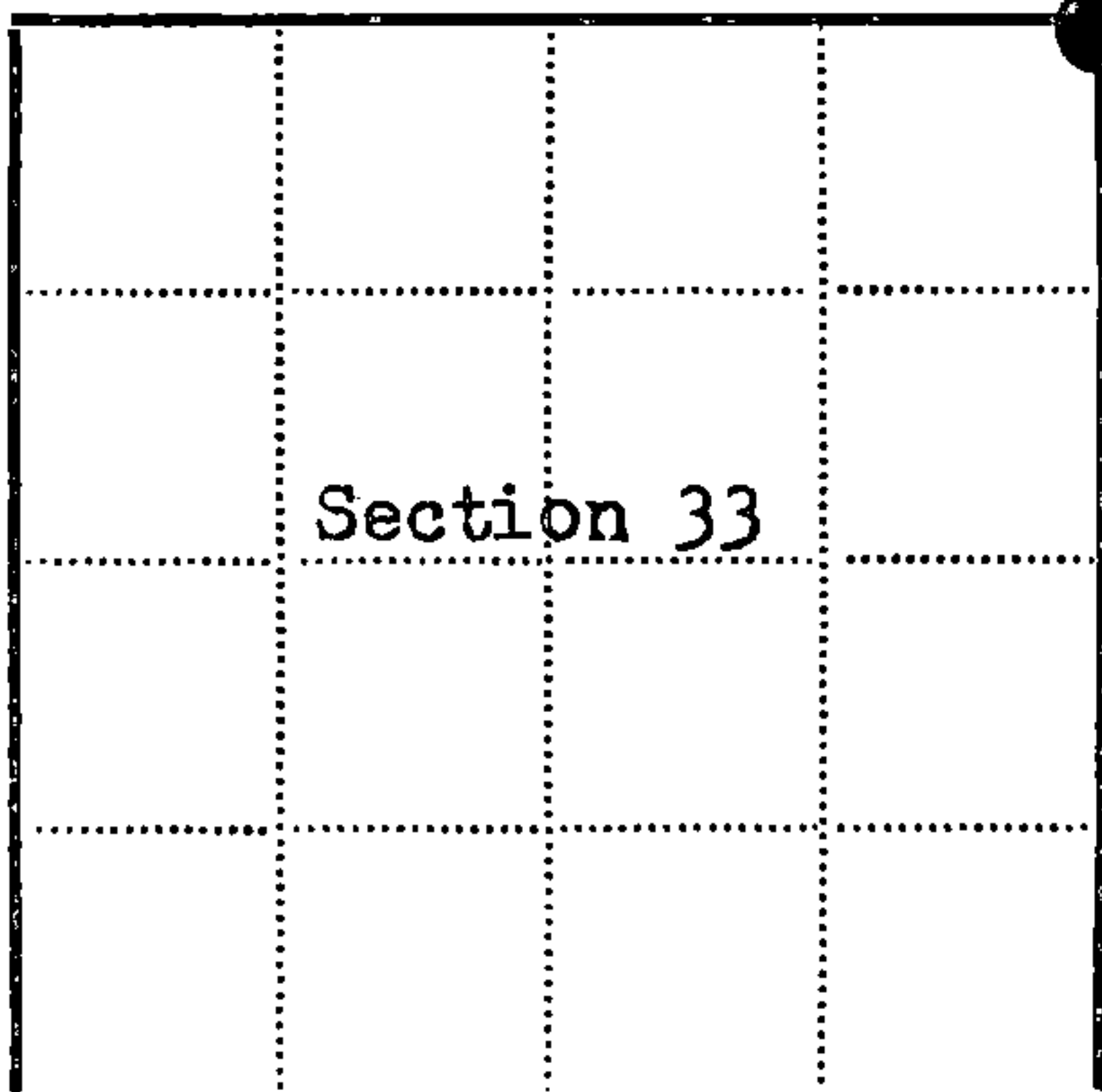

● = Corner monument restored
□ =

Resident witnesses.....

Dated at Rhineland Wisconsin, this 21st day of July
19 67.

Signature Jean F. Resvick Title Cadastral Surveyor
(County Surveyor, Registered Land Surveyor, or other duly authorized official)

Surveyors Registration No. S-802 DOC. NO. 94224

Office of Register of Deeds County of Forest

I hereby certify that the within instrument was filed in this office for record
on the 27th day of February 19 68, and was filed in Book
No. I Page No. _____ of County Records.

Signature Eugene Stetson Title Register of Deeds

Township 38 North, Range 14 East, Section 33, Index No. V-13, Page No. _____

43814280000

13

U. S. PUBLIC LAND SURVEY MONUMENT RECORD

INSTRUCTIONS: This record shall show the location of the corner and shall include all of the following nine elements (a through i).

- (a) Identify the corner by reference to the U.S. public land survey system.
 O = Corner monument restored.

Southwest Corner of
 Section 27, T38N, R14E

REGISTER'S OFFICE
 Forest County, Wis.

Received for record this 5th day
 of November A.D., 1986 at

3:50 o'clock P. M. and recorded

In Vol. CORNER RESTORATIONS
 page 13

Paul Aschenbrenner
 Register of Deeds

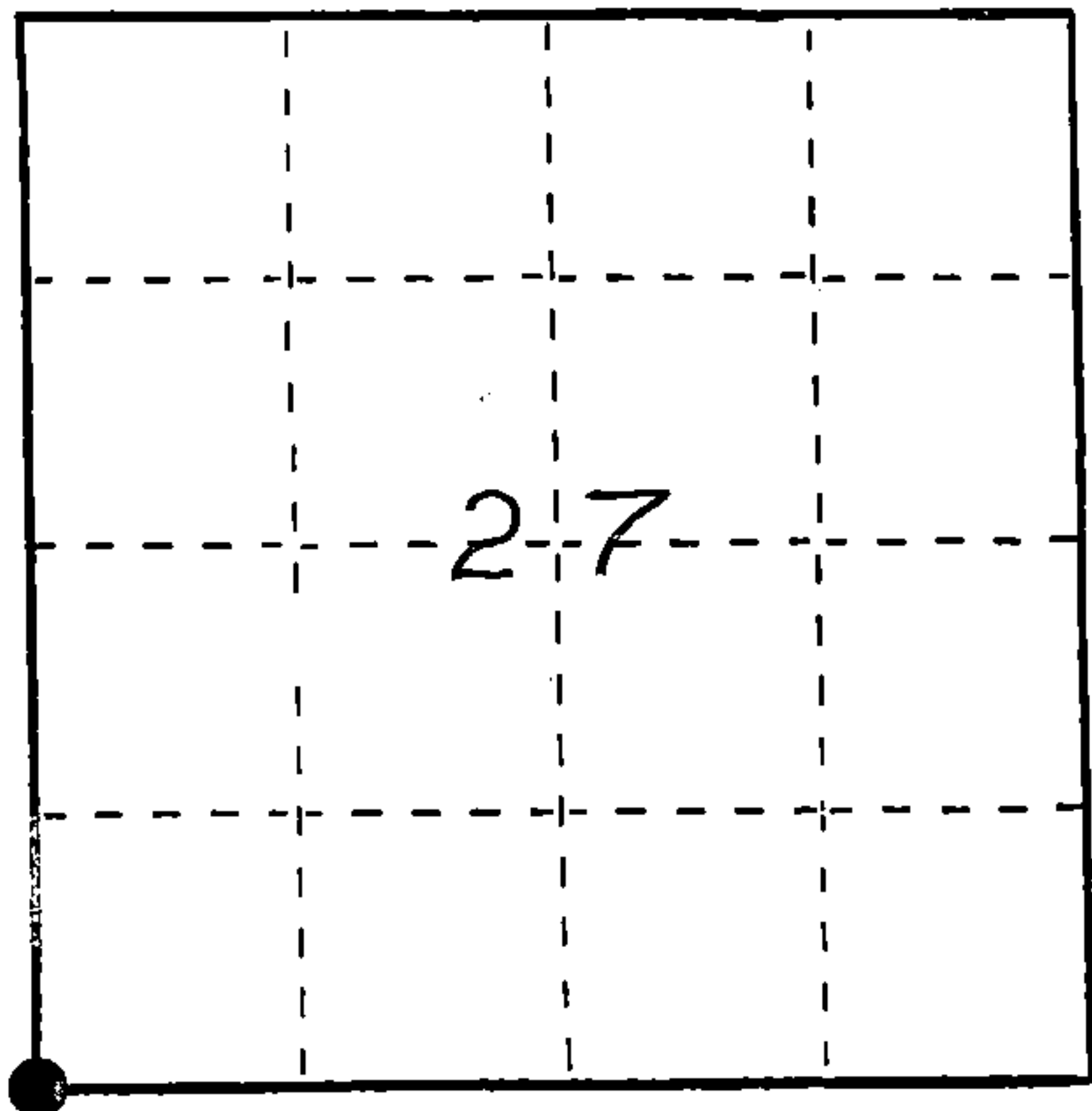

- (b) Describe any record evidence, monument evidence, occupational evidence, testimonial evidence or any other material evidence you considered, and whether the monument was found or placed.

In 1865 James L. Nowlin set wood post with the following BTs: Cedar, 15", N25°W, 23 links; Birch, 12", N18°E, 32 links. Found 2" diameter iron pipe, with 3" diameter brass tablet stamped to identify corner. This corner was restored in 1967 by Jean F. Resvick. His bearing trees were found.

Sugar	18"	N11°W	34.05 feet
Yellow Birch	17"	S74°E	6.51 feet
Hemlock(dead)	13"	S42°W	52.24 feet
Hemlock(stump)	15"	N48°W	32.8 feet
Wood Post		North	1.8 feet

- (c) In the plan view drawing below, provide reference ties to at least 4 witness monuments, or, if the location is within a municipality, to at least 2 witness monuments. (Witness monuments shall be made of concrete, natural stone, iron or other equally durable material.) Describe witness monuments.

- (d) Show a plan view drawing depicting the relevant monuments and reference ties which is sufficient in detail to enable accurate relocation of the corner monument if the corner monument is disturbed. Indicate north.

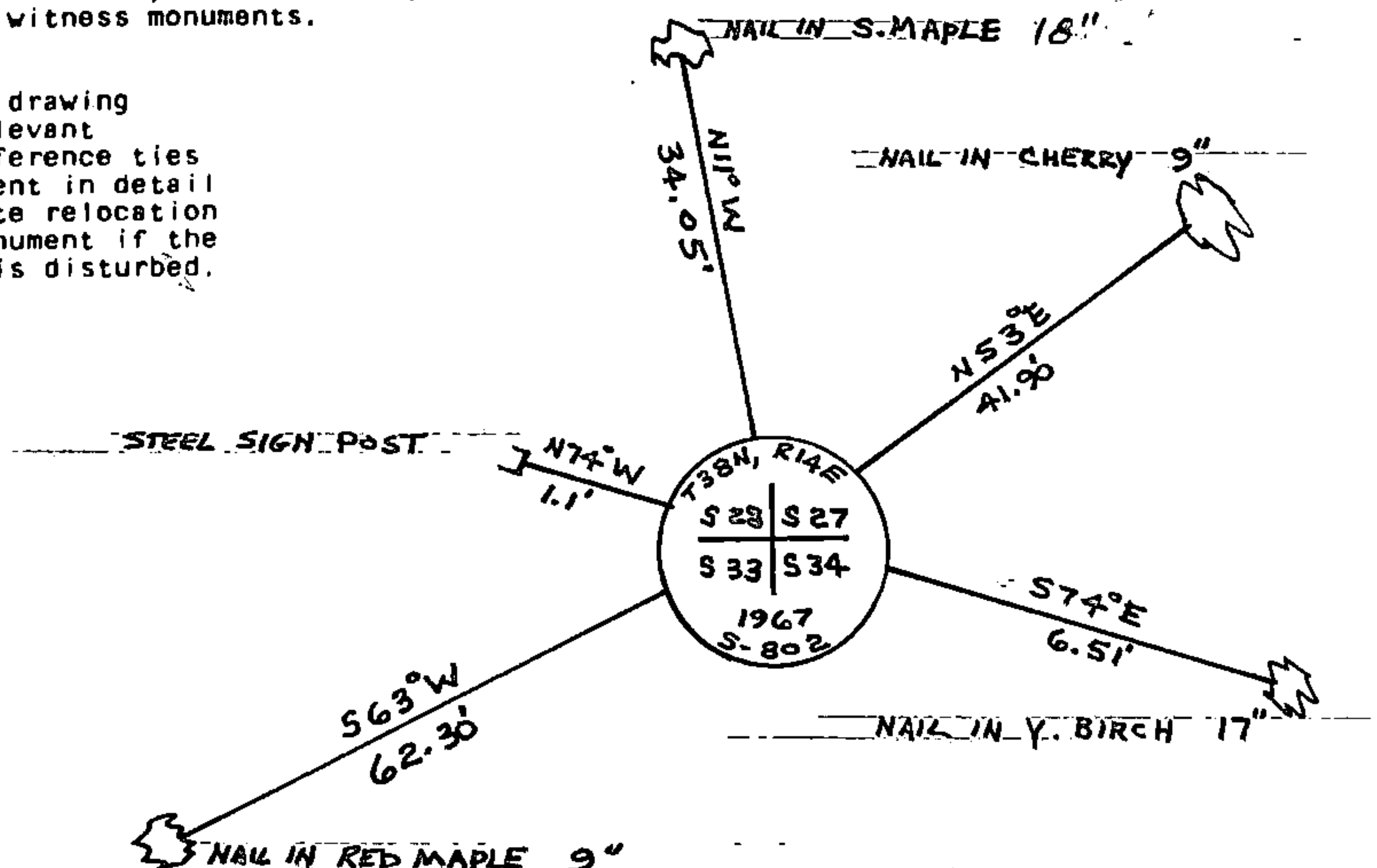

- (e) Describe any material discrepancy between the location of the corner as restored or reestablished and the location of that corner as previously restored or reestablished by distance and direction. Show the discrepancy on the plan view drawing under (d), above. Show the distances between the corner as previously restored or reestablished and (1) the corner as restored or reestablished, and (2) to at least 2 of the witness monuments shown on the drawing in (d), above.

NONE

- (f) Was the corner restored through acceptance of (1) an obliterated evidence location, or, (2) a found, perpetuated location?

Through Acceptance of a found perpetuated location

- (g&h) Was the corner reestablished through lost corner proportionate methods? If so, show the method, including the directions and distances to other public land survey corners used as evidence or used for proportioning in determining the corner location?

NO

- (1) I, John H. Fisher
(Type or print name) certify that the corner location shown on this record was determined by me or under my direction and control and that this U.S. Public Land Survey Monument Record is correct and complete to the best of my knowledge and belief.

Signature

Date

