

CERTIFIED LAND CORNER RESTORATION

State of Wisconsin

County of Forest

ss.

I William B. Cochrane, do hereby certify that on the 30 day of April, 1974, I found evidence of the West Quarter corner of Section 3 Township 39 North, Range 14 East, Fourth Principal Meridian, as described hereon; and that from this evidence I established a new monument and accessories as described hereon to perpetuate the original location of this corner:

Description of original monument and accessories and subsequent restorations:

Surveyed in April and May 1865 by Wm. E. Daugherty and Alex McDill
South corrected between sections 3 and 4 40.17 chains
Set 1/4 section post
Tamarack, 12", N2°E, 119 lks.
Tamarack, 12", N13°W, 161 lks.
19.0 lks. South, creek 20 lks. wide runs SE

Description of corner evidence found:

4x4 scribed cedar post. From the post N2°E, 119 lks, large tamarack stump and N13°W, 164 lks. large tamarack stump. Creek, 20 lks. wide, bears North of post 20 lks., Runs NE, 40.00 chains North to township corner.
I believe the stream call was reversed when surveyed in 1865.

Description of monument and accessories I established to perpetuate the location of this corner:

March 23, 1976, I replaced the post with a 2 inch inside diameter, galvanized pipe, 5 feet long filled with concrete with a brass cap stamped: T39N, R14E, 1/4, S3, S4, 1976, S-1107.
From which the following bear:
Tamarack, 10", S43°E, 109.17 feet
Tamarack, 9", S37°W, 54.74 feet
Set a steel sign post South of the monument 0.20 feet

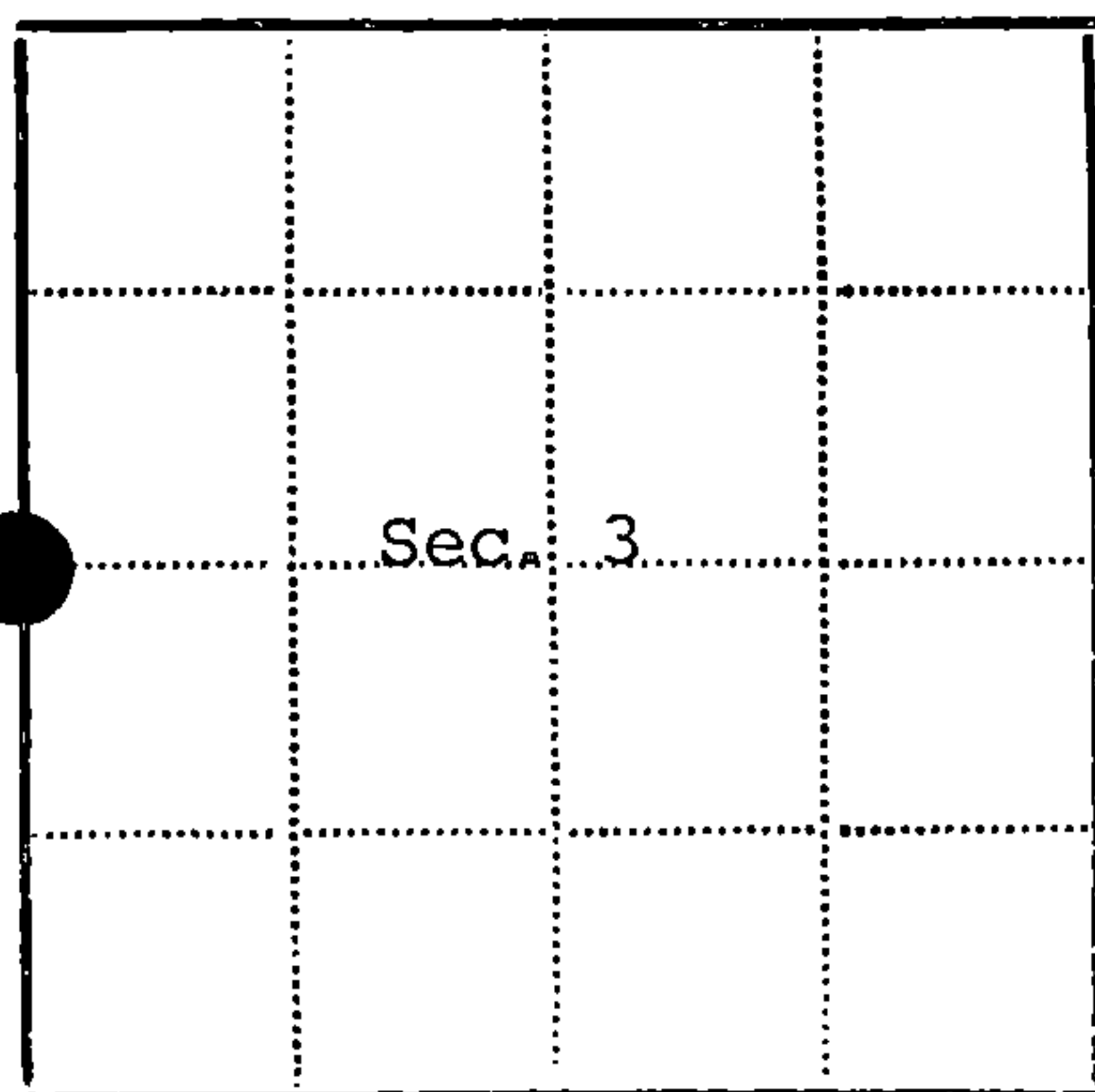
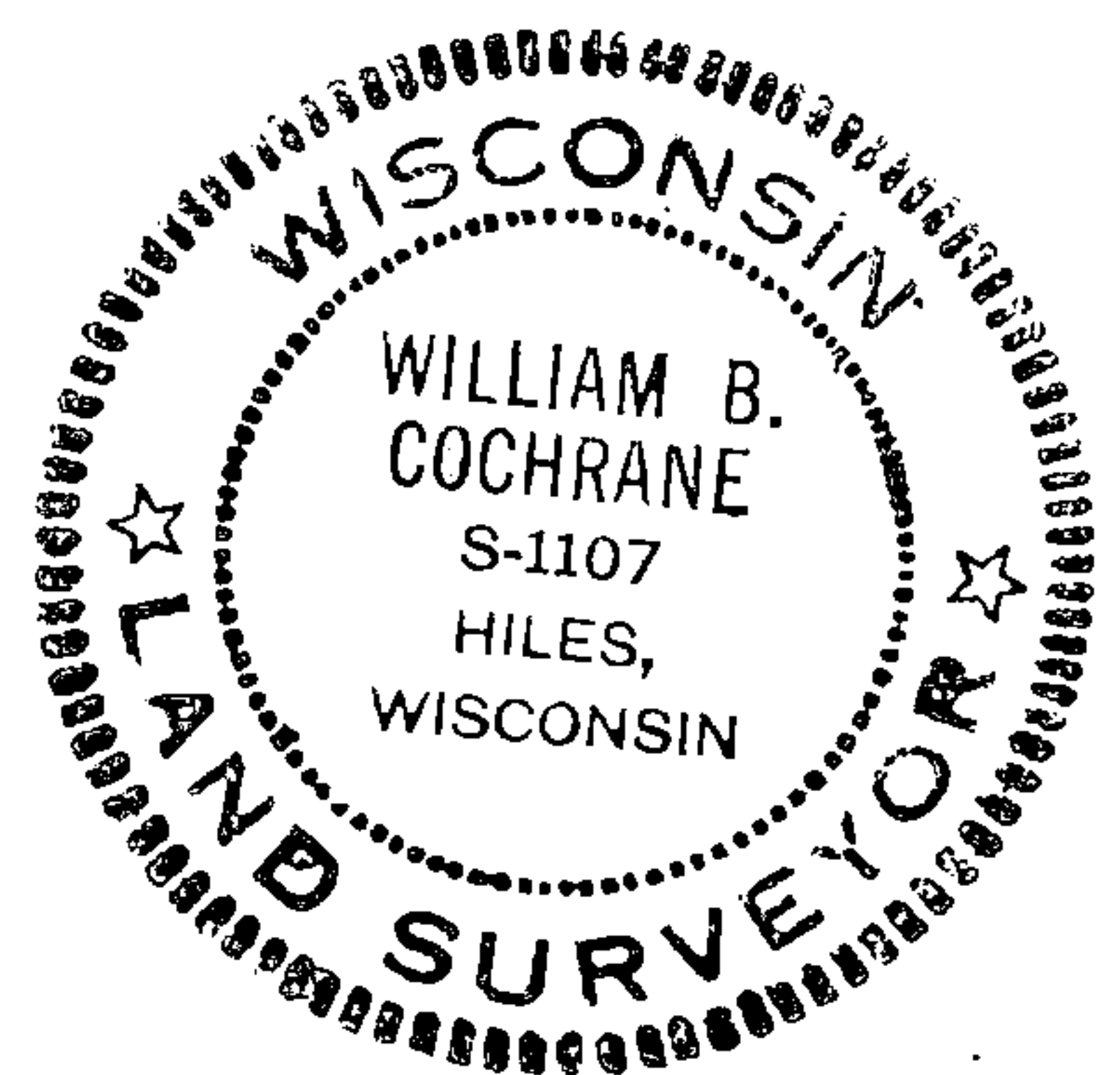

● - Corner monument restored
□ -

Resident witnesses

Dated at Laona Wisconsin, this 30 day of April 1976.

Signature William B. Cochrane Title Survey Technician
(County Surveyor, Registered Land Surveyor, or other duly authorized official)

Surveyors Registration No. S-1107 DOCUMENT NUMBER 109594

Office of Register of Deeds County of Forest

I hereby certify that the within instrument was filed in this office for record on the 2nd day of July 1976, and was filed in Book No. Page No. of County Records.

Signature Eugene Stately Title Register of Deeds

Township 39 North, Range 14 East, Section 3, Index No. C-13, Page No.

43914042000

13

U.S. PUBLIC LAND SURVEY MONUMENT RECORD

Index No. C-13

State of Wisconsin }
County of Forest } ss.

I William B. Cochrane, do hereby
certify that on the 22nd day
of July, 1985, I found
evidence of the West Quarter
corner of Section 3
Township 39 North, Range
14 East, Fourth Principal Meridian,
as described hereon; and that from this evidence
I established a new monument and accessories
as described hereon to perpetuate the original
location of this corner.

Resident witnesses:

Tony Tillman

State Plane Co-ordinates
N- 265,969.8760
E-2,321,601.2990

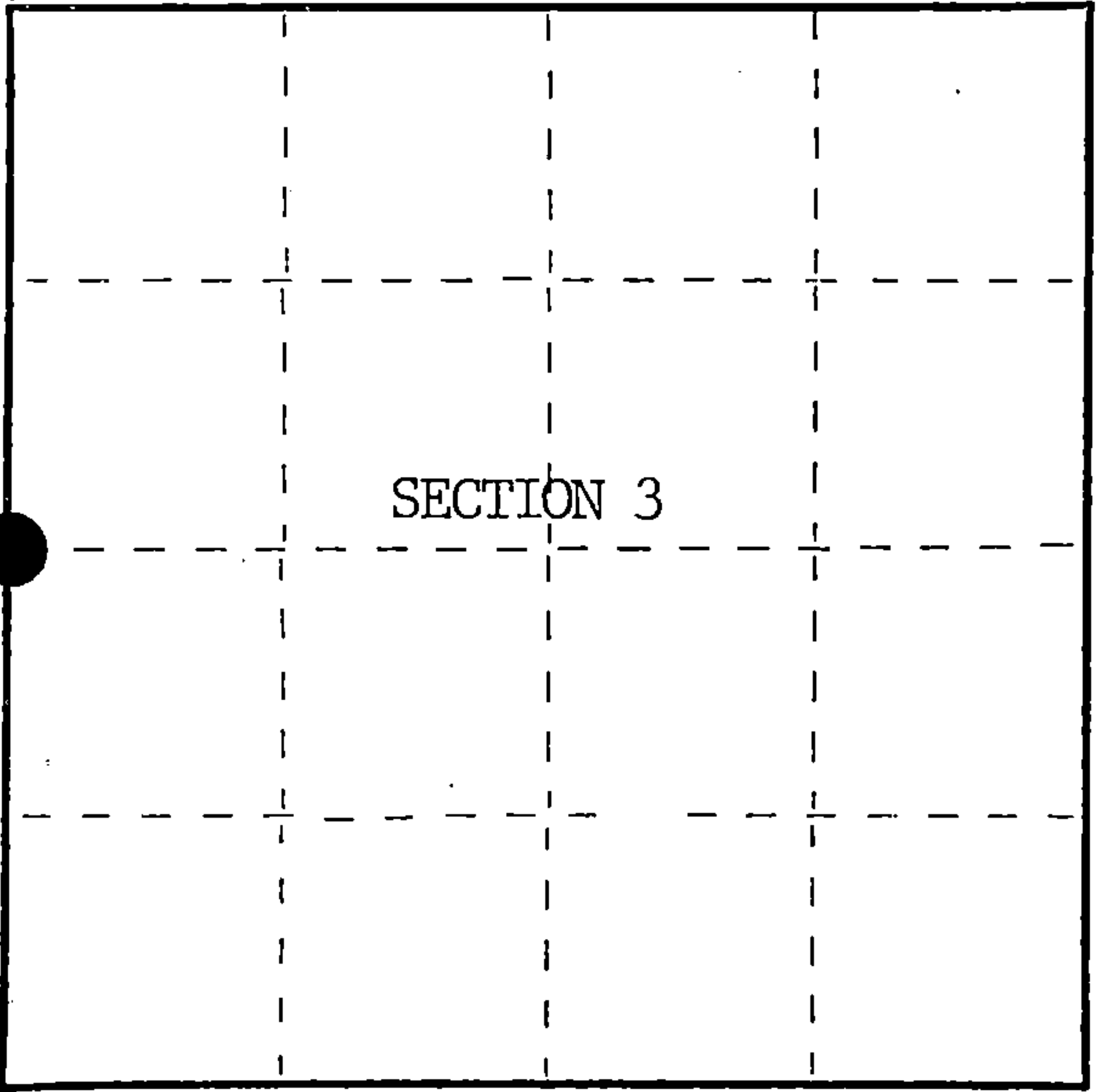

○ = Corner monument restored.

History of original corner establishment:

Original Government Survey in 1865 by William E. Daugherty and Alex McDill.

Corner restored on April 30th, 1974, by William B. Cochrane, a Registered Land Surveyor with the U.S. Forest Service.

See Certified Land Corner Restoration Certificate #109894, filed in the Registrar of Deeds Office, in the Forest County Courthouse.

Description of corner evidence found:

Found monument as described and in place, from which the following bear;

Tamarack	11"	S43°E	109.17 feet
Tamarack	10"	S37°W	54.74 feet
Steel Sign Post		South	0.20 feet

Description of monument and accessories I established to perpetuate the original location of this corner.

Blazed and scribed a new bearing tree;

Spruce	7"	S80°W	65.40 feet
Re-set Steel Sign Post		SW	2.00 feet

Dated at Hiles, Wis., this 5th day of February, 1986

Signature William B. Cochrane Title Land Surveyor Registration No. S-1107
(County Surveyor, Registered Land Surveyor, or other duly authorized official)

Office of Register of Deeds, County of Forest, I hereby certify that the within
instrument was filed in this office for record on the 11th day of March, 1987
at 3:30 o'clock P. M.

Paul Achenbrenner
(Register of Deeds)

By Deputy

- (e) Describe any material discrepancy between the location of the corner as restored or reestablished and the location of that corner as previously restored or reestablished by distance and direction. Show the discrepancy on the plan view drawing under (d), above. Show the distances between the corner as previously restored or reestablished and (1) the corner as restored or reestablished, and (2) to at least 2 of the witness monuments shown on the drawing in (d), above.

See drawing below.

- (f) Was the corner restored through acceptance of (1) an obliterated evidence location, or, (2) a found perpetuated location?

Restored through acceptance of a found perpetuated location.

- (g&h) Was the corner reestablished through lost corner proportionate methods? If so, show the method, including the directions and distances to other public land survey corners used as evidence or used for proportioning in determining the corner location?

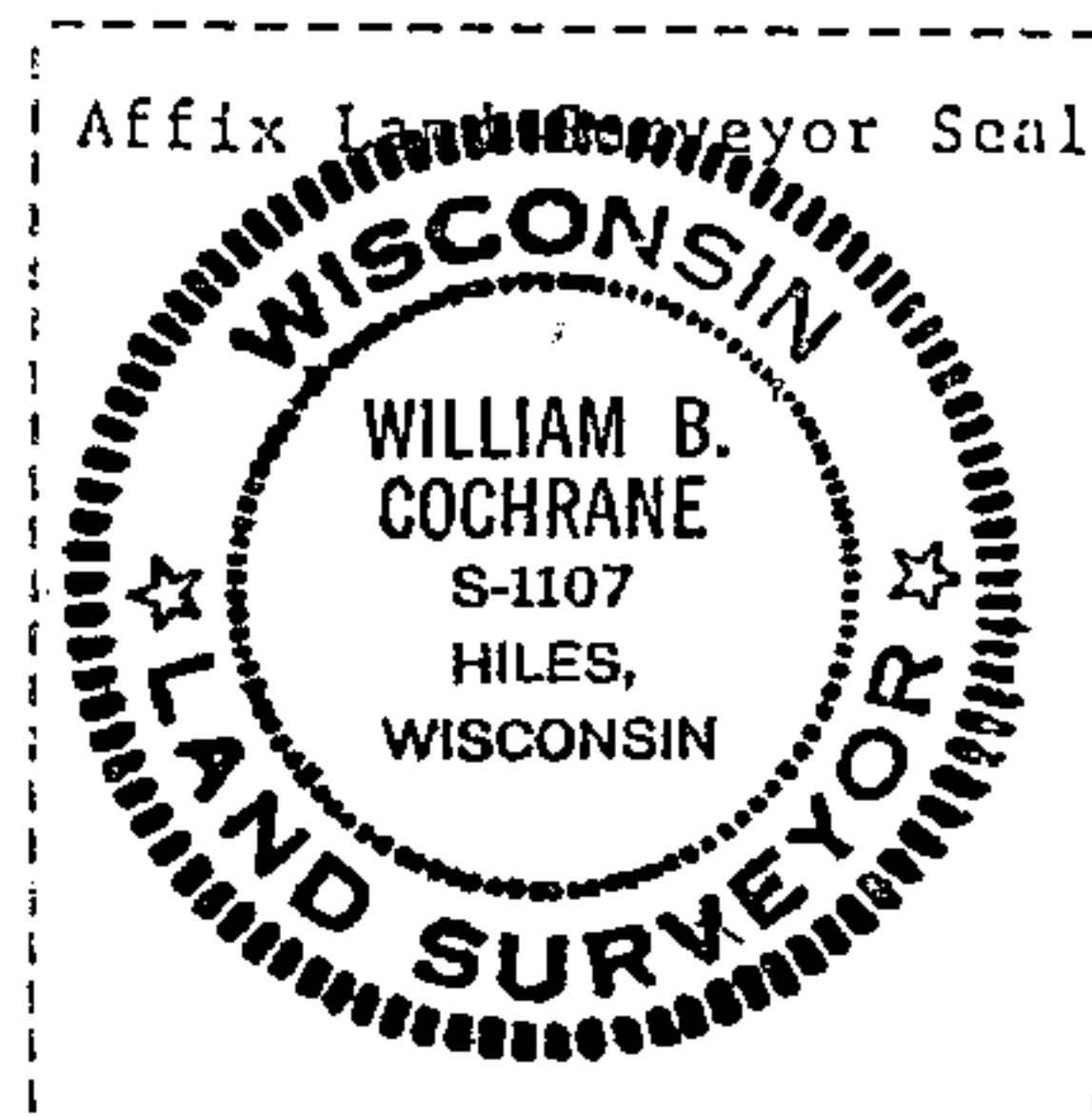
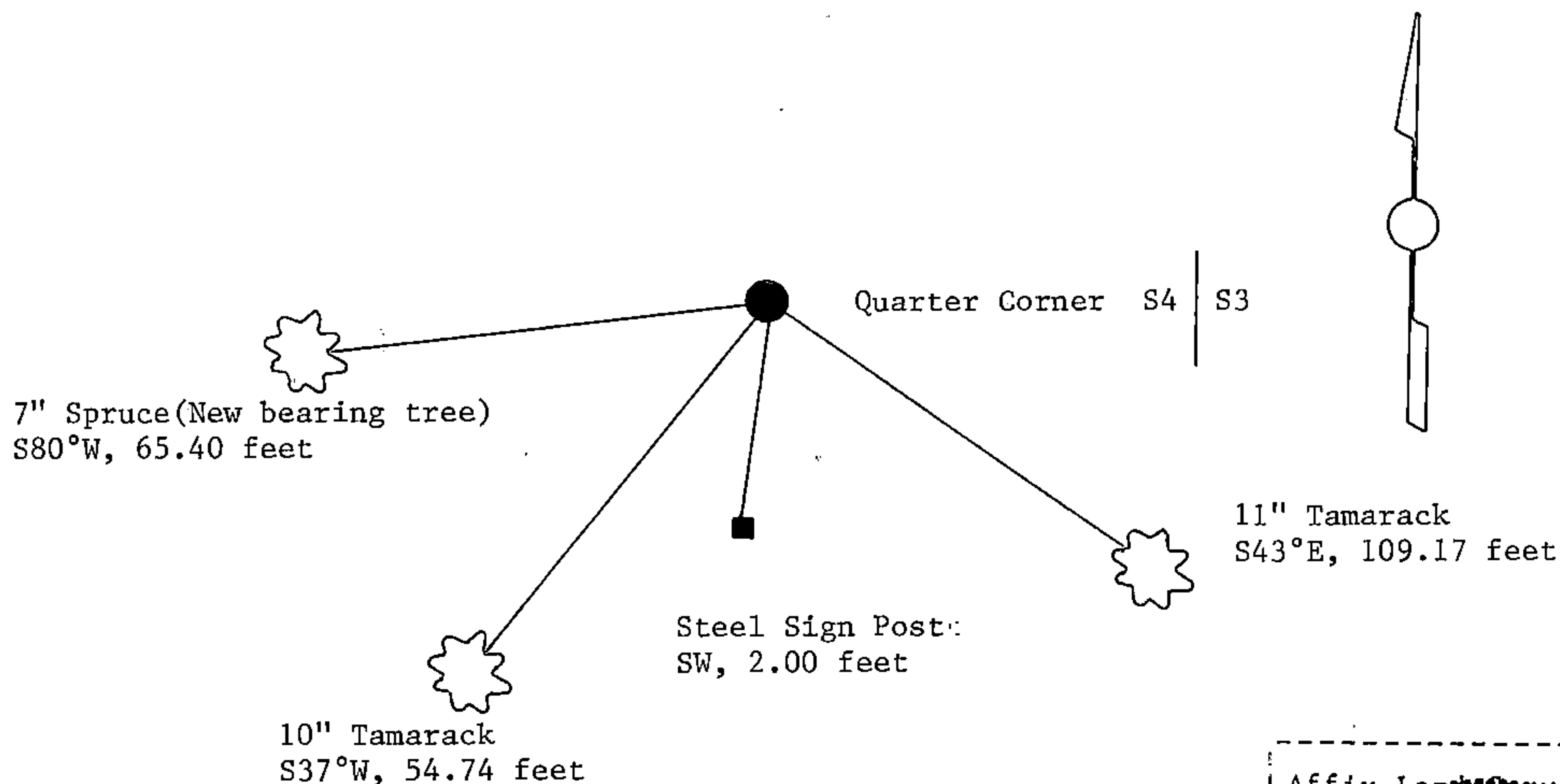

- (i) 1. William B. Cochrane
(type or print name) certify that the corner location shown on this record was determined by me or under my direction and control and that this U.S. Public Land Survey Monument Record is correct and complete to the best of my knowledge and belief.

William B. Cochran October 7, 1986
Signature Date

Survey requested by: Larry R. Gier 5-9-81
District Ranger Date

