

U.S. PUBLIC LAND SURVEY MONUMENT RECORD

Index No. V-19

State of Wisconsin }
County of Forest } ss.

I, William B. Cochrane, do hereby certify that on the 10th day of September, 1986, I found evidence of the North Quarter corner of Section 35 Township 39 North, Range 14 East, Fourth Principal Meridian, as described hereon; and that from this evidence I established a new monument and accessories as described hereon to perpetuate the original location of this corner.

Resident witnesses:

David Brownell

Tony Tillman

State Plane Co-ordinates
N- 242,537.5761
E-2,329,784.5650

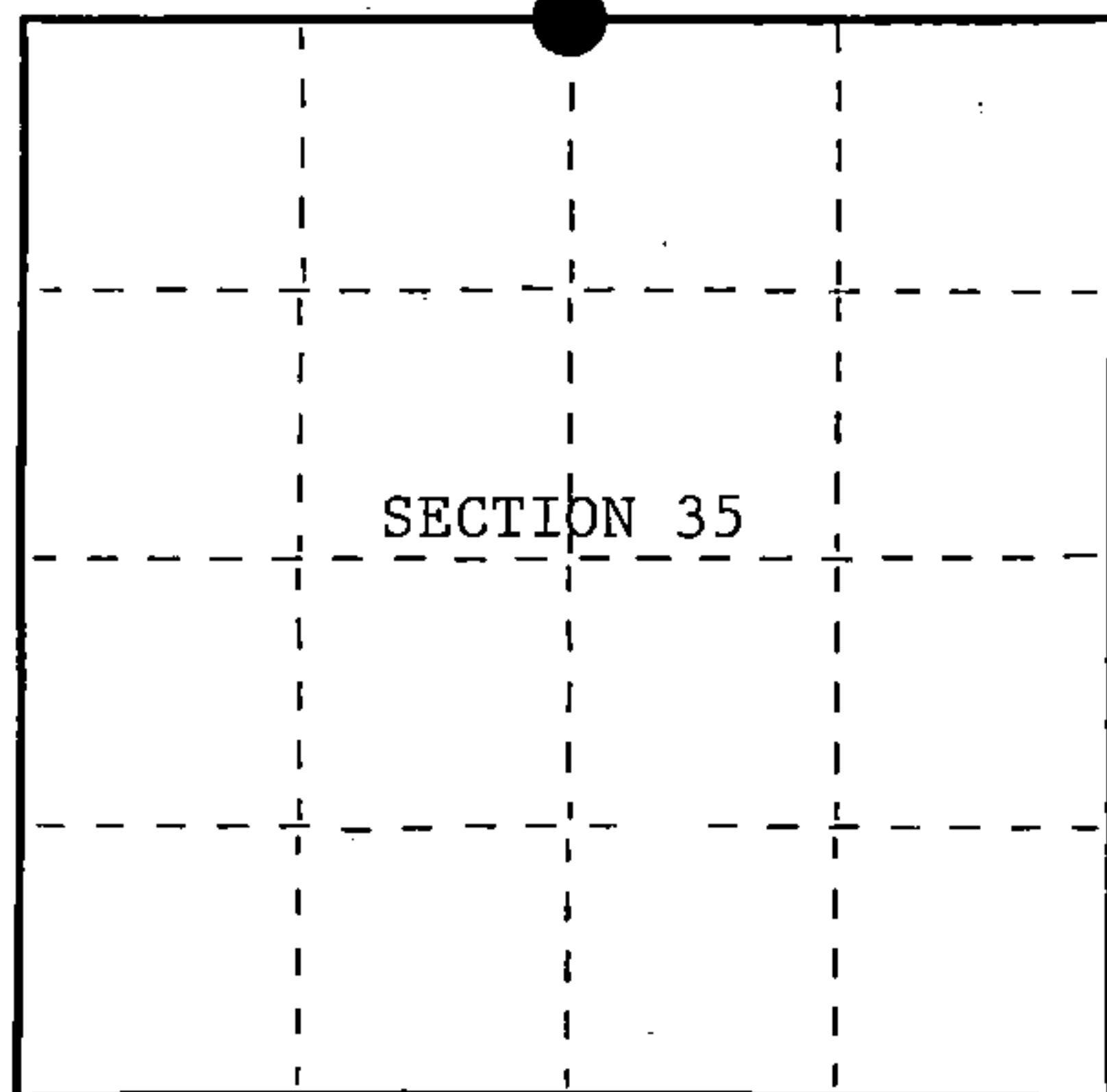

○ = Corner monument restored.

History of original corner establishment:

Original Government Survey in 1865 by William E. Daugherty and Alex McDill. West corrected between Sections 26 and 35, at 39.95 chains, set Quarter Section Post to Sections 26 and 35, from which the following bear;

Hemlock	25"	N22°W	5 lks.
Sugar	16"	S31°W	20 lks.

Description of corner evidence found:

No corner evidence was recovered.

The corner position is re-established at proportionate distance and on line between the Northwest and Northeast Section Corners of Section 35.

Description of monument and accessories I established to perpetuate the original location of this corner.

At the corner position, set a 2½ inch diameter aluminum pipe monument, 3 feet long, 2½ feet in the ground, with an aluminum cap stamped; T39N, R14E, 1/4, S26, S35, 1986, S-1107. From which the following new blazed and scribed bearing trees bear;

Maple	18"	S23°W	24.33 feet
Maple	22"	N34°W	29.38 feet
Steel Sign Post		South	1.00 feet

Dated at Hiles, Wis., this 2nd day of February, 1987

Signature William B. Cochrane Title Land Surveyor Registration No. S-1107
(County Surveyor, Registered Land Surveyor, or other duly authorized official)

Office of Register of Deeds, County of Forest, I hereby certify that the within instrument was filed in this office for record on the 11th day of March, 1987 at 3:30 o'clock P. M.

Paul Aschenbrenner
(Register of Deeds)

By Deputy

- (e) Describe any material discrepancy between the location of the corner as restored or reestablished and the location of that corner as previously restored or reestablished by distance and direction. Show the discrepancy on the plan view drawing under (d), above. Show the distances between the corner as previously restored or reestablished and (1) the corner as restored or reestablished, and (2) to at least 2 of the witness monuments shown on the drawing in (d), above.

See drawing below.

- (f) Was the corner restored through acceptance of (1) an obliterated evidence location, or, (2) a found perpetuated location?

- (g&h) Was the corner reestablished through lost corner proportionate methods? If so, show the method, including the directions and distances to other public land survey corners used as evidence or used for proportioning in determining the corner location?
This corner was re-established using State Plane Co-ordinates computed from Aerial Photography and a Global Positioning Satellite Survey. The computed corner position was located in the field using a North Seeking Gyro, an Electronic Distance Meter, and/or a steel tape.

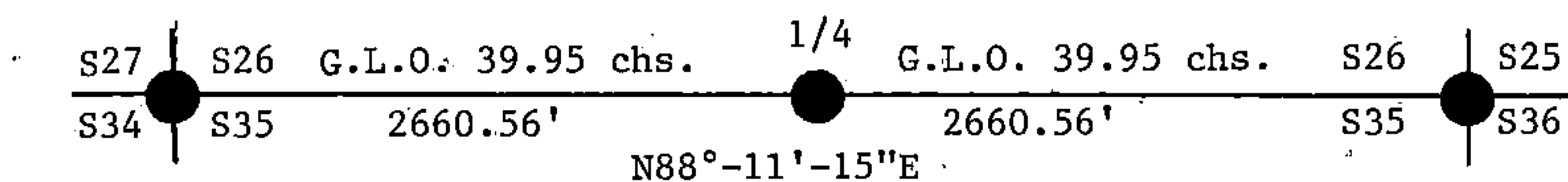

22" Maple (New bearing tree)
N34°W, 29.38 feet



Quarter Corner

S26
S35



Steel Sign Post
South 1.00 feet

18" Maple (New bearing tree)
S23°W, 24.33 feet

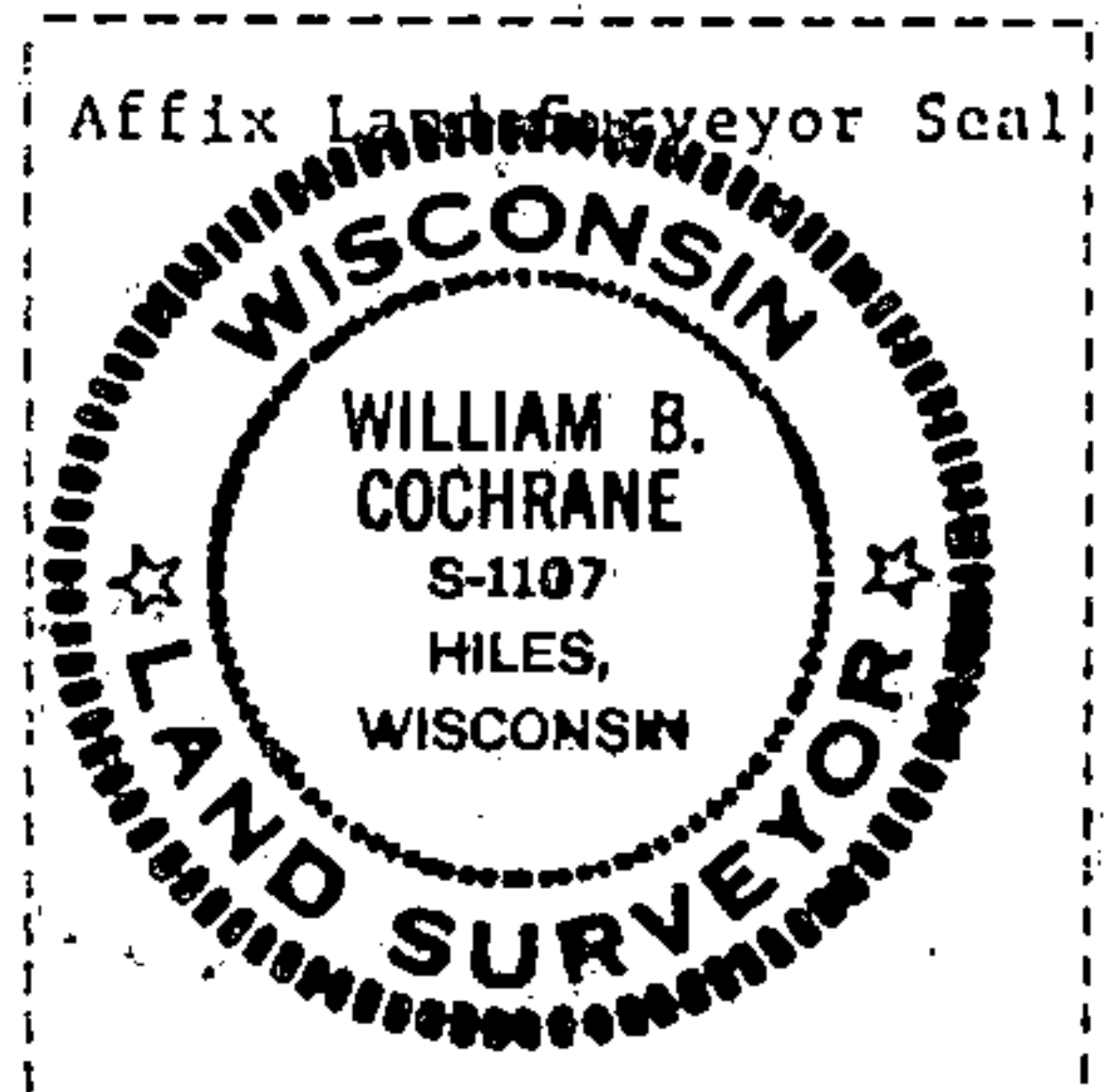

- (i) I, William B. Cochrane
(type or print name) certify that the corner location shown on this record was determined by me or under my direction and control and that this U.S. Public Land Survey Monument Record is correct and complete to the best of my knowledge and belief.

William B. Cochrane
Signature

February 2, 1987
Date

Survey requested by: Edward Eger

3-9-87

District Ranger

Date

U. S. PUBLIC LAND SURVEY MONUMENT RECORD

INSTRUCTIONS:

This record shall show the location of the corner and shall include all of the following nine elements (a through i).

- (a) Identify the corner by reference to the U.S. public land survey system.
 O = Corner monument restored.

Quarter Corner common to Sections 26 and 35
 T39N, R14E, Forest County, Wisconsin

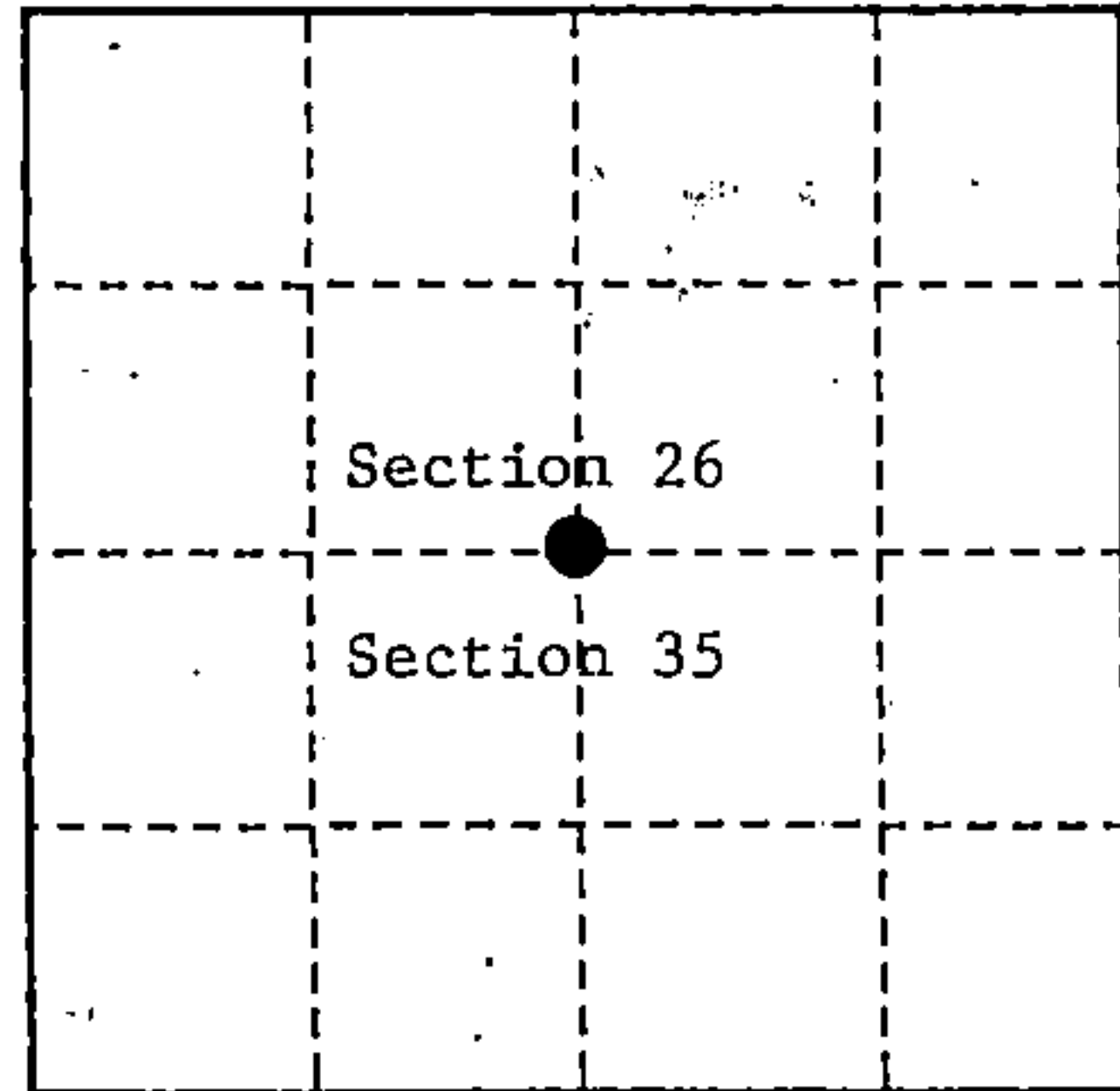

- (b) Describe any record evidence, monument evidence, occupational evidence, testimonial evidence or any other material evidence you considered, and whether the monument was found or placed.

Original Government Survey in 1865 by William E. Daugherty and Alex McDill.

In 1986, William B. Cochrane, a Land Surveyor with the U.S. Forest Service, restored the corner position at proportionate distance and on line between the NW and NE Section corners of Section 35. He set a 2½" diameter aluminum pipe monument, 3 feet long, with an aluminum cap stamped as follows: T39N, R14E, 1/4, S26, S35, 1986, S-1107, from which the following bear:

Maple	18"	S 23°W	24.33 feet
Maple	22"	N 34°W	29.38 feet
Steel sign post		South	1.0 feet

On 8/5/99, Gary L. Pisoni RLS found above monument and assessories as described below.

See previous Land Corner Certificate dated March 11, 1987, Document Number 132394.

- (c) In the plan view drawing below, provide reference ties to at least 4 witness monuments, or, if the location is within a municipality, to at least 2 witness monuments. (Witness monuments shall be made of concrete, natural stone, iron or other equally durable material.)

- (d) Show a plan view drawing depicting the relevant monuments and reference ties which is sufficient in detail to enable accurate relocation of the corner monument if the corner monument is disturbed. Indicate north.

1. Maple, 22", S 23°W, 24.33 feet
2. Maple, 26", N 40°W, 29.38 feet
3. Steel sign post, South, 1.0 feet
4. Basswood, 12", N 37°E, 22.40 feet (NBT)

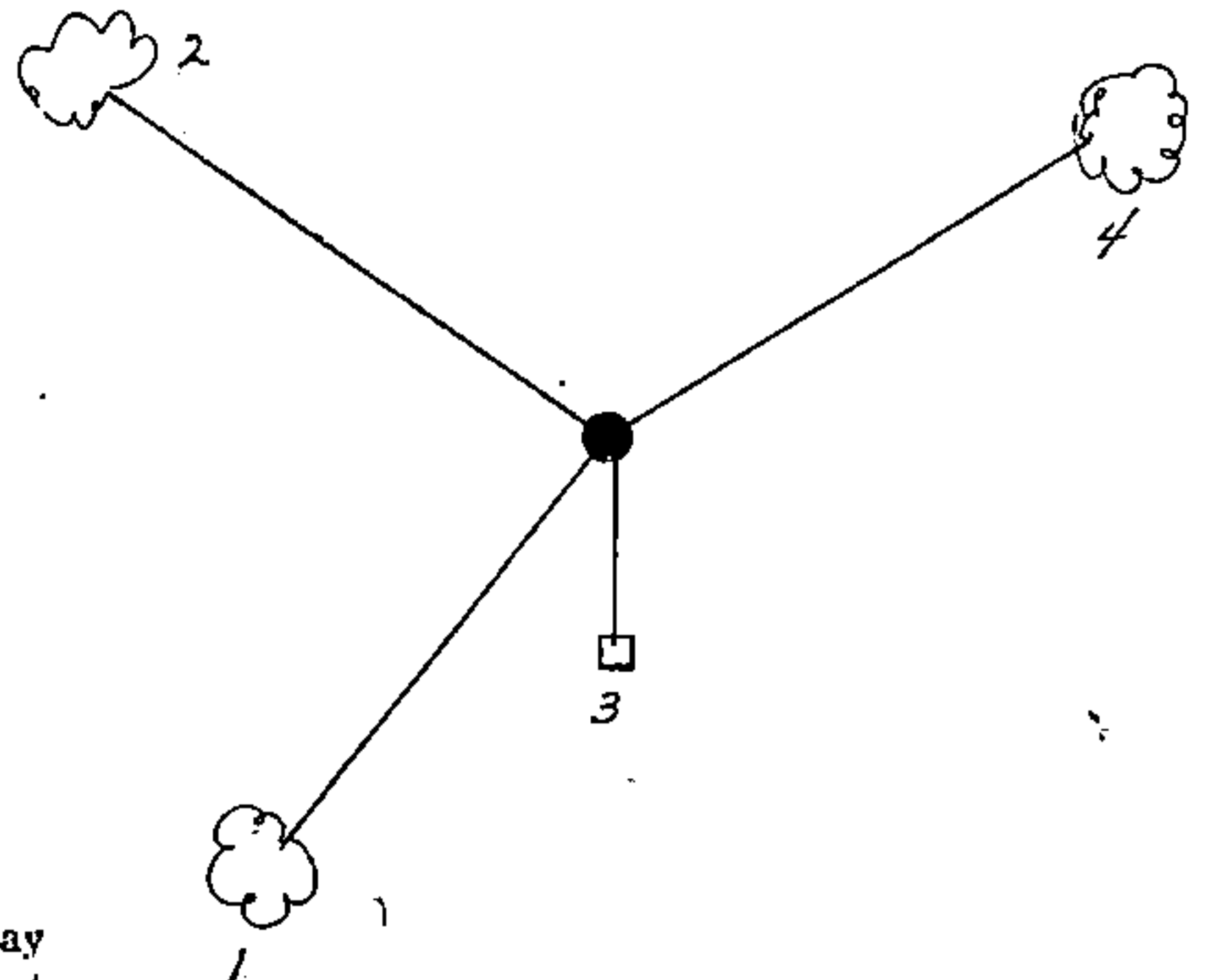

REGISTER'S OFFICE
 Forest County, Wis.
 Received for record this 27th day
 of October A.D. 1999 at
10:05 o'clock A.M. and recorded
 in Vol. Corner Restoration
 page V-19

Kay Swanson, Deputy
 Register of Deeds

V-19

43914260020

V-19

(e) Describe any material discrepancy between the location of the corner as restored or reestablished and the location of that corner as previously restored or reestablished by distance and direction. Show the discrepancy on the plan view drawing under (d), above. Show the distances between the corner as previously restored or reestablished and (1) the corner as restored or reestablished, and (2) to at least 2 of the witness monuments shown on the drawing in (d), above.

None

(f) Was the corner restored through acceptance of (1) an obliterated evidence location, or, (2) a found perpetuated location?

Restored from accepted evidence.

(g & h) Was the corner reestablished through lost corner proportionate methods? If so, show the method, including the directions and distances to other public land survey corners used as evidence or used for proportioning in determining the corner location?

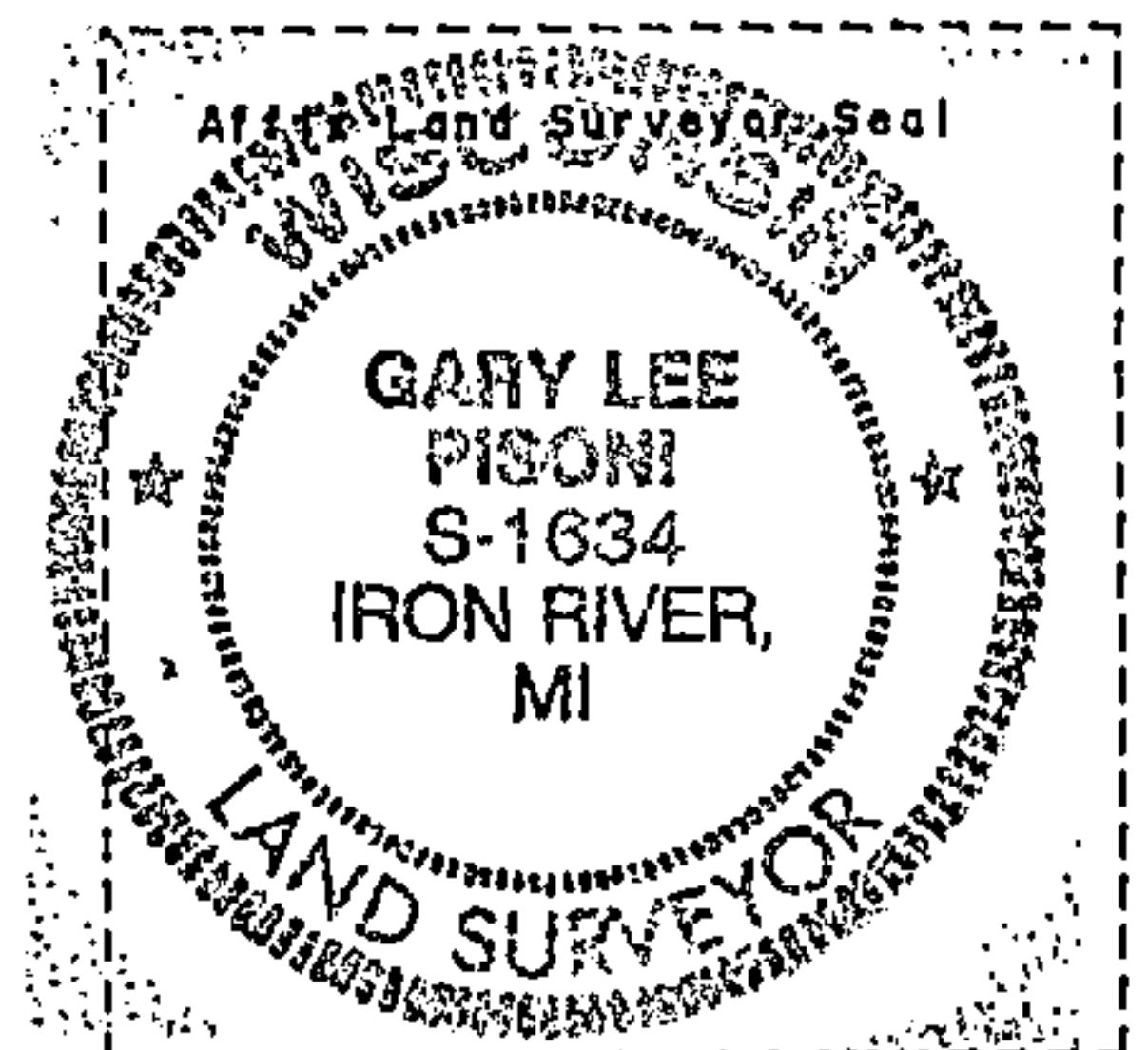

(1) I, Gary L. Pisoni
(type or print name) certify that the corner location shown on this record was determined by me or under my direction and control and that this U.S. Public Land Survey Monument Record is correct and complete to the best of my knowledge and belief.

Gary L. Pisoni
Signature

10-1-99

Date

CERTIFICATE READY FOR FILING:

[Signature]
District Ranger

Stock No. 26273