

A PARCEL LOCATED IN THE NW 1/4 SE 1/4,
SECTION 30, T34N-R11E
BEING LOT 6 AND PART OF LOT 5,
BLOCK 1 OF MORRISSEY'S ADDITION,
CITY OF ANTIGO,
LANGLADE COUNTY, WISCONSIN.

RECORD #

LANGLADE COUNTY SURVEYORS OFFICE

DATE FILED: 2/16/06 BY: D. TLUSTY

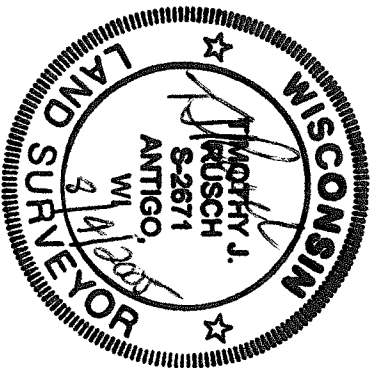
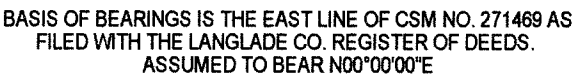

SCALE 1 INCH = 30 FEET

LEGEND

- -FOUND IRON PIPE.
- -FOUND IRON ROD
- -SET 1.05"ODX24" IRON PIPE WEIGHING 1.13 LBS. PER LN. FOOT.
- () RECORD MEASUREMENTS

SURVEYED BY:
RUSCH ENGINEERING & SURVEYING LLC
400 RUSCH ROAD
ANTIGO, WI 54409
715-623-5044
PROJECT #05-4459

DRAFTED BY: PAUL MATTMILLER

I, TIMOTHY J. RUSCH, REGISTERED LAND SURVEYOR,
DO HEREBY CERTIFY:

THAT I HAVE SURVEYED BY THE ORDER OF JAMES
FERK, OWNER, A PARCEL BEING LOT 6 AND THE SOUTH 10'
OF LOT 5, BLOCK ONE OF MORRISEY'S ADDITION
TO THE CITY OF ANTIGO.

THAT THIS SURVEY WAS FOR THE PURPOSE OF
LOCATING PROPERTY BOUNDARIES ONLY.

THAT THIS MAP IS A TRUE AND CORRECT REPRESENTATION
OF THE BOUNDARIES SURVEYED TO THE BEST OF MY
KNOWLEDGE AND BELIEF.