

Document Number  
216273

REGISTER'S OFFICE  
Forest County, Wis. } 2nd  
Received for record this 2nd day  
of February A.D., 2015 at  
11:40 o'clock A.M. and recorded  
in Vol. 101 of the  
USRA E-7  
Erica S. Deaton, Deputy  
Register of Deeds

RC-7150-11 (9/1/66)

CERTIFIED LAND CORNER RESTORATION

State of Wisconsin }  
County of Forest } ss.

I, Randy R. Erickson, do hereby certify that on the 16 day of Sept, 19 2014  
I found evidence of the South Quarter corner of Section 5  
Township 35 North, Range 14 East, Fourth Principal Meridian, as described  
hereon; and that from this evidence I established a new monument and accessories as described hereon to per-  
petuate the original location of this corner:

Description of original monument and accessories and subsequent restorations:

1859 James McBride set a wood post and Marked Bearing Trees:  
Spruce 8" S 31 E° 34 lks Spruce 8" N 26° W 41 lks

1992 RLS #1651, Al Harrison found no evidence of corner and restored by  
proportionate measure. Set a 2" x 36" aluminum monument. Marked BTS:

Tamarack 6" N 47° E 7.35 feet Spruce 6" S 31° W 12.30 feet  
Spruce 6" N 70° W 7.00 feet Steel Sign Post South 1.0 feet

Description of corner evidence found:

Found monument and accessories in place from 1992. Spruce BTs had been cut  
for GPS procedures.

Description of monument and accessories I established to perpetuate the location of this corner:

Monument left in place. Tamarack bearing tree good, Steel sign post good.  
Marked new Bearing Trees:

Tamarack 9" S 51° E 29.46 feet  
Tamarack 8" N 49° W 23.79 feet

Established Wisconsin North Zone State Plane coordinates for corner:

N 137367.11 E 2284311.16 NAD 83 2011 U.S. FOOT

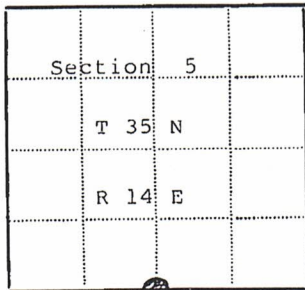
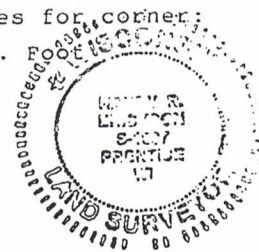

● - Corner monument restored  
□ -

Resident witnesses.....

Dated at Park Falls Wisconsin, this 14 day of January  
19 2015

Signature [Signature] Title Prof. Land Surveyor  
(County Surveyor, Registered Land Surveyor, or other duly authorized official)

Surveyors Registration No. 1897

Office of..... County of.....

I hereby certify that the within instrument was filed in this office for record  
on the..... day of..... 19....., and was filed in Book  
No..... Page No..... of County Records.

Signature..... Title.....

Township 35 North, Range 14 East, Section 5, Index No....., Page No.....

23