

139183

## U. S. PUBLIC LAND SURVEY MONUMENT RECORD.

## INSTRUCTIONS:

This record shall show the location of the corner and shall include all of the following nine elements (a through i).

- (a) Identify the corner by reference to the U.S. public land survey system.  
 O = Corner monument restored.

CENTER QUARTER CORNER TO SECTION 3,  
 TWP. 34 N., R. 14 E.

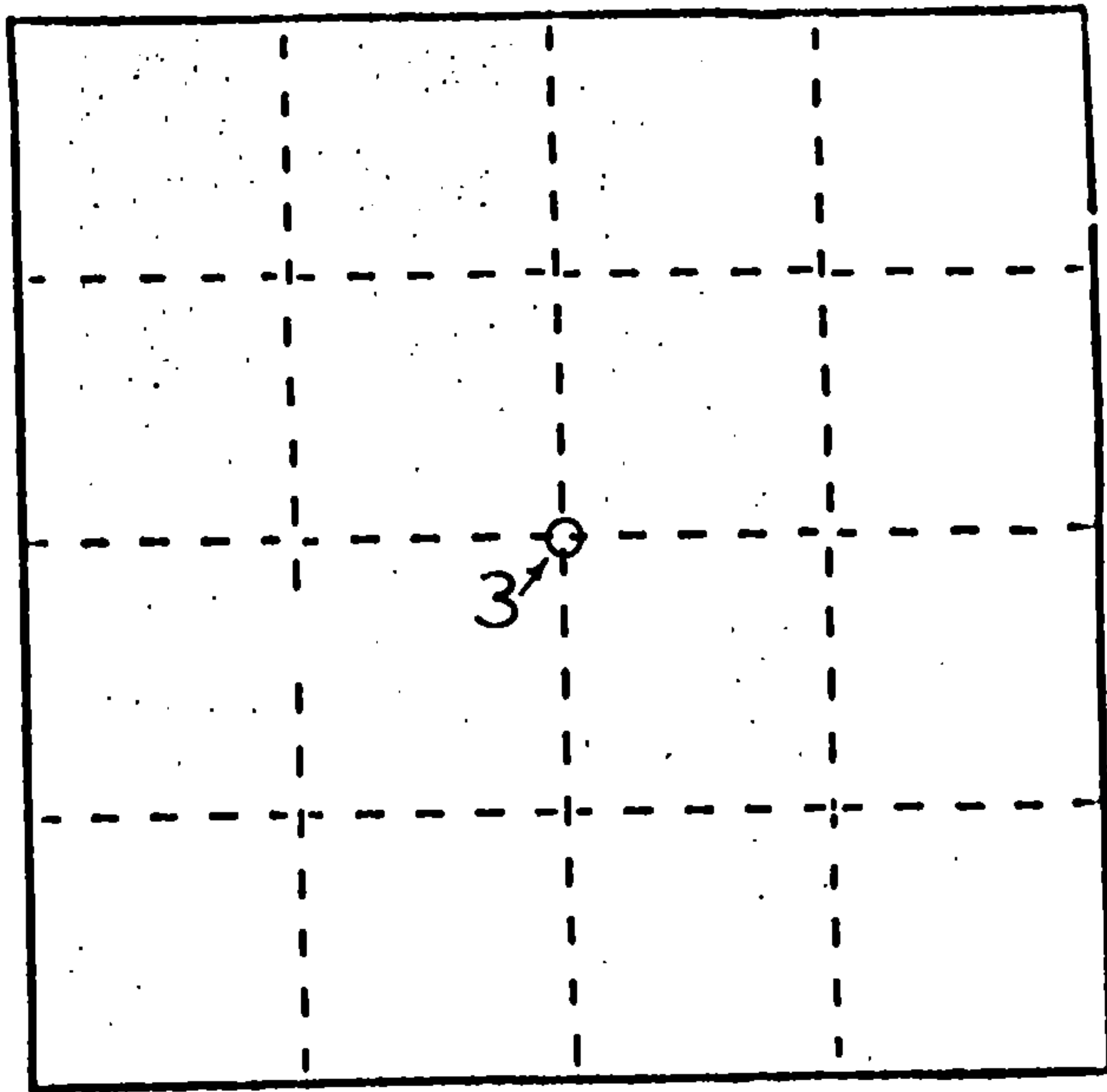

- (b) Describe any record evidence, monument evidence, occupational evidence, testimonial evidence or any other material evidence you considered, and whether the monument was found or placed.

1857 & 1859 ORIGINAL SURVEY OF SECTION 3  
 1982 SUBDIVISION OF SECTION 3, BY STEFAN R.L.S. NO. S-1558  
 SET 2" DIA. ALUMINUM MONUMENT AT CENTER QUARTER CORNER  
 B.T.s TAMARACK 6" N.17° E. 50.94FT., TAMARACK 8" S.29° E. 29.73FT.,  
 TAMARACK 10" S.19° W. 26.00FT.  
 WITNESS STEEL SIGN POST NORTH 15.00FT.  
 1989 DOBBRATZ R.L.S. NO. S-973, FOUND B.T.s AND POST AS NOTED BY  
 STEFAN IN 1982, TOP OF MONUMENT SHEARED OFF BY ROAD GRADER.

- (c) In the plan view drawing below, provide reference ties to at least 4 witness monuments, or, if the location is within a municipality, to at least 2 witness monuments. (Witness monuments shall be made of concrete, natural stone, iron or other equally durable material.)  
 Describe witness monuments.

- (d) Show a plan view drawing depicting the relevant monuments and reference ties which is sufficient in detail to enable accurate relocation of the corner monument if the corner monument is disturbed. Indicate north.

REGISTER'S OFFICE  
 Forest County, Wis.

Received for record this 26<sup>th</sup> day  
 of February A.D. 1990 at  
10:10 o'clock A.M. and recorded  
 in Vol. CORNER RESTORATIONS  
 page 15  
*Paul Henderson*  
 Register of Deeds

B.T.s ① TAMARACK 6" N.17° E. 50.94FT. (EXISTING)  
 ② TAMARACK 8" S.29° E. 29.73FT. (EXISTING)  
 ③ TAMARACK 10" S.19° W. 26.00FT. (EXISTING)

## WITNESS MONUMENTS

- ⑤ 1" X 36" ALUMINUM MONUMENT 16.00FT. (NEW)  
 NORTH OF CENTER QUARTER CORNER  
 ⑥ STEEL SIGN POST 15.05 NORTH OF (EXISTING)  
 CENTER QUARTER CORNER  
 ④ CENTER QUARTER CORNER, REMAINS OF 2"  
 DIA. ALUMINUM MONUMENT.

NOTE! 1" X 36" ALUMINUM MONUMENT IS STAMPED  
 TO IDENTIFY CORNER.

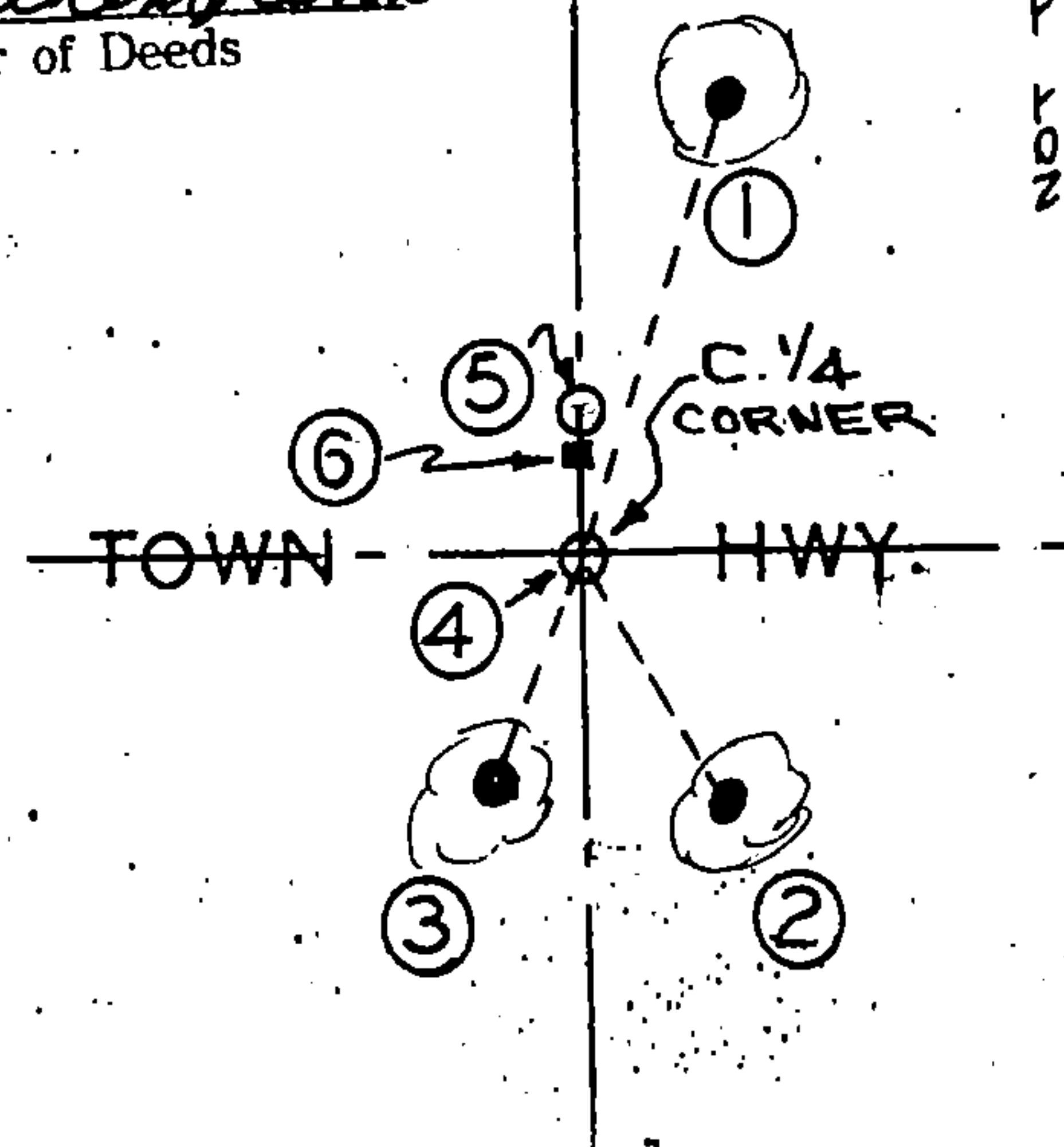

43414032020

C-15

C 15

- (e) Describe any material discrepancy between the location of the corner as restored or reestablished and the location of that corner as previously restored or reestablished by distance and direction. Show the discrepancy on the plan view drawing under (d), above. Show the distances between the corner as previously restored or reestablished and (1) the corner as restored or reestablished, and (2) to at least 2 of the witness monuments shown on the drawing in (d), above.

(NONE)

- (f) Was the corner restored through acceptance of (1) an obliterated evidence location, or, (2) a found perpetuated location?

(2) FOUND PERPETUATED LOCATION

- (g&h) Was the corner reestablished through lost corner proportionate methods? If so, show the method, including the directions and distances to other public land survey corners used as evidence or used for proportioning in determining the corner location?

WAYNE G. DOBBRATZ

- (i) I, Wayne G. Dobbratz (type or print name) certify that the corner location shown on this record was determined by me or under my direction and control and that this U.S. Public Land Survey Monument Record is correct and complete to the best of my knowledge and belief.

Signature

10/6/89

Date

CERTIFICATE READY FOR FILING:

Dennis Starg  
District Ranger

