

Stock No. 26272  
FORM 985  
RC Miller Company  
Milwaukee, Wisconsin

State of Wisconsin }  
County of Forest } ss.

I Glen Barker, do hereby  
certify that on the 19th day  
of November, 1982, I found  
established NE 1/16  
corner of Section 28  
Township 35, North, Range  
13 East, Fourth Principal Meridian,  
as described hereon; and that from this evidence  
I established a new monument and accessories  
as described hereon to perpetuate the original  
location of this corner.

Resident witnesses:

J. Claflin, Reg. Land Surveyor

H. Wagoner

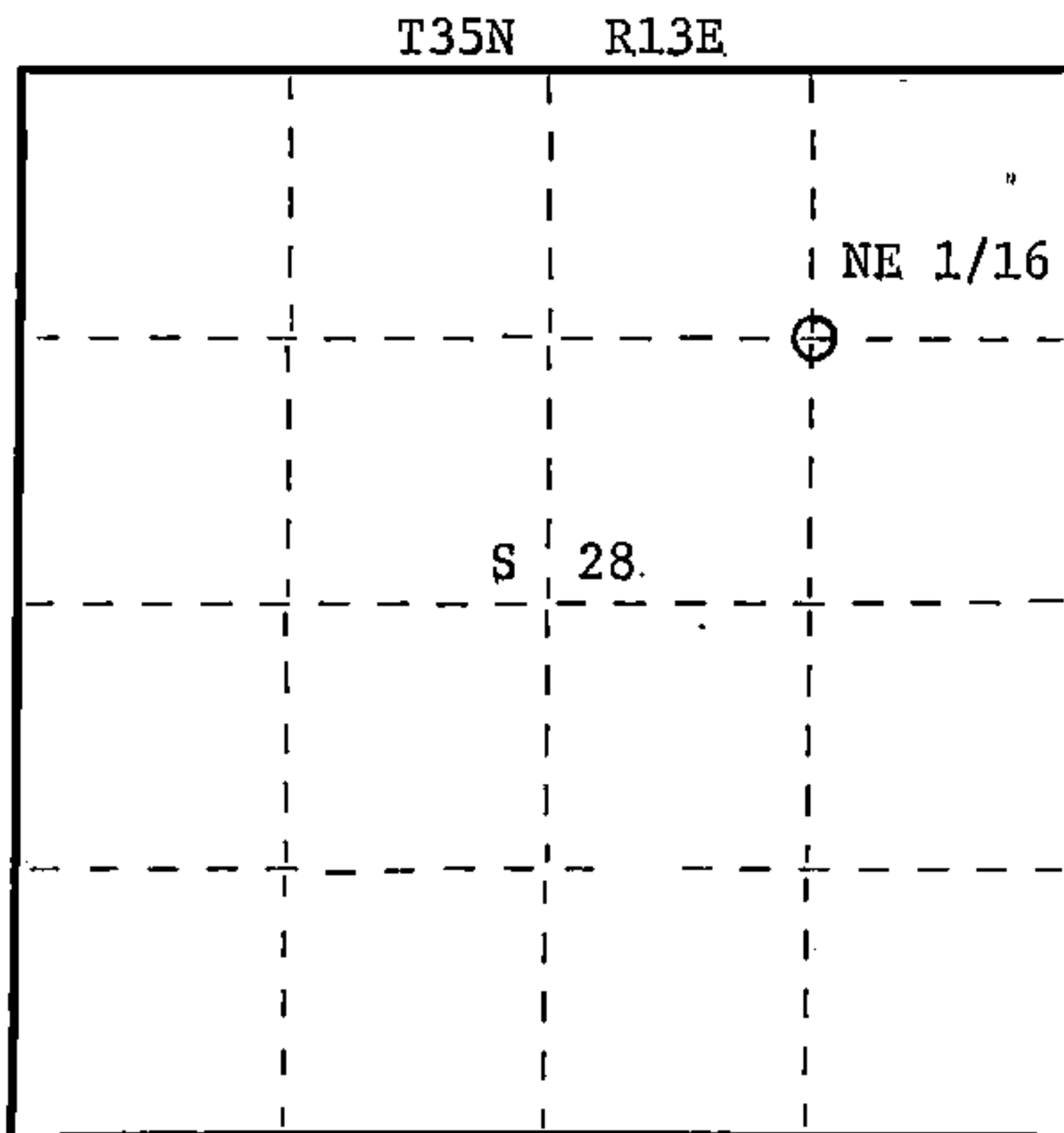
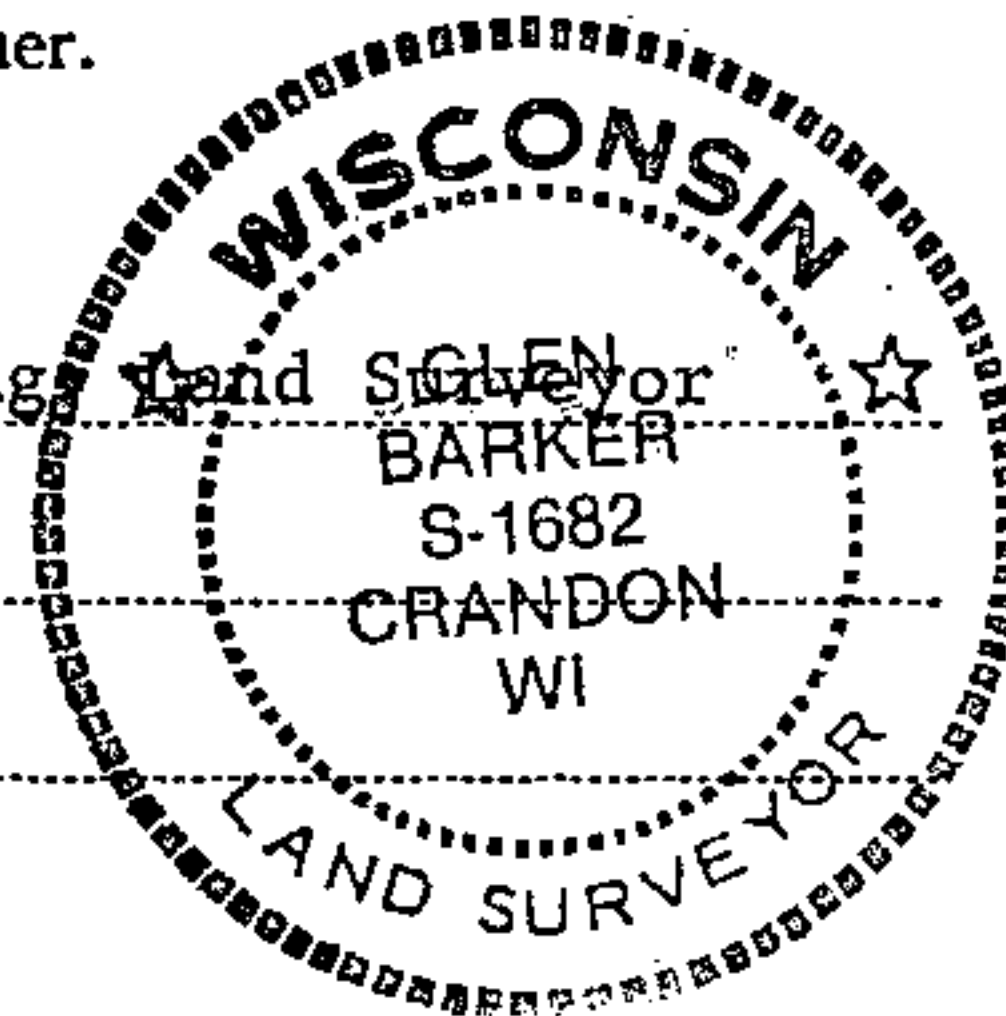

⊙ = Corner monument restored.

# CERTIFIED LAND CORNER RESTORATION

Index No. S-12

S12

History of original corner establishment:

No evidence of any previous corner.

Description of corner evidence found:

Corner established by subdivision of the NE 1/4 section 28. Location of NE 1/16 is  
N 0-19-48 E 1338.27 feet of EC 1/16 and S 87-39-43 E 1310.01 feet of NC 1/16.

Description of monument and accessories I established to perpetuate the original location of this corner.

Set a 1" iron pipe with 2" diameter alloy cap - stamped:  
Monument projects 18" above ground.

Marked NBT's:

Sugar 7" N4°W 28.33 feet  
Sugar 8" N33°E 41.50 feet  
scribed 1/16 B.T.

S1682  
T35N R13E  
NE 1/16 S 28  
CPI-1982

Dated at Rhinelander, Wis., this 21st day of March, 1983.

Signature Glen Barker Title Registered Land Surveyor Registration No. S-1682  
(County Surveyor, Registered Land Surveyor, or other duly authorized official)

Office of Register of Deeds, County of Forest, I hereby certify that the within  
instrument was filed in this office for record on the 7th day of April, 1983  
at 9:30 o'clock A. M.

Eugene Staszny  
(Register of Deeds)

By \_\_\_\_\_ Deputy

DOCUMENT NO. 123147

43513283010