

U. S. PUBLIC LAND SURVEY MONUMENT RECORD

INDEX NO. V-11

Quarter _____ Corner to Section 28 33 T 35 N, R 14 E
(Section/Quarter)

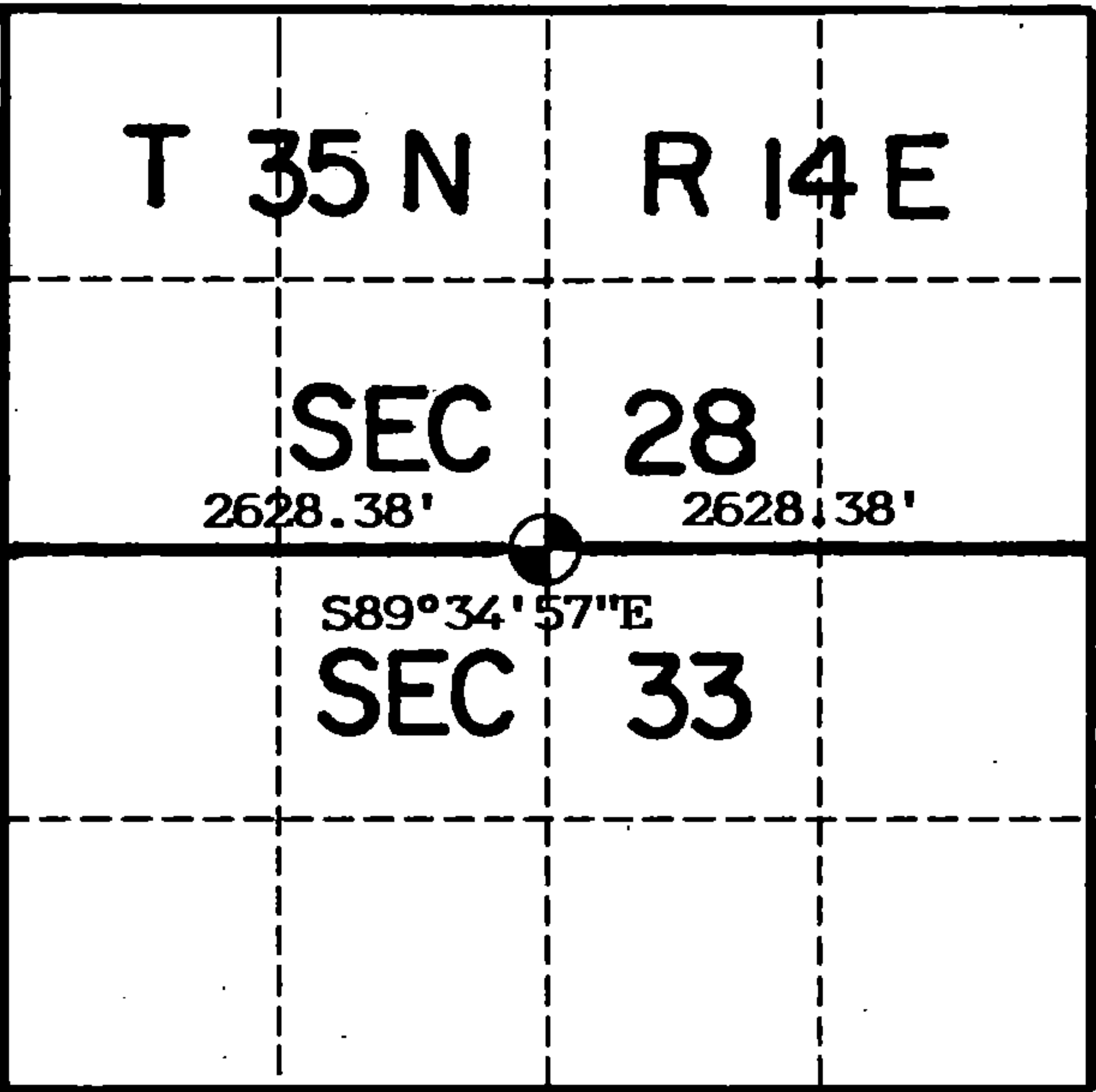

Show distances and bearings if set by
proportional measurement.

History of original corner establishment, record evidence, monument evidence, occupational evidence, testimonial evidence or any other material evidence, and what you found and how the monument was set.

In 1859 James MCBride, contract surveyor, set this corner at 39.99 chains and marked the following bearing trees:

Lind	20"	S28E	30 links
Sugar	7"	N09E	27 "

I stubbed a traverse into the single proportionate position for this corner which fell in line with the southerly portion of an older Red Pine Plantation. A large clump of Basswood was found and some hardwood depressions but pulling the record calls from the bearing trees did not uncover any post evidence. The area was heavily logged to the south and the Pine plantation disrupted other corner evidence. I determined the corner lost and set it at single proportionate measure.

In the plan view drawing below, provide reference ties to at least 4 witness monuments, or, if the location is within a municipality, to at least 2 witness monuments. (Witness monuments shall be made of concrete, natural stone, iron or other equally durable material, except wood other than bearing trees.) Also, show any material discrepancies between the corner restored or re-established and the location of any other previous corner location or occupation.

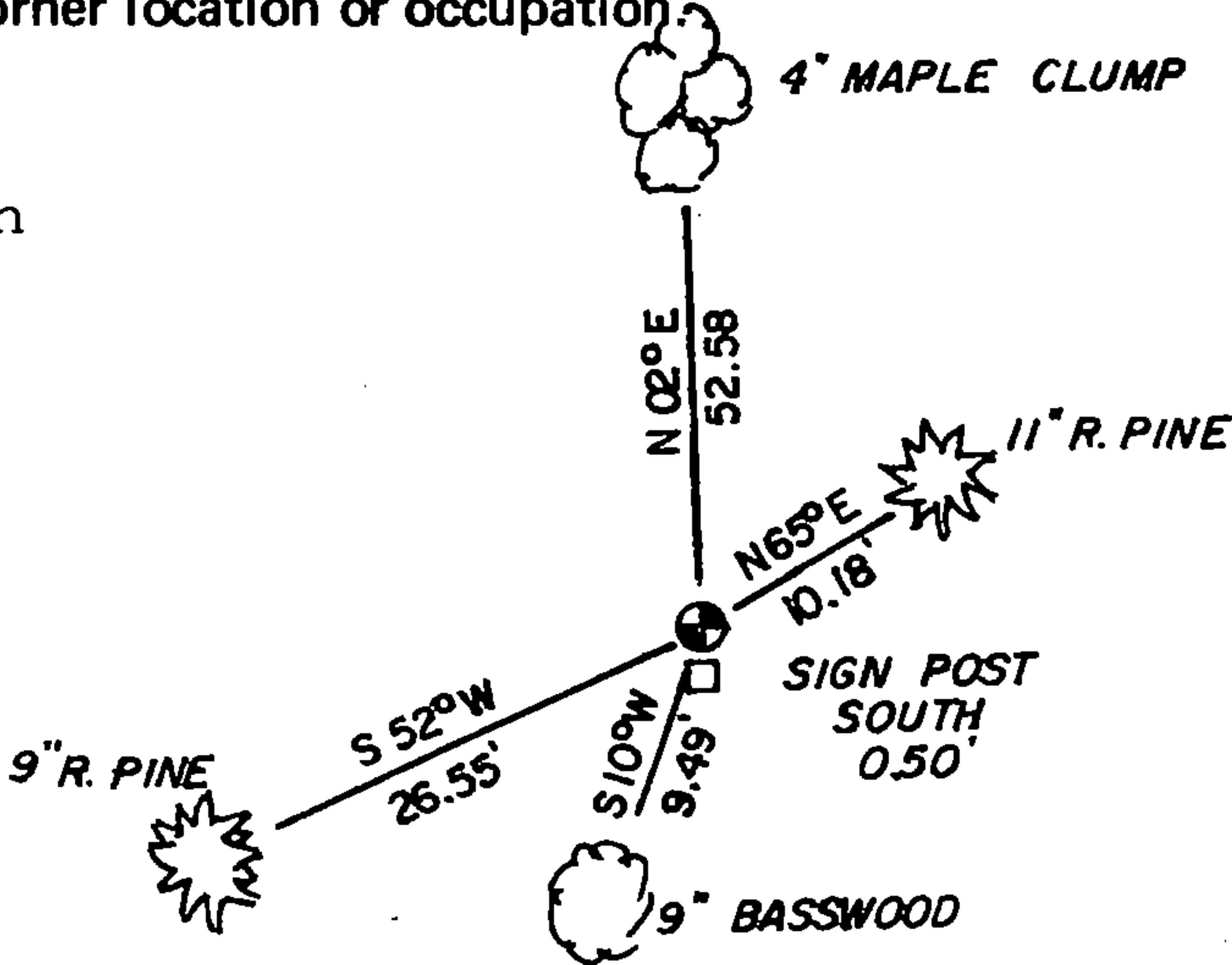

○ = Corner monument restored.



Set a 2"x 36" aluminum monument with cap stamped for corner. Ties are to aluminum nails driven into the tree centers which trees were blazed and scribed. Bearings are magnetic.

I, Kim H Pritzlaff, RLS No. 1259
(Type or print name) certify that the corner location shown on this record was determined by me or under my direction and control and that this U.S. Public Land Survey Monument Record is correct and complete to the best of my knowledge and belief.

Kim Pritzlaff
Signature

1223
Date

Certificate Ready For Filing:

Ralph [Signature]
District Ranger

149073

43514280020

INDEX NO. _____

MAINTENANCE RECORD

Condition of Monument _____

Condition of Ties _____

New Ties, if any:

_____ Date

_____ Signature

Condition of Monument _____

Condition of Ties _____

New Ties, if any:

_____ Date

_____ Signature

Condition of Monument _____

Condition of Ties _____

New Ties, if any:

_____ Date

_____ Signature

REGISTER'S OFFICE
FOREST COUNTY, WIS.
NOV 23 1993
At _____ 9 clock _____ M.
Paul A. Schenck
Register of Deeds