

CERTIFIED LAND CORNER RESTORATION

State of Wisconsin }
County of Forest } ss.

I William B. Cochrane, do hereby certify that on the 15th day of May, 19 80, I found evidence of the Southwest Section corner of Section 30 Township 35 North, Range 16 East, Fourth Principal Meridian, as described hereon; and that from this evidence I established a new monument and accessories as described hereon to perpetuate the original location of this corner:

Description of original monument and accessories and subsequent restorations:

Surveyed in 1857 by Artemas Curtis.
North between Sections 31 and 36, 80.00 chains set post for corner of sections 25, 30, 31 and 36.
Hemlock, 10 inches, S54W, 18 links
Cedar, 10 inches, N34W, 18 links
Hemlock, 14 inches, N56E, 39 links
Hemlock, 10 inches, S14E, 22 links.

Description of corner evidence found:

Old 4 X 4 squared wood post in a mound of stone
Hemlock stump hole, S54W, 18 links
Broken cedar stump, N34W, 18 links
Hemlock stump roots, N56E, 39 links
Hemlock stump mound, S14E, 22 links.

Description of monument and accessories I established to perpetuate the location of this corner:

I replaced the post with a 2 1/2 inch diameter, aluminum pipe, 3 feet long, with an aluminum cap stamped:
T35N, R15E, R16E, S25, S30, S31, S36, 1980, S-1107

Blazed and scribed the following new bearing trees:

Spruce, 9 inches, N68E, 32.73 feet
Spruce, 9 inches, S66E, 14.51 feet
Spruce, 6 inches, S63W, 31.88 feet
Spruce, 6 inches, N35W, 22.35 feet.

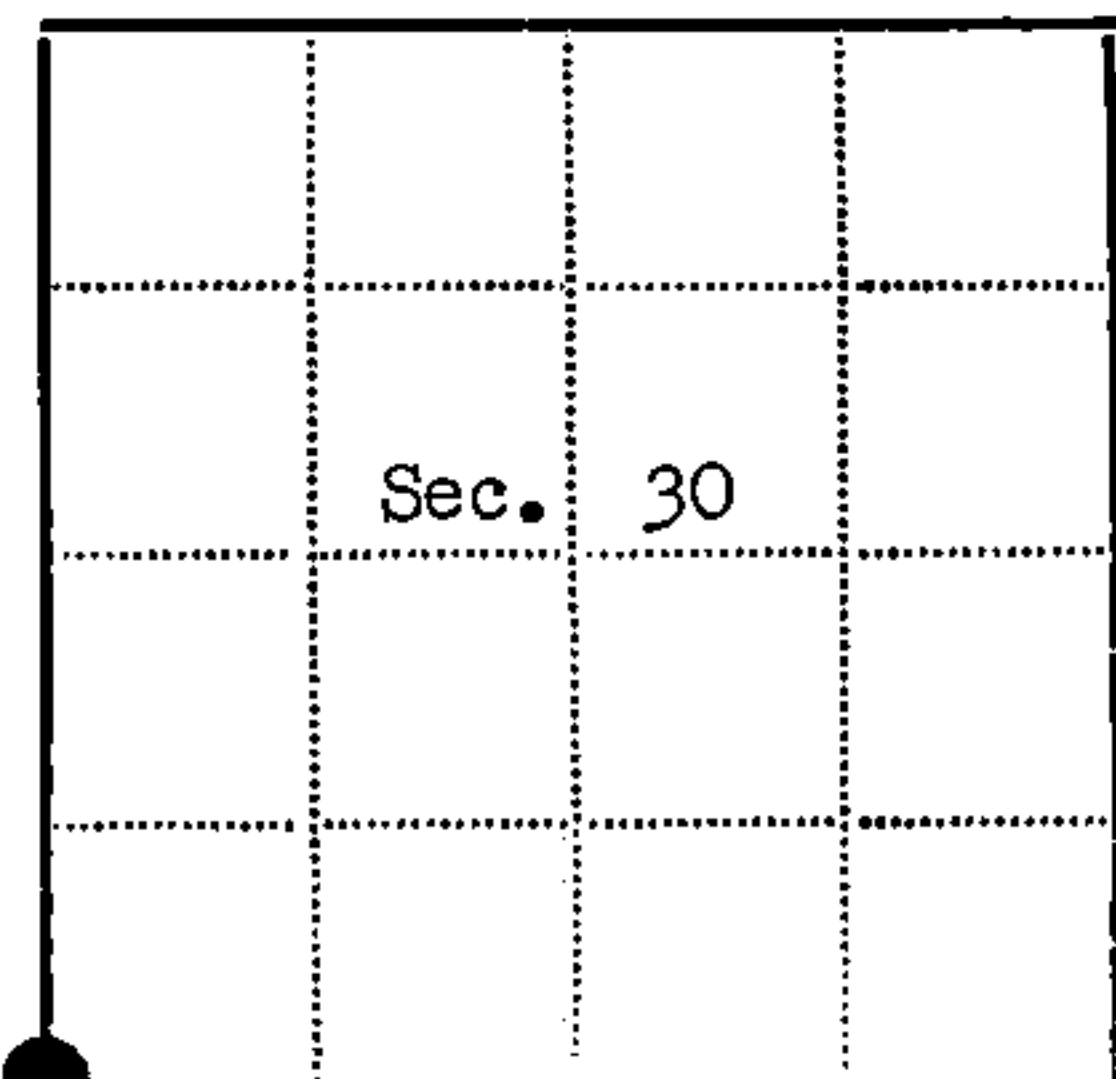
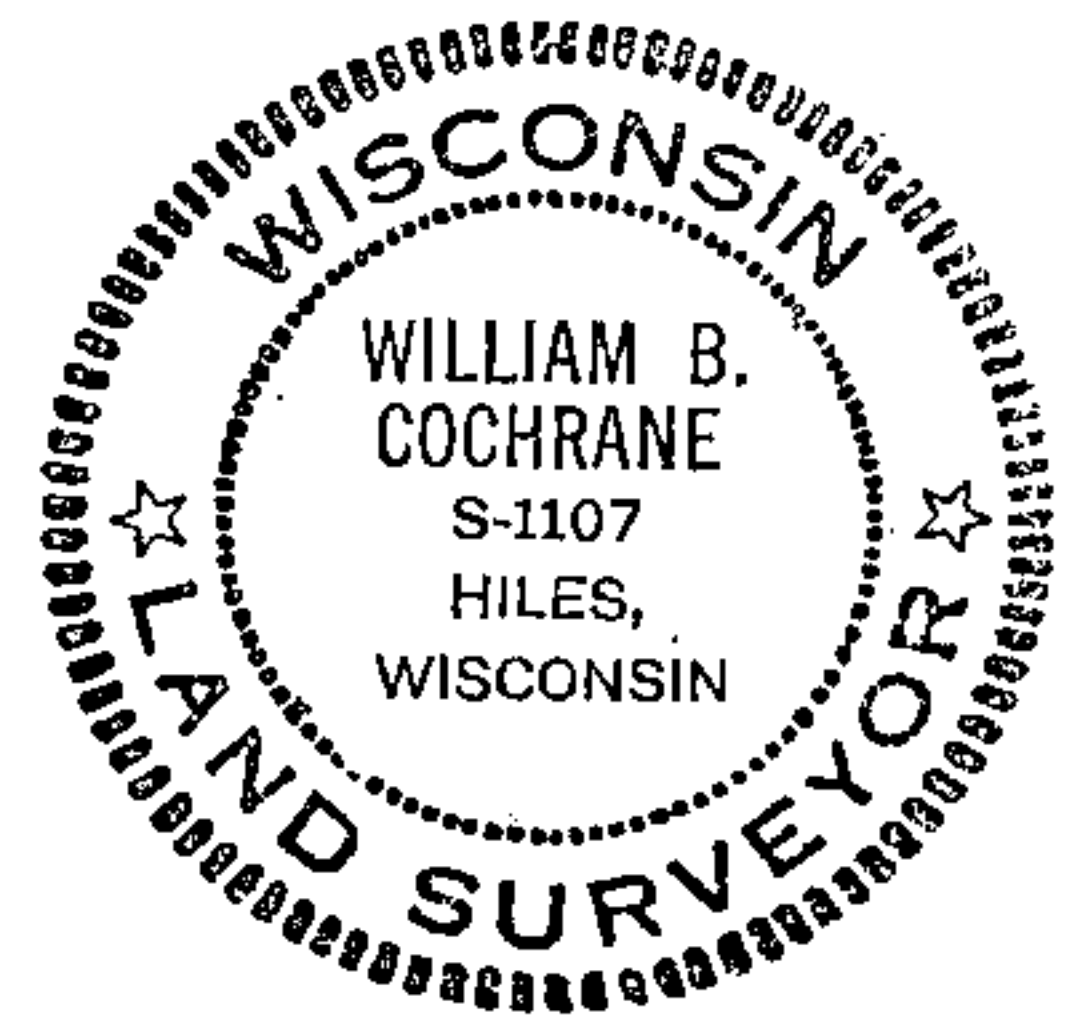

● - Corner monument restored
□ -

Resident witnesses.....

Dated at Laona Wisconsin, this 28th day of May 19 80.

Signature William B. Cochrane Title Land Surveyor
(County Surveyor, Registered Land Surveyor, or other duly authorized official)

Surveyors Registration No. S-1107 DOCUMENT 118067 No.

Office of Register of Deeds County of Forest

I hereby certify that the within instrument was filed in this office for record on the 9th day of June 19 80, and was filed in Book No. of County Records.

Signature Sharon Mueller Title Deputy

Township 35 North, Range 16 East, Section 30, Index No. V-1, Page No.

43515250000