

U. S. PUBLIC LAND SURVEY MONUMENT RECORD

INDEX NO. C-13

QUARTER Corner to Section 4 T35N, R16E
(Section/Quarter)

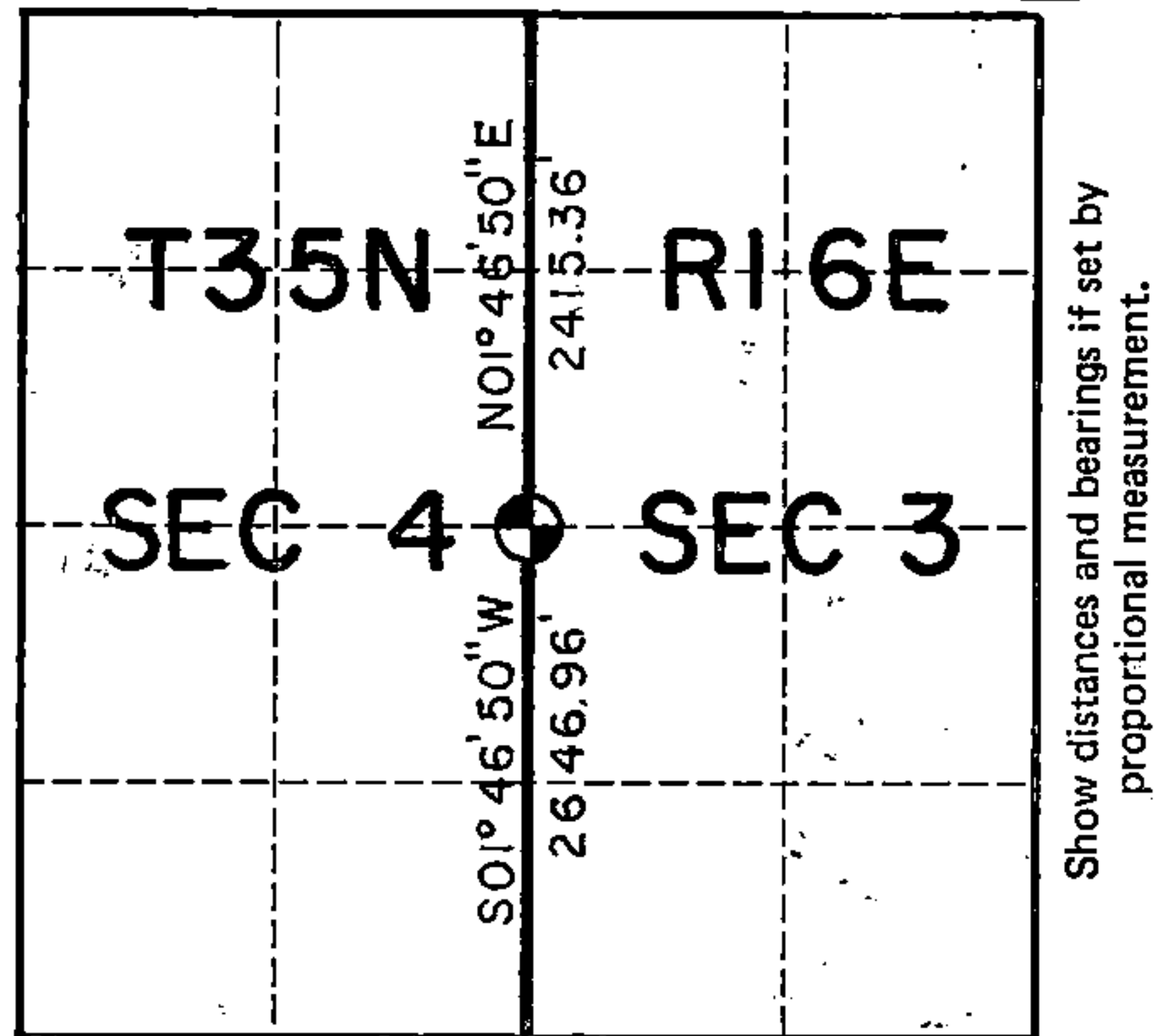

○ = Corner monument restored.



Set a 2"x 36" aluminum monument at corner position with stamped cap. Ties are to aluminum nails driven into the tree centers which trees were blazed and scribed. Bearings are magnetic.

1-2 =	N86°E	95.22'
1-3 =	S53°E	60.30'
1-4 =	S55°W	82.68'
1-5 =	N27°E	44.90'
1-6 =	West	0.70'
1-7 =	North	0.60'

● = Set 2"x36" aluminum monument

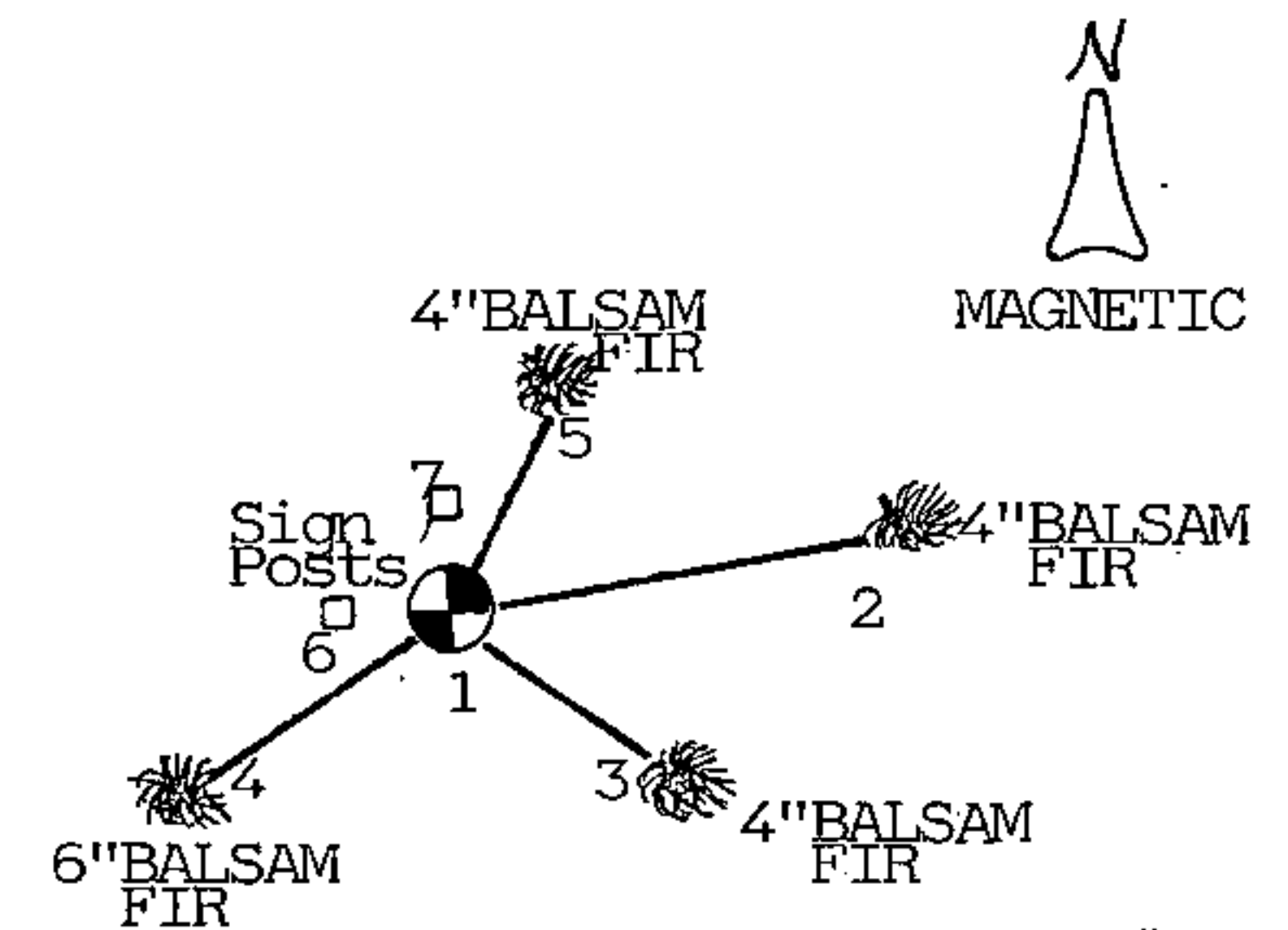

History of original corner establishment, record evidence, monument evidence, occupational evidence, testimonial evidence or any other material evidence, and what you found and how the monument was set.

In 1858 James McBride, set this corner position at 40 chains from the south and marked the following bearing trees:

Sugar	14"	S81W	13
Hemlock	18"	N20E	6

A stream call was noted on the south corrected line at 23.50 chains with the corner set at 36.50 chains.

CCC tags were located facing iron rails at the Centerwest and center quarter corners of section 4 falling approximately 70 ft and 30 ft north of the corners computed for single proportionate measure of the quarter corners. I pushed these points of occupation both westward and eastward in search areas for the quarter corners which would place the east quarter corner south roughly 100 to 140 ft. This corner position fell in a heavily logged area in Popple slashing and no evidence was found. The stream call to the north fit within a chain, however. I set this corner by lost methods of single proportionate measure.

In the plan view drawing below, provide reference ties to at least 4 witness monuments, or, if the location is within a municipality, to at least 2 witness monuments. (Witness monuments shall be made of concrete, natural stone, iron or other equally durable material, except wood other than bearing trees.) Also, show any material discrepancies between the corner restored or re-established and the location of any other previous corner location or occupation.

I, Kim H Pritzlaff, RLS No. 1259

(Type or print name) certify that the corner location shown on this record was determined by me or under my direction and control and that this U.S. Public Land Survey Monument Record is correct and complete to the best of my knowledge and belief.

Kim Pritzlaff

Signature

1993

Date

Plat Ready For Filing:

Ralph McCall
District Ranger

Acbing

149050

43516084 2000

INDEX NO. _____

MAINTENANCE RECORD

Condition of Monument _____

Condition of Ties _____

New Ties, if any:

Date

Signature

Condition of Monument _____

Condition of Ties _____

New Ties, if any:

Date

Signature

Condition of Monument _____

Condition of Ties _____

New Ties, if any:

Date

Signature

REGISTER'S OFFICE
FOREST COUNTY, WIS.

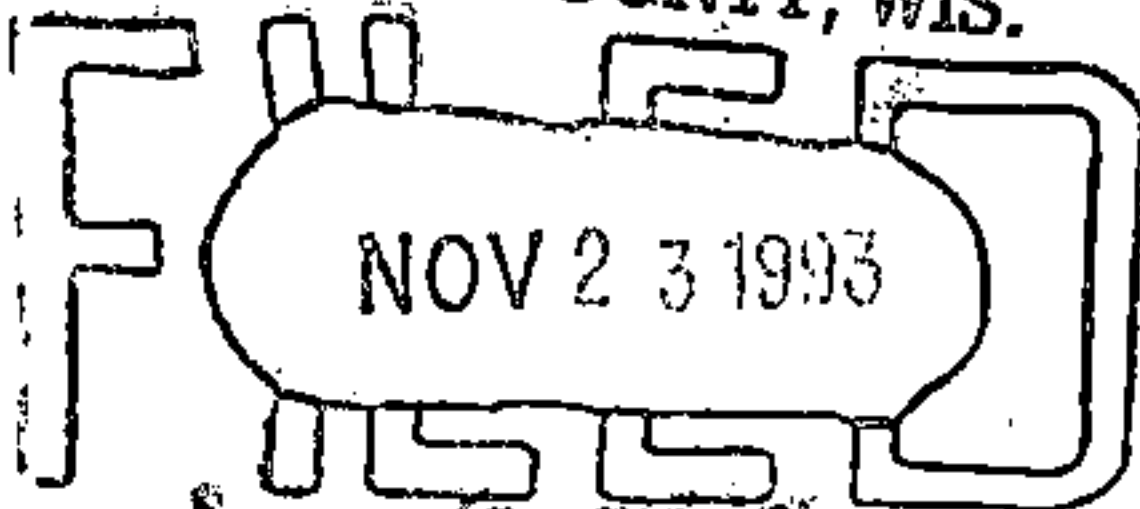

9 O'clock A.M.
Paul A. Anderson
Register of Deeds