

U. S. PUBLIC LAND SURVEY MONUMENT RECORD

INDEX NO. C-9

1/4 Corner to Section 4 T35N, R16E
(Section/Quarter)

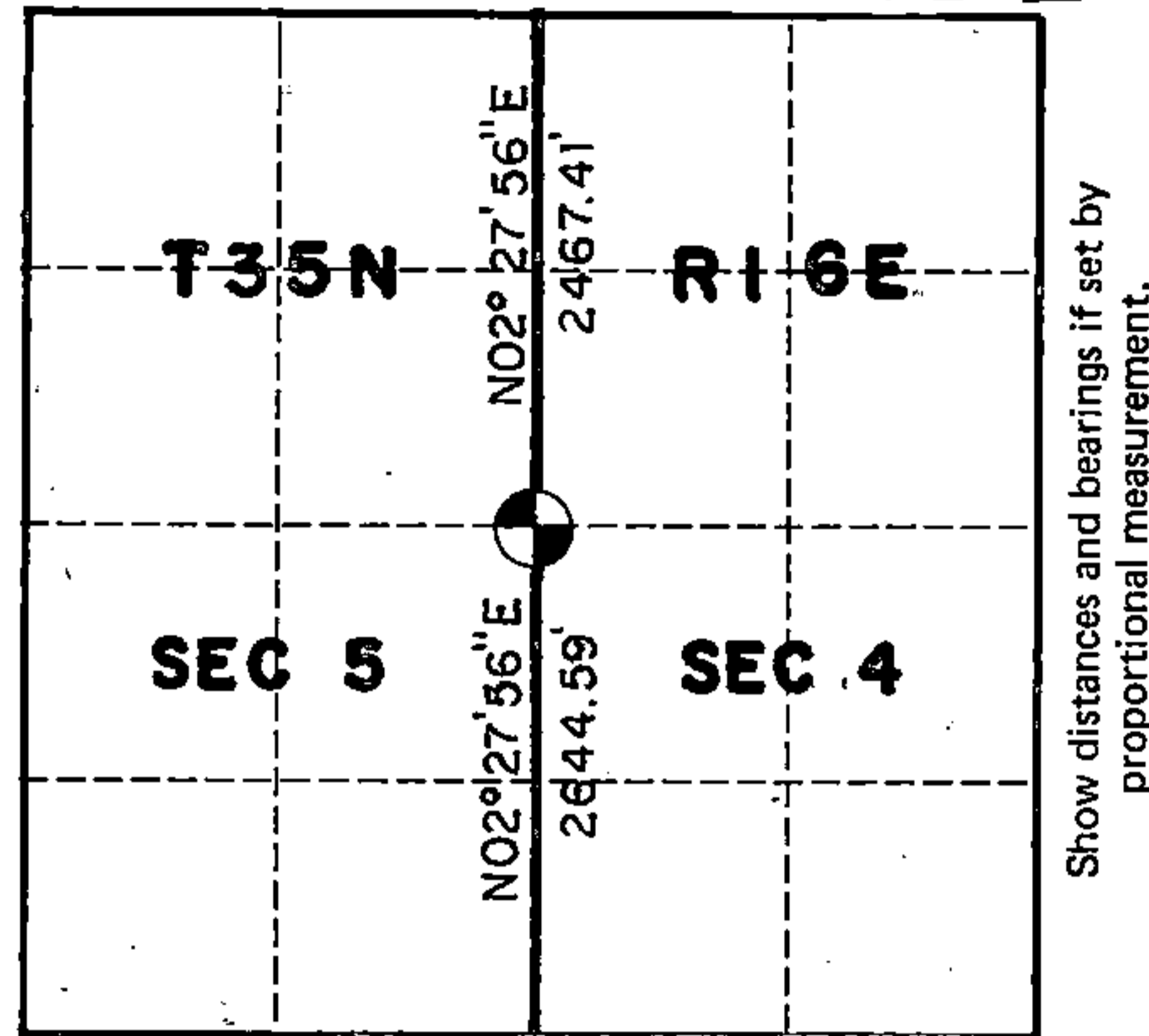

○ = Corner monument restored.



Kim H Pritzlaff, RLS No. 1259

(Type or print name) certify that the corner location shown on this record was determined by me or under my direction and control and that this U.S. Public Land Survey Monument Record is correct and complete to the best of my knowledge and belief.

Kim Pritzlaff

Signature

1093

Date

History of original corner establishment, record evidence, monument evidence, occupational evidence, testimonial evidence or any other material evidence, and what you found and how the monument was set.

In 1858 James McBride set a wood post at this corner location at 40 chains and marked the following bearing trees:

Hemlock	14"	East	25
Birch	6"	N78W	21

Corner search area was set at single proportionate position and Hemlock stumps of 30" or better were found but no post evidence or blazes in the area. A CCC tag was found on a tree facing an iron rail at the centerwest and center quarter corners of this section. The centerwest corner occupation was roughly 70 ft. north and the center quarter corner occupation was roughly 30 ft north. This occupation evidence was pushed westward to the west line falling between 100 ft and 140 ft. north of the single proportionate search area. Nothing was found. I did not have any survey record of the two CCC tags mentioned and thus determined the corner position lost, setting it at single proportionate position. The measured distance along the east west section lines fit too close to record to accept the errors the CCC tags witnessed. In the plan view drawing below, provide reference ties to at least 4 witness monuments, or, if the location is within a municipality, to at least 2 witness monuments. (Witness monuments shall be made of concrete, natural stone, iron or other equally durable material, except wood other than bearing trees.) Also, show any material discrepancies between the corner restored or re-established and the location of any other previous corner location or occupation.

Set a 2"x 60" aluminum post with stamped cap at corner. Ties are to aluminum nails driven into the tree centers which trees were scribed and blazed. Bearings are magnetic.

1-2 =	S63°E	29.90'
1-3 =	S02°E	18.98'
1-4 =	S87°W	5.25'
1-5 =	N46°E	45.08'
1-6 =	North	0.50'

⊙ = Set 2"x60" Aluminum monument

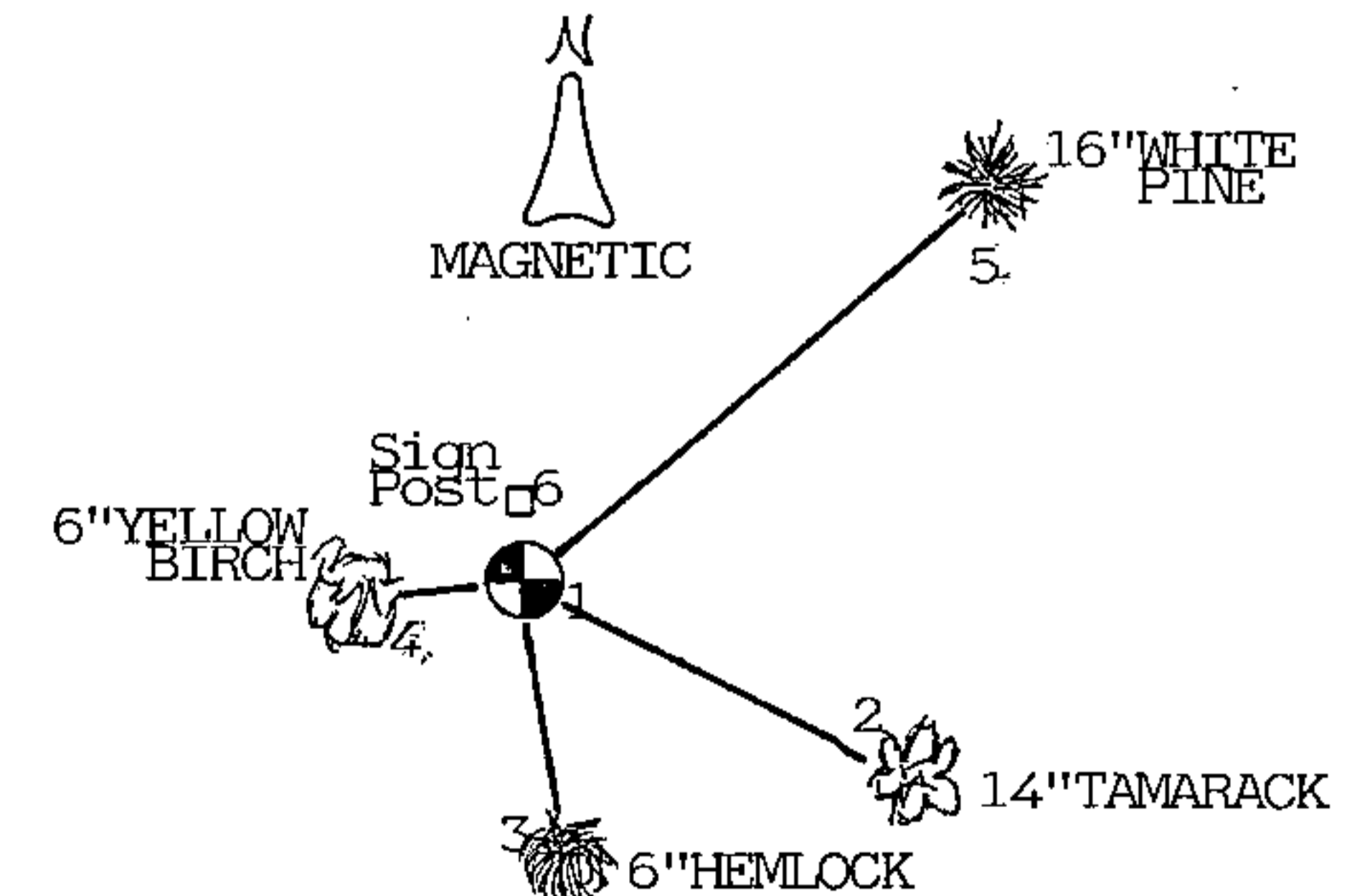

Plat Ready For Filing:

Ralph Hall
Acting District Ranger

4351605 200607

INDEX NO. _____

MAINTENANCE RECORD

Condition of Monument _____

Condition of Ties _____

New Ties, if any:

Date

Signature

Condition of Monument _____

Condition of Ties _____

New Ties, if any:

Date

Signature

Condition of Monument _____

Condition of Ties _____

New Ties, if any:

Date

Signature

REGISTER'S OFFICE
FOREST COUNTY, WIS.

NOV 23 1990

9 O'clock M.

Paul A. [Signature]
Register of Deeds