

CERTIFIED LAND CORNER RESTORATION

Index No. **U-9**

State of Wisconsin }
County of Forest } ss.

I Philip T. Hansen, do hereby
certify that on the 16th day
of June, 1976, I found
evidence of the S 1/16
corner of 28-29
Township 36, North, Range
12, Fourth Principal Meridian,
as described hereon; and that from this evidence
I established a new monument and accessories
as described hereon to perpetuate the original
location of this corner.

Resident witnesses:

Glen Barker

Jim Claflin

Herb Wagoner

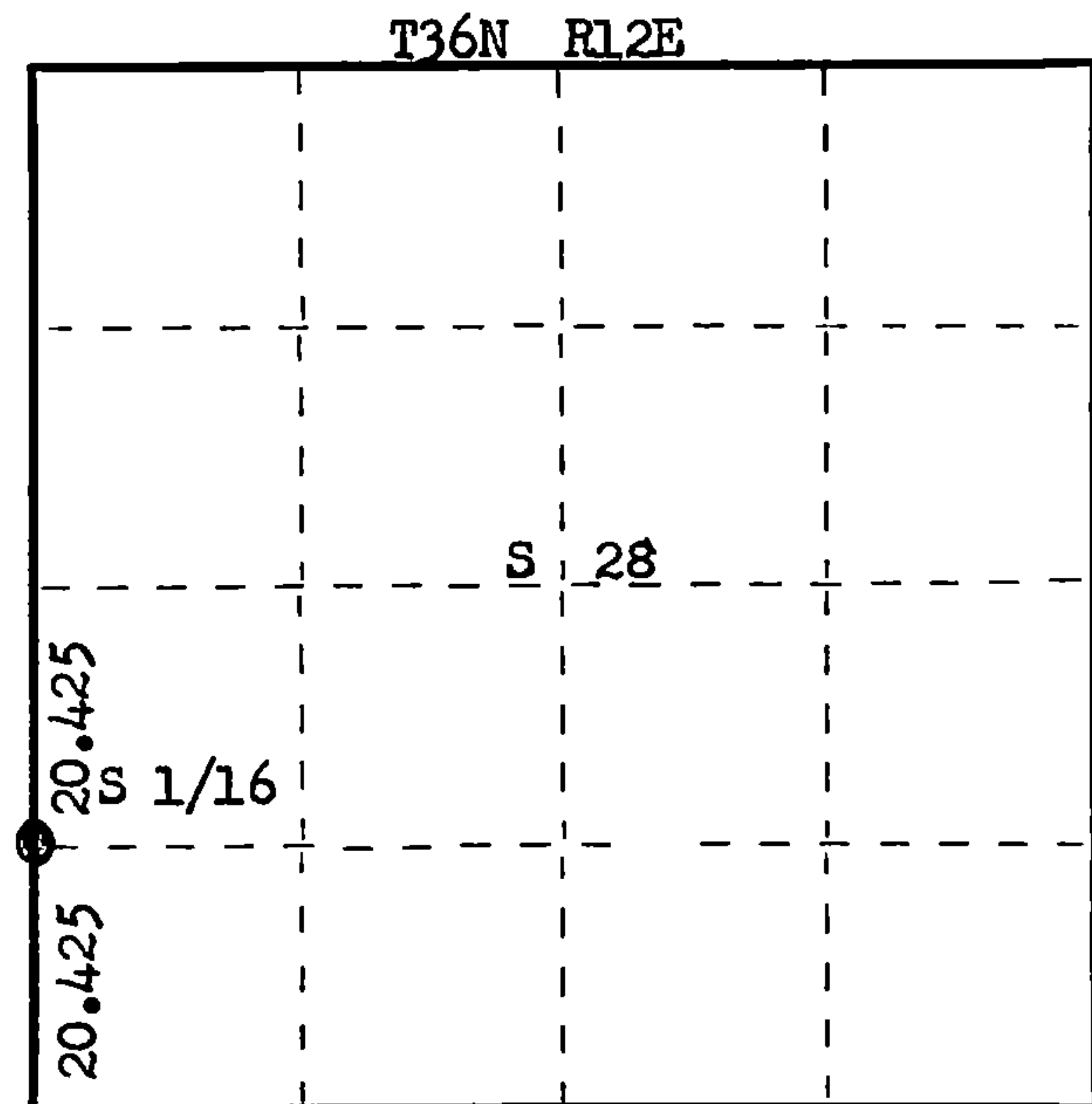

○ = Corner monument restored.

History of original corner establishment:

No record or evidence of any previous survey to establish this corner.

Description of corner evidence found: Corner set by proportional measurement between 1/4, Sec. 28-29, yellow post, set by Wisconsin Highway Department and Section Corner 28, 29, 32, 33. Ran traverse N 0° 45' E to point 11 lks East of 1/4 corner, measured at 90°. Total distance computed 40.85 chains. Set S 1/16 corner 5.5. lks. West at 20.425 chains. Corrected bearing of line N 0° 30' 56" E.

Description of monument and accessories I established to perpetuate the original location of this corner.

Set a 1" x 18" iron pipe at the west edge of Tower Road for Corner 4" below road surface.
Set a 1 1/2" iron pipe with 2" brass cap 60 lks. East for Witness Corner. Cap stamped.
NBTs - Sugar 8" S 57° W 64.4 lks, scribed 1/16 BT.
Sugar 8" N 69° E 87.3 lks, scribed 1/16 BT.
Measurements and bearings to true corner.
Monument and BTs painted blue.

S498
T36N R12E
S 1/16 S29/S28 W.C.
W-60 lks
CPI - 1976

Dated at Rhineland, Wis., this 22nd day of June, 1976

Signature _____ Title Registered Land Surveyor Registration No. S-498
(County Surveyor, Registered Land Surveyor, or other duly authorized official)

Office of Register of Deeds, County of Forest, I hereby certify that the within
instrument was filed in this office for record on the 28th day of June, 1976
at 3:45 o'clock P. M.

Eugene Staszny
(Register of Deeds)
By _____ Deputy

DOCUMENT NUMBER ---- **109540**

FORM 985

43612291000