

# CERTIFIED LAND CORNER RESTORATION

Index No. 11-19

**W19**

State of Wisconsin }  
County of Forest } ss.

I Glen Barker, do hereby  
certify that on the 18th day  
of August, 1982, I ~~found~~ found est.  
evidence of the NC 1/16  
corner of Section 35  
Township 36, North, Range  
12 East, Fourth Principal Meridian,  
as described hereon; and that from this evidence  
I established a new monument and accessories  
as described hereon to perpetuate the original  
location of this corner.

Resident witnesses:

J. Claflin - RLS

H. Wagoner

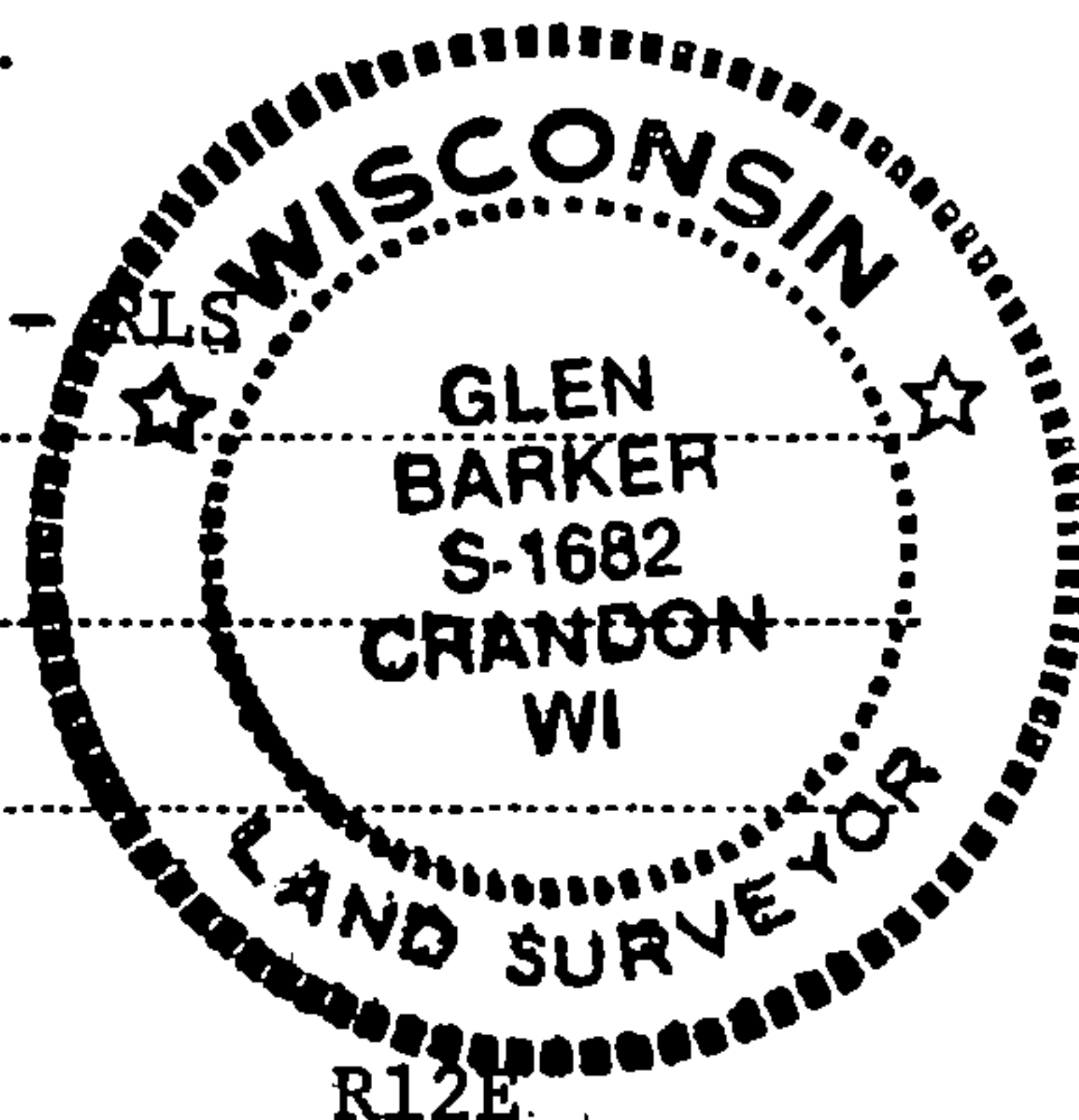

T36N

R12E

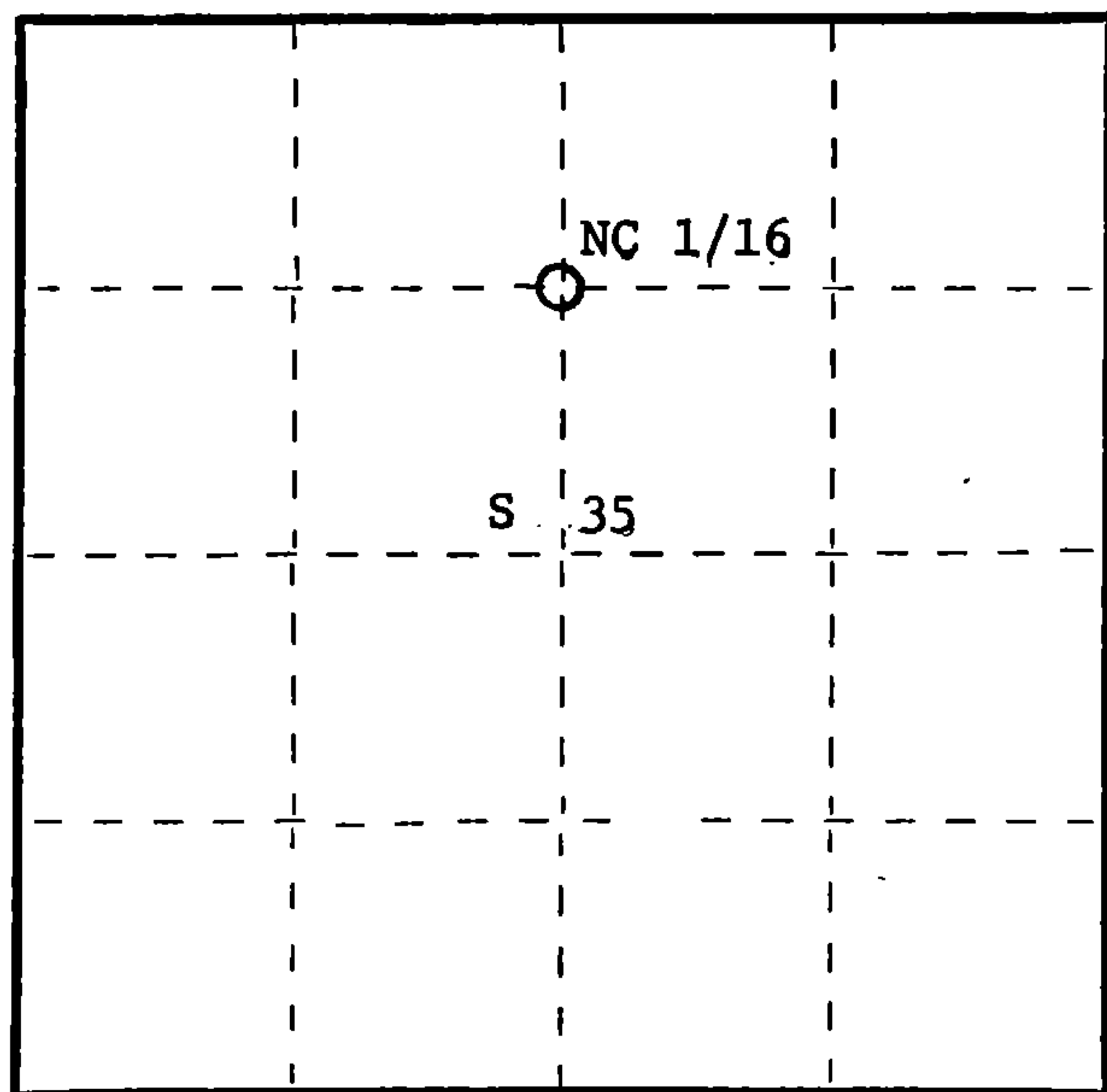

○ = Corner monument restored.

History of original corner establishment:

No evidence of any previous corner.

Description of corner evidence found:

Total distance from 1/4 corner between sections 26 & 35 to C 1/4 section 35 is  
3029.32 ft. at bearing S2-15-42W. Set NC 1/16 1514.66 ft. intermediate.

Description of monument and accessories I established to perpetuate the original location of this corner.

Set a 1" iron pipe with 2" alloy cap stamped:

S1682

Monument projects 10" above ground.

T36N R12E

Marked NBTs:

Sugar 6" N44E 12.70 ft.

S 35

Sugar 5" S56E 26.28 ft.

Scribed 1/16 - BT

CPI - 1982

Dated at Rhineland, Wis., this 28th day of October, 1982.

Signature Glen Barker Title Registered Land Surveyor Registration No. S1682  
(County Surveyor, Registered Land Surveyor, or other duly authorized official)

Office of Register of Deeds, County of Forest, I hereby certify that the within  
instrument was filed in this office for record on the 16th day of February, 1983  
at 10:30 o'clock A. M.

Eugene Stetson  
(Register of Deeds)

DOCUMENT NO. **122920**

By \_\_\_\_\_ Deputy