

DOCUMENT NUMBER
137126

FORM 985 H. C. MILLER CO., MILWAUKEE

State of Wisconsin }
County of Forest } ss.

I, Glen Barker, do hereby
certify that on the 22nd day
of December, 1988, I found
evidence of the 1/4
corner of Section 5 & 6
Township 36, North, Range
14 East, Fourth Principal Meridian,
as described hereon; and that from this evidence
I established a new monument and accessories
as described hereon to perpetuate the original
location of this corner.

Resident witnesses:

N. Spiess

D. Broadbridge

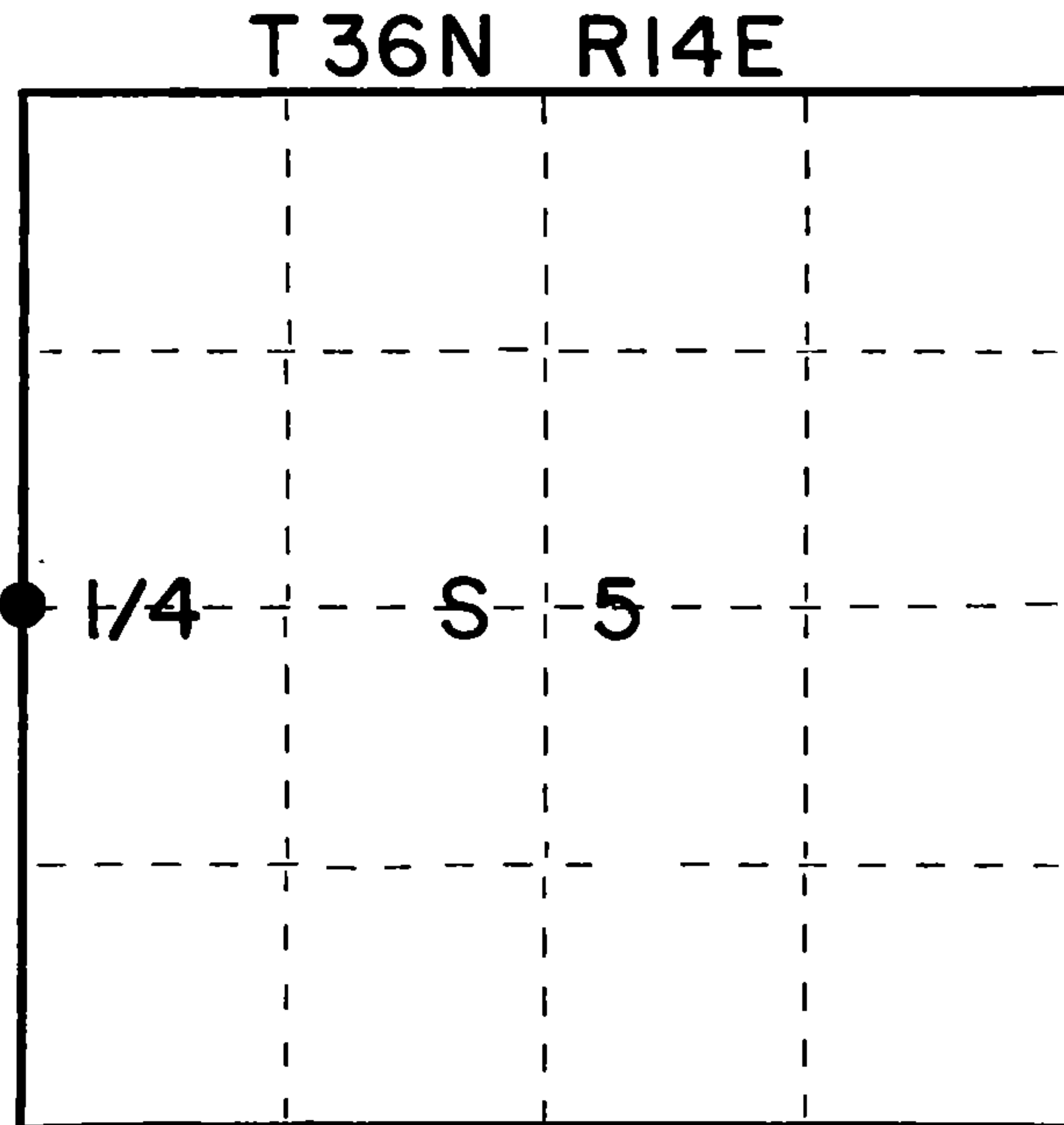

○ = Corner monument restored.

CERTIFIED LAND CORNER RESTORATION
U.S. Public Land Survey Monument Record

Index No. C-5

History of original corner establishment:

Original Corner established by James McBride deputy surveyor in 1859 from which
Birch 6" bears S36E 61 Lks and Birch 7" N51W 8 Lks

Description of corner evidence found:

No evidence of original or other. Set 1/4 on proportionate method total distance
from Section 5-6-31-32 T36 & 37N R14E to Section Corner 5-6-7-8 is 5335.65'.
Set 1/4 corner proportional to original distance 5385.60'.

Description of monument and accessories I established to perpetuate the original location of this corner.
Set a 2 1/4" Forest County aluminum monument with 3/4" alloy cap stamped. Monument
projects 5" above ground.

Marked NBT:

Maple 10"	S76E	34.34'
Maple 8"	S49W	12.38'
Maple 6"	N6W	9.94'
Sugar 6"	N44E	52.99'

	T36N	R14E
1/4	S6	S5
	S-1682	1988

Dated at Rhinelander, Wis., this 14th day of March, 1989

Signature Glen Barker Title Registered Land Surveyor Registration No. 1682
(County Surveyor, Registered Land Surveyor, or other duly authorized official)

Office of Register of Deeds, County of Forest, I hereby certify that the within
instrument was filed in this office for record on the 31st day of March, 1989
at 10:25 o'clock A. M.

Paul Aschenbrenner
(Register of Deeds)

By Deputy

43614062000

1) Describe any material discrepancy between the location of the corner as restored or reestablished and the location of that corner as previously restored or reestablished by distance and direction. Show the discrepancy on the plan view drawing under (d), above. Show the distances between the corner as previously restored or reestablished and (1) the corner as restored or reestablished, and (2) to at least 2 of the witness monuments shown on the drawing in (d), above.

(f) Was the corner restored through acceptance of (1) an obliterated evidence location, or, (2) a found perpetuated location?

(g&h) Was the corner reestablished through lost corner proportionate methods? If so, show the method, including the directions and distances to other public land survey corners used as evidence or used for proportioning in determining the corner location?

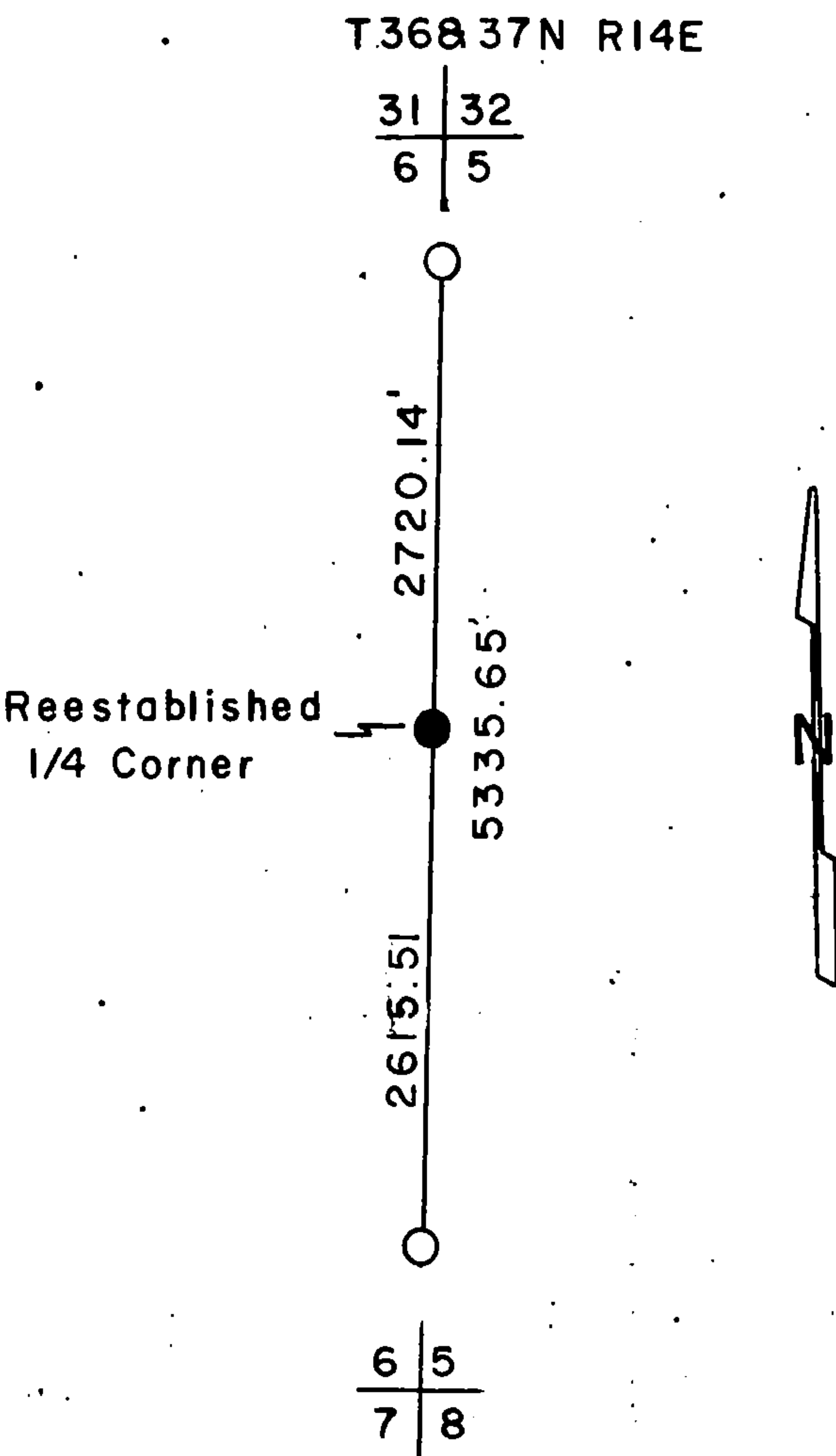

(i) I, Glen Barker
(type or print name) certify that the corner location shown on this record was determined by me or under my direction and control and that this U.S. Public Land Survey Monument Record is correct and complete to the best of my knowledge and belief.

Signature

Date

Affix Land Surveyor Seal

