

CERTIFIED LAND CORNER RESTORATION

State of Wisconsin }  
County of Forest } ss.

I William B. Cochrane, do hereby certify that on the 12th day of May, 19 80, I found evidence of the Northeast Section corner of Section 21 Township 36 North, Range 15 East, Fourth Principal Meridian, as described hereon; and that from this evidence I established a new monument and accessories as described hereon to perpetuate the original location of this corner:

Description of original monument and accessories and subsequent restorations:

Surveyed in 1859 by James McBride.  
North between Sections 21 and 22, 80.00 chains set post corner to sections 15, 16, 21 and 22.  
Sugar, 18 inches, N4W, 21 links  
Sugar, 12 inches, N33E, 41 links  
Birch, 10 inches, S54E, 51 links  
Elm, 24 inches, S74W, 52 links.

Description of corner evidence found:

Old scribed post and a 2 inch iron pipe in a mound of stones.  
S74W, 52 links, a very large, rotted elm stump.  
Other bearing trees fall in old R/R grade.

Description of monument and accessories I established to perpetuate the location of this corner:

I replaced the iron pipe with a 2½ inch diameter aluminum pipe,  
3 feet long with an aluminum cap stamped:  
T36N, R15E, S15, S16, S21, S22, 1980, S-1107

Blazed and scribed the following new bearing trees:

Maple, 6 inches, N83E, 6.63 feet  
White Birch, 7 inches, S42E, 14.66 feet  
Basswood, 7 inches, S22W, 10.33 feet  
White Birch, 7 inches, S82W, 18.42 feet.

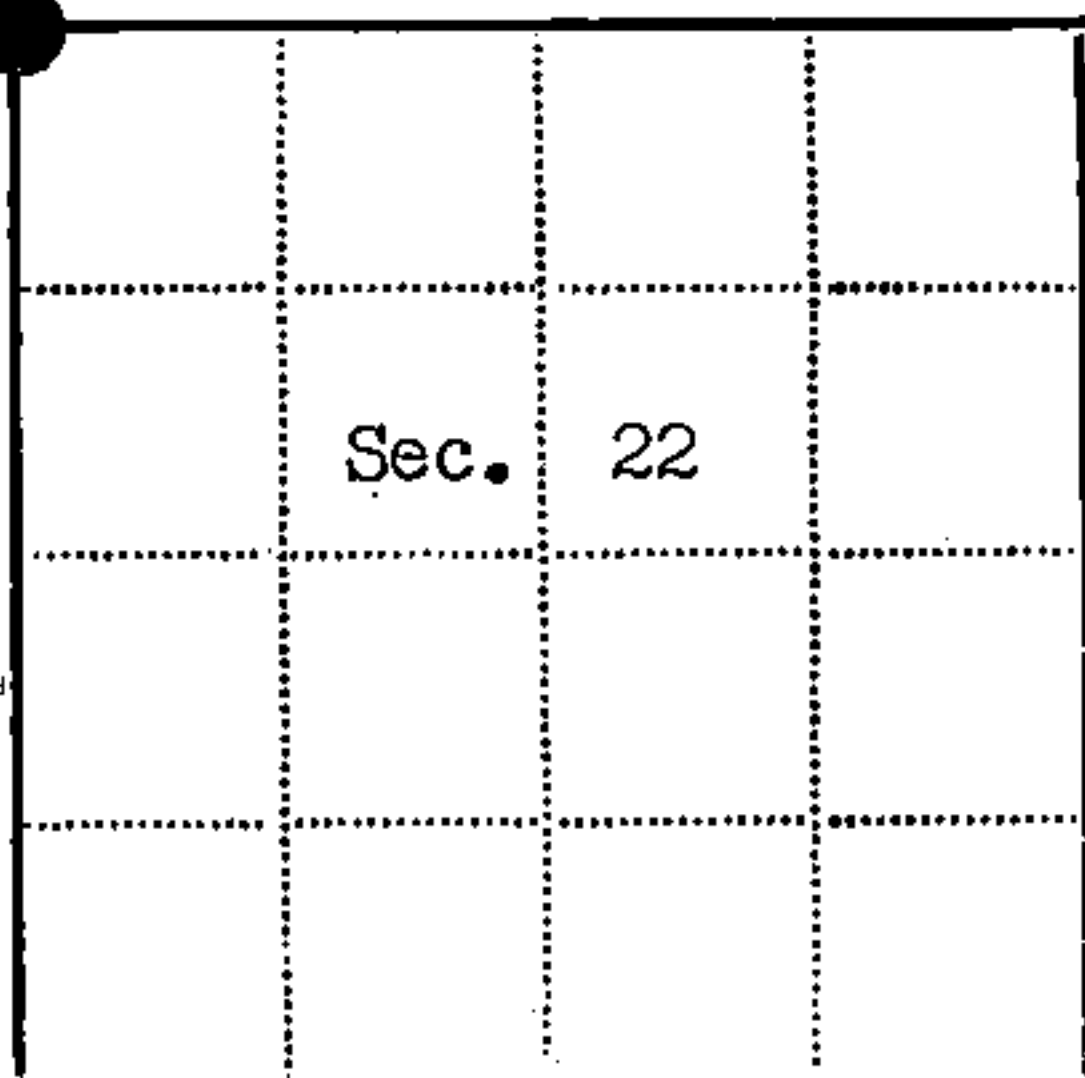
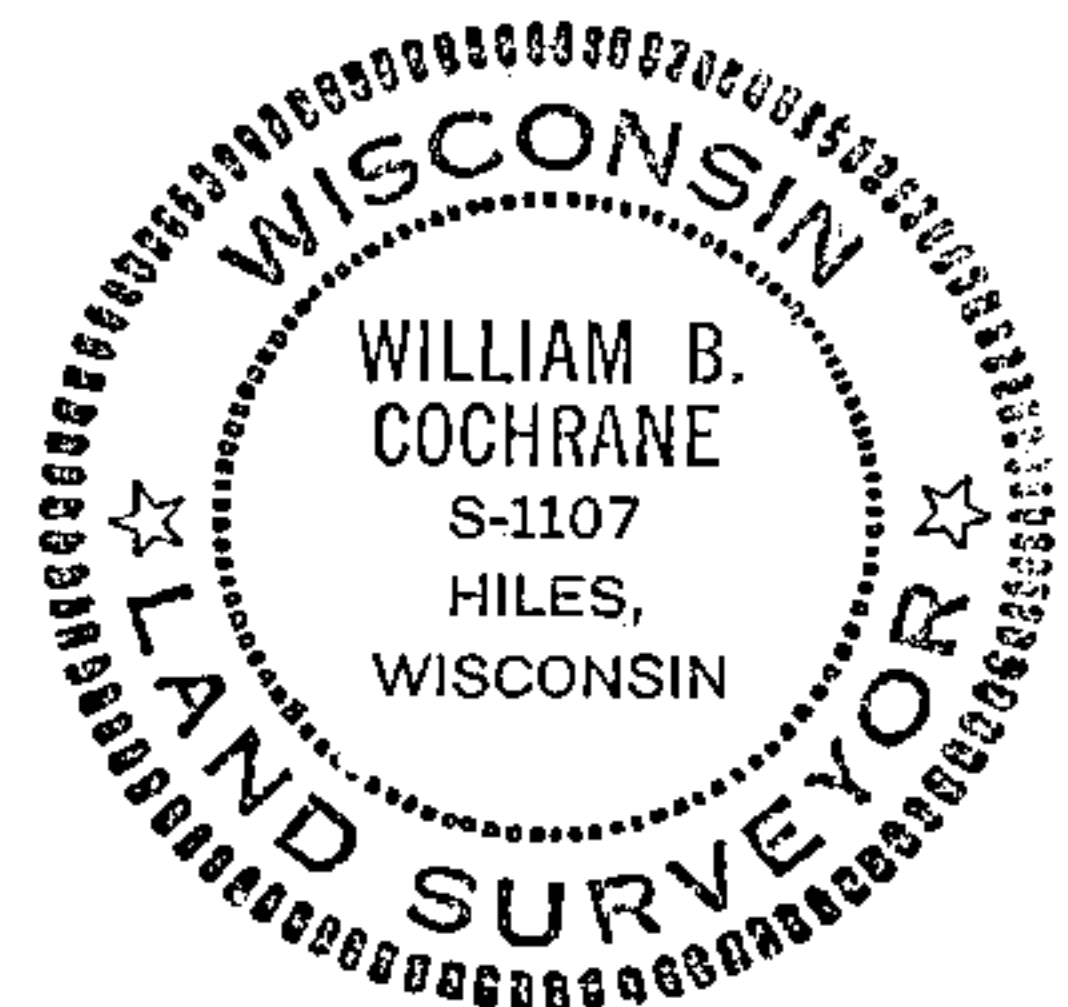

● - Corner monument restored  
□ -

Resident witnesses.....

Dated at Laona Wisconsin, this 28th day of May 19 80.

Signature William B. Cochrane Title Land Surveyor  
(County Surveyor, Registered Land Surveyor, or other duly authorized official)

Surveyors Registration No. S-1107 DOCUMENT 118073 NO.

Office of Register of Deeds County of Forest

I hereby certify that the within instrument was filed in this office for record on the 9th day of June 19 80, and was filed in Book No. Page No. of County Records.

Signature Sharon Mueller Title Deputy

Township 36 North, Range 15 East, Section 22, Index No. N-13, Page No.