

CERTIFIED LAND CORNER RESTORATION

State of Wisconsin

County of Forest

ss.

I William B. Cochrane, do hereby certify that on the 5th day of May, 1980, I found evidence of the Southwest Section corner of Section 35 Township 36 North, Range 15 East, Fourth Principal Meridian, as described hereon; and that from this evidence I established a new monument and accessories as described hereon to perpetuate the original location of this corner:

Description of original monument and accessories and subsequent restorations:

Surveyed in 1857 by Artemas Curtis.
West between Sections 2 and 35, 80.00 chains set post for corner of Sections 2, 3, 34 and 35.
Sugar, 16 inches, N12W, 57 links
Hemlock, 20 inches, N68E, 89 links
Sugar, 10 inches, S26E, 66 links
Sugar, 14 inches, S81W, 31 links.

Description of corner evidence found:

2 inch iron pipe, 2.5 feet above ground in a mound of stone.
N12W, 57 links, Sugar stump hole,
N68E, 89 links, Bearing tree would be in old road
S26E, 66 links, Bearing tree would be in old road
S81W, 31 links, Sugar stump and fallen log.

Description of monument and accessories I established to perpetuate the location of this corner:

I replaced the iron pipe with a 2 inch inside diameter, galvanized iron pipe, 3 feet long, filled with concrete, with a brass cap stamped:
T36N, R15E, S34, S35, S2, S3, T35N, 1980, S-1107

Blazed and scribed the following new bearing trees:

Maple, 6 inches, N23E, 11.54 feet
Maple, 8 inches, S8E, 6.89 feet
Y. Birch, 10 inches, S58W, 13.28 feet
Basswood, 14 inches, N22W, 30.38 feet.

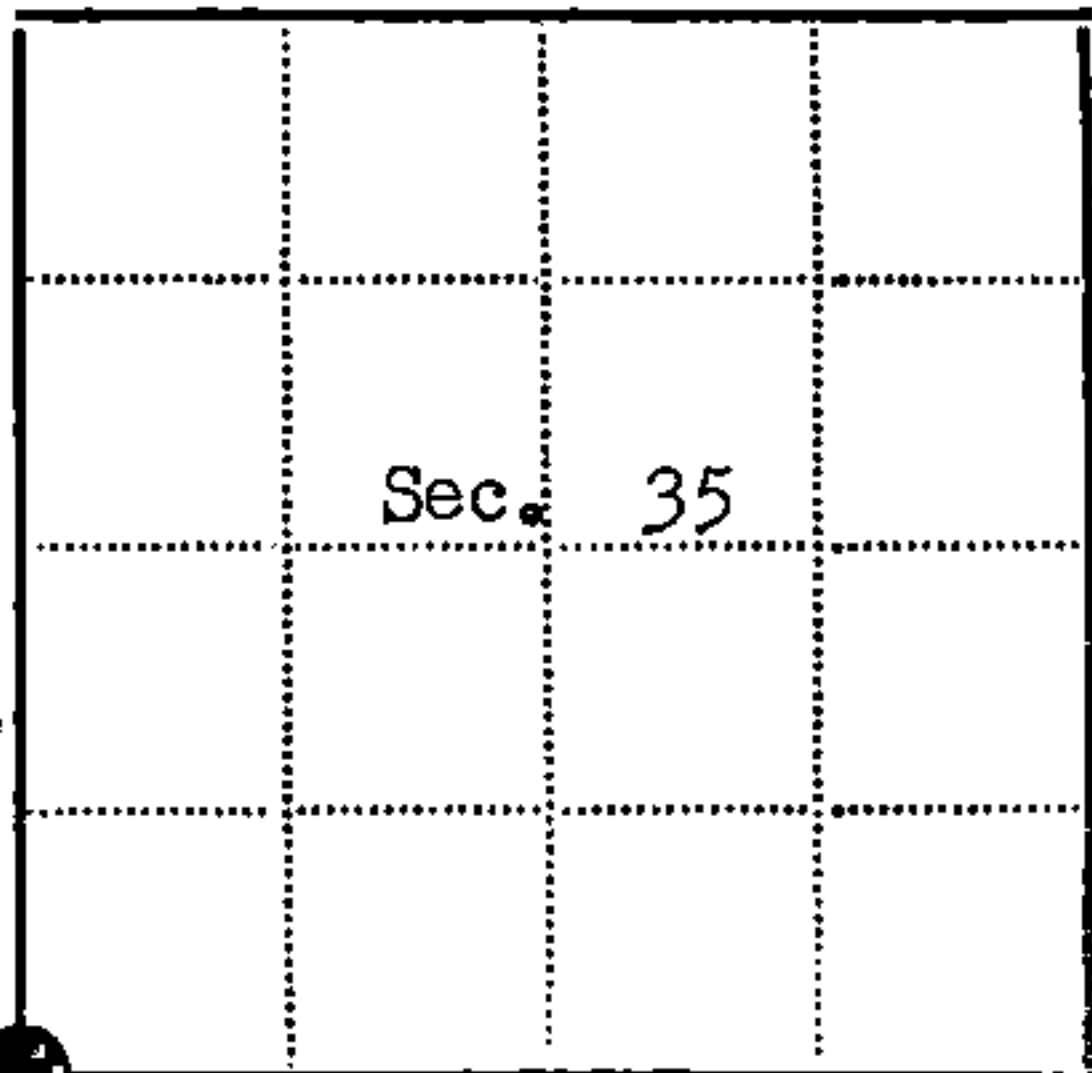
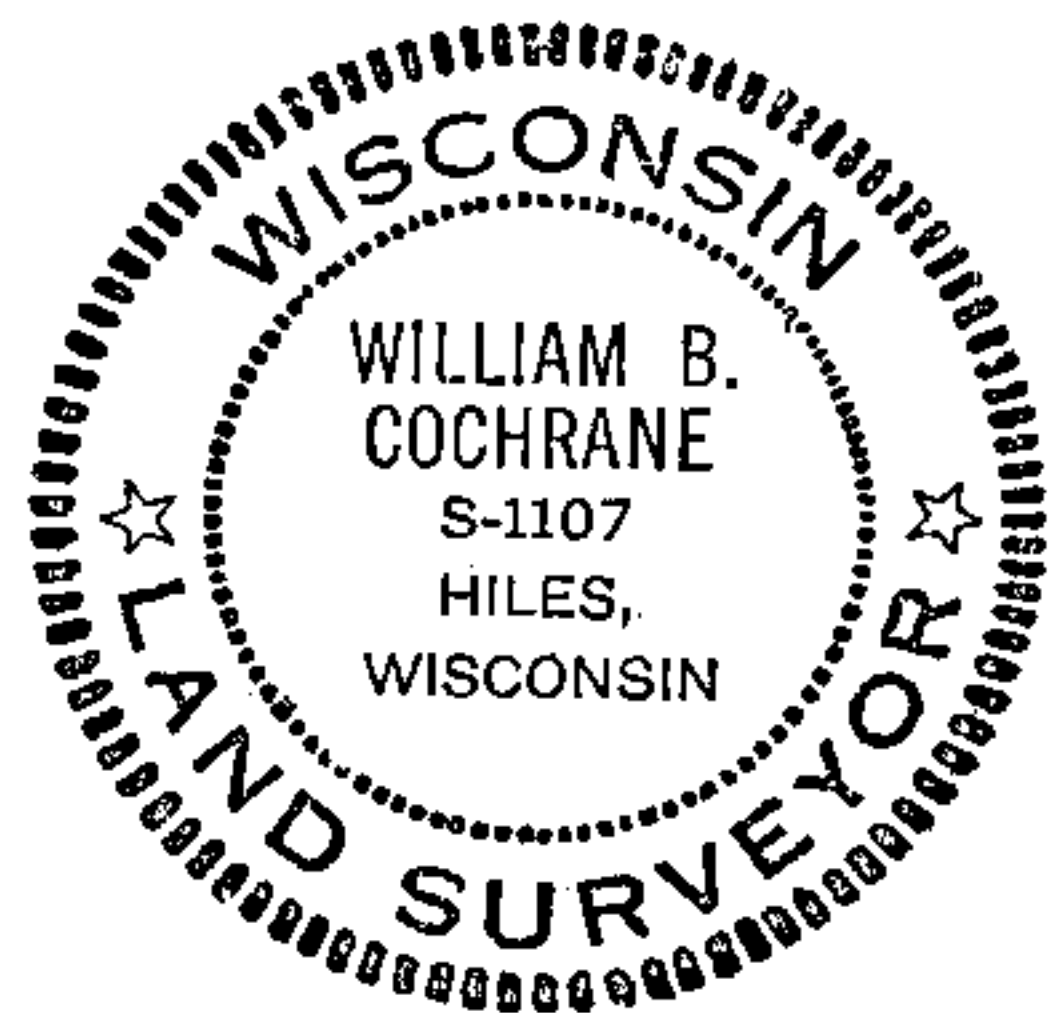

● - Corner monument restored
□ -

Resident witnesses

Dated at Laona Wisconsin, this 29th day of May 1980.

Signature William B. Cochrane Title Land Surveyor
(County Surveyor, Registered Land Surveyor, or other duly authorized official)

Surveyors Registration No. S-1107 DOCUMENT NO. 118083

Office of Register of Deeds County of Forest

I hereby certify that the within instrument was filed in this office for record on the 9th day of June 1980, and was filed in Book No. of County Records.

Signature Sharon Mueller Title Deputy

Township 36 North, Range 15 East, Section 35, Index No. Z-17, Page No.

43015340000

217

U. S. PUBLIC LAND SURVEY MONUMENT RECORD

INSTRUCTIONS:

This record shall show the location of the corner and shall include all of the following nine elements (a through i).

- (a) Identify the corner by reference to the U.S. public land survey system.
 O = Corner monument restored.

Section Corner to Sections 34, 35;
 T.36N., R.15E. and Sections 2 and 3,
 T.35N., R.15E., Forest County, Wisconsin.

State Plane Coordinates
 Wisconsin North Zone
 142864.76089-N
 2328926.18239-E

Geographic Coordinates
 45-32-58.93445-N
 088-35-35.17227-W

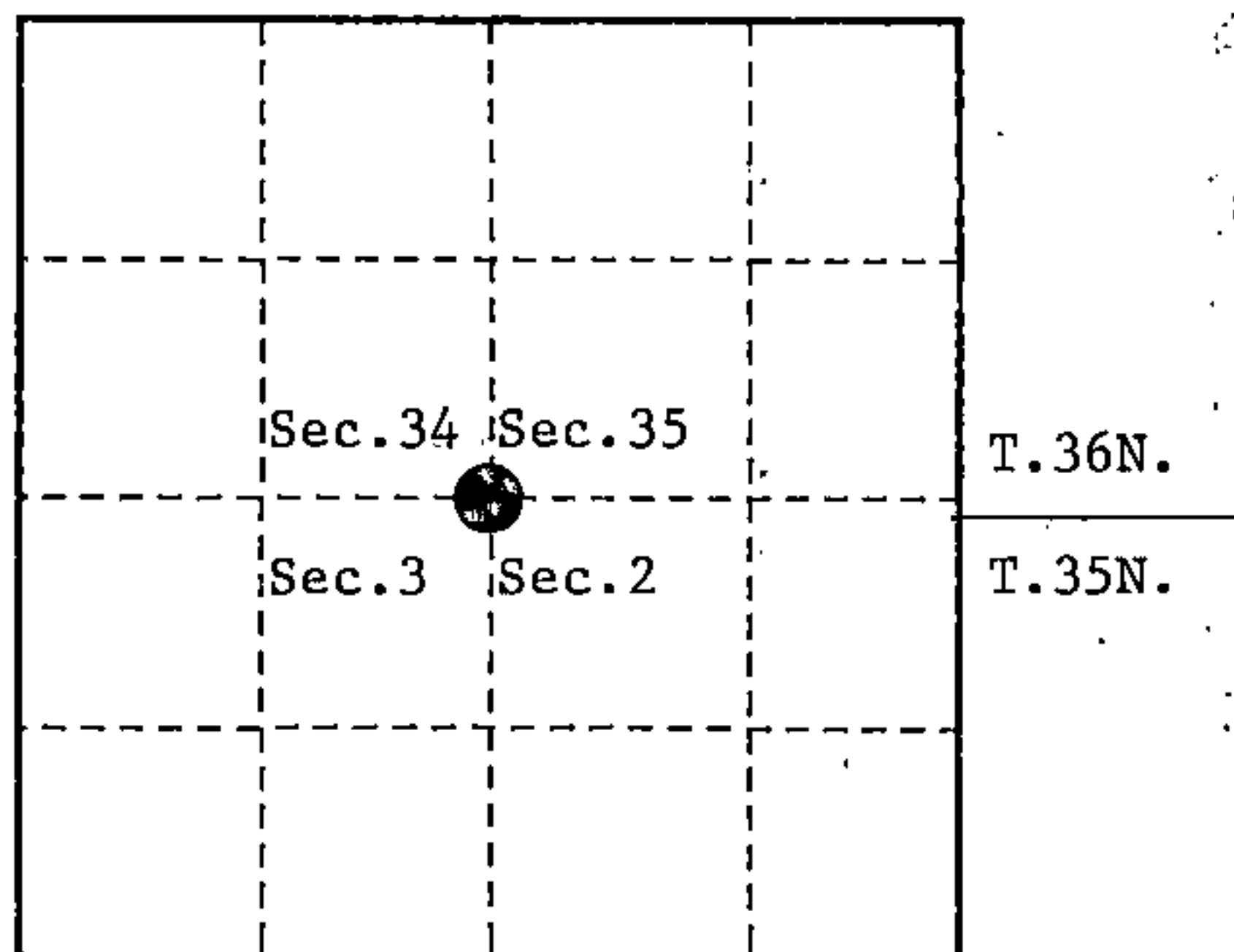

- (b) Describe any record evidence, monument evidence, occupational evidence, testimonial evidence or any other material evidence you considered, and whether the monument was found or placed.

Original survey in 1857 by Artemas Curtis. Set corner post and the following bearing trees; Sugar, 16", N.12°W., 57 links, Hemlock, 20", N.68°E., 89 links, Sugar, 10", S.26°E., 66 links, Sugar, 14", S.81°W., 31 links.

In 1980, William Cochrane, RLS, found a 2" diameter iron pipe and original bearing tree evidence. In place of pipe set a 2" x 36" galvanized iron pipe, with a brass cap stamped to identify corner. Made new bearing trees; Maple, 6", N.23°E., 11.54 feet, Maple, 8", S.08°E., 6.89 feet, Yellow Birch, 10", S.58°W., 13.28 feet, Basswood, 14", N.22°W., 30.38 feet.

On 11-16-93, Alan Harrison, RLS, found the monument and bearing trees as described above. Cut down all bearing trees for G.P.S. observations. Made the following new bearing trees; Maple, 11", N.25°E., 38.59 feet, Maple, 11", S.55°E., 52.48 feet, Maple, 6", S.42°W., 28.95 feet, Maple, 6", N.50°W., 49.12 feet, Steel Sign Post, 0.50 feet.

- (c) In the plan view drawing below, provide reference ties to at least 4 witness monuments, or, if the location is within a municipality, to at least 2 witness monuments. (witness monuments shall be made of concrete, natural stone, iron or other equally durable material.)

- (d) Show a plan view drawing depicting the relevant monuments and reference ties which is sufficient in detail to enable accurate relocation of the corner monument if the corner monument is disturbed. Indicate north.

1. 2" x 36" galvanized iron pipe with a tablet stamped to identify corner.
2. Maple, 11", N.25°E., 38.59 feet.
3. Maple, 11", S.55°E., 52.48 feet.
4. Maple, 6", S.42°W., 28.95 feet.
5. Maple, 6", N.50°W., 49.12 feet.
6. Steel Sign Post, South, 0.50 feet.

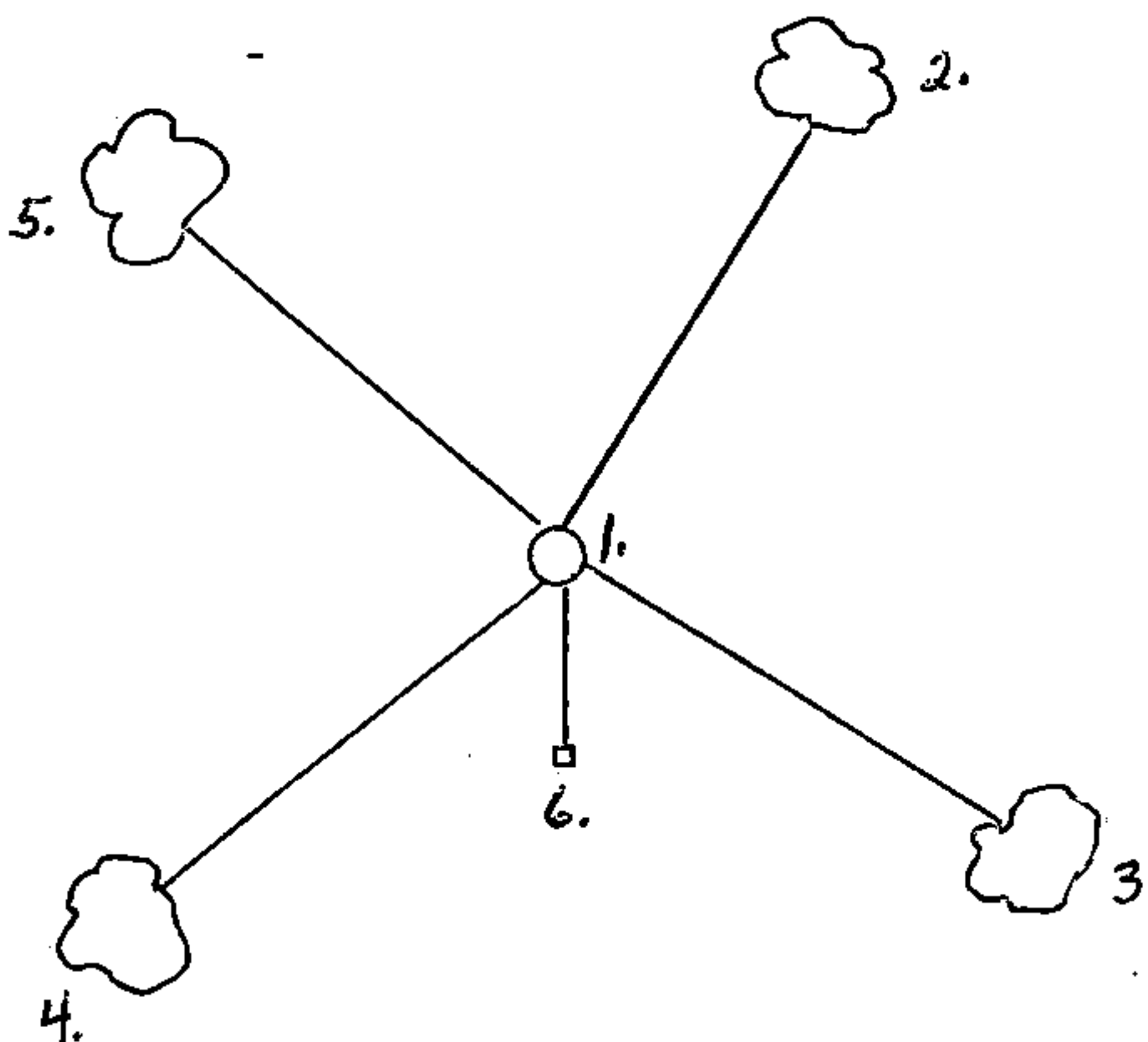

(e) Describe any material discrepancy between the location of the corner as restored or reestablished and the location of that corner as previously restored or reestablished by distance and direction. Show the discrepancy on the plan view drawing under (d), above. Show the distances between the corner as previously restored or reestablished and (1) the corner as restored or reestablished, and (2) to at least 2 of the witness monuments shown on the drawing in (d), above.

None.

(f) Was the corner restored through acceptance of (1) an obliterated evidence location, or, (2) a found perpetuated location?

(2)

(g & h) Was the corner reestablished through lost corner proportionate methods? If so, show the method, including the directions and distances to other public land survey corners used as evidence or used for proportioning in determining the corner location?

No.

REGISTER'S OFFICE
Forest County, Wis.

Received for record this 23rd day
of November A.D., 1994 at
9:00 o'clock A.M. and recorded
in Vol. Corner Restorations
page 35-15, 2, 17

Paul Chubb, Deputy
Register of Deeds

(1) I, Alan D. Harrison
(type or print name) certify that the corner location shown
on this record was determined by me or under my direction and
control and that this U.S. Public Land Survey Monument Record is
correct and complete to the best of my knowledge and belief.

Alan D. Harrison
Signature

10/26/94
Date

CERTIFICATE READY FOR FILING:

Joe Vap
District Ranger

