

CERTIFIED LAND CORNER RESTORATION

State of Wisconsin }
County of Forest } ss.

I William B. Cochrane, do hereby certify that on the 26 day of July, 19 77, I found evidence of the Northwest Section corner of Section 17 Township 36 North Range 16 East, Fourth Principal Meridian, as described hereon; and that from this evidence I established a new monument and accessories as described hereon to perpetuate the original location of this corner:

Description of original monument and accessories and subsequent restorations:

Surveyed in 1858 by James McBride
North between Sections 17 and 18. 80.0 chains set post corner to Sections 7, 8, 17 and 18.
Spruce, 5, N30W, 7 lks.
Spruce, 5, N88E, 64 lks.
Spruce, 5, S29E, 34 lks.
Spruce, 5, S52W, 17 lks.
29.0 chs. South leave swamp NE & SW
16.0 chs. East leave swamp NE & SW

Description of corner evidence found:

1 1/2" iron pipe 5 feet long, along side and north of old post point.
From post point: Spruce stump bears, N88E, 64 lks.
Spruce stump bears, S29E, 32 lks.
Spruce stump bears, S52W, 17 lks.
29 chs. South leave swamp
16.5 chs. East leave swamp

Description of monument and accessories I established to perpetuate the location of this corner:

I replaced the post point with a 2 inch inside diameter galvanized pipe, 6 feet long, 3 feet filled with concrete, with a brass cap stamped:
T36N R16E, S7, S8, S17, S18, 1977, S-1107
From which the following bear:
Black Spruce, 5", N67°E, 15.83 feet
Black Spruce, 4", S17°E, 22.66 feet
Black Spruce, 5", S56°W, 26.21 feet
Black Spruce 3", N52°W, 14.88 feet
Steel sign post, North, 0.30 feet

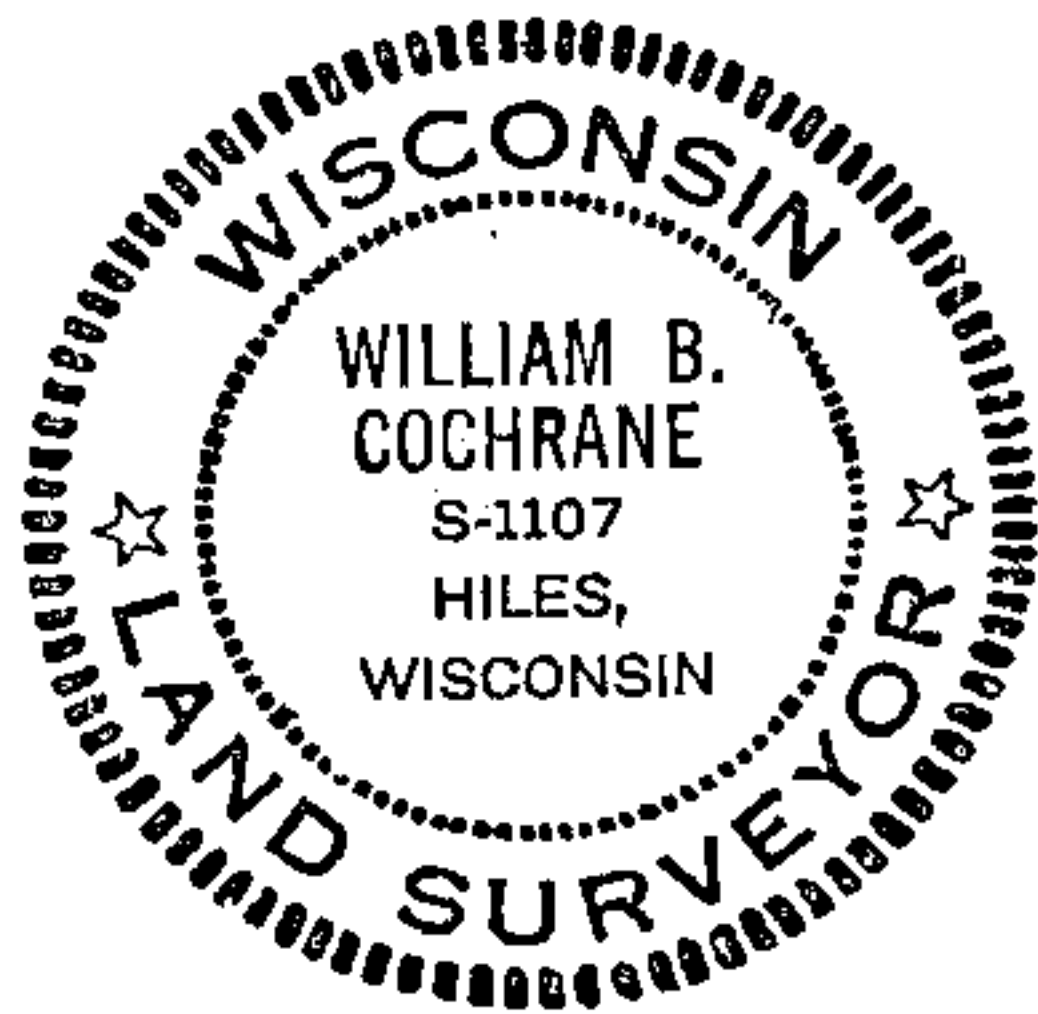

43616070000

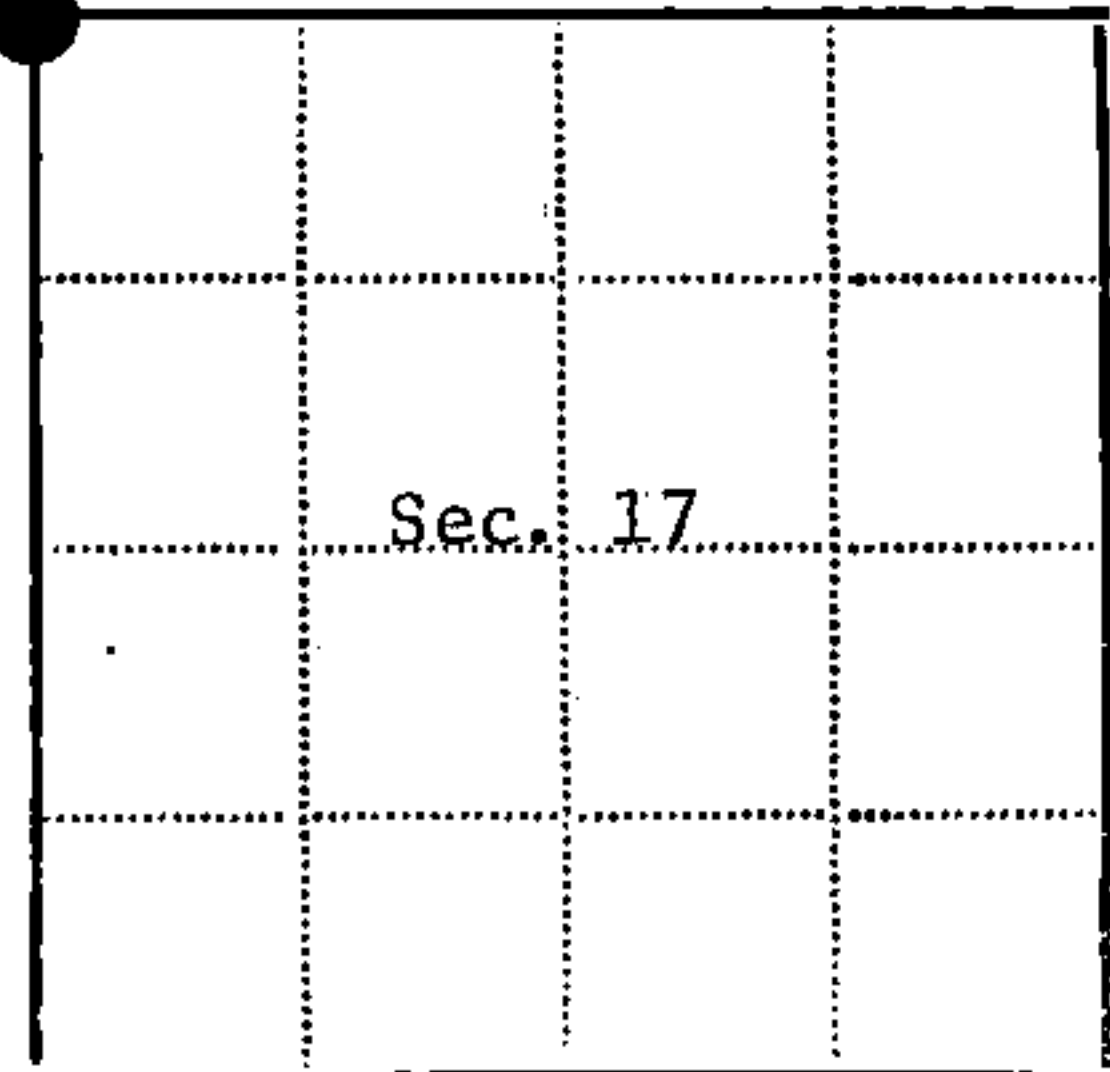

● - Corner monument restored
□ -

Resident witnesses.....

Dated at Laona Wisconsin, this 8 day of August 19 77.

Signature William B. Cochrane Title Survey Technician
(County Surveyor, Registered Land Surveyor, or other duly authorized official)

Surveyors Registration No. S-1107 DOCUMENT NUMBER 113299

Office of Register of Deeds County of Forest

I hereby certify that the within instrument was filed in this office for record on the 13th day of February 1978, and was filed in Book No. Page No. of County Records.

Signature Eugene Scatny Title Register of Deeds

Township 36 North, Range 16 East, Section 17, Index No. J-5, Page No.

U. S. PUBLIC LAND SURVEY MONUMENT RECORD

INSTRUCTIONS:

This record shall show the location of the corner and shall include all of the following nine elements (a through i).

- (a) Identify the corner by reference to the U.S. public land survey system.
 O = Corner monument restored.

Section Corner to Sections 7-8-17-18,
 T.36N., R.16E., Forest County, Wisconsin.

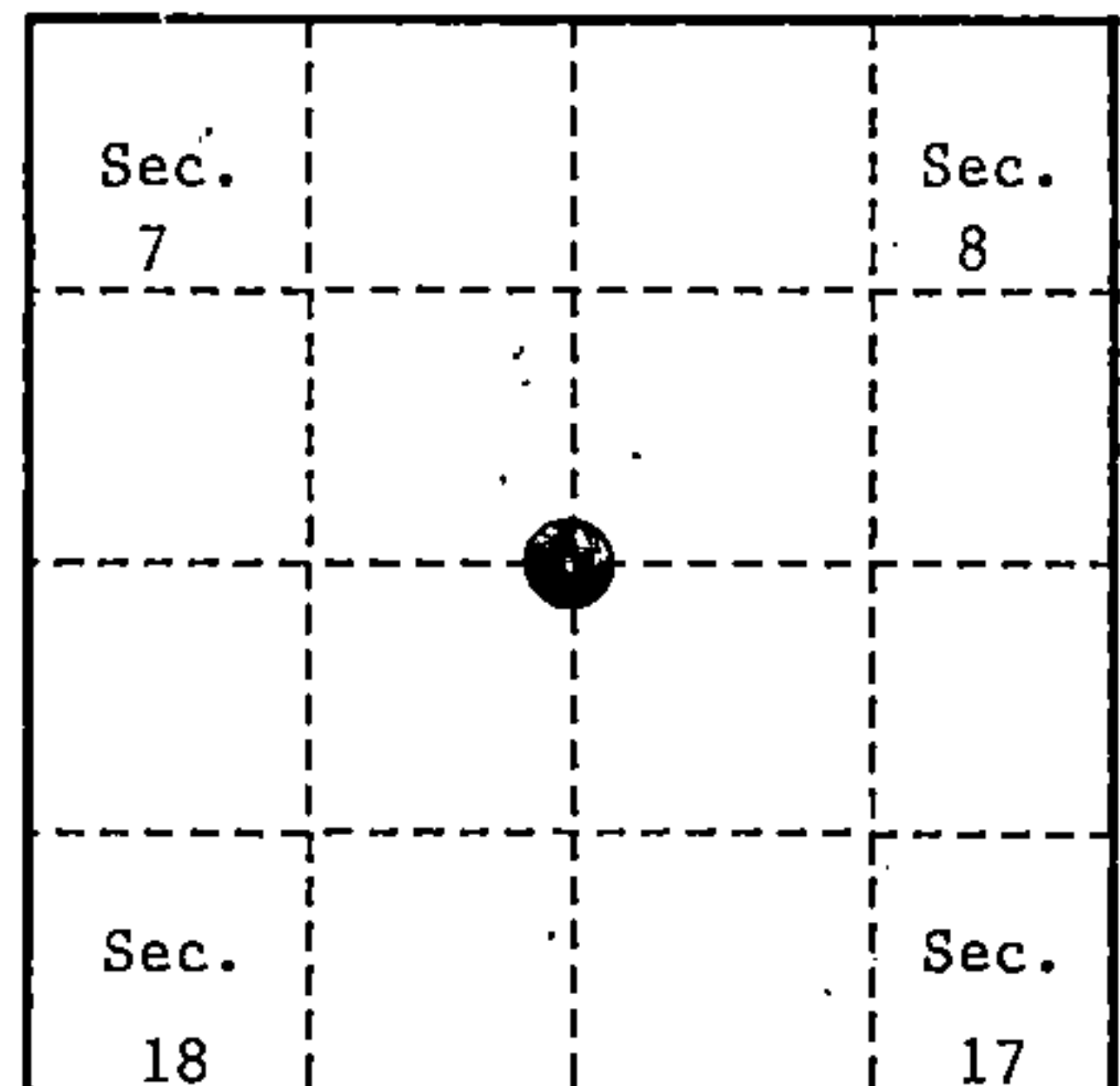

- (b) Describe any record evidence, monument evidence, occupational evidence, testimonial evidence or any other material evidence you considered, and whether the monument was found or placed.

In 1858, James McBride set a wood post with the following B.T.'s: Spruce, 5", N.30°W., 7 links (4.62'); Spruce, 5", N.88°E., 64 links (42.24'); Spruce, 5", S.29°E., 34 links (22.44'); Spruce, 5", S.52°W., 17 links (11.22').

In 1920's Goodman Lumber Company found an old Spruce Post; set 2" x 64" Flue Pipe.

In 1975 and 1976 William Cochrane (RLS) found iron pipe with old post point alongside as per Goodman Lumber Company, from pipe Spruce stump N.88°E., 64 links (42.24'), Spruce stump S.29°E., 34 links (22.44'), Spruce stump S.52°W., 17 links (11.22). He replaced post point with a 2' x 36" galvanized pipe filled with concrete with a brass cap stamped to identify the corner with the following B.T.'s: Spruce, 5", N.67°E., 15.83 feet; Spruce, 4", S.17°E., 22.66 feet; Spruce, 5", S.56°W., 26.21 feet; Spruce, 3", N.52°W., 14.88 feet.

In 1989 Alan Harrison (RLS) found monument and B.T.'s as per Resvick, Northwest B.T. is dead and down, added a B.T. and Steel Sign Post.

In 1993 Alan Harrison (RLS) found monument and bearing trees as described above. Added a new bearing tree; Black Spruce, 3", S.35°E., 5.45 feet.

- (c) In the plan view drawing below, provide reference ties to at least 4 witness monuments, or, if the location is within a municipality, to at least 2 witness monuments. (witness monuments shall be made of concrete, natural stone, iron or other equally durable material.)

- (d) Show a plan view drawing depicting the relevant monuments and reference ties which is sufficient in detail to enable accurate relocation of the corner monument if the corner monument is disturbed. Indicate north.

1. 2" x 36" Iron Pipe filled with concrete with brass cap stamped to identify the corner.
2. Black Spruce, 5", N.67°E., 15.83 feet.
3. Black Spruce, 5", S.56°W., 26.21 feet.
4. Black Spruce, 4", N.32°W., 11.21 feet.
5. Black Spruce, 3", S.35°E., 5.45 feet.
6. Steel Sign Post, South, 0.55 feet.

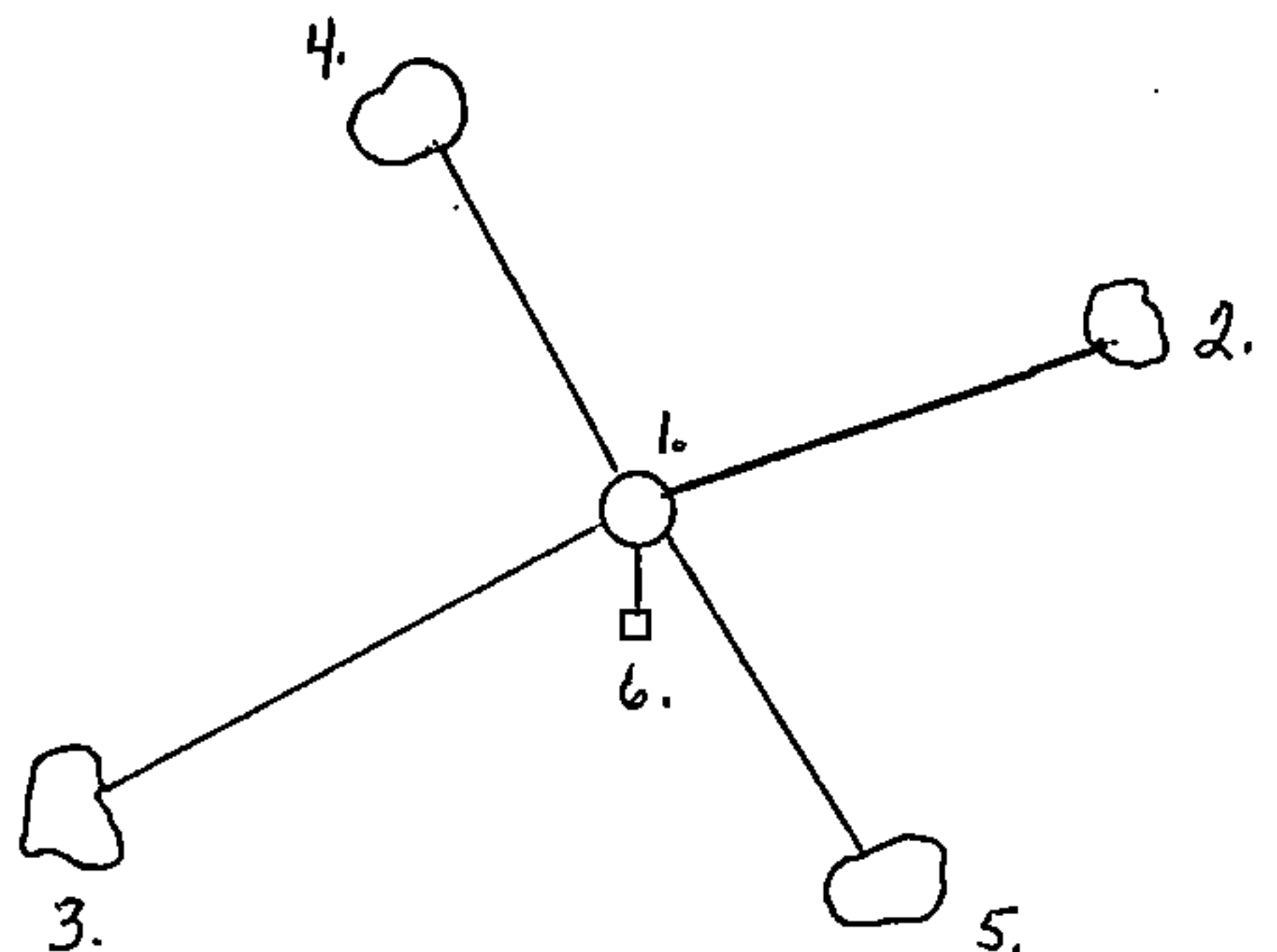

(e) Describe any material discrepancy between the location of the corner as restored or reestablished and the location of that corner as previously restored or reestablished by distance and direction. Show the discrepancy on the plan view drawing under (d), above. Show the distances between the corner as previously restored or reestablished and (1) the corner as restored or reestablished, and (2) to at least 2 of the witness monuments shown on the drawing in (d), above.

None

(f) Was the corner restored through acceptance of (1) an obliterated evidence location, or, (2) a found perpetuated location?

(2) found perpetuated location.

(g & h) Was the corner reestablished through lost corner proportionate methods? If so, show the method, including the directions and distances to other public land survey corners used as evidence or used for proportioning in determining the corner location?

REGISTER'S OFFICE }
Forest County, Wis. }

Received for record this 15th day
of September, A.D., 1994 at
1:00 o'clock P.M. and recorded
in Vol. Corner Restorations
page 1-5

Jack Chittenden
Register of Deeds

(1) I, Alan D. Harrison

(type or print name) certify that the corner location shown on this record was determined by me or under my direction and control and that this U.S. Public Land Survey Monument Record is correct and complete to the best of my knowledge and belief.

Alan D. Harrison

Signature

8/17/94

Date

CERTIFICATE READY FOR FILING:

Sue Vogt
District Ranger

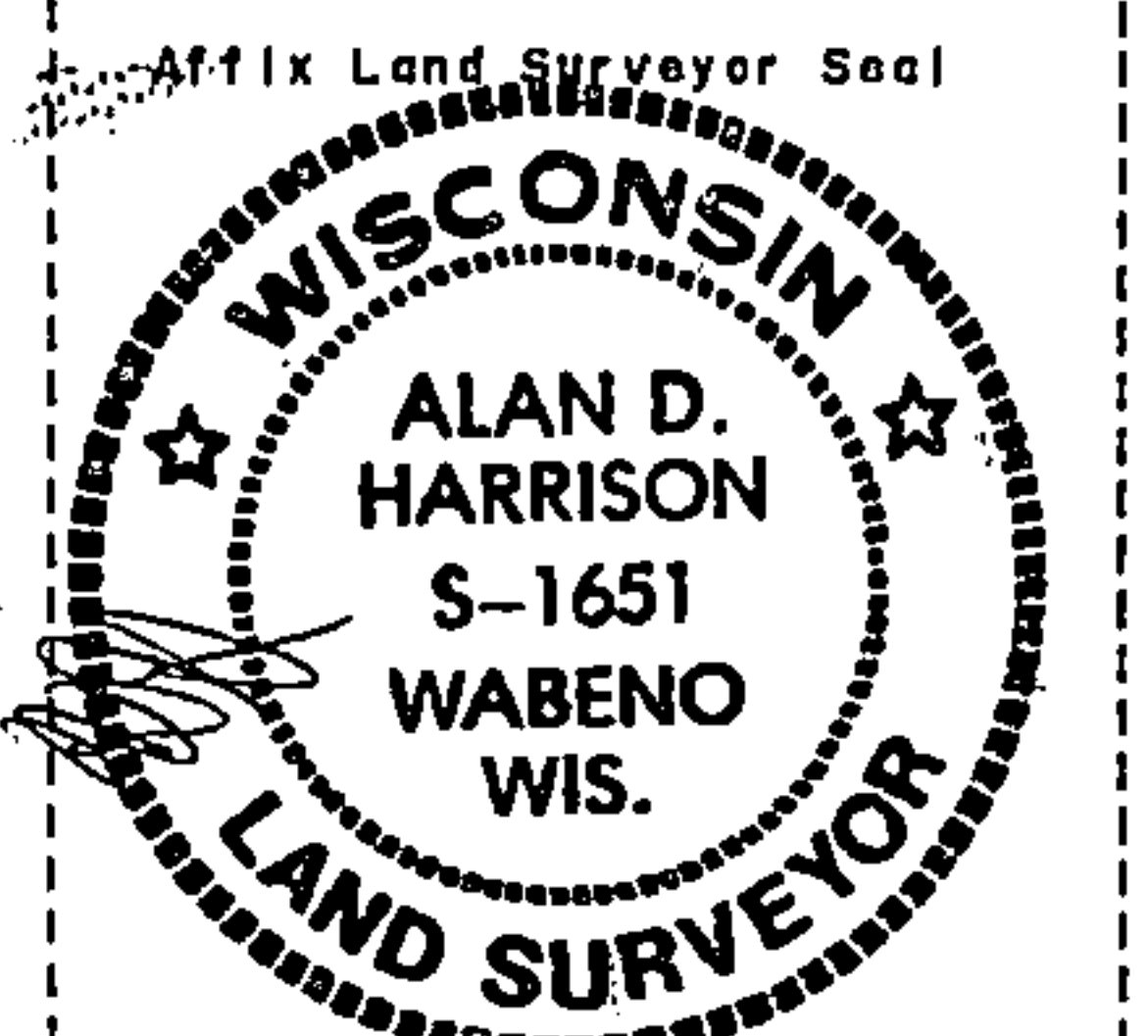

U. S. PUBLIC LAND SURVEY MONUMENT RECORD.

INSTRUCTIONS: This record shall show the location of the corner and shall include all of the following nine elements (a through i).

- (a) Identify the corner by reference to the U.S. public land survey system.
- ④ - Corner monument restored.

Section Corner to Sections 7-8-17-18,
T.36N., R.16E., Forest County, Wisconsin.

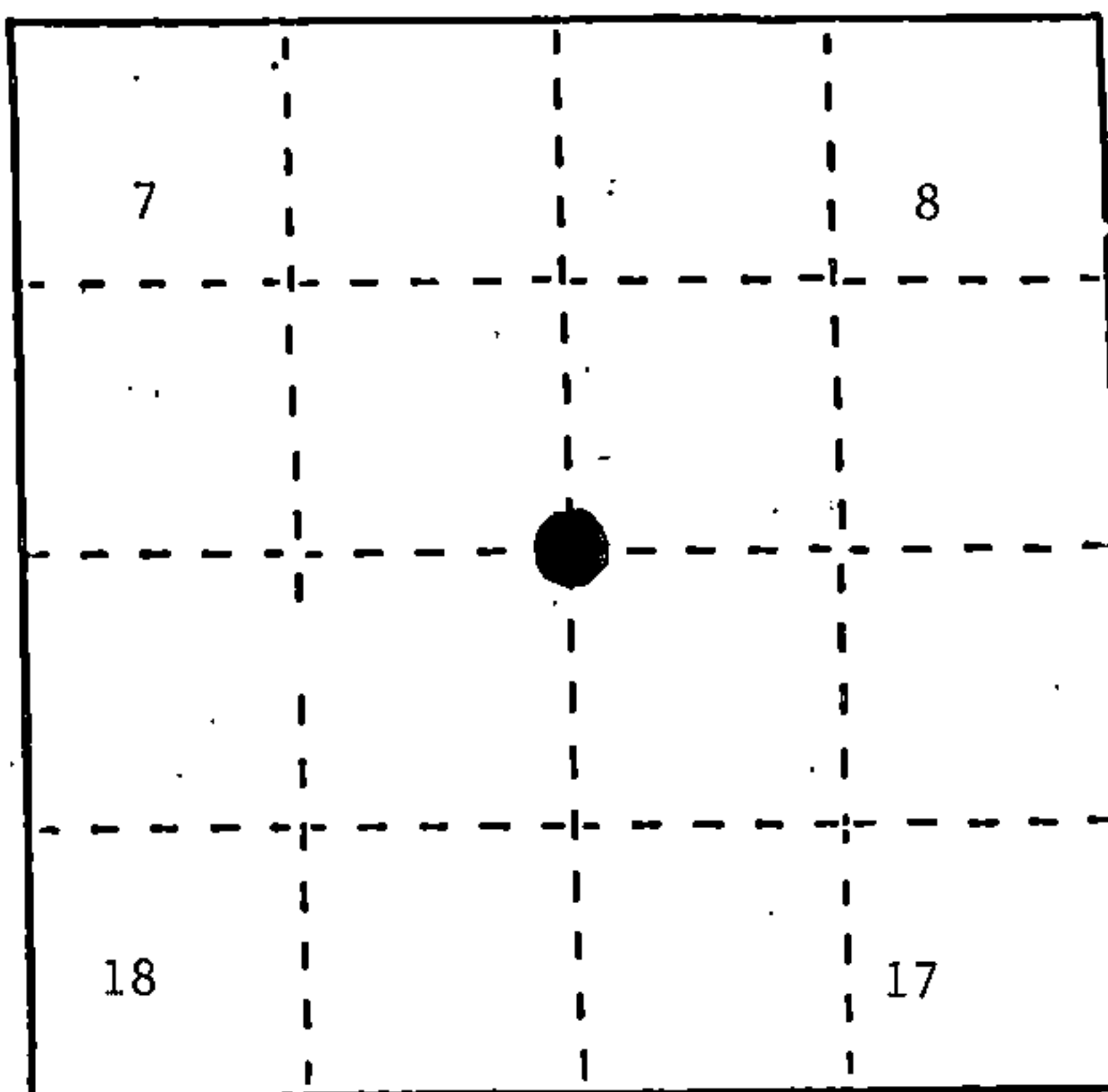

- (b) Describe any record evidence, monument evidence, occupational evidence, testimonial evidence or any other material evidence you considered, and whether the monument was found or placed.

In 1858 James McBride set a wood post with the following B.T.'s: Spruce, 5", N.30°W., 7 links (4.62'); Spruce, 5", N.88°E., 64 links (42.24'); Spruce, 5", S.29°E., 34 links (22.44'); Spruce, 5", S.52°W., 17 links (11.22').

In 1920's Goodman Lumber Company found an old Spruce Post; set 2" x 64" Flue Pipe.

In 1975 and 1976 Jean Resvick (RLS) found iron pipe with old post point alongside as per Goodman Lumber Company, from pipe Spruce stump N.88°E., 64 links (42.24'), Spruce stump S.29°E., 34 links (22.44'), Spruce stump S.52°W., 17 links (11.22'). He replaced post point with a 2' x 36" galvanized pipe filled with concrete with a brass cap stamped to identify the corner with the following B.T.'s: Spruce, 5", N.67°E., 15.83 feet; Spruce, 4", S.17°E., 22.66 feet; Spruce, 5", S.56°W., 26.21 feet; Spruce, 3", N.52°W., 14.88 feet.

In 1989 Alan Harrison (RLS) found monument and B.T.'s as per Resvick, Northwest B.T. is dead and down, added a B.T. and Steel Sign Post.

- (c) In the plan view drawing below, provide reference ties to at least 4 witness monuments, or, if the location is within a municipality, to at least 2 witness monuments. (Witness monuments shall be made of concrete, natural stone, iron or other equally durable material.) Describe witness monuments.

- (d) Show a plan view drawing depicting the relevant monuments and reference ties which is sufficient in detail to enable accurate relocation of the corner monument if the corner monument is disturbed. Indicate north.

1. 2" x 36" Iron Pipe filled with concrete with brass cap stamped to identify the corner.
2. Black Spruce, 5", N.67°E., 15.83 feet.
3. Black Spruce, 4", S.17°E., 22.66 feet.
4. Black Spruce, 5", S.56°W., 26.21 feet.
5. Black Spruce, 4", N.32°W., 11.21 feet.
6. Steel Sign Post, South, 0.55 feet.

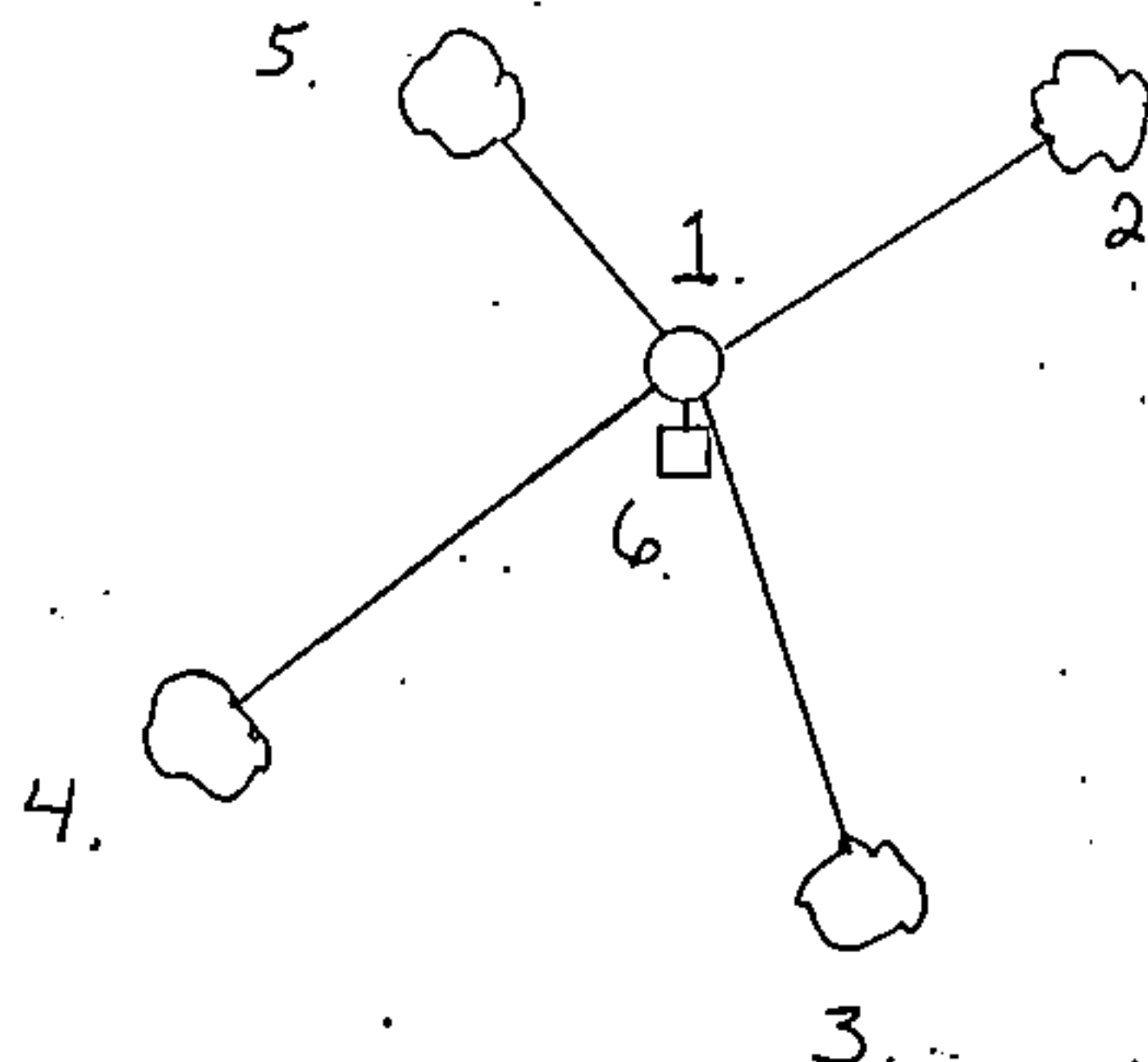

REGISTER'S OFFICE
Forest County, Wis.
Received for record this 29th day
of March, 1990, at
10:00 o'clock A.M. and recorded
in Vol. CORNER RESTORATIONS
page 5
Paul Achenbrenner
Register of Deeds

- (e) Describe any material discrepancy between the location of the corner as restored or reestablished and the location of that corner as previously restored or reestablished by distance and direction. Show the discrepancy on the plan view drawing under (d), above. Show the distances between the corner as previously restored or reestablished and (1) the corner as restored or reestablished, and (2) to at least 2 of the witness monuments shown on the drawing in (d), above.

None.

- (f) Was the corner restored through acceptance of (1) an obliterated evidence location, or, (2) a found perpetuated location?

(2) a found perpetuated location.

- (g,h) Was the corner reestablished through lost corner proportionate methods? If so, show the method, including the directions and distances to other public land survey corners used as evidence or used for proportioning in determining the corner location?

No.

- (i) I, Alan D. Harrison
(type or print name) certify that the corner location shown on this record was determined by me or under my direction and control and that this U.S. Public Land Survey Monument Record is correct and complete to the best of my knowledge and belief.

Alan D. Harrison 3/1/90
Signature Date

CERTIFICATE READY FOR FILING:

Valer B. Itazgo
District Ranger

