

DOCUMENT NUMBER
136223

FORM 985 H. C. MILLER CO., MILWAUKEE

State of Wisconsin }
County of Forest } ss.

I Glen Barker, do hereby
certify that on the 24th day
of May, 1988, I found
est. ~~evidence~~ of the Quarter Section
corner of 2 & 11
Township 37, North, Range
14 East, Fourth Principal Meridian,
as described hereon; and that from this evidence
I established a new monument and accessories
as described hereon to perpetuate the original
location of this corner.

Resident witnesses:

Norm Spiess

Herb Wagoner

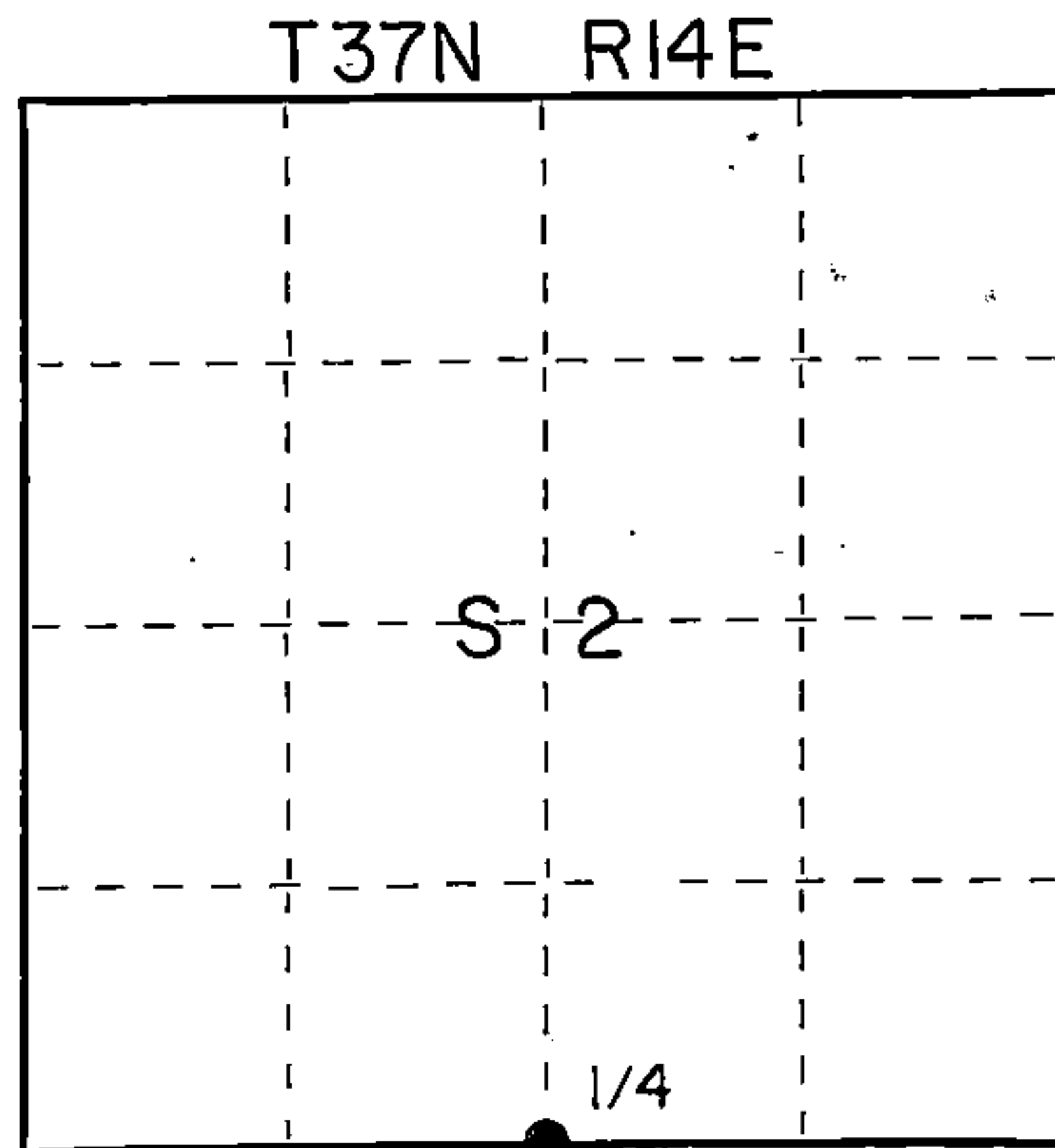

○ = Corner monument restored.

CERTIFIED LAND CORNER RESTORATION
U.S. PUBLIC LAND SURVEY

Index No. E-19

History of original corner establishment:

Original corner established by J.L. Nowlin, Deputy Surveyor in 1865 from
which Birch 10" bears S20°E 20 links and Sugar 8" bears N22°E 10 links.

Description of corner evidence found:

Re-established quarter section corner by proportional measurement. Total
distance from previous recovered section corners 2-3-10-11 and 1-2-11-12
is 5220.44'. Set 1/4 corner 2610.22' intermediate.

Description of monument and accessories I established to perpetuate the original location of this corner.

Set a 2 1/4" aluminum Forest County monument with a 3 1/4" alloy cap stamped:

Monument projects 6" above ground.

Marked N.B.T.'s

Balsam 12" N14°W 23.85'

Sugar 9" N65°E 71.62'

Reference I.P.

1" I.P. - S23°E 7.61'

1" I.P. - S87°W 7.57'

T37N-R14E
1/4 S 2
S 11
1988
S1682

Dated at _____, Wis., this _____ day of _____, 19____

Signature Glen Barker Title _____ Registration No. _____
(County Surveyor, Registered Land Surveyor, or other duly authorized official)

Office of Register of Deeds, County of Forest, I hereby certify that the within
instrument was filed in this office for record on the 19th day of October, 1988
at 11:00 o'clock A. M.

Paul Achenbrenner
(Register of Deeds)

By _____ Deputy

43714020020

e) Describe any material discrepancy between the location of the corner as restored or reestablished and the location of that corner as previously restored or reestablished by distance and direction. Show the discrepancy on the plan view drawing under (d), above. Show the distances between the corner as previously restored or reestablished and (1) the corner as restored or reestablished, and (2) to at least 2 of the witness monuments shown on the drawing in (d), above.

(f) Was the corner restored through acceptance of (1) an obliterated evidence location, or, (2) a found perpetuated location?

(g&h) Was the corner reestablished through lost corner proportionate methods? If so, show the method, including the directions and distances to other public land survey corners used as evidence or used for proportioning in determining the corner location?

Proportionate Method

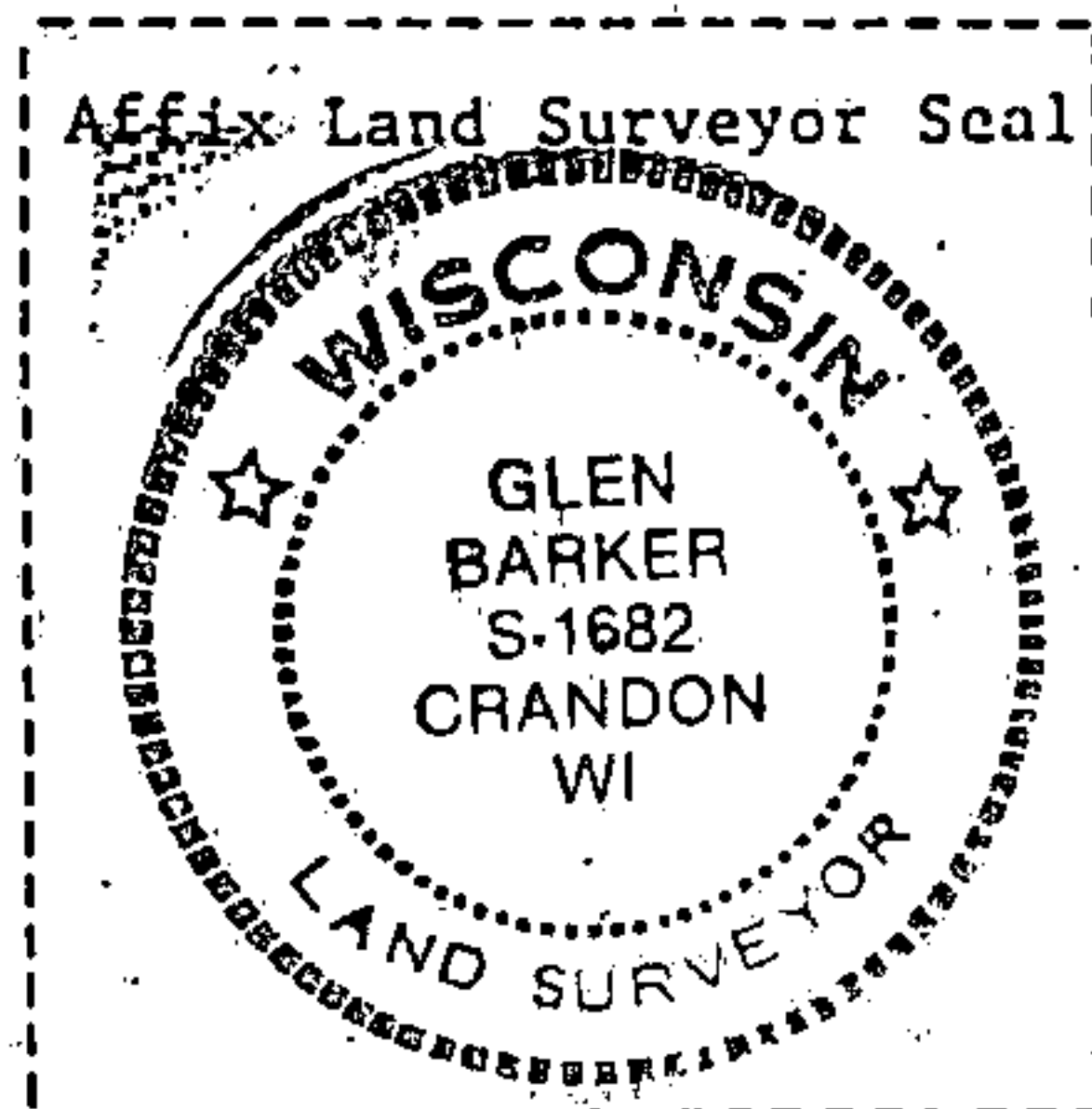
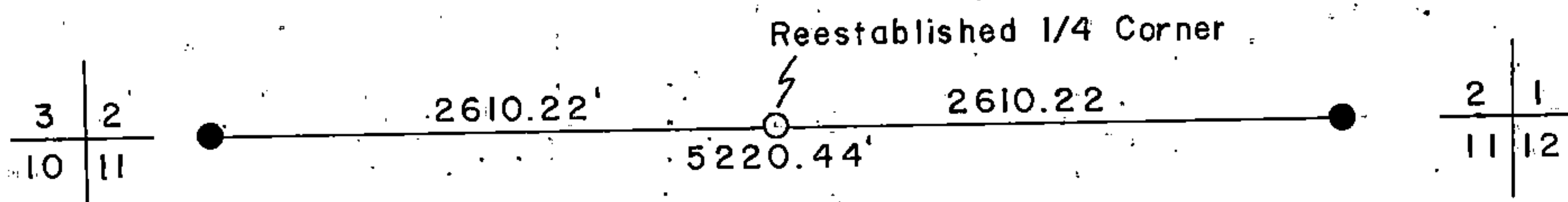

(i) I, Glen Barker
(type or print name) certify that the corner location shown on this record was determined by me or under my direction and control and that this U.S. Public Land Survey Monument Record is correct and complete to the best of my knowledge and belief.

Signature

Date

Sept 7, 1988