

State of Wisconsin }  
County of Forest } ss.

I Philip T. Hansen, do hereby  
certify that on the 10th day  
of August, 19 78, I found  
evidence of the Section  
corner of Sec. 15, 16, 21 & 22  
Township 37, North, Range  
14, Fourth Principal Meridian,  
as described hereon; and that from this evidence  
I established a new monument and accessories  
as described hereon to perpetuate the original  
location of this corner.

Resident witnesses:

Glen Barker

Jim Claflin

Herb Wagoner

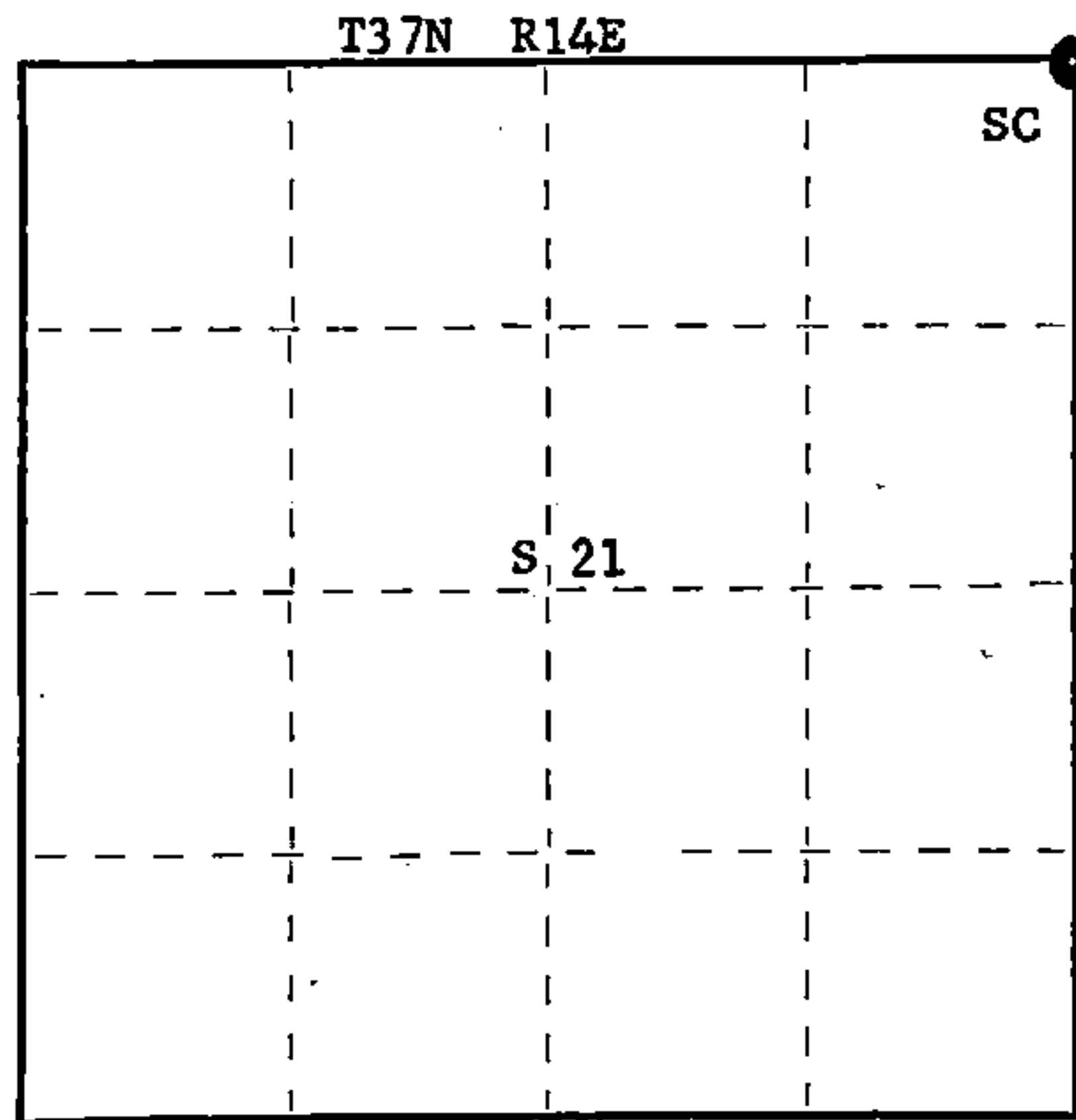
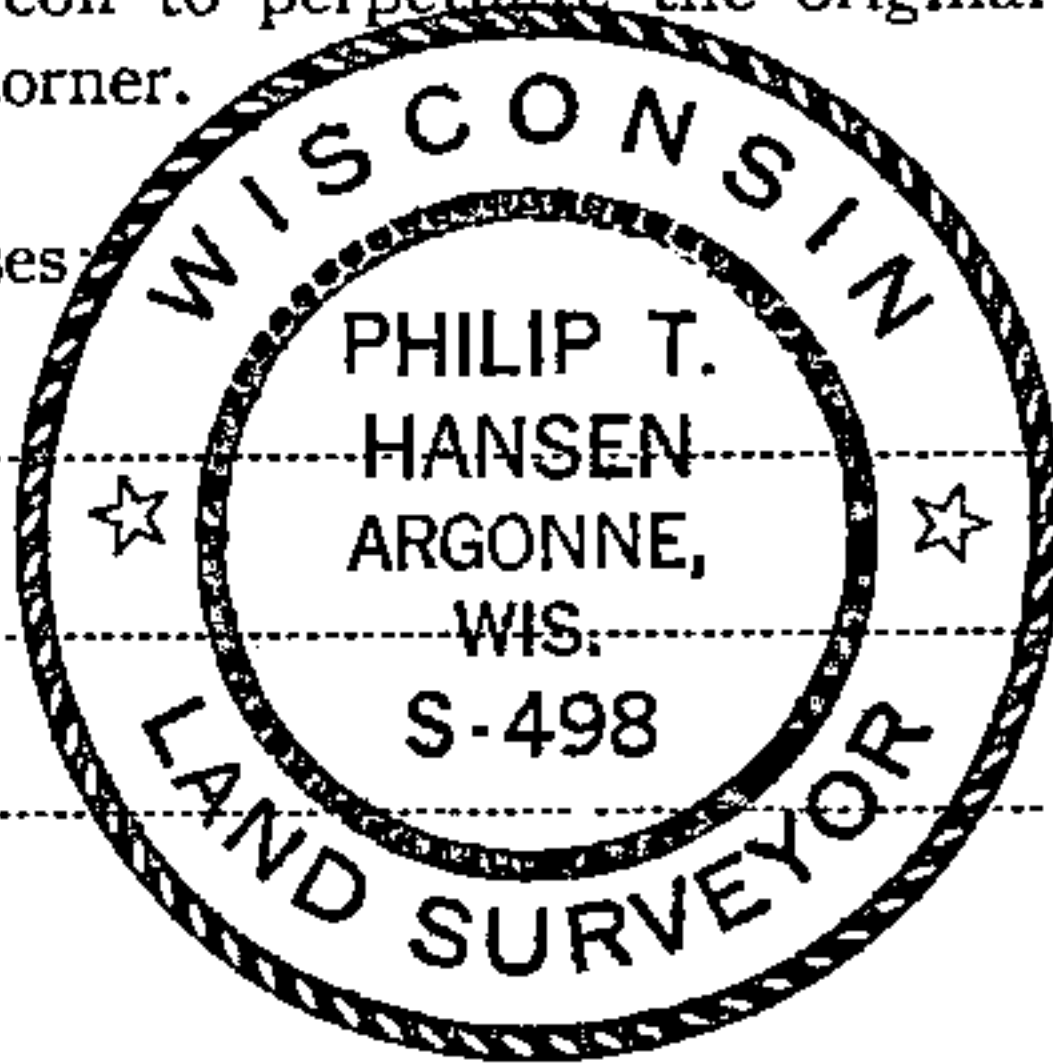

○ = Corner monument restored.

CERTIFIED LAND CORNER RESTORATION  
Correction to N-13 Dated September 30, 1975 Doc. 107873  
History of original corner establishment:

Index No. N-13 A.

Description of corner evidence found:

Because of harvesting of infected trees it was necessary to cut the established bearing trees. Elm 12" N12°E, 91.2 links and Elm 14" S74°W, 73.5 links.

Description of monument and accessories I established to perpetuate the original location of this corner.  
Replaced elm BT's with 3 witness monuments.

- #1 1½" x 48" iron pipe south 8 feet
  - #2 1½" x 48" iron pipe west 10 feet
  - #3 1½" x 48" iron pipe S45°E, 12 feet
- all witness monuments project 24" above ground.

Dated at Rhineland, Wis., this 14th day of August, 19 78

Signature Philip T. Hansen Title Registered Land Surveyor Registration No. S-498  
(County Surveyor, Registered Land Surveyor, or other duly authorized official)

Office of Register of Deeds, County of Forest, I hereby certify that the within  
instrument was filed in this office for record on the 28th day of August, 19 78  
at 3:30 o'clock P. M.

Eugene Steatzen  
(Register of Deeds)

By \_\_\_\_\_ Deputy

DOCUMENT NUMBER  
**114615**

4371416000

N-13 Index No. **N13**

T37N R14E

S 21

○ = Corner monument restored.

History of original corner establishment: Original corner established by James L. Nowlin, Government Deputy Surveyor, in 1865, from which aspen 8" bears S23°E 45 links and aspen 10" bears N43°W 50 links.

Corner recovered by E.B. Hurst, Consolidated Papers, Inc. forester, in 1930 during mapping for acquisition in 1930. Recovered wood post but no evidence of BT's. Corner perpetuated by Consolidated's foresters and P.T. Hansen, Registered Land Surveyor, since 1930.

Description of corner evidence found:  
Recovered old squared cedar stake in poor condition.

Description of monument and accessories I established to perpetuate the original location of this corner.  
Replaced old wood stake with 2-1/2" x 30" Berntsen A-1 Federal Monument, aluminum pipe with magnet installed in cap and base. The post projects 6" above the ground.  
Cap stamped -

NBT's - Elm 12" N12<sup>0</sup>E 91.2 links scribed SC BT.  
Elm 14" S74<sup>0</sup>W 73.5 links scribed SC BT.

Post and accessories painted blue.

S498  
T37N R14E  
S16 | S15  
S21 | S22  
1975

Dated at Argonne, Wis., this 24th day of September, 1975.

Signature Kyle D. Hansen Title Registered Land Surveyor Registration No. S-498  
(County Surveyor, Registered Land Surveyor, or other duly authorized official)

Office of Register of Deeds, County of Forest, I hereby certify that the within instrument was filed in this office for record on the 30th day of September, 19 75 at 3:15 o'clock P. M.

DOCUMENT NUMBER -- 107873

By \_\_\_\_\_ Deputy

FORM 985 H. C. MILLER CO., MILWAUKEE

H3714160000