

## CERTIFIED LAND CORNER RESTORATION

State of Wisconsin

County of Forest

ss.

I Jean F. Resvick, do hereby certify that on the 6th day of July, 1970, I found evidence of the Northeast Section corner of Section 9 Township 37 North, Range 15 East, Fourth Principal Meridian, as described hereon; and that from this evidence I established a new monument and accessories as described hereon to perpetuate the original location of this corner:

## Description of original monument and accessories and subsequent restorations:

Surveyed in 1865 by J. L. Nowlin

80.00 chains North between sections 9 and 10

Set post

Hemlock 7, bears N45E, 12 lks.

Hemlock 14, bears N55W, 30 lks.

## Description of corner evidence found:

1½ inch diameter iron pipe and remains of old post. Forest Service location poster on South edge of road which reads, approximately 80 lks. South to corner. Old post is the same as those found on the other corners of the section. Iron pipe is in agreement with corners South and West. I accept this to be best available evidence of corner.

## Description of monument and accessories I established to perpetuate the original location of this corner:

Replaced iron pipe with a 2 inch inside diameter, galvanized wrought iron pipe, filled with concrete, 5 feet long with a brass cap stamped.

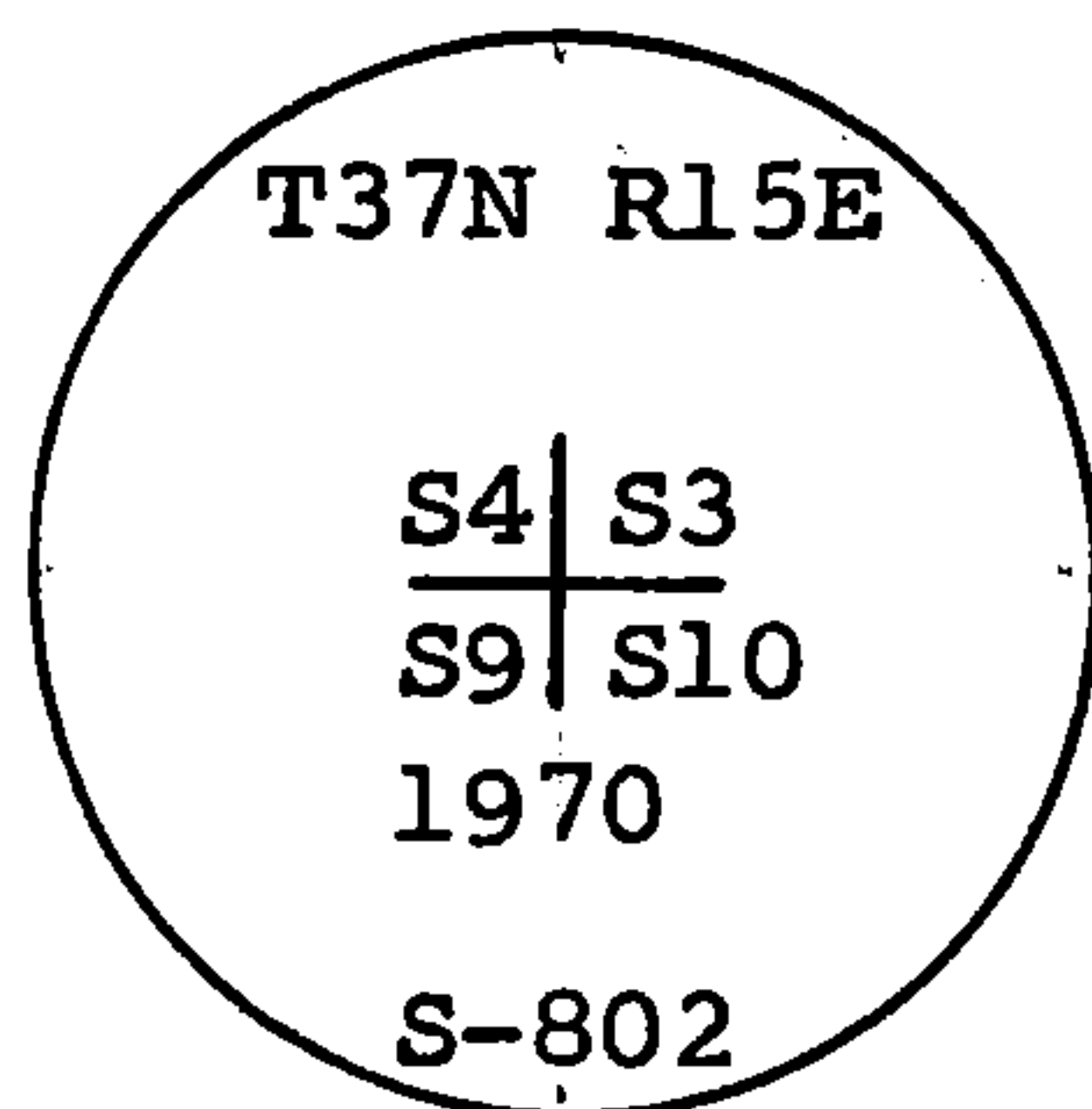

from which the following New blazed and scribed bearing trees bear:

Black Spruce 4, bears S72W, 19.48 ft.

Balsam 6, bears N31W, 16.80 ft.

Iron fence post set 1.0 feet Southeast of monument.



Resident witnesses

Dated at Rhinelanders Wisconsin this 11th day of July 1970

Signature Jean F. Resvick

Title Cadastral Surveyor

(County Surveyor, Registered Land Surveyor, or other duly authorized official)

Surveyors Registration No. S-802

DOCUMENT Number 98915

Office of Register of Deeds County of Forest

I hereby certify that the within instrument was filed in this office for record on the 23rd day of October 1970, and was filed in Book

No. CORNER Page No. E-13 of County Records.

RESTORATIONS

Signature Eugene Statz Title Register of Deeds

Township 37 North, Range 15 East, Section 9, Index No. E-13, Page No.

43715040000

U.S. PUBLIC LAND SURVEY MONUMENT RECORD

Index No. E-13

State of Wisconsin }  
County of Forest } ss.

I, Gary L. Pisoni, do hereby  
certify that on the 12th day  
of December, 1994, I found  
evidence of the Southwest Section  
corner of Section 3  
Township 37 North, Range  
15 East, Fourth Principal Meridian,  
as described hereon; and that from this evidence  
I established a new monument and accessories  
as described hereon to perpetuate the original  
location of this corner.

Resident witnesses:

\_\_\_\_\_  
\_\_\_\_\_  
\_\_\_\_\_

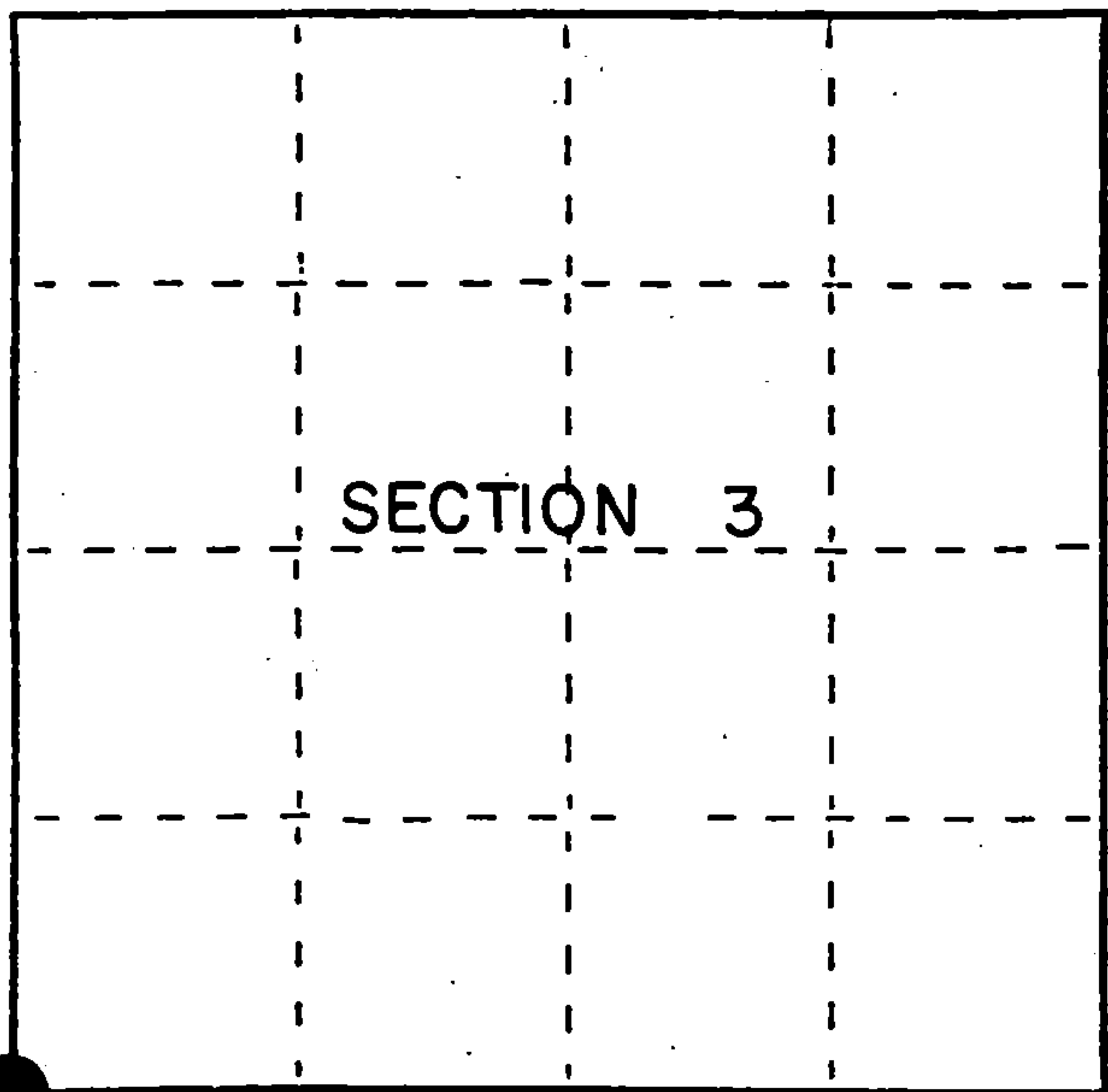

● = Corner monument restored.

History of original corner establishment:

Original Survey in 1865 by J.L. Nowlin. North between Sections 9 and 10, at 80.00  
chains, set section cor. post which bears: Hemlock 7"N45°E 121ks; Hemlock 14"N55°W 30 lks.  
In 1934 John Ruby found wood post alongside a 1½" dia. iron pipe. Put metal tag on a Maple  
8", S60 E, 2 chs.

In 1970, Jean Resvick, RLS, with the Forest Service found the above described evidence. He  
replaced pipe with a 2" dia. galvanized iron pipe. Made the following bearing trees; B. Spruce  
4", S72°W, 19.48 ft., Balsam, 6", N31°W, 16.80 ft., Iron Post, SE, 1.00 ft.

In 1988, Alan Harrison, RLS, with the Forest Service, made the following new bearing trees;  
Description of corner evidence found:

Aspen	3"	N46°E	10.64 feet
Balsam	7"	S78°E	53.92 feet
Red Maple	6"	S82°W	19.56 feet
Balsam	5"	N77°W	21.60 feet

Found monument and bearing trees as described above;

Aspen(Dead)		N46°E	10.64 feet
Balsam	8"	S84°E	54.02 feet
Red Maple	7"	S82°W	19.56 feet
Balsam	6"	N77°W	21.60 feet
Steel Sign Post		S60°E	1.20 feet

Description of monument and accessories I established to perpetuate the original location of this corner.

Blazed and scribed a new bearing tree: (Measurement is taken to a nail in side of tree)

Aspen	6"	N35°E	32.48 feet
Steel Sign Post		N01°E	1.30 feet

Dated at Iron River, MI, this 5th day of March, 1995

Signature: Gary L. Pisoni Title: Land Surveyor Registration No: S-1634  
(County Surveyor, Registered Land Surveyor, or other duly authorized official)

Office of Register of Deeds, County of Forest, I hereby certify that the within  
instrument was filed in this office for record on the 30th day of March, 1997  
at 1:30 o'clock P. M.

(Register of Deeds)

By: [Signature] Deputy



(e) Describe any material discrepancy between the location of the corner as restored or reestablished and the location of that corner as previously restored or reestablished by distance and direction. Show the discrepancy on the plan view drawing under (d), above. Show the distances between the corner as previously restored or reestablished and (1) the corner as restored or reestablished, and (2) to at least 2 of the witness monuments shown on the drawing in (d), above.

None

(f) Was the corner restored through acceptance of (1) an obliterated evidence location, or, (2) a found perpetuated location?

Restored through acceptance of a found perpetuated location.

(g&h) Was the corner reestablished through lost corner proportionate methods? If so, show the method, including the directions and distances to other public land survey corners used as evidence or used for proportioning in determining the corner location?

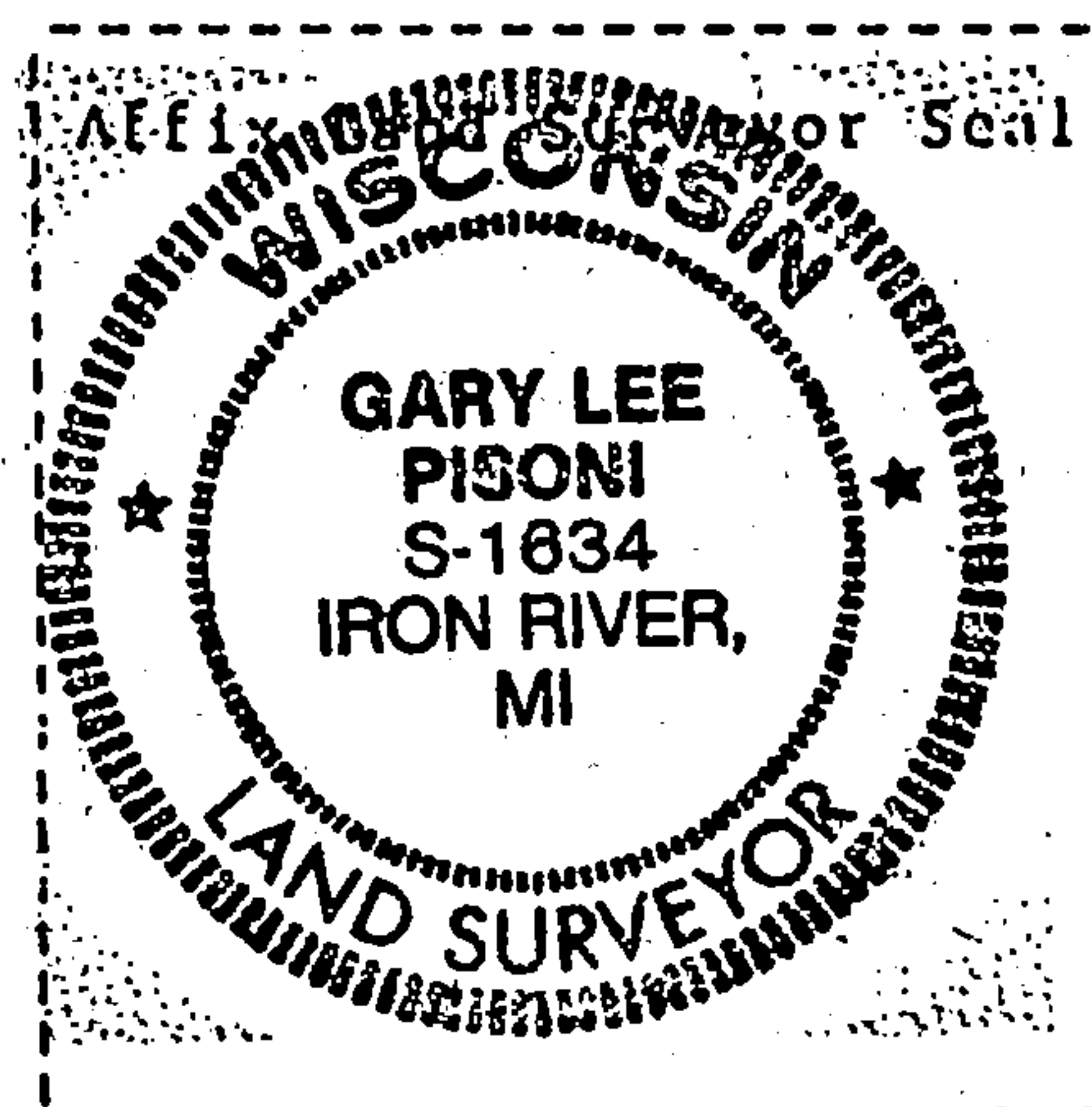
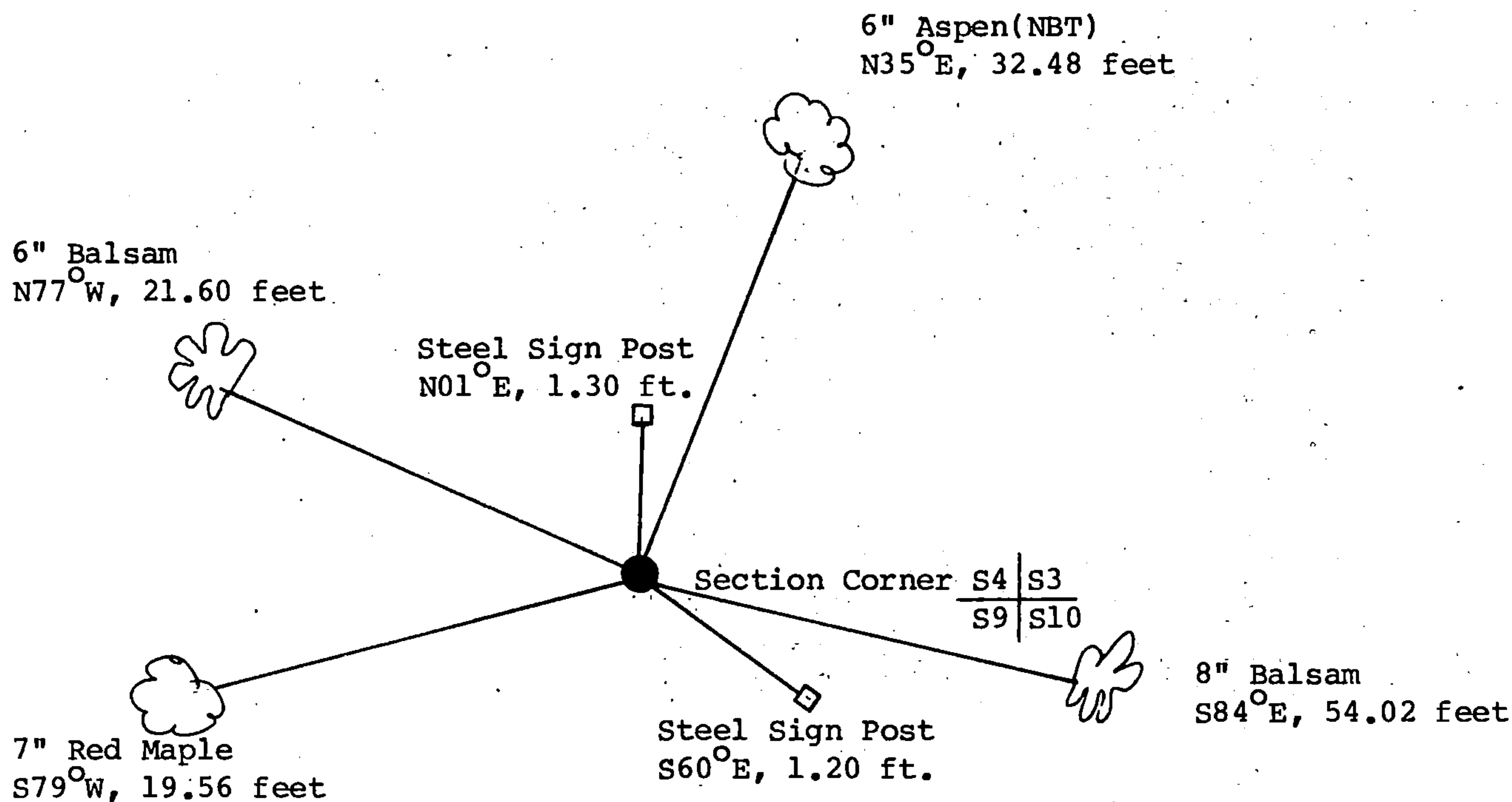

(i) I, Gary L. Pisoni  
(Type or print name) certify that the corner location shown on this record was determined by me or under my direction and control and that this U.S. Public Land Survey Monument Record is correct and complete to the best of my knowledge and belief.

Signature

*Gary L. Pisoni*

Date

9-23-95

DOCUMENT NUMBER

137113

## U. S. PUBLIC LAND SURVEY MONUMENT RECORD

INSTRUCTIONS: This record shall show the location of the corner and shall include all of the following nine elements (a through i).

- (a) Identify the corner by reference to the U.S. public land survey system.  
 ○ = Corner monument restored.

Section Corner to Sections 3-4-9-10,  
 T.37N., R.15E., Forest County.

REGISTER'S OFFICE  
 Forest County, Wis.

Received for record this 29<sup>th</sup> day

of March A.D., 1989 at

9:00 o'clock A.M. and recorded

In Vol. CORNER RESTORATIONS

page E-13

Paul Achenbrenner  
 Register of Deeds

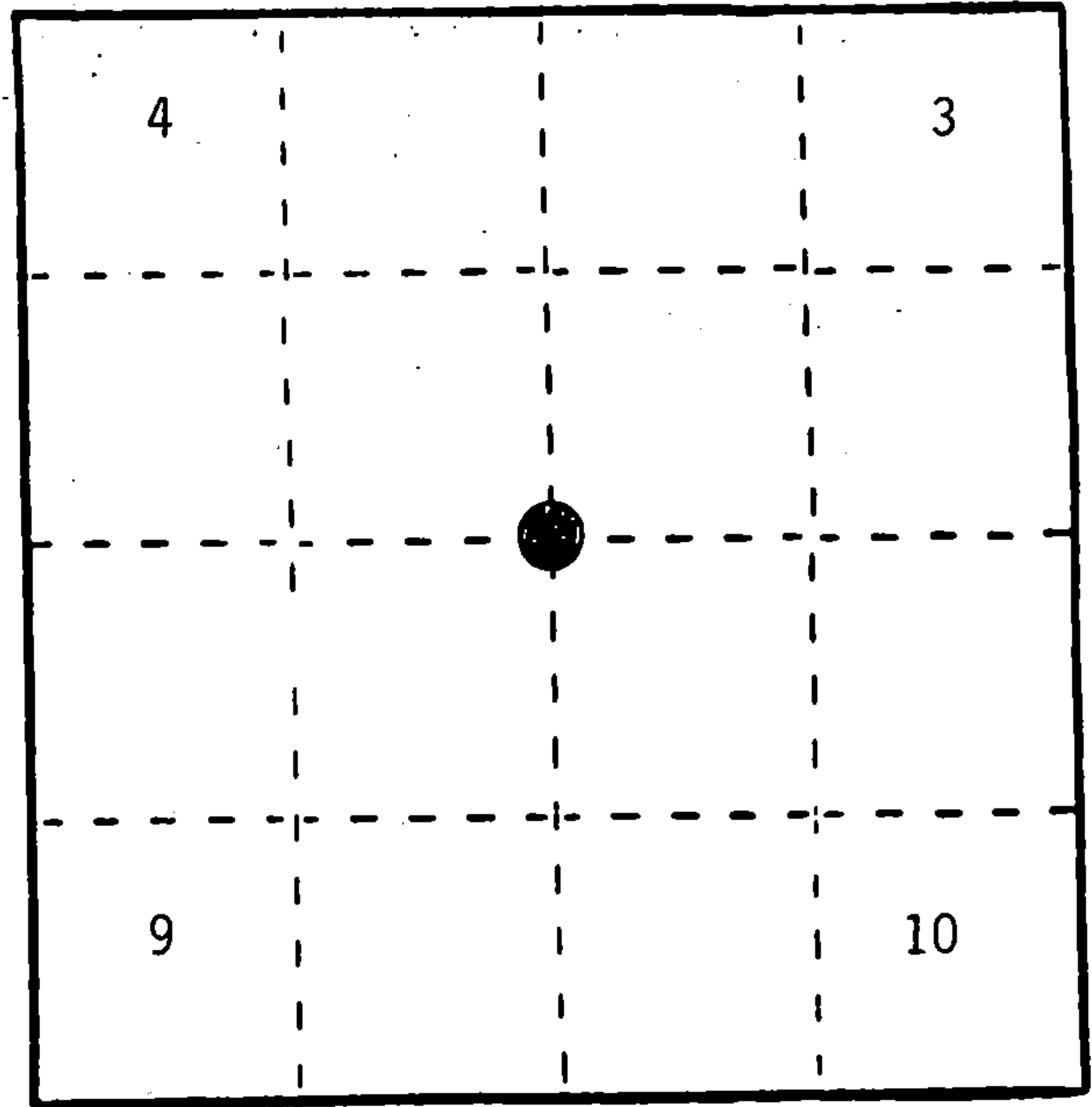

- (b) Describe any record evidence, monument evidence, occupational evidence, testimonial evidence or any other material evidence you considered, and whether the monument was found or placed.  
 In 1865, J.L. Nowlin set wood post with the following BTs: Hemlock, 7", N.45E., 7.92 feet; Hemlock, 14", N.55W., 19.80 feet.

In 1934, John Lindiy Ruby, "874" found wood post with 1½" iron pipe alongside. Put metal tag on a Maple, 8", S.60E., 2 chains. Old road runs East and West, 80.00 feet South of corner position.

In 1970, Jean Resvick; found Forest Service location tag on South edge of road. 1½" iron pipe and remains of old post, replaced with a 2" galvanized pipe, 5 feet long. Added BTs: Black Spruce, 4", S.72W., 19.48 feet; Balsam, 6", N.31W., 16.80 feet, iron post, Southeast, 1.00 feet.

In 1988, Al Harrison found monument in good condition, added new BTs.

- (c) In the plan view drawing below, provide reference ties to at least 4 witness monuments, or, if the location is within a municipality, to at least 2 witness monuments. (Witness monuments shall be made of concrete, natural stone, iron or other equally durable material.)  
 Describe witness monuments.

- (d) Show a plan view drawing depicting the relevant monuments and reference ties which is sufficient in detail to enable accurate relocation of the corner monument if the corner monument is disturbed. Indicate north.

1. 2" galvanized pipe filled with concrete, 5 feet long with brass cap.
2. Aspen, 3", N.46E., 10.64 feet.
3. Balsam, 7", S.78E., 53.92 feet.
4. Red Maple, 6", S.82W., 19.56 feet.
5. Balsam, 5", N.77W., 21.60 feet.
6. Steel Sign Post, Southeast, 1.00 feet.

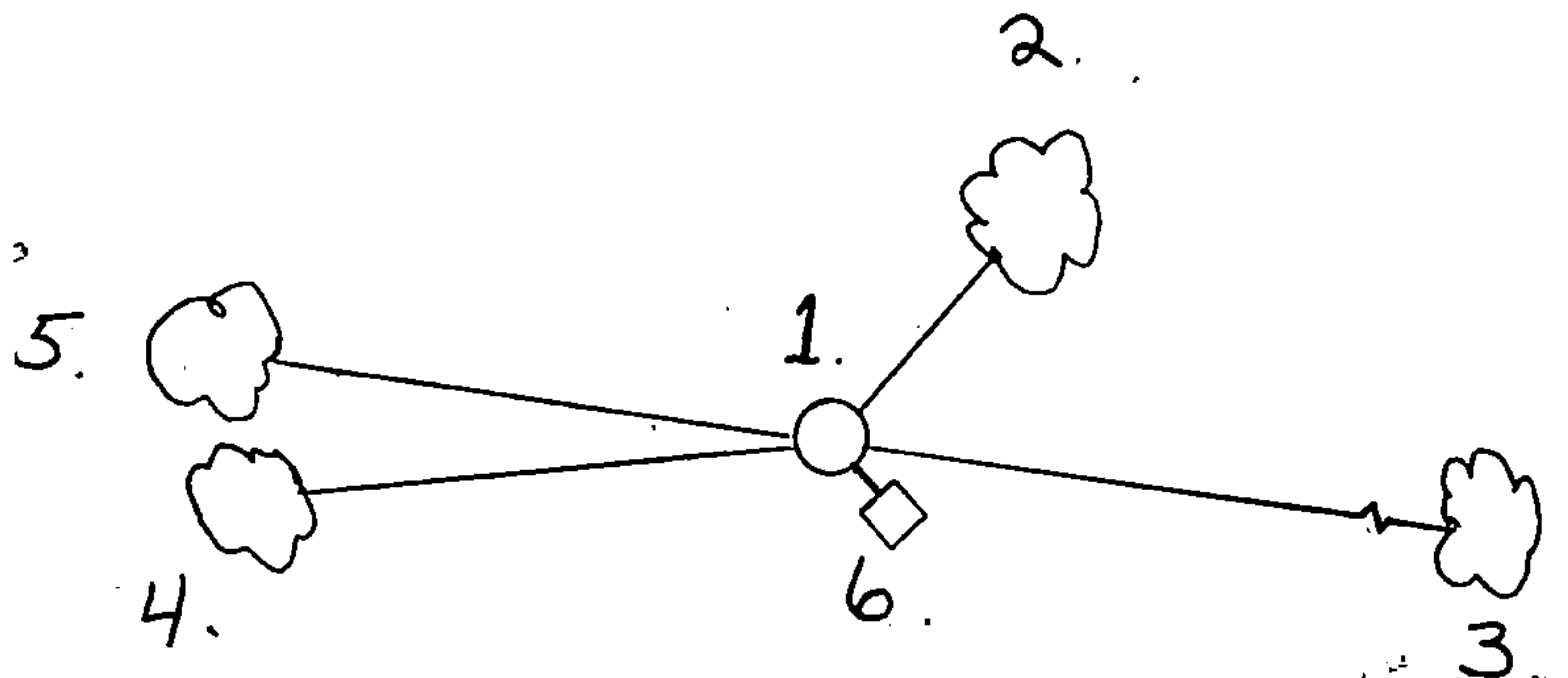

- (e) Describe any material discrepancy between the location of the corner as restored or reestablished and the location of that corner as previously restored or reestablished by distance and direction. Show the discrepancy on the plan view drawing under (d), above. Show the distances between the corner as previously restored or reestablished and (1) the corner as restored or reestablished, and (2) to at least 2 of the witness monuments shown on the drawing in (d), above.

None

- (f) Was the corner restored through acceptance of (1) an obliterated evidence location, or, (2) a found perpetuated location?

(2) A found perpetuated location.

- (g) Was the corner reestablished through lost corner proportionate methods? If so, show the method, including the directions and distances to other public land survey corners used as evidence or used for proportioning in determining the corner location?

No.

- (1) Alan D. Harrison  
(Type or print name) certify that the corner location shown on this record was determined by me or under my direction and control and that this U.S. Public Land Survey Monument Record is correct and complete to the best of my knowledge and belief.

Alan D. Harrison 3/2/89  
Signature Date

Certificate ready for filing.

Dale S. Stange  
District Ranger

