

## CERTIFIED LAND CORNER RESTORATION

State of Wisconsin

County of Forest

ss.

I Jean F. Resvick, do hereby certify that on the 8th day of July, 1970, I found evidence of the East Quarter corner of Section 9 Township 37 North, Range 15 East, Fourth Principal Meridian, as described hereon; and that from this evidence I established a new monument and accessories as described hereon to perpetuate the original location of this corner:

## Description of original monument and accessories and subsequent restorations:

Surveyed in 1865 by J. L. Nowlin  
 40 chains North between section 9 and 10, set post.  
 Tamarack 14, bears N52E, 25 lks.  
 Tamarack 12, bears S18W, 25 lks.  
 22.25 chains South stream 8 lks. wide runs Southwest.

## Description of corner evidence found:

Squared cedar post  
 Squared pine post scribed  
 Point of old post which is the oldest and could be the original.  
 Tamarack stump, with scribing bears S18W, 30 lks.  
 Tamarack stump, bears N52E, 30 lks.

## Description of monument and accessories I established to perpetuate the original location of this corner:

Replaced old post point with a 2 inch inside diameter, galvanized wrought iron pipe, 5 feet long, filled with concrete, with brass cap stamped.

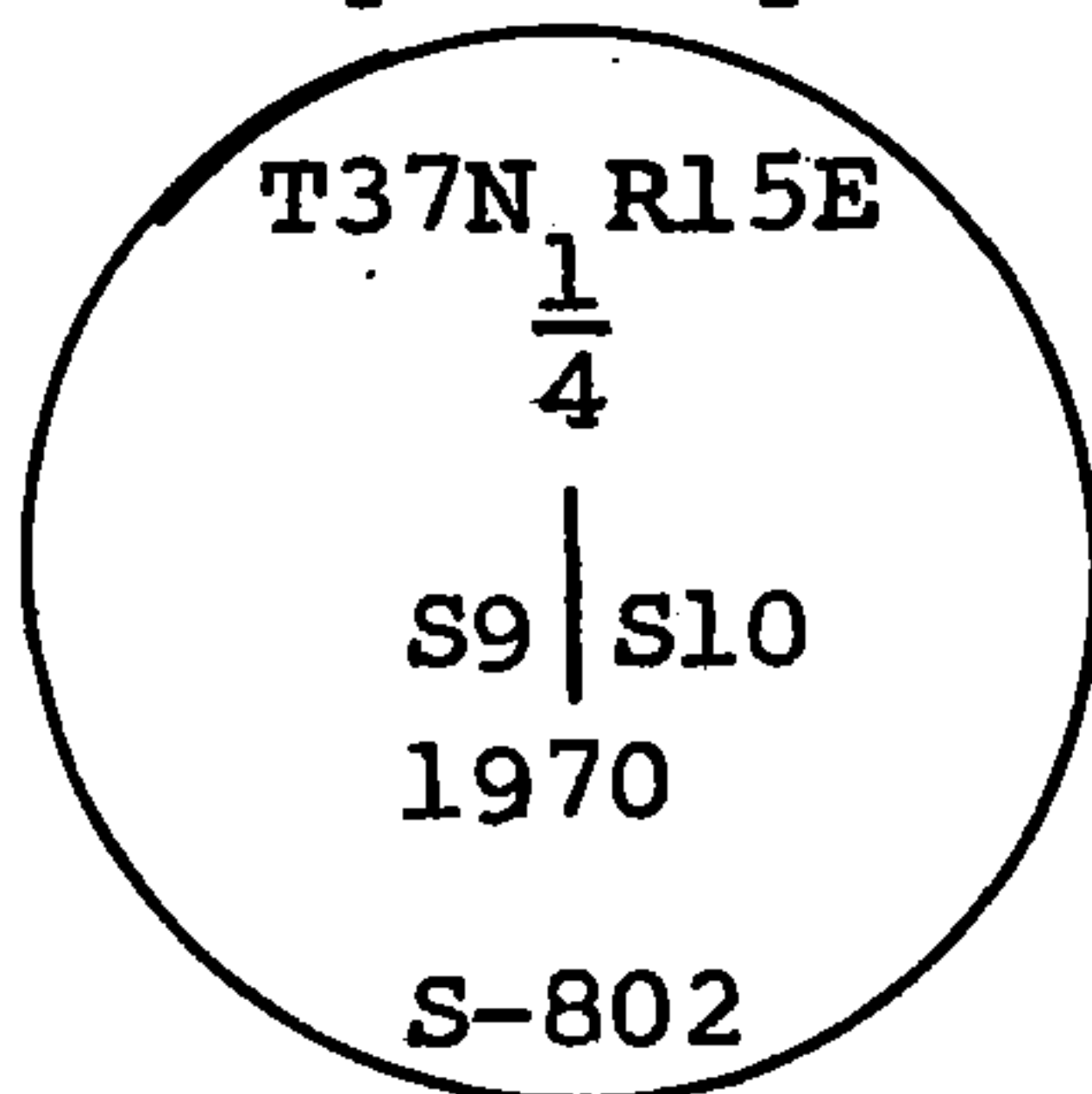

from which the following New blazed and scribed bearing trees bear.

Tamarack 4, bears N60E, 15.11 feet  
 Tamarack 5, bears S44W, 4.75 feet  
 Tamarack 5, bears N49W, 4.45 feet

Set iron fence post 1.1 foot Southeast of monument.

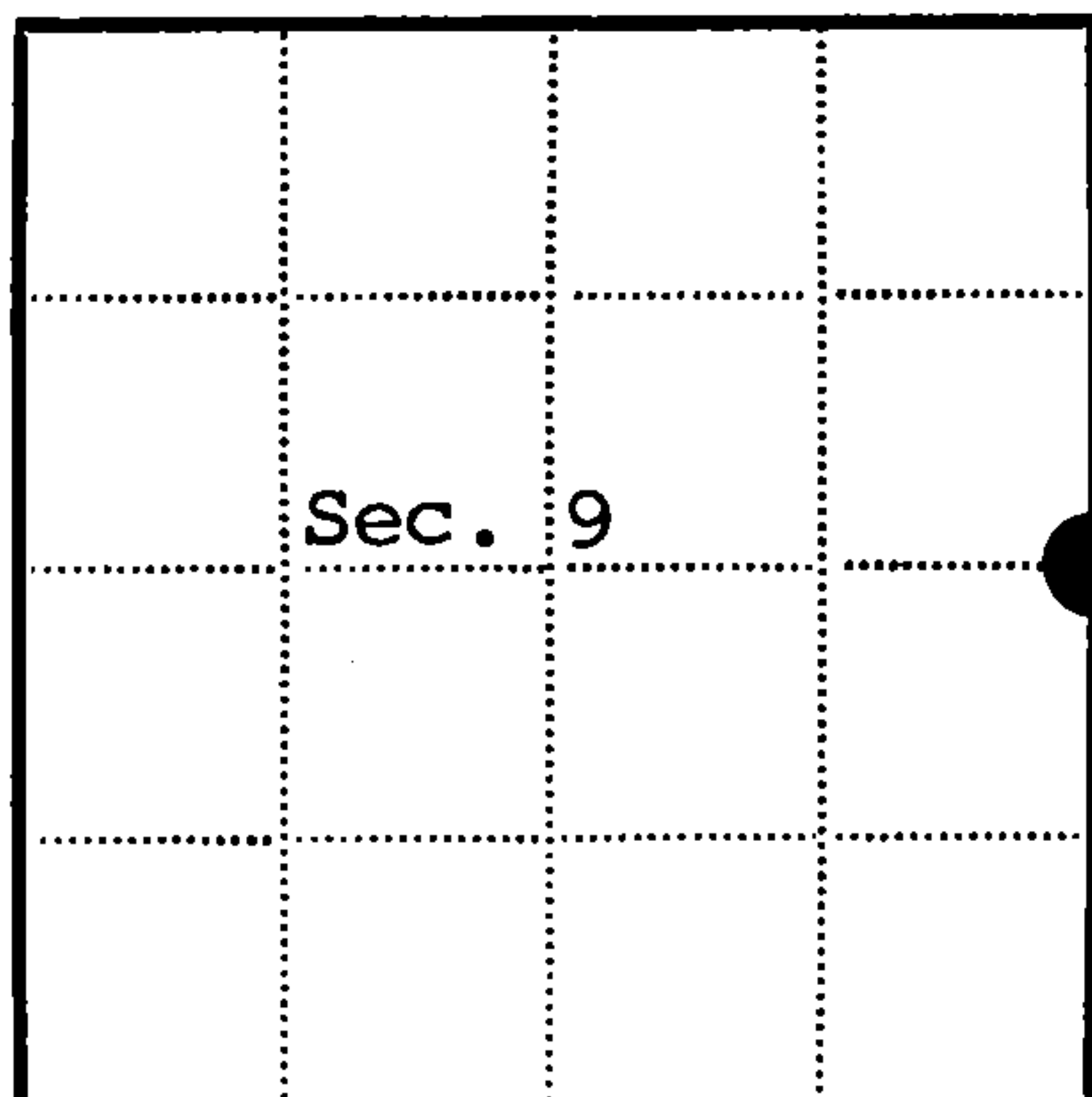

● = Corner monument restored

□ =

Resident witnesses

Dated at Rhinelanders Wisconsin, this 11th day of July, 1970.

Signature Jean F. Resvick Title County Surveyor  
 (County Surveyor, Registered Land Surveyor, or other duly authorized official)

Surveyors Registration No. S-802

DOCUMENT Number 98917

Office of Register of Deeds County of Forest

I hereby certify that the within instrument was filed in this office for record on the 23rd day of October 1970, and was filed in Book

No. CORNER Page No. G-13 of County Records.

Signature Eugene Stutzman Title Register of Deeds

Township 37 North, Range 15 East, Section 9, Index No. G-13, Page No.

43715092000

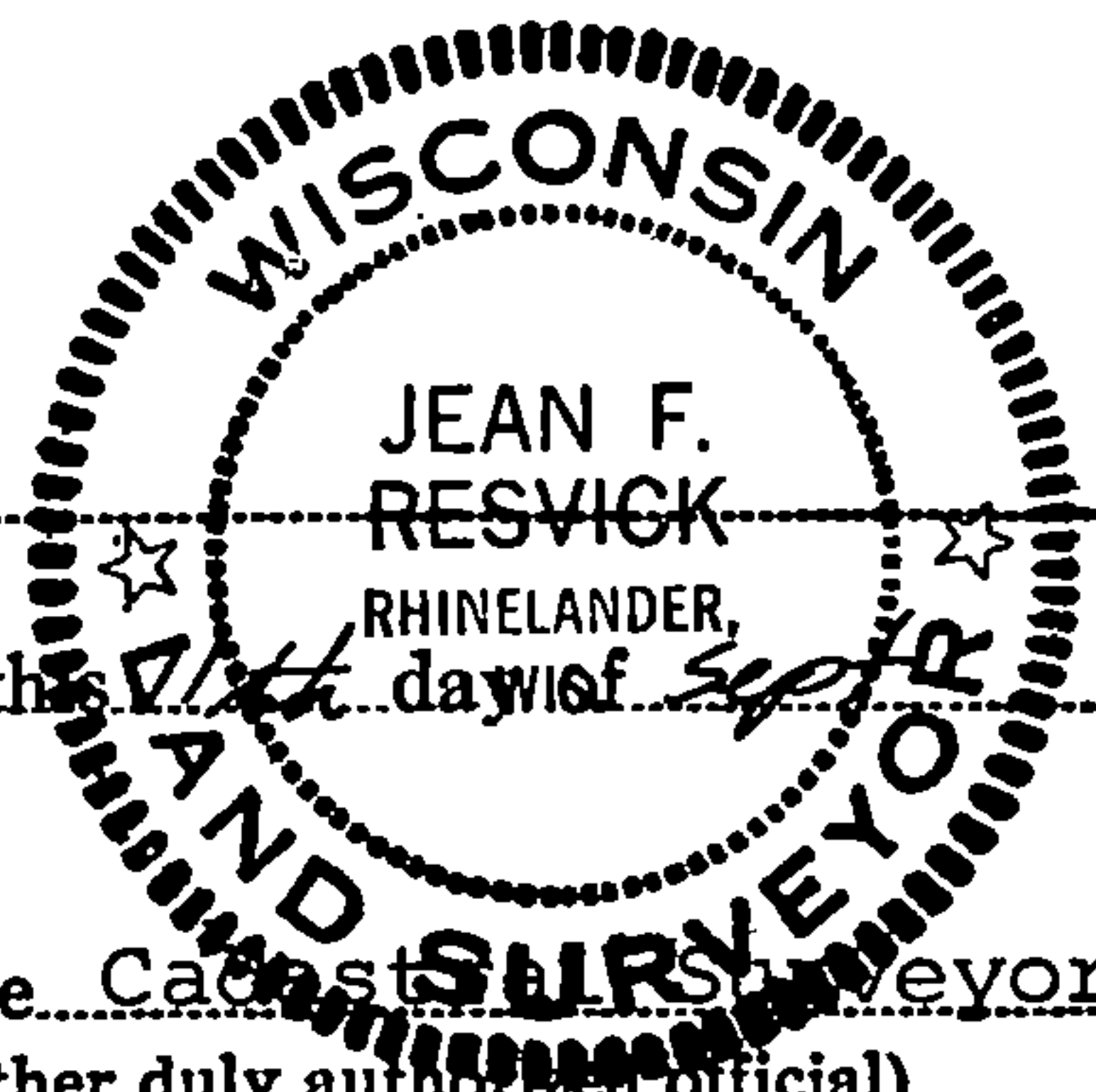

G 13

U.S. PUBLIC LAND SURVEY MONUMENT RECORD

Index No. G-13

State of Wisconsin }  
County of Forest } ss.

I, Gary L. Pisoni, do hereby  
certify that on the 12th day  
of December, 1994, I found  
evidence of the West Quarter  
corner of Section 10  
Township 37, North, Range  
15 East, Fourth Principal Meridian,  
as described hereon; and that from this evidence  
I established a new monument and accessories  
as described hereon to perpetuate the original  
location of this corner.

Resident witnesses:

\_\_\_\_\_  
\_\_\_\_\_  
\_\_\_\_\_

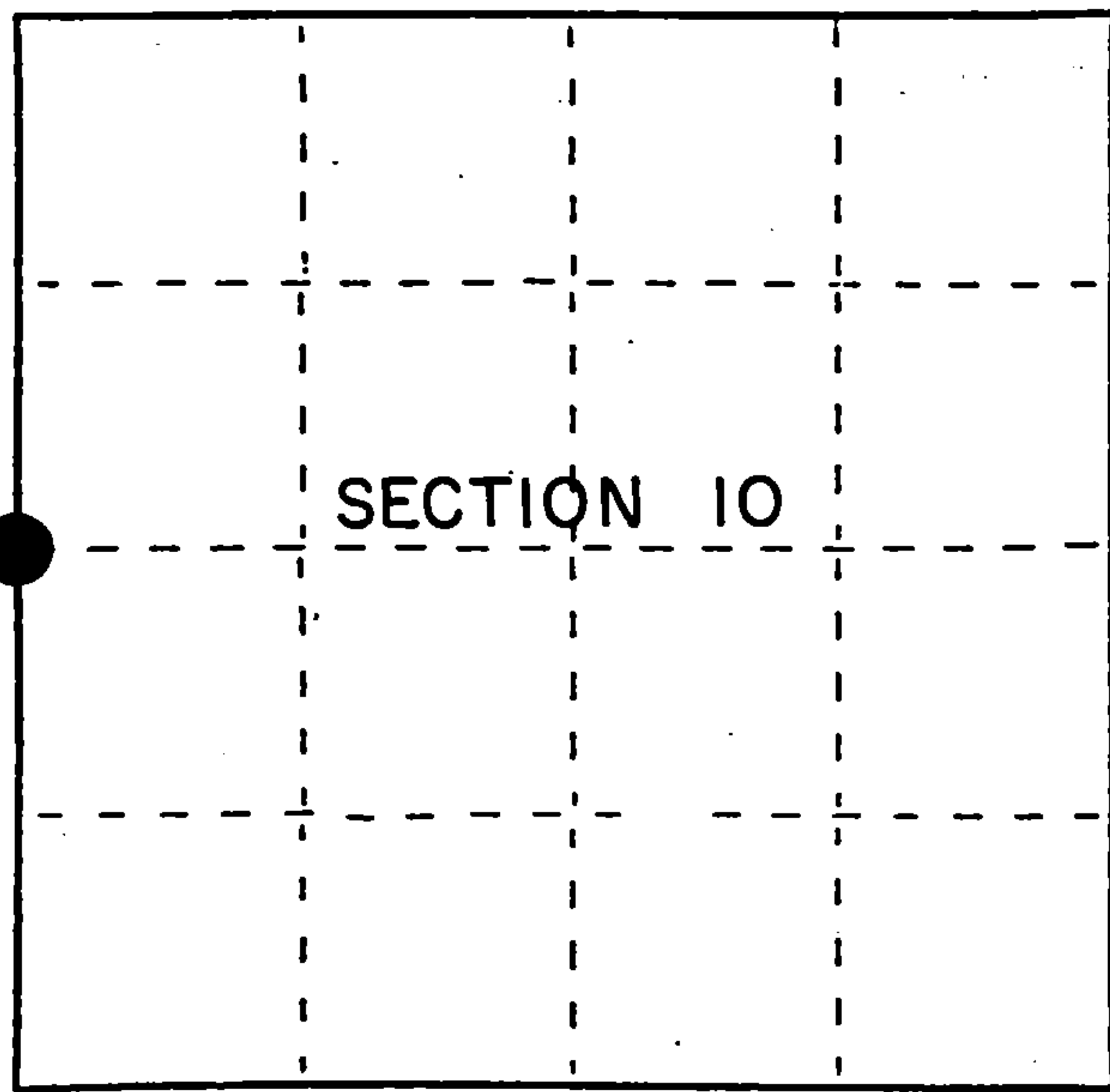

● = Corner monument restored.

History of original corner establishment:  
Original Government Survey in 1865 by J.L. Nowlin. At 40.00 chains, set Quarter Section  
Post, from which the following bear; Tamarack, 14", N52°E, 25 lks., Tamarack, 12",  
S18°W, 25 lks.

In 1970, Jean Resvick, RLS, with the Forest Service, found a squared cedar post and original  
bearing tree evidence with scribing. In place of post, set a 2" x 60" galvanized iron pipe,  
with a brass cap stamped to identify the corner. Blazed and scribed the following new bearing  
trees;

Tamarack	4"	N60°E	15.11 feet
Tamarack	5"	S44°W	4.75 feet
Tamarack	5"	N49°W	4.45 feet
Iron Fence Post		Southeast	1.10 feet

Description of corner evidence found:

Found monument and bearing trees as described above;

Tamarack	8"	N60°E	15.11 feet
Tamarack	9"	S34°W	4.61 feet
Tamarack	6"	N49°W	4.32 feet
Iron Fence Post		S27°E	0.75 feet

Description of monument and accessories I established to perpetuate the original location of this corner.  
Blazed and scribed the following new bearing trees; (measurements are taken to a nail in  
side of tree)

Tamarack	8"	S13°E	15.98 feet
Black Spruce	8"	N21°W	11.03 feet
Steel Sign Post		N75°E	1.10 feet

Dated at Iron River, MI, Wis. this 5th day of March, 1995

Signature Gary L. Pisoni Title Land Surveyor Registration No. S-1634  
(County Surveyor, Registered Land Surveyor, or other duly authorized official)

Office of Register of Deeds, County of Forest, I hereby certify that the within  
instrument was filed in this office for record on the 20th day of March, 1997  
at 1:30 o'clock P M.

\_\_\_\_\_  
(Register of Deeds)  
By Gail Jankiewicz Deputy

FORM NO. 985-A

H.C. Miller Company  
Madison, Wisconsin

Stock No. 26273

158124

43715092000



- (e) Describe any material discrepancy between the location of the corner as restored or reestablished and the location of that corner as previously restored or reestablished by distance and direction. Show the discrepancy on the plan view drawing under (d), above. Show the distances between the corner as previously restored or reestablished and (1) the corner as restored or reestablished, and (2) to at least 2 of the witness monuments shown on the drawing in (d), above.

None

- (f) Was the corner restored through acceptance of (1) an obliterated evidence location, or, (2) a found perpetuated location?

Restored through acceptance of a found perpetuated location.

- (g&h) Was the corner reestablished through lost corner proportionate methods? If so, show the method, including the directions and distances to other public land survey corners used as evidence or used for proportioning in determining the corner location?

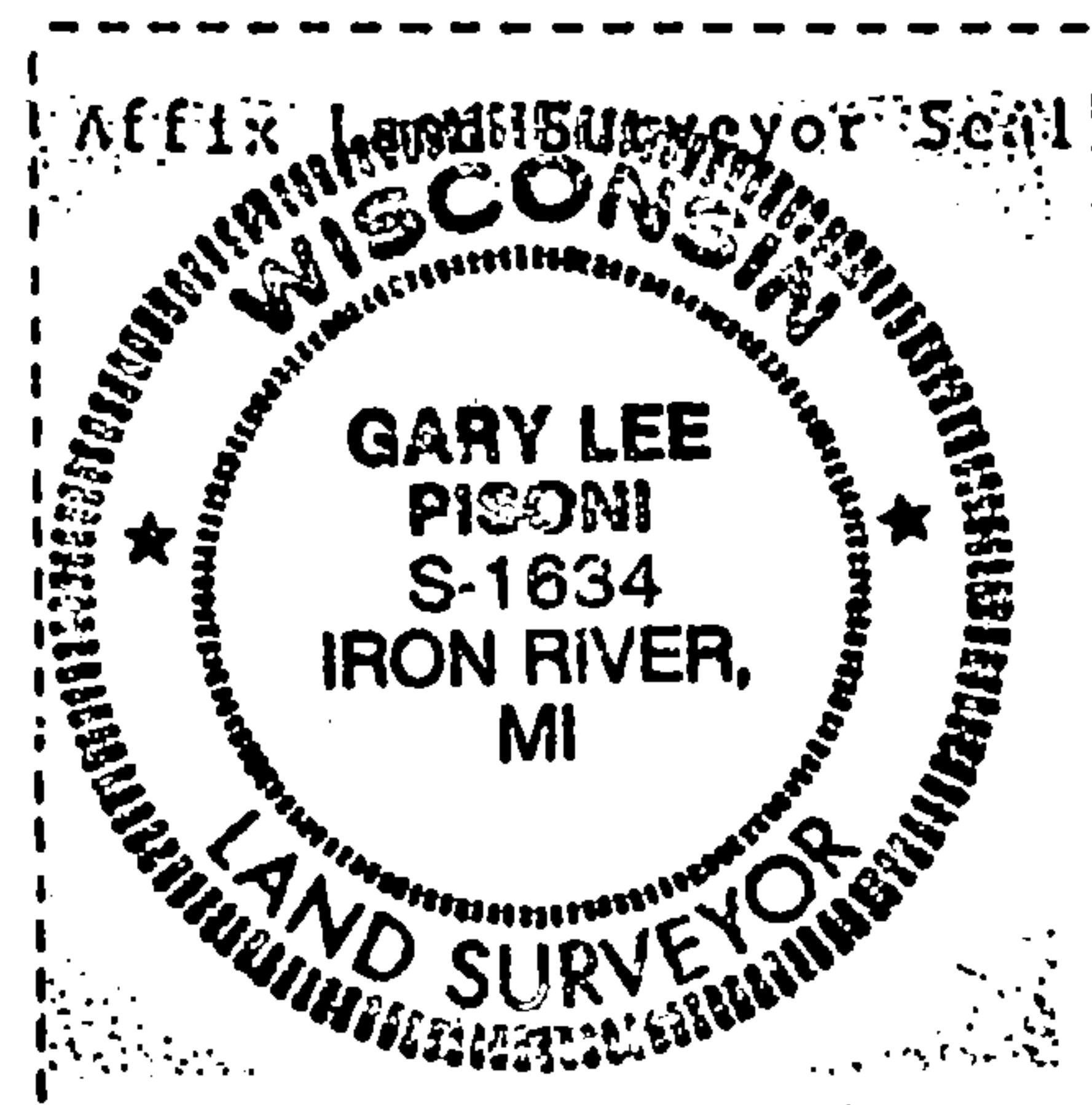
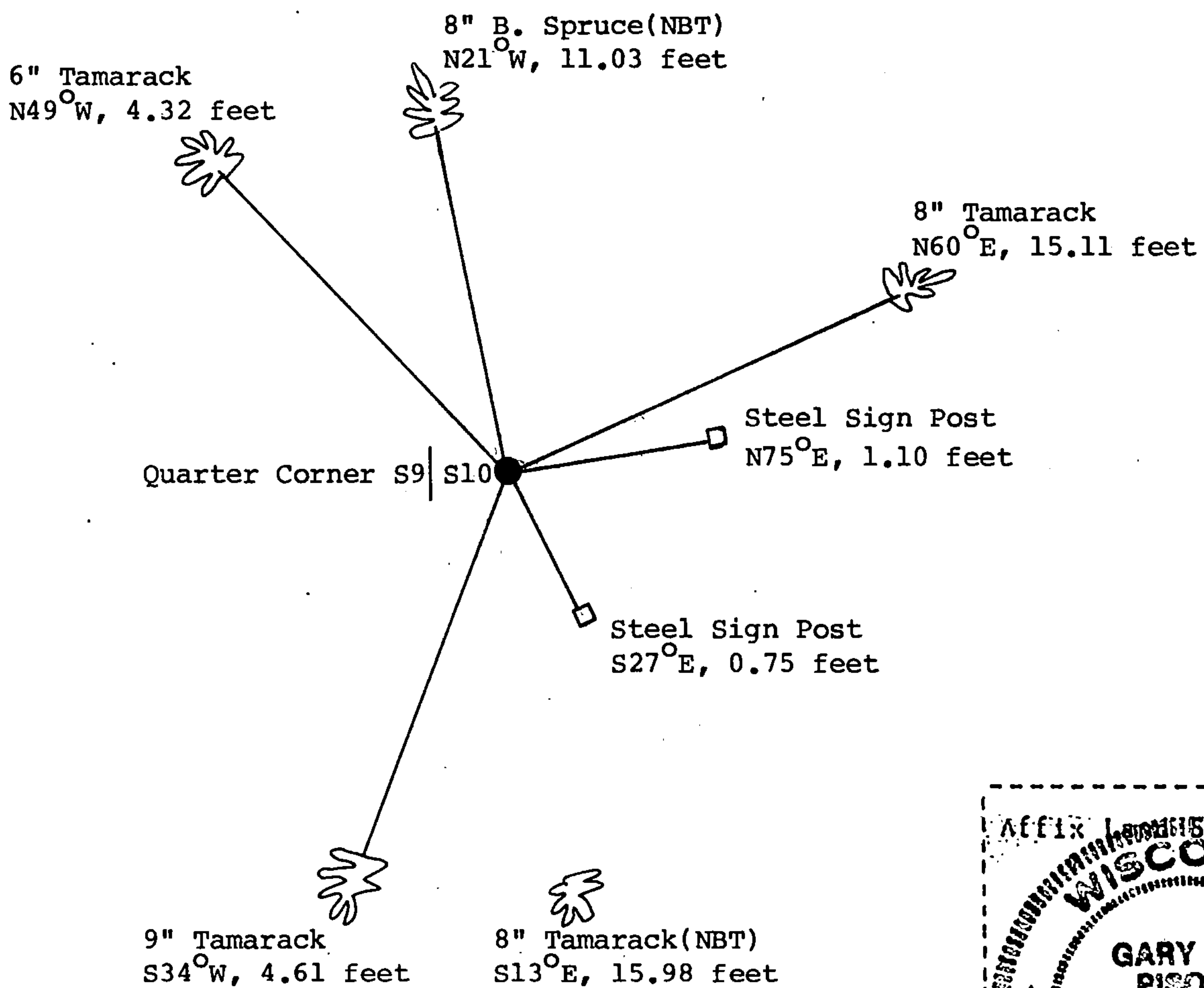

- (i) I, Gary L. Pisoni  
(type or print name) certify that the corner location shown on this record was determined by me or under my direction and control and that this U.S. Public Land Survey Monument Record is correct and complete to the best of my knowledge and belief.

Signature

Date

9-23-95