

CERTIFIED LAND CORNER RESTORATION

Index No. **E-1313**

State of Wisconsin }
County of Forest } ss.

I Daniel K. Pleoger, do hereby
certify that on the 20 day
of October, 19 81, I ~~was~~
Est. ~~XXXXXX~~ the Quarter
corner of Sections 15 & 16
Township 37, North, Range
15 East, Fourth Principal Meridian,
as described hereon; and that from this evidence
I established a new monument and accessories
as described hereon to perpetuate the original
location of this corner.

Resident witnesses:

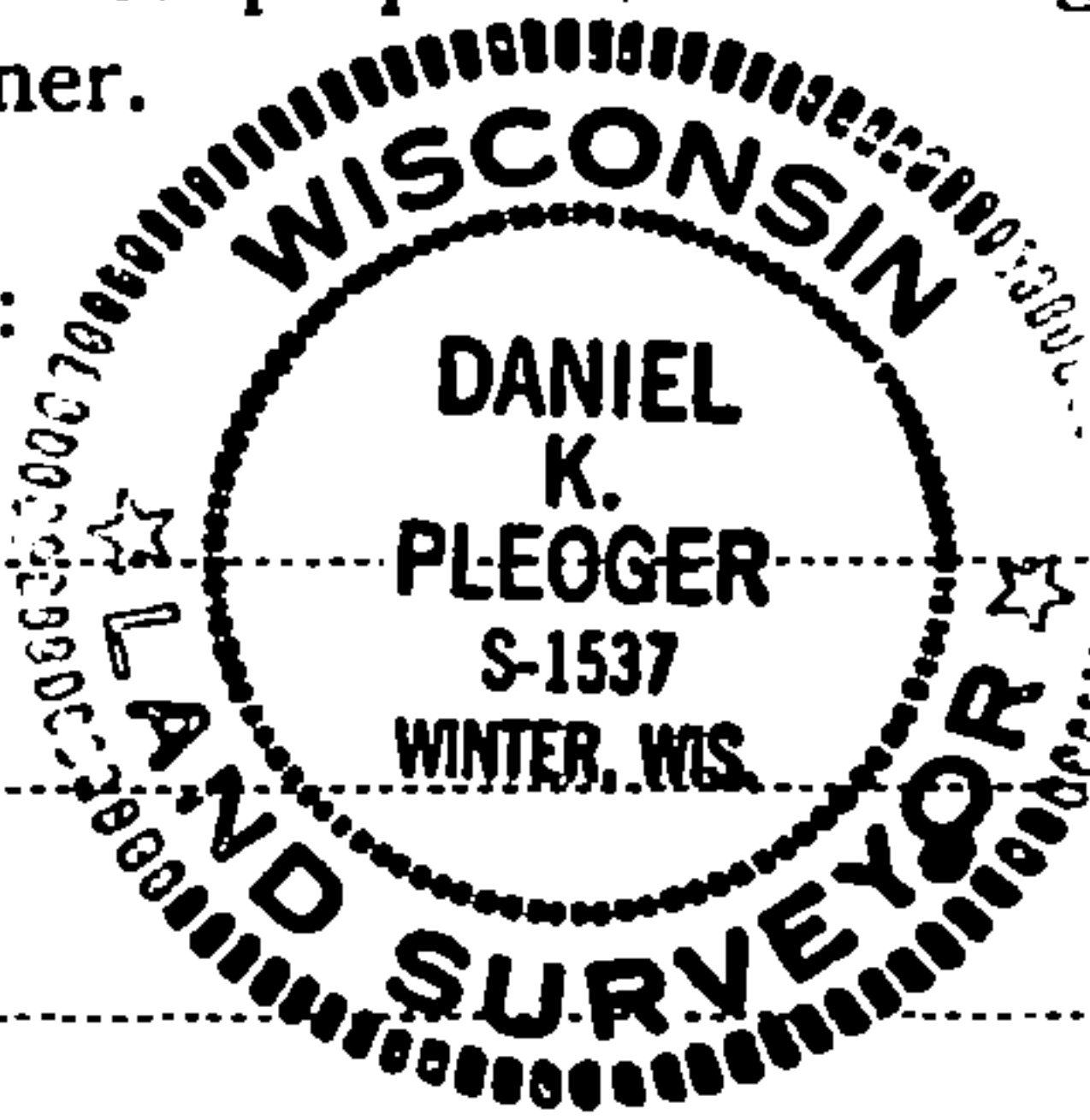

T37N

R15E

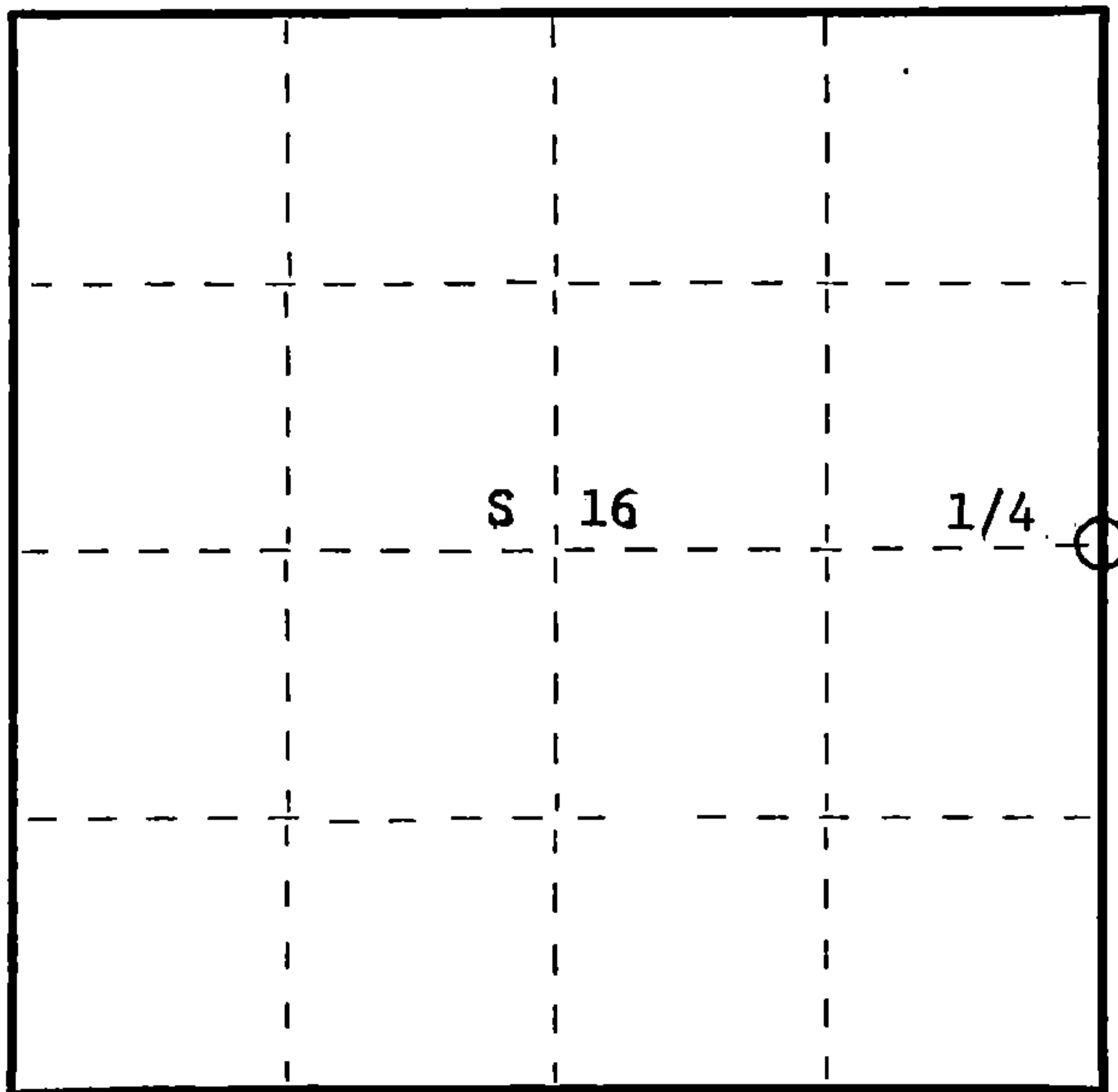

○ = Corner monument restored.

History of original corner establishment:

Original corner established by James Nowlin, Gov. Deputy Surveyor in 1865 from
which spruce 10" bears S38W 30 lks and spruce 6" bears N28W 15 lks.

Description of corner evidence found:

Total distance from section corner 9, 10, 15, 16 to section corner 15, 16, 21, 22 is
5213.724 ft. at bearing NO-07-55W.

Set 1/4 corner 2606.862 ft. intermediate

Description of monument and accessories I established to perpetuate the original location of this corner.

Set a 2½" aluminum A-1 Federal monument with alloy cap stamped:

Monument projects 8" above ground

Marked NBTs

Black spruce 4" N10W 19.50 ft.

Cedar 10" N77W 32.44 ft

Black spruce S14E 17.85 ft.

Scribed 1/4 - B.T.

T37N R15E

1/4 16 | 15

S1537 - 1981

Dated at Rhineland, Wis., this 3 day of November, 19 81

Signature Daniel K. Pleoger Title Registered Land Surveyor Registration No. 1537
(County Surveyor, Registered Land Surveyor, or other duly authorized official)

Office of Register of Deeds, County of Forest, I hereby certify that the within
instrument was filed in this office for record on the 9th day of April, 19 82
at 11:00 o'clock A. M.

(Register of Deeds)

DOCUMENT NO. **121396**

By _____ Deputy

U.S. PUBLIC LAND SURVEY MONUMENT RECORD

Index No. L-13

State of Wisconsin

County of Forest ss.

I Gary L. Pisoni, do hereby certify that on the 16th day of March, 1994, I found evidence of the East Quarter corner of Section 16 Township 37, North, Range 15 East, Fourth Principal Meridian, as described hereon; and that from this evidence I established a new monument and accessories as described hereon to perpetuate the original location of this corner.

Resident witnesses:

History of original corner establishment:

Original Government Survey in 1865 by J.L. Nowlin. North between Sections 15 and 16, at 40.00 chs. set Quarter Section Post from which the following bear; Spruce, 10", S38°W, 30 lks., Spruce, 6", N28°W, 15 lks.

On 10-20-81, Dan Pleoger a Registered Land Surveyor, restored the corner position at mid-point and on line between opposing Section Corners. At the corner position set a 2 1/2 inch dia. Federal Monument stamped; T37N R15E, 1/4, S15, S16, 1981, S-1537. Blazed and scribed the following bearing trees;

Description of corner evidence found:

B. Spruce	4"	N10°W	19.50'
Cedar	10"	N77°W	32.44'
B. Spruce		S14°E	17.85'

Found Forest County Monument as described above, and the following bearing trees;

Cedar	13"	N81°W	32.05 feet
-------	-----	-------	------------

Description of monument and accessories I established to perpetuate the original location of this corner.

Blazed and scribed the following new bearing trees; (Measurements are taken to a nail in side of tree)

Tamarack	7"	N04°E	42.83 feet
Black Spruce	5"	S34°E	31.11 feet
Hemlock	13"	S02°W	101.85 feet
Steel Sign Post		East	0.82 feet

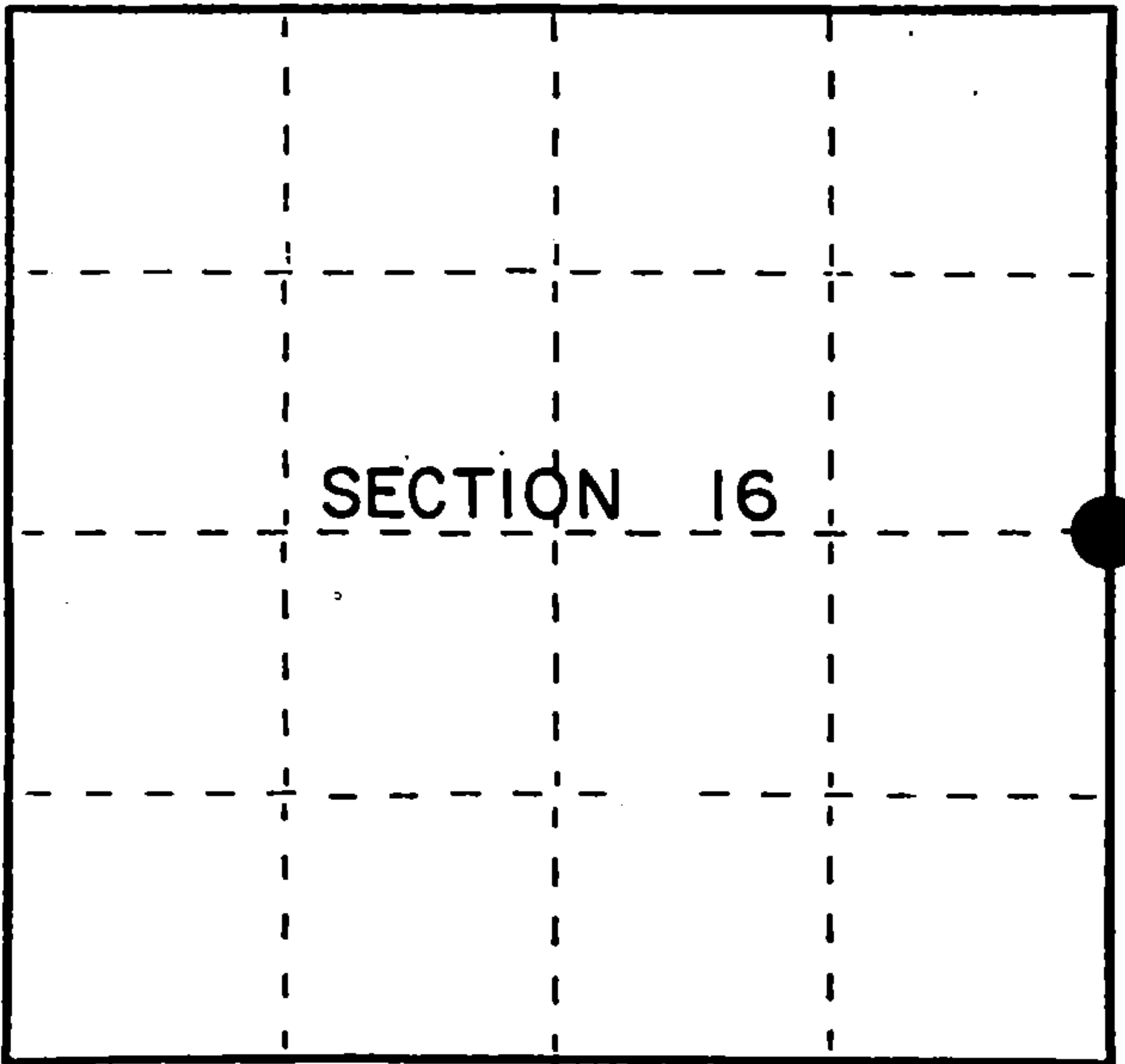

● = Corner monument restored.

Dated at Iron River, MI, this 5th day of May, 1994

Signature Gary L. Pisoni Title Land Surveyor Registration No. S-1634
(County Surveyor, Registered Land Surveyor, or other duly authorized official)

Office of Register of Deeds, County of Forest, I hereby certify that the within instrument was filed in this office for record on the 20th day of March, 1994 at 1:30 o'clock P. M.

(Register of Deeds)
By [Signature] Deputy

FORM NO. 985-A
H.C. Miller Company
Madison, Wisconsin

Stock No. 26273

158133

43715162000

(e) Describe any material discrepancy between the location of the corner as restored or reestablished and the location of that corner as previously restored or reestablished by distance and direction. Show the discrepancy on the plan view drawing under (d), above. Show the distances between the corner as previously restored or reestablished and (1) the corner as restored or reestablished, and (2) to at least 2 of the witness monuments shown on the drawing in (d), above.

None

(f) Was the corner restored through acceptance of (1) an obliterated evidence location, or, (2) a found perpetuated location?

Restored through acceptance of a found perpetuated location.

(g&h) Was the corner reestablished through lost corner proportionate methods? If so, show the method, including the directions and distances to other public land survey corners used as evidence or used for proportioning in determining the corner location?

No

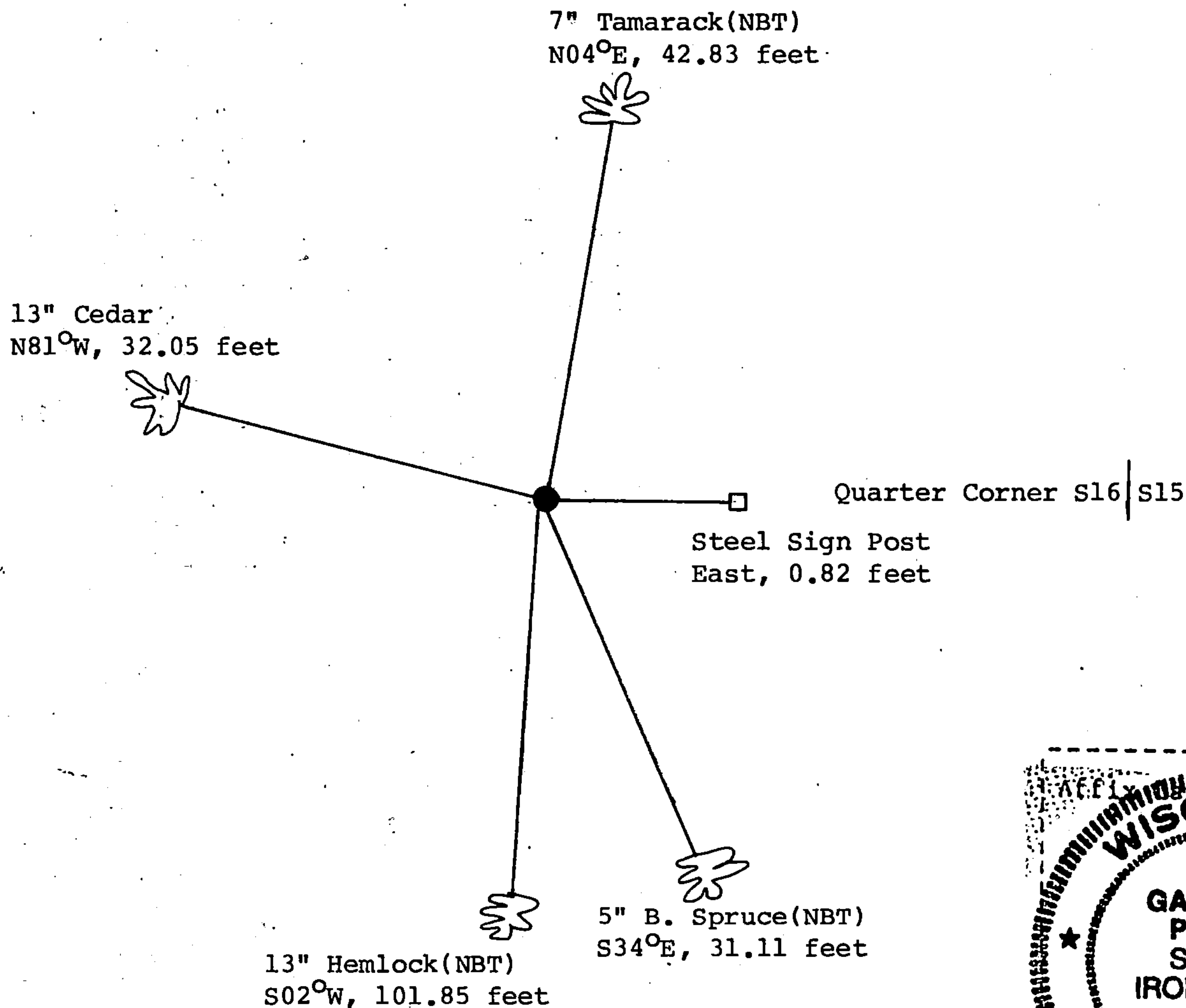

(i) I, Gary L. Pisoni
(type or print name) certify that the corner location shown on this record was determined by me or under my direction and control and that this U.S. Public Land Survey Monument Record is correct and complete to the best of my knowledge and belief.

Signature

Date

