

CERTIFIED LAND CORNER RESTORATION

Index No. **T11**

State of Wisconsin }
County of Forest } ss.

I Philip T. Hansen, do hereby
certify that on the 13th day
of September, 1976, I found
evidence of the C 1/4
corner of Section 28
Township 37, North, Range
15 East, Fourth Principal Meridian,
as described hereon; and that from this evidence
I established a new monument and accessories
as described hereon to perpetuate the original
location of this corner.

Resident witnesses:

Glen Barker

Jim Claflin

Herb Wagoner

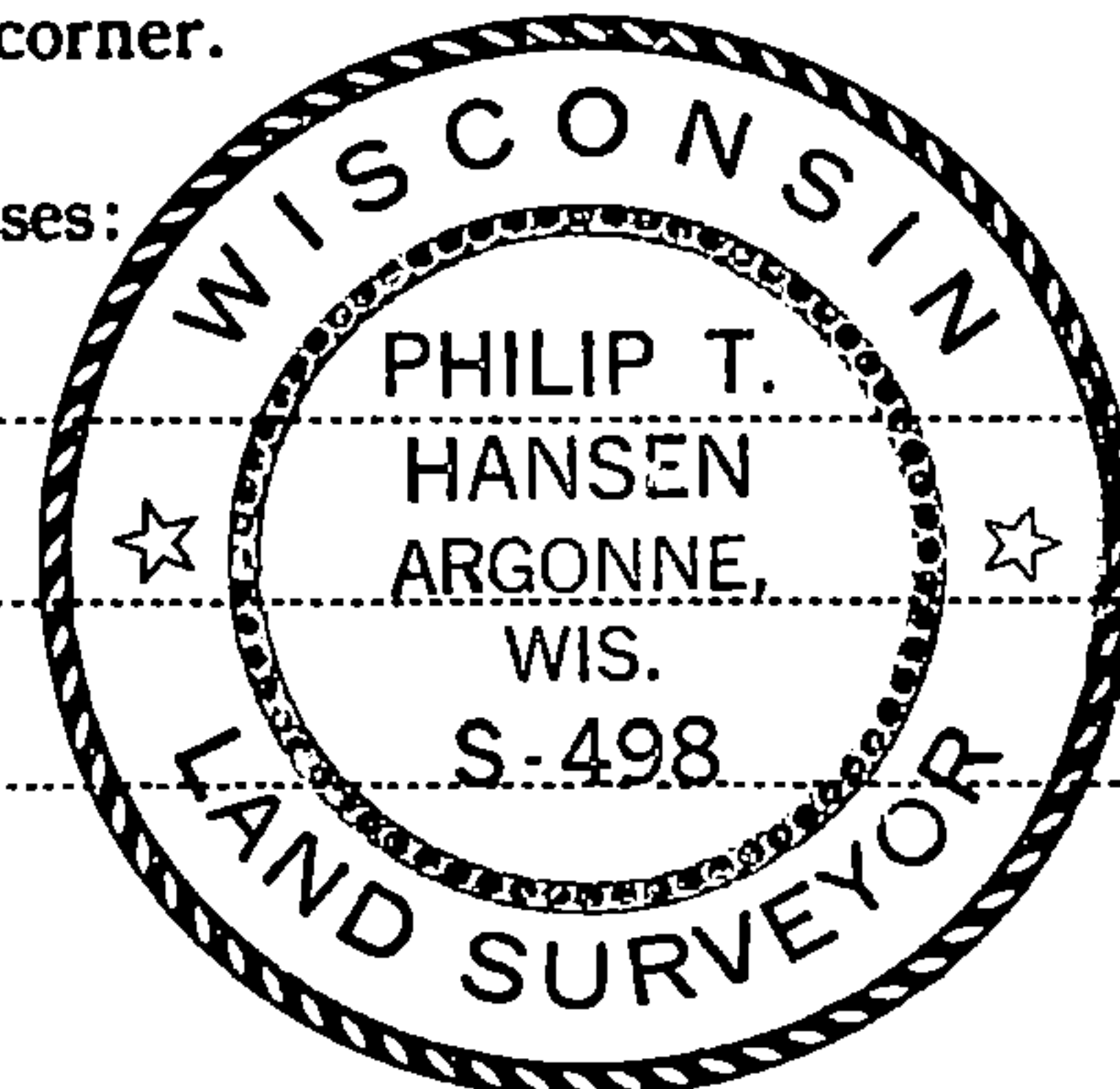

T37N R15E

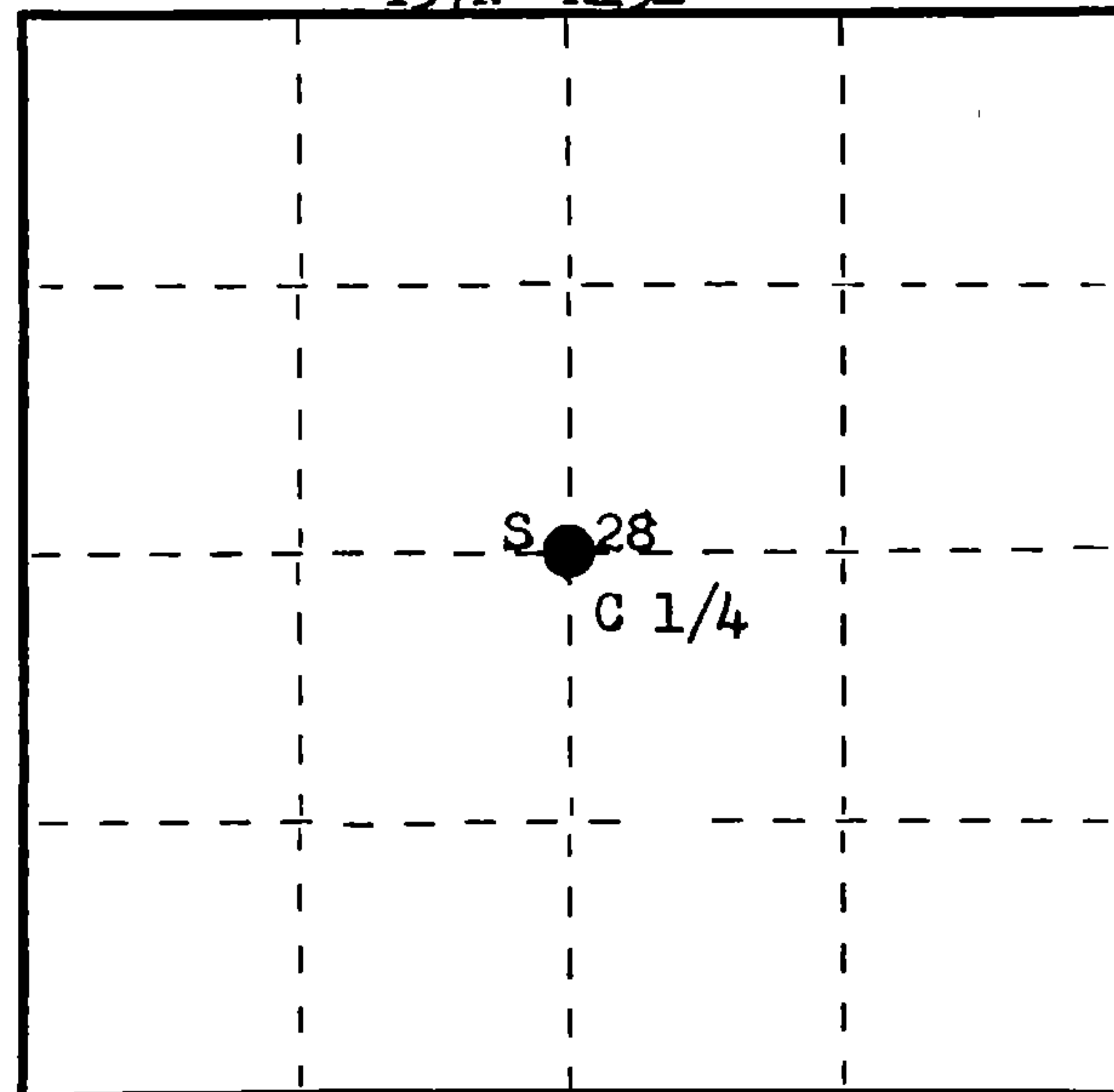

○ = Corner monument restored.

History of original corner establishment:

Origin of this C 1/4 corner is unknown. Corner has been in existence for many years and recognized by adjacent land owners as the corner.

Description of corner evidence found:

Recovered a 3" iron pipe with concrete in the upper half, projecting 18" above ground. Corner sets in a wet alder swamp. This area had once been flooded from a beaver dam. No BT's were in evidence. Corner sets 2 chains north of Highway U.S. 8.

Description of monument and accessories I established to perpetuate the original location of this corner.

Replaced 3" iron pipe with 2 1/2" Berntsen A-1 Federal Monument, stamped.

No trees available for BT's.

Set two 1 1/2" iron pipes for reference marks.

#1 - North 25 links, projects 2 1/2' above ground.

#2 - East 20 links, projects 2 1/2' above ground.

Monument and reference marks painted blue.

T37N R15E
C 1/4 S 28
S498-1976

Dated at Rhineland, Wis., this 16th day of September, 1976.

Signature Philip T. Hansen Title Registered Land Surveyor Registration No. S-498
(County Surveyor, Registered Land Surveyor, or other duly authorized official)

Office of Register of Deeds, County of Forest, I hereby certify that the within
instrument was filed in this office for record on the 9th day of November, 1976
at 3:45 o'clock P. M.

Eugene Staszynski
(Register of Deeds)

DOCUMENT NUMBER **110501**

By _____ Deputy