

CERTIFIED LAND CORNER RESTORATION

Index No. 123

State of Wisconsin } ss.
County of Forest

I Philip T. Hansen, do hereby
certify that on the 22nd day
of December, 1975, I found
evidence of the Quarter
corner of Section 6 and 31
Township 36 and 37, North, Range
15 East, Fourth Principal Meridian,
as described hereon; and that from this evidence
I established a new monument and accessories
as described hereon to perpetuate the original
location of this corner.

Resident witnesses:

Glen Barke

Jim Claflin

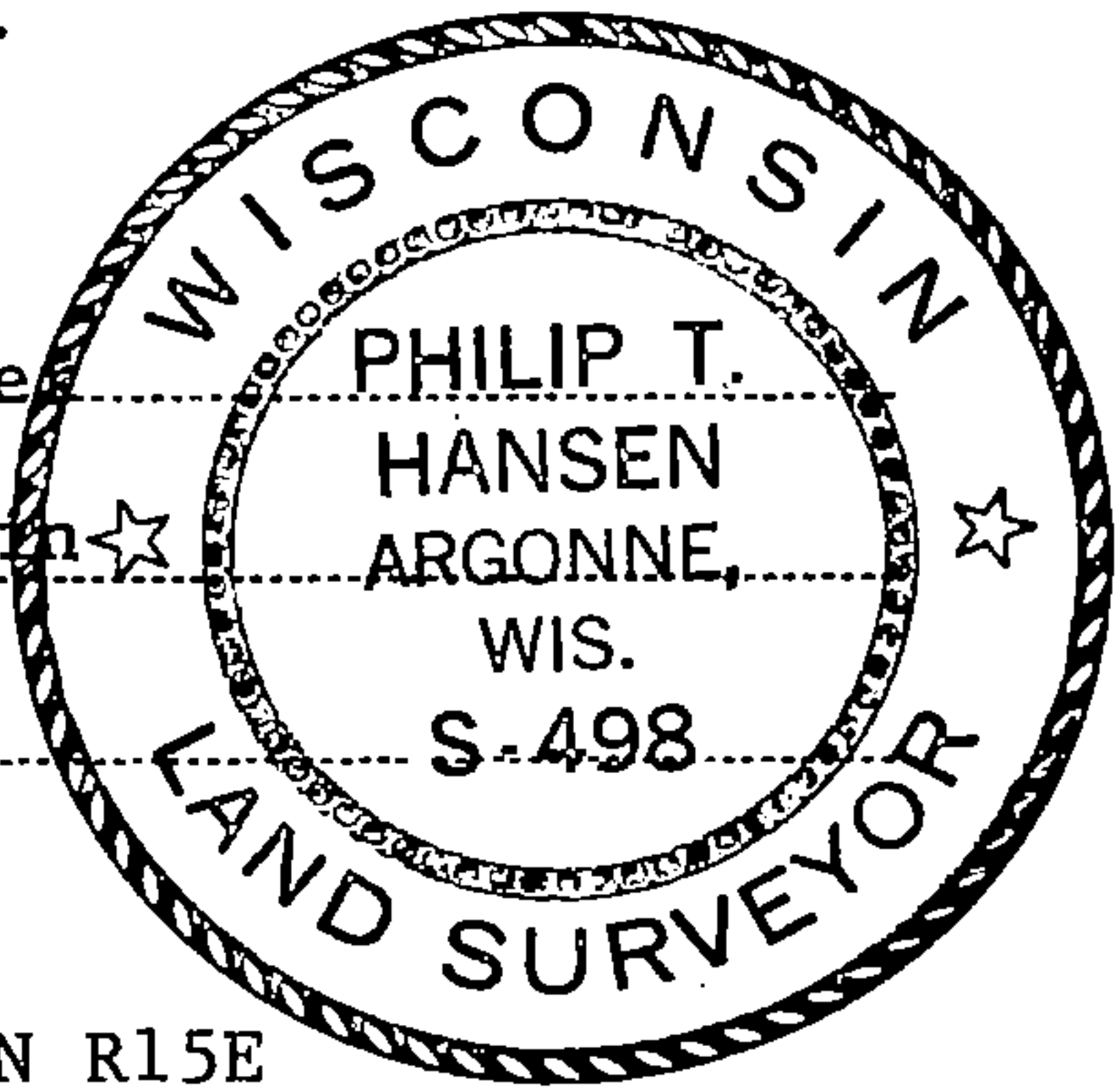

T37N R15E

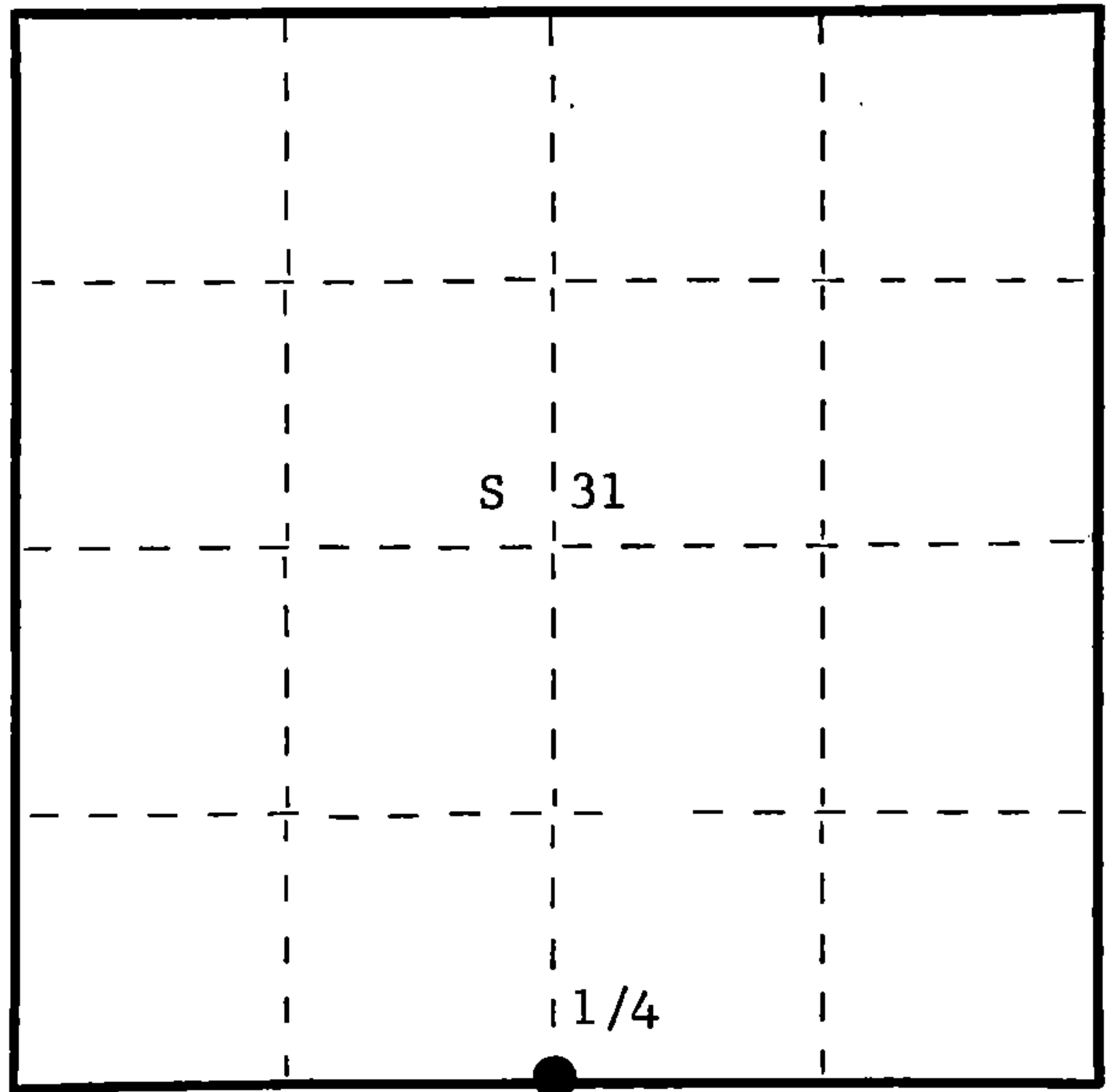

○ = Corner monument restored.

History of original corner establishment: Original corner established by A. Curtiss, Deputy
Surveyor, in 1857 from which sugar 14" bears N55°W, 27 links and sugar 12" bears
S35°W, 5 links.

Corner recovered by H.C. Lawrence, Registered Land Surveyor, in 1945. Found 20"
birch, BT N70°W, 32 links.

Description of corner evidence found: Did not recover any post at this corner. Did recover
yellow birch BT. The face of this BT had been chopped out years ago. Chopped out
additional face but could not find any. Recovered old location tag indicating corner
to be S75°W, 1-1/2 poles. Old property lines indicate this to be the 1/4 corner.

Description of monument and accessories I established to perpetuate the original location of this corner.
Set 2-1/2" Berntsen, A-1 Federal Monument at point 32 links, S37°E of old birch BT.
This checks with location indicated on old location tag.
Pipe projects 18" above ground. Cap stamped -

NBT's - Sugar 7" N78°W 16.7 links
Sugar 8" S30°W 35.7 links

BT's faced but not scribed.
Pipe, OBT, and NBT's painted blue.

S498
T37N R15E
S 31
1/4 S 6
T36N R15E
1975

Dated at Argonne, Wis., this 6th day of January, 1976

Signature Philip T. Hansen Title Registered Land Surveyor Registration No. S-498
(County Surveyor, Registered Land Surveyor, or other duly authorized official)

Office of Register of Deeds, County of Forest, I hereby certify that the within
instrument was filed in this office for record on the 4th day of February, 1976
at 4:00 o'clock P. M.

Eugene Stategny
(Register of Deeds)
By Deputy

DOCUMENT NUMBER 108698

FORM 985 H. C. MILLER CO., MILWAUKEE

43715310020

OK 16
Forest Co.

DOCUMENT NUMBER
132212

U. S. PUBLIC LAND SURVEY MONUMENT RECORD

INSTRUCTIONS: This record shall show the location of the corner and shall include all of the following nine elements (a through i).

- (a) Identify the corner by reference to the U.S. public land survey system.
○ = Corner monument restored.

Quarter corner to Sections 31 and 6, T.36-37N., R.15E.

REGISTER'S OFFICE
Forest County, Wis.
Received for record this 26th day
of February A.D. 1987 at
10:45 o'clock A.M. and recorded
in Vol. CORNER RESTORATIONS
page A-3
Paul Aschenbrenner
Register of Deeds

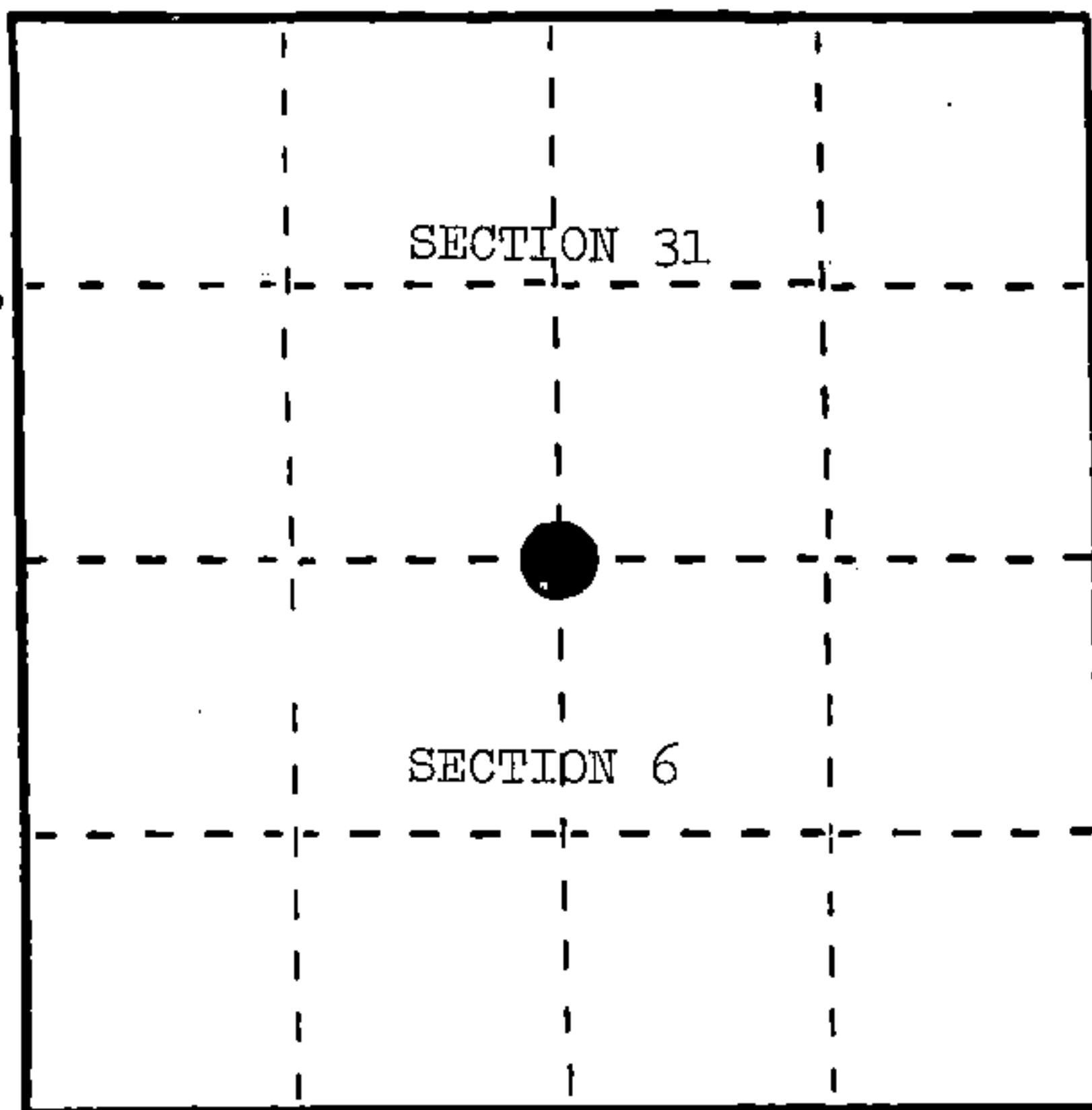

- (b) Describe any record evidence, monument evidence, occupational evidence, testimonial evidence or any other material evidence you considered, and whether the monument was found or placed.
In 1857, Artemas Curtis set wood post with the following BTs: Sugar, 14", N.55°W., 27 links; Sugar, 12", S.35°W., 5 links.
In 1935, Henry Blum "874" placed an Ironwood post and put location tag on 10" Basswood, N.75°E., 6.6 feet, as an approximate corner.
October 28, 1985, Milo Stefan found Forest County cap as placed by S-498, Phil Hansen; new BTs: Sugar, 10", S.2°W., 23.90 feet and Sugar, 8", N.78°W., 11.27 feet; old Yellow Birch snag with large open face, 20", N.38°W., 21.9 feet; location tag, N.75°E., 6.6 feet on 16" Basswood. Stefan did not accept corner as per Hansen for the following reasons: First, distance across the north side of Section 6 did not fit reasonably well for a line run by Curtis on the township line. Second, proof of the 16" Tamarack line tree 15.82 chains westerly places Hansen's corner greatly in error. Last, by placement of the corner in its proportionate measure using the Tamarack line tree, it better fits the original 1857 survey.
- (c) In the plan view drawing below, provide reference ties to at least 4 witness monuments, or, if the location is within a municipality, to at least 2 witness monuments. (Witness monuments shall be made of concrete, natural stone, iron or other equally durable material.)
Describe witness monuments.
- (d) Show a plan view drawing depicting the relevant monuments and reference ties which is sufficient in detail to enable accurate relocation of the corner monument if the corner monument is disturbed. Indicate north.

1. 2" x 36" aluminum monument in a mound of stone.
2. Sugar, 6", N.57°E., 29.51 feet
3. Sugar, 6", S.71°E., 38.44 feet
4. Sugar, 6", N.47°W., 29.24 feet
5. Steel Sign Post, East, 1.2 feet
6. County Monument, S.72°W., 105.38 feet

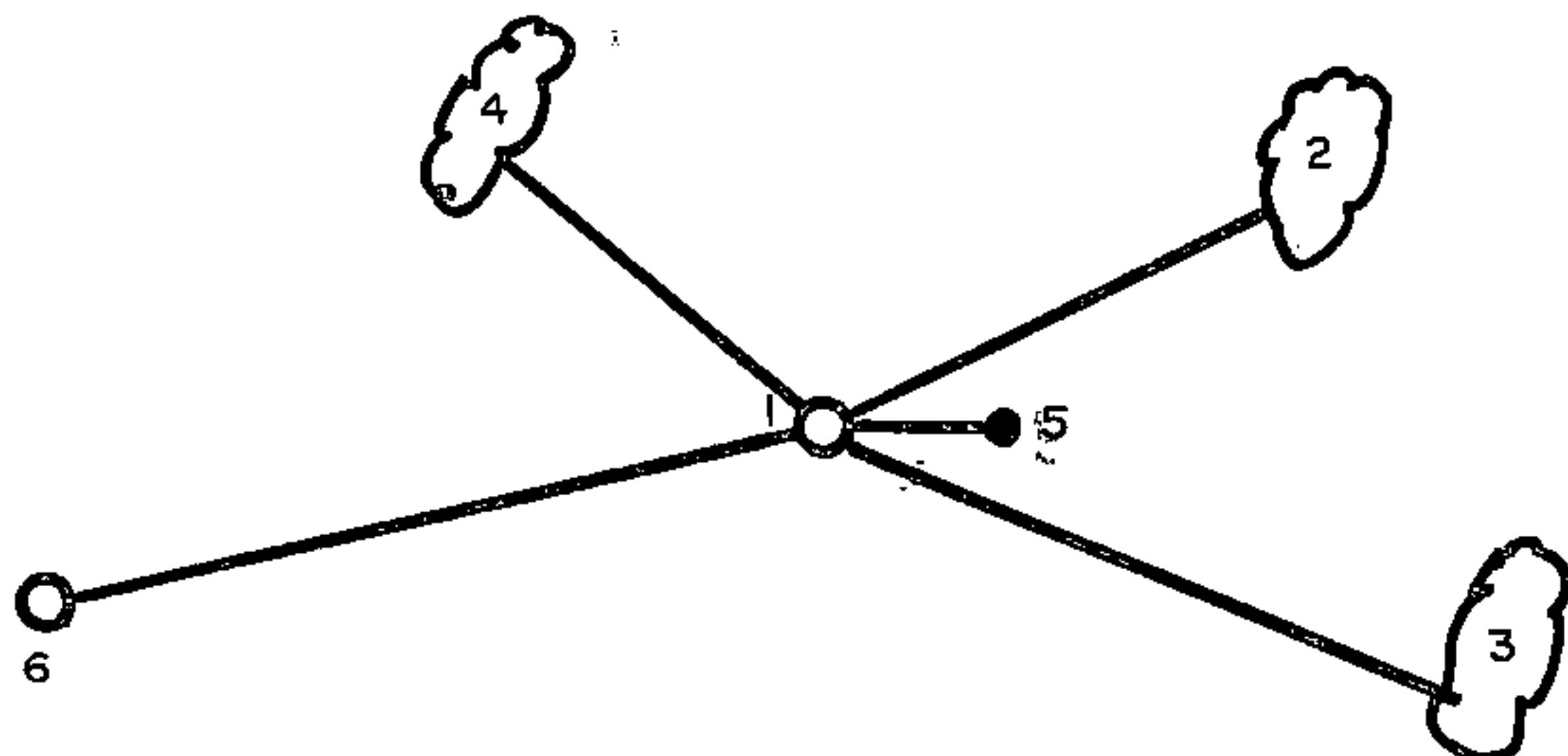

- (e) Describe any material discrepancy between the location of the corner as restored or reestablished and the location of that corner as previously restored or reestablished by distance and direction. Show the discrepancy on the plan view drawing under (d), above. Show the distances between the corner as previously restored or reestablished and (1) the corner as restored or reestablished, and (2) to at least 2 of the witness monuments shown on the drawing in (d); above.

None.

- (f) Was the corner restored through acceptance of (1) an obliterated evidence location, or, (2) a found perpetuated location?

No.

- (g&h) Was the corner reestablished through lost corner proportionate methods? If so, show the method, including the directions and distances to other public land survey corners used as evidence or used for proportioning in determining the corner location?

Yes, line tree west and section corner east.

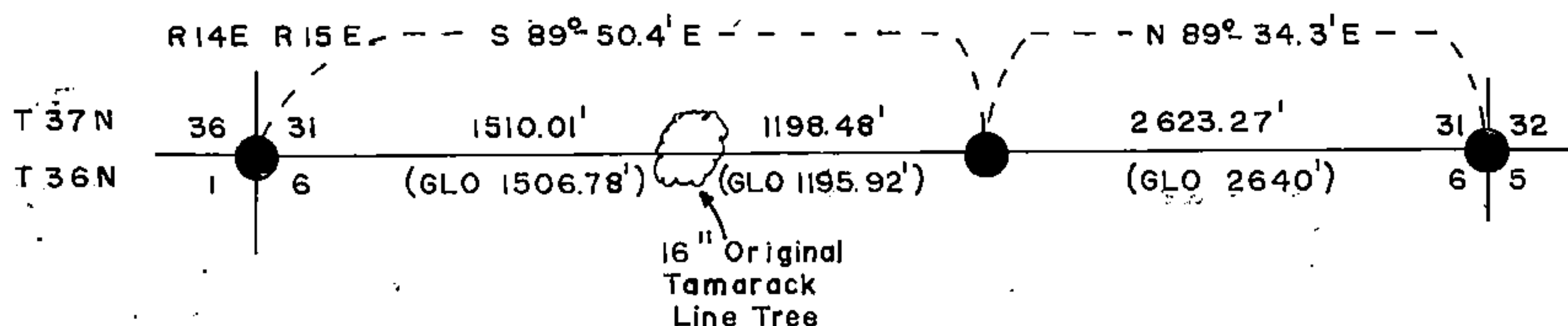

Affix Land Surveyor Seal

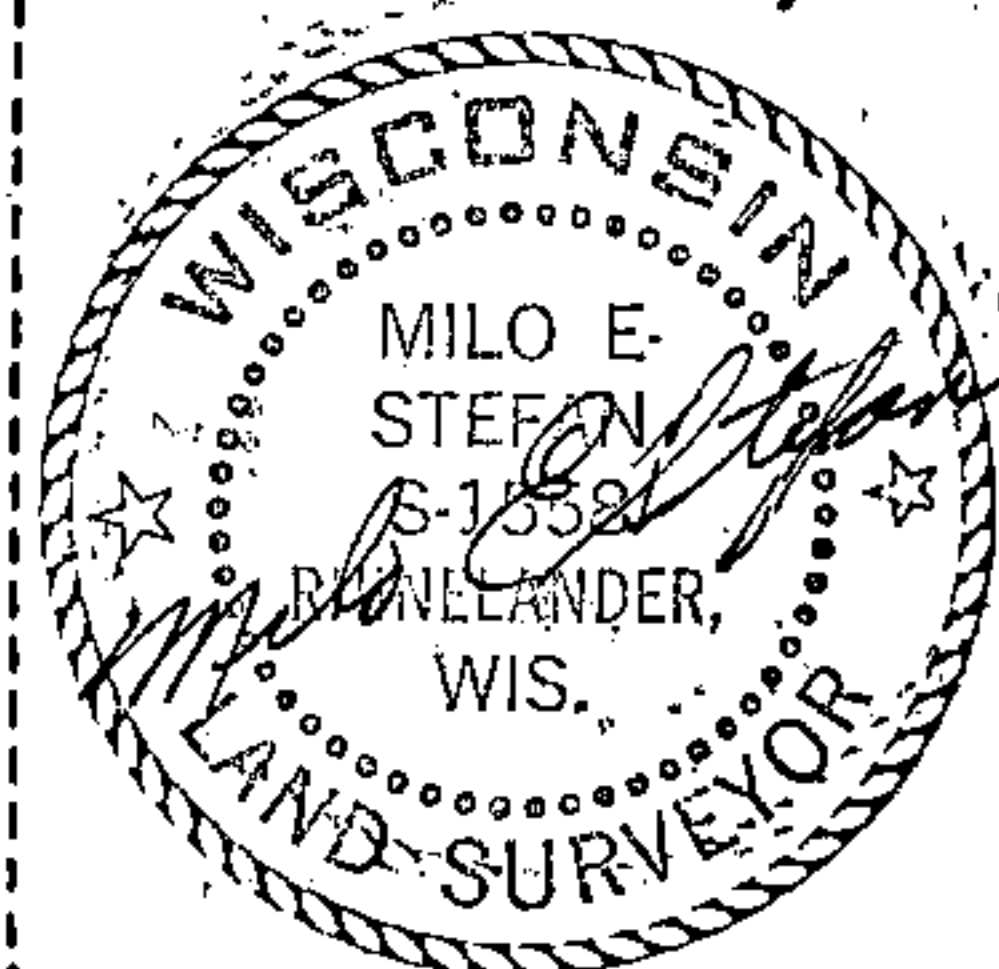

- (i) I, Milo E. Stefan
(type or print name) certify that the corner location shown on this record was determined by me or under my direction and control and that this U.S. Public Land Survey Monument Record is correct and complete to the best of my knowledge and belief.

Milo E. Stefan
Signature

2/16/87
Date