

CERTIFIED LAND CORNER RESTORATION

Index No. **N25**

State of Wisconsin }
County of Forest } ss.

I Philip T. Hansen, do hereby
certify that on the 6th day
of January, 1976, I found
evidence of the Section
corner of S13, 24, 19-18
Township 38
14 and 15, North, Range
as described hereon; and that from this evidence
I established a new monument and accessories
as described hereon to perpetuate the original
location of this corner.

Resident witnesses:

Glen Barker

Jim Claflin

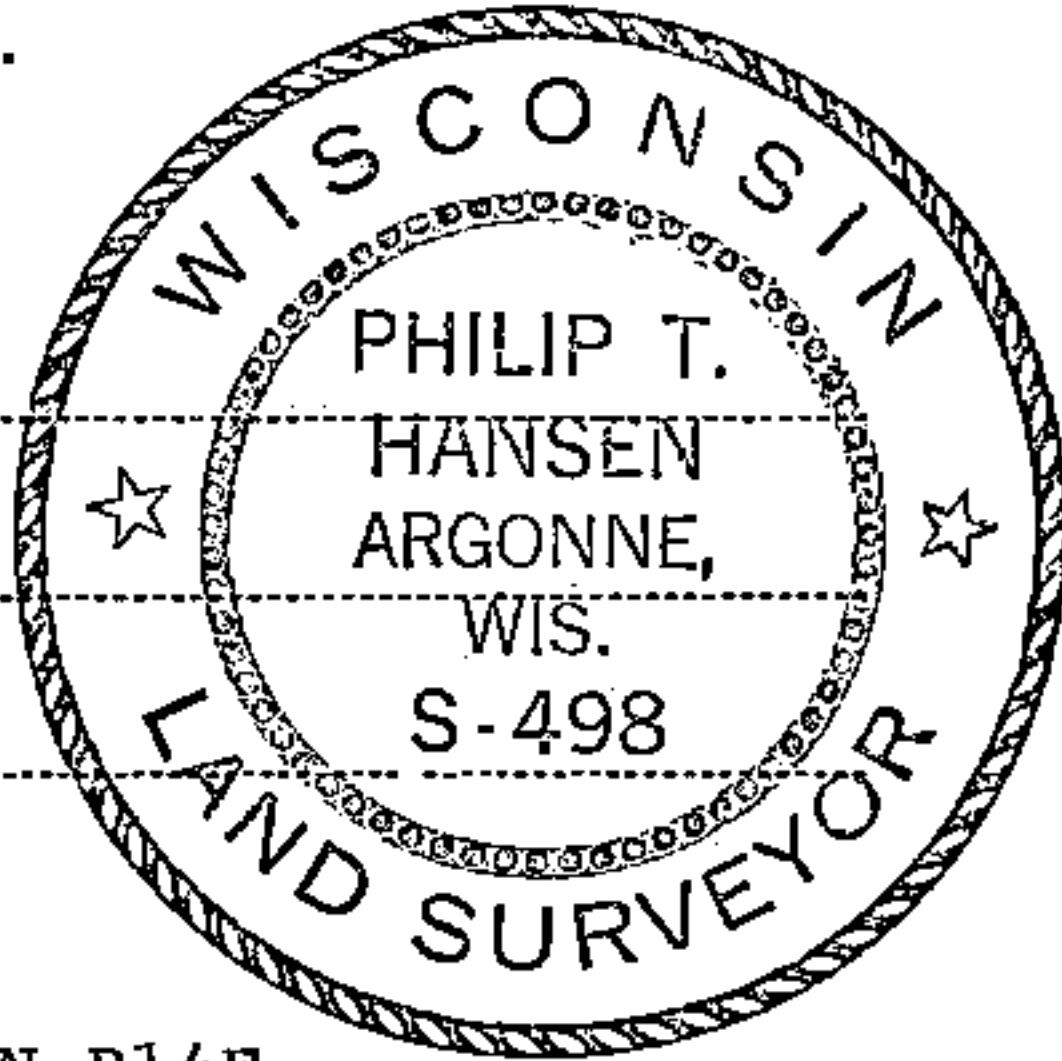

FORM 985 W. C. MILLER CO., MILWAUKEE

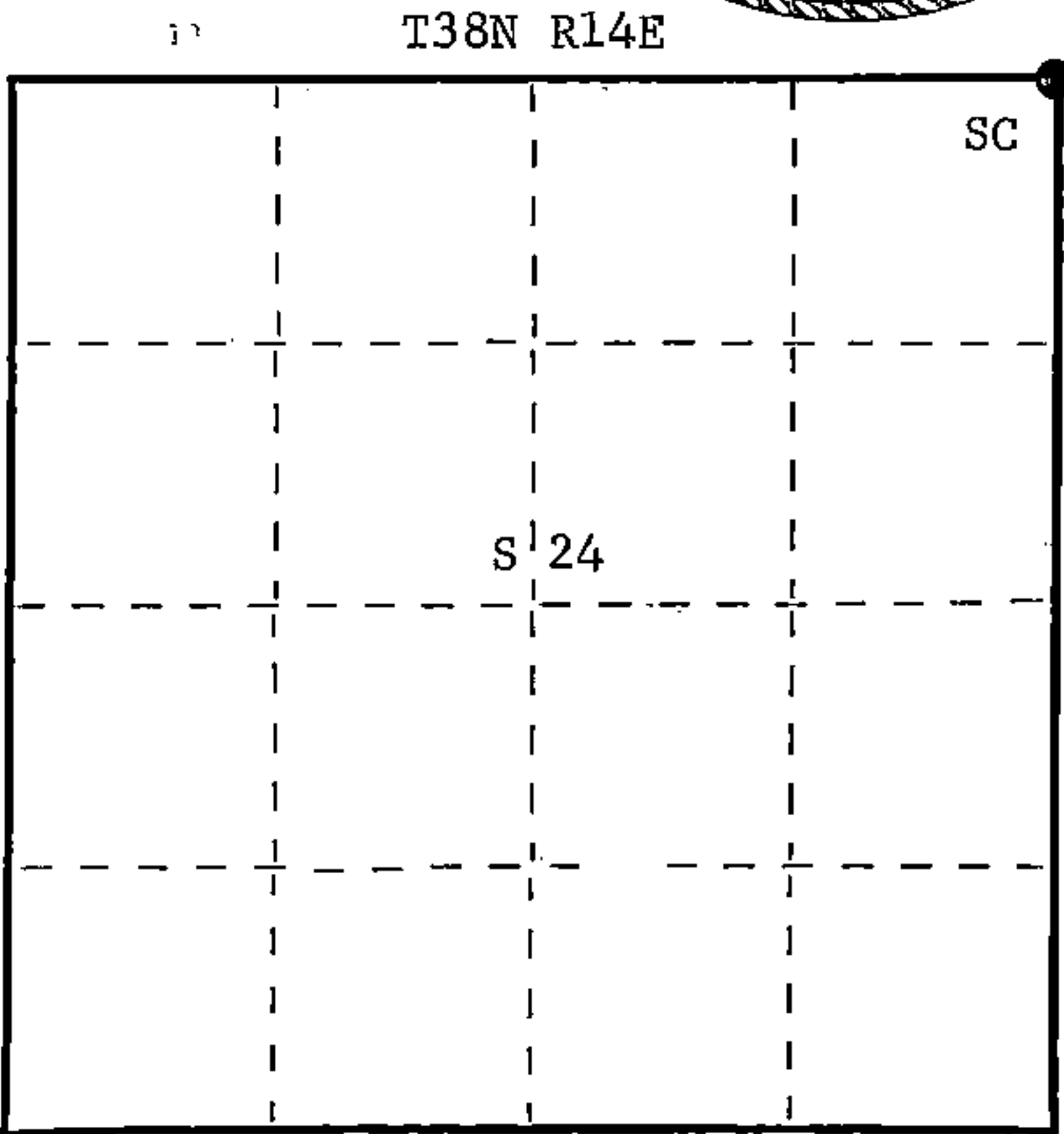

○ = Corner monument restored.

History of original corner establishment: Original corner established by Artemas Curtiss, Deputy Surveyor, in 1857 from which yellow birch 12" bears N44°W, 11 links, yellow birch 10" bears N45°E, 25 links, hemlock 20" bears S48°E, and spruce 14" bears S67°W, 50 links.

Corner recovered by Ray Leigh, Consolidated Forester, during cruising and mapping of this area.

Description of corner evidence found: Recovered 6" squared cedar post in poor condition.
No evidence of OBT's recovered.

Description of monument and accessories I established to perpetuate the original location of this corner.

Replaced 6" squared cedar post with 2-1/2" Berntsen, A-1 Federal Monument, aluminum with magnet installed in cap and base. Pipe projects 18" above ground. Cap stamped - S498 T38N

NBT's - Cedar 7" N54°E 38.8 links scribed SC BT
Cedar 6" N73°W 18 links scribed SC BT
Cedar 8" S14°E 29 links scribed SC BT

R 13 18 R
14 Sec. 24 19 15
E E
1975

Cedar post set beside new pipe.
Pipe, post, and NBT's painted blue.

Dated at Argonne, Wis., this 13th day of January, 1976.

Signature *Philip T. Hansen* Title Registered Land Surveyor Registration No. S-498
(County Surveyor, Registered Land Surveyor, or other duly authorized official)

Office of Register of Deeds, County of Forest, I hereby certify that the within
instrument was filed in this office for record on the 4th day of February, 1976.
at 4:00 o'clock P. M.

Eugene Staszny
(Register of Deeds)
By Deputy

DOCUMENT NUMBER 108701

43814130000

U.S. PUBLIC LAND SURVEY MONUMENT RECORD

Index No. **N-25**

State of Wisconsin }
County of Forest } ss.

I William B. Cochrane, do hereby
certify that on the 25th day
of February, 1985, I found
evidence of the Northeast Section
corner of Section 24
Township 38, North, Range
14 East, Fourth Principal Meridian,
as described hereon; and that from this evidence
I established a new monument and accessories
as described hereon to perpetuate the original
location of this corner.

Resident witnesses:

David Brownell

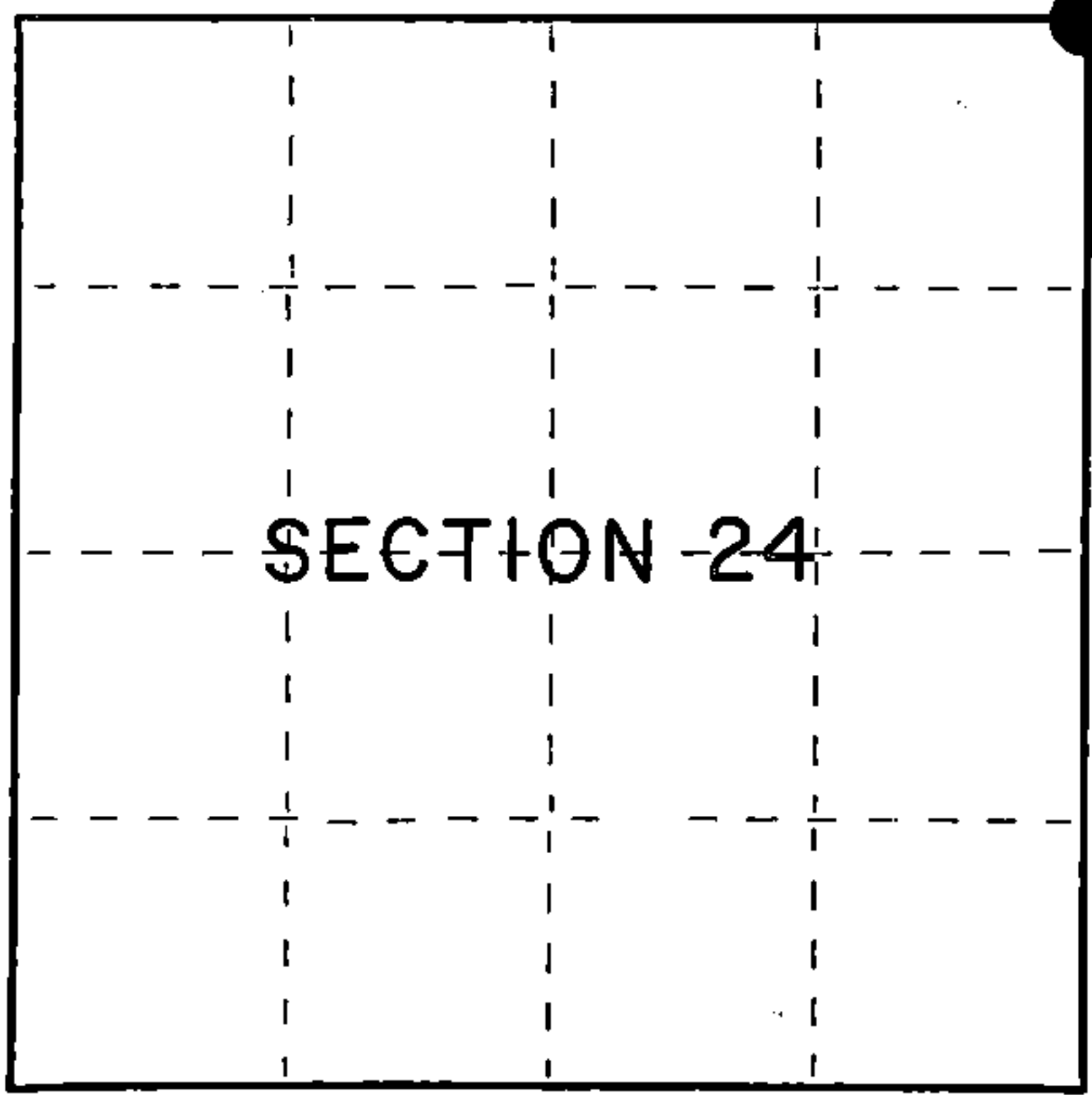

○ = Corner monument restored.

History of original corner establishment:

Original Government Survey in 1857 by Artemas Curtis. North between Sections 19 and 24, 80.00 chains, set Section corner post to Sections 13, 18, 19, and 24. From which the following bear:

| | | | |
|-------|-----|-------|---------|
| Cedar | 10" | S38°W | 40 lks. |
| Cedar | 7" | N72°W | 10 lks. |
| Cedar | 5" | N60°E | 20 lks. |
| Cedar | 16" | S27°E | 17 lks. |

Description of corner evidence found:

2½" diameter aluminum pipe monument, with an aluminum cap stamped: T38N, R14E, R15E, S13, S18, S19, S24, S-498, 1976, Forest County. From which the following bear:

| | | | |
|-------|-----|-------|------------|
| Cedar | 10" | N55°E | 26.74 feet |
|-------|-----|-------|------------|

No original corner evidence was recovered.

Description of monument and accessories I established to perpetuate the original location of this corner.

Blazed and scribed the following new bearing trees:

| | | | |
|-----------------|-----|-------|------------|
| Cedar | 12" | S31°E | 31.78 feet |
| Cedar | 4" | S78°W | 30.33 feet |
| Cedar | 6" | N58°W | 28.46 feet |
| Steel sign post | | NE | 0.50 feet |

Dated at Hiles, Wis., this 12th day of March, 1985

Signature William B. Cochrane Title Land Surveyor Registration No. S-1107
(County Surveyor, Registered Land Surveyor, or other duly authorized official)

Office of Register of Deeds, County of Forest, I hereby certify that the within
instrument was filed in this office for record on the 24th day of April, 1985
at 1:00 o'clock P. M.

Paul Aschenbrenner
(Register of Deeds)

By _____ Deputy

FORM NO. 985-A

H.C. Miller Company
ST. LOUIS, MO.

Stock No. 26273

Document Number 127899

43814130000

(e) Describe any material discrepancy between the location of the corner as restored or reestablished and the location of that corner as previously restored or reestablished by distance and direction. Show the discrepancy on the plan view drawing under (d), above. Show the distances between the corner as previously restored or reestablished and (1) the corner as restored or reestablished, and (2) to at least 2 of the witness monuments shown on the drawing in (d), above.

See drawing below.

(f) Was the corner restored through acceptance of (1) an obliterated evidence location, or, (2) a found perpetuated location?

Restored through acceptance of a found perpetuated location.

(g&h) Was the corner reestablished through lost corner proportionate methods? If so, show the method, including the directions and distances to other public land survey corners used as evidence or used for proportioning in determining the corner location?

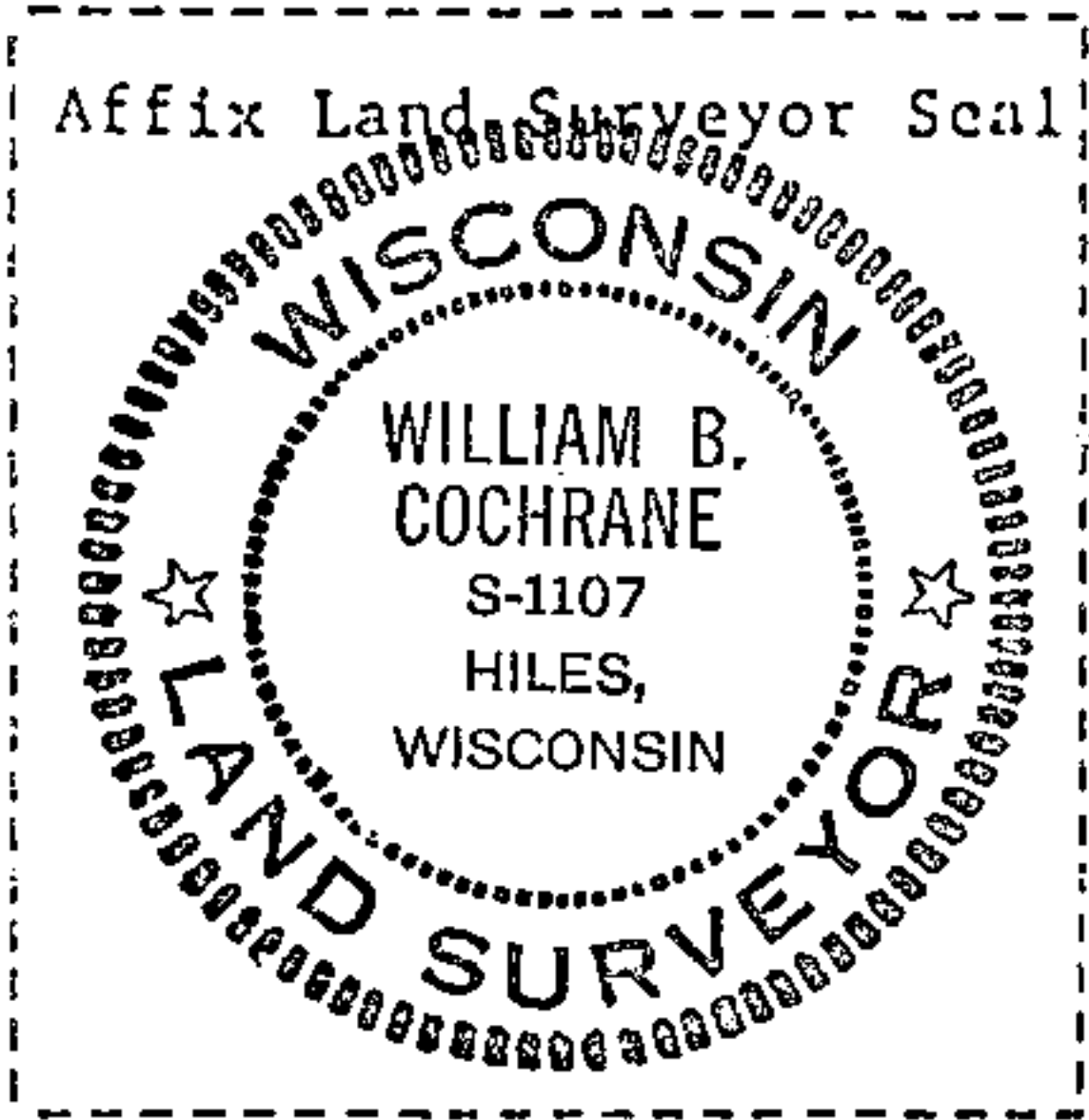
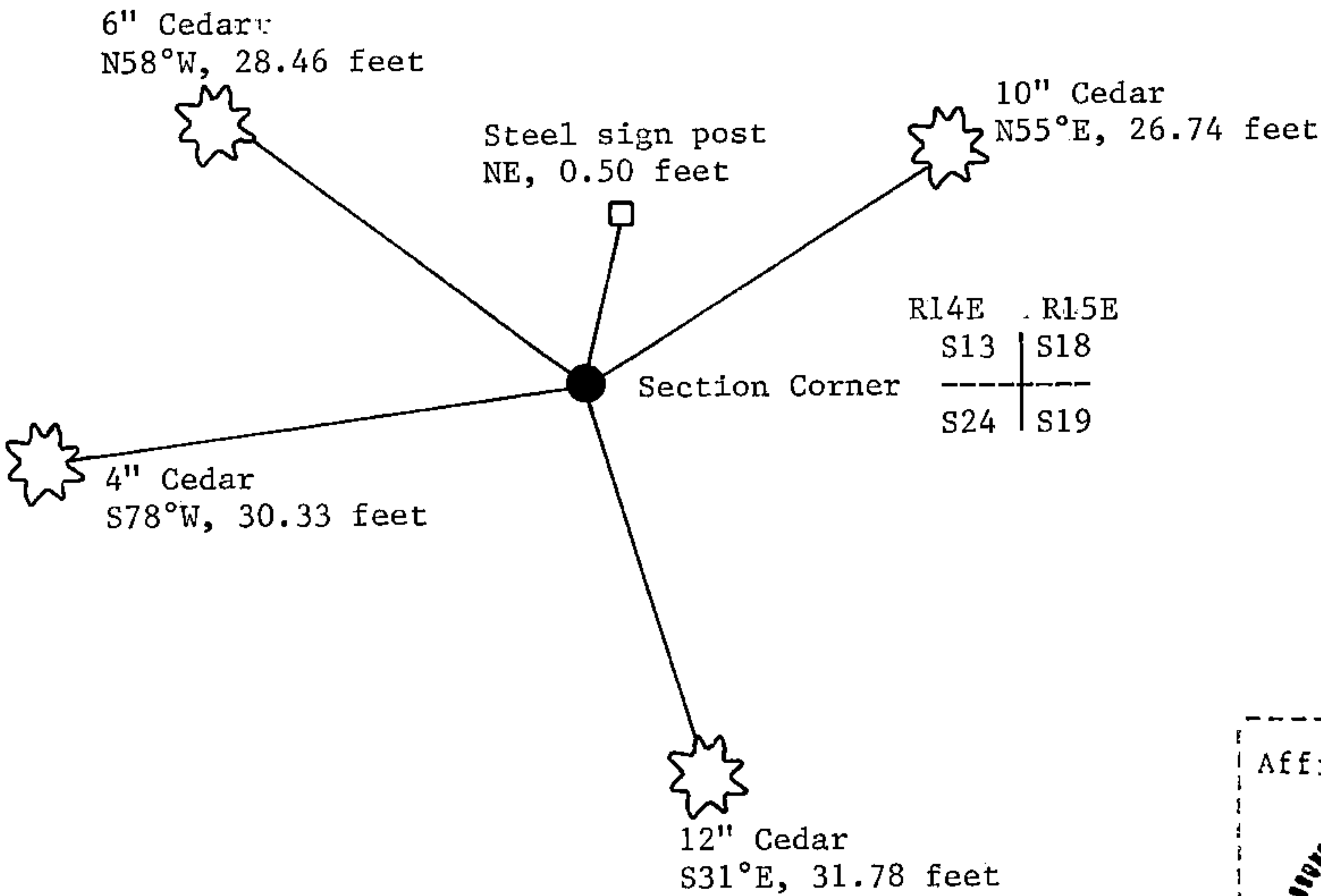

(i) I, William B. Cochrane
(type or print name) certify that the corner location shown on this record was determined by me or under my direction and control and that this U.S. Public Land Survey Monument Record is correct and complete to the best of my knowledge and belief.

William B. Cochrane March 12, 1985
Signature Date