

Document Number 127515

FORM 985 M. C. MILLER CO., MILWAUKEE

State of Wisconsin }  
County of Forest } ss.

I, Glen Barker, do hereby  
certify that on the 8th day  
of January, 1985, I found  
evidence of the N 1/16  
corner of Sections 29 & 30  
Township 38  
14 East, North, Range  
as described hereon; and that from this evidence  
I established a new monument and accessories  
as described hereon to perpetuate the original  
location of this corner.

Resident witnesses:

N. Spiess

R. Lundt

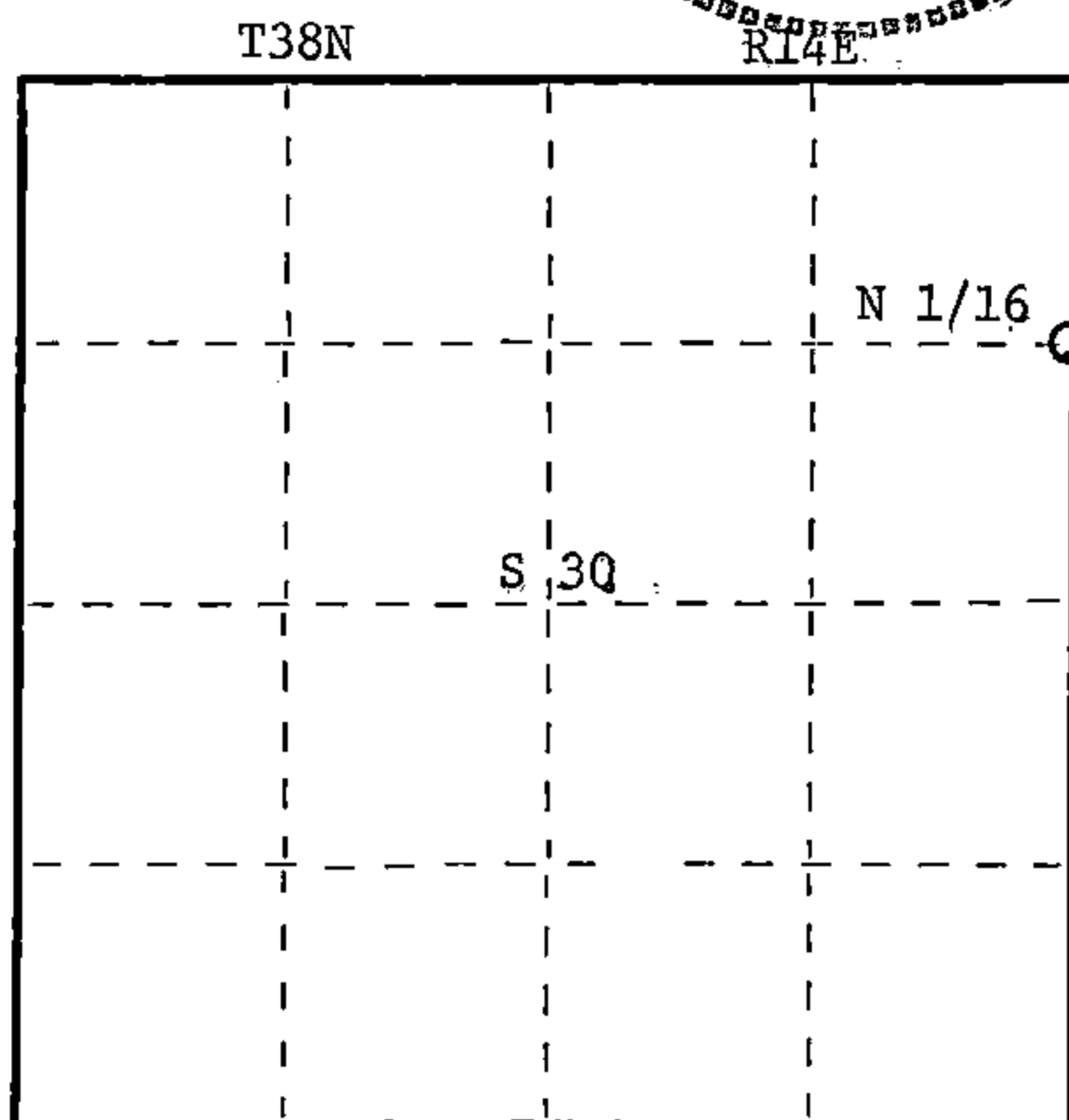
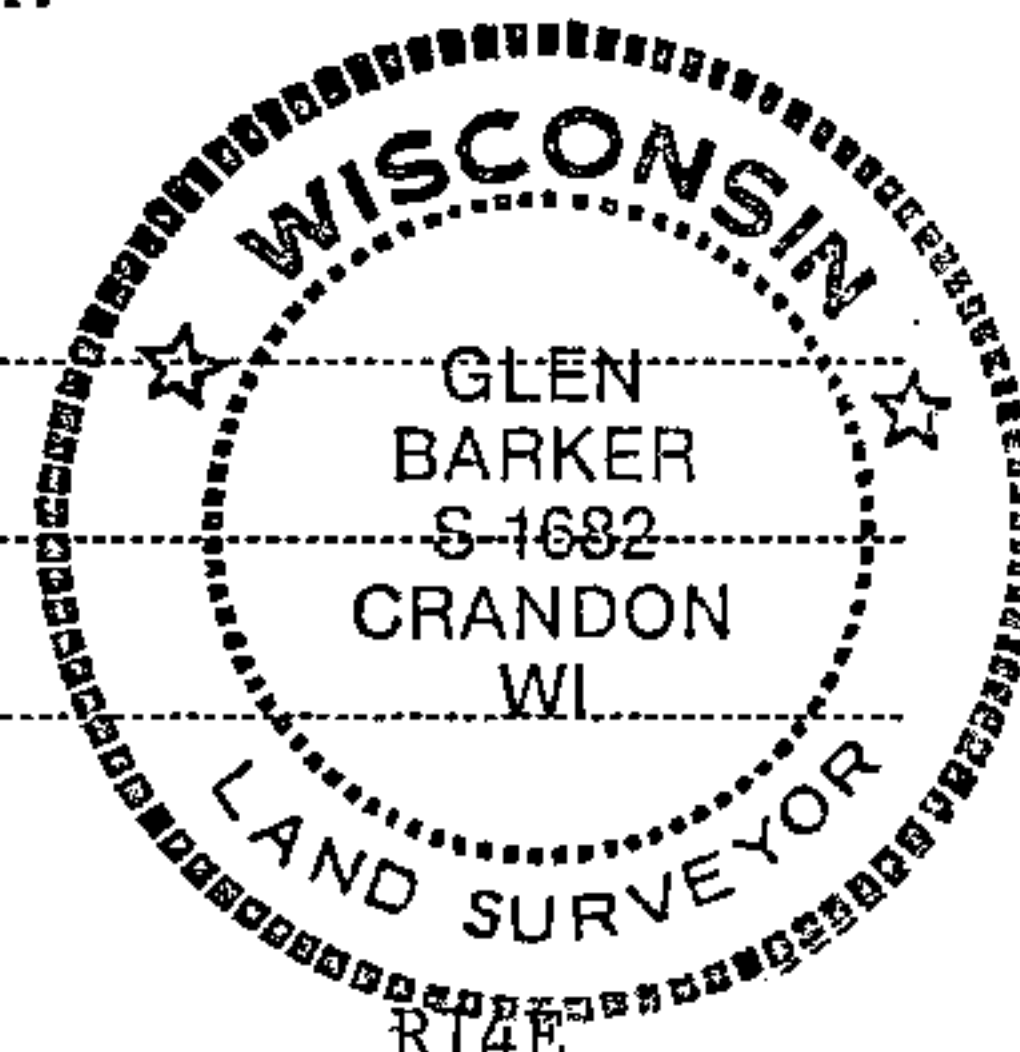

○ = Corner monument restored.

# CERTIFIED LAND CORNER RESTORATION

Index No. S-5

S 5

History of original corner establishment:

No evidence of any previous corner

Description of corner evidence found:

Total distance from section corner 19-20-29-30 to 1/4 corner between sections 29 & 30  
is 2624.52'.  
Set N 1/16 1312.26' intermediate.

Description of monument and accessories I established to perpetuate the original location of this corner.

Set a 1" iron pipe with 2" diameter alloy cap stamped:

S1682

Monument projects 18" above ground

T38N

Marked NBTs:

Cedar 4" S80E 18.28'

Cedar 12" S15E 37.38'

N 1/16

S30 S29

R14E

CPI - 1985

Dated at Rhinelander, Wis., this 6th day of February, 1985.

Signature: Glen Barker Title: Registered Land Surveyor Registration No. 1682

(County Surveyor, Registered Land Surveyor, or other duly authorized official)

Office of Register of Deeds, County of Forest, I hereby certify that the within  
instrument was filed in this office for record on the 22nd day of February, 1985  
at 2:15 o'clock P. M.

Paul Aschenbrenner

(Register of Deeds)

By Deputy

43814303000